



Providence Bicycle and Pedestrian Advisory Commission

Jorge O. Elorza, Mayor

Staff Report: Woonasquatucket Greenway Improvements Design Review – Valley, Smith Hill – Wards 12, 15 (For Action)

Presented at February 17, 2021 BPAC meeting

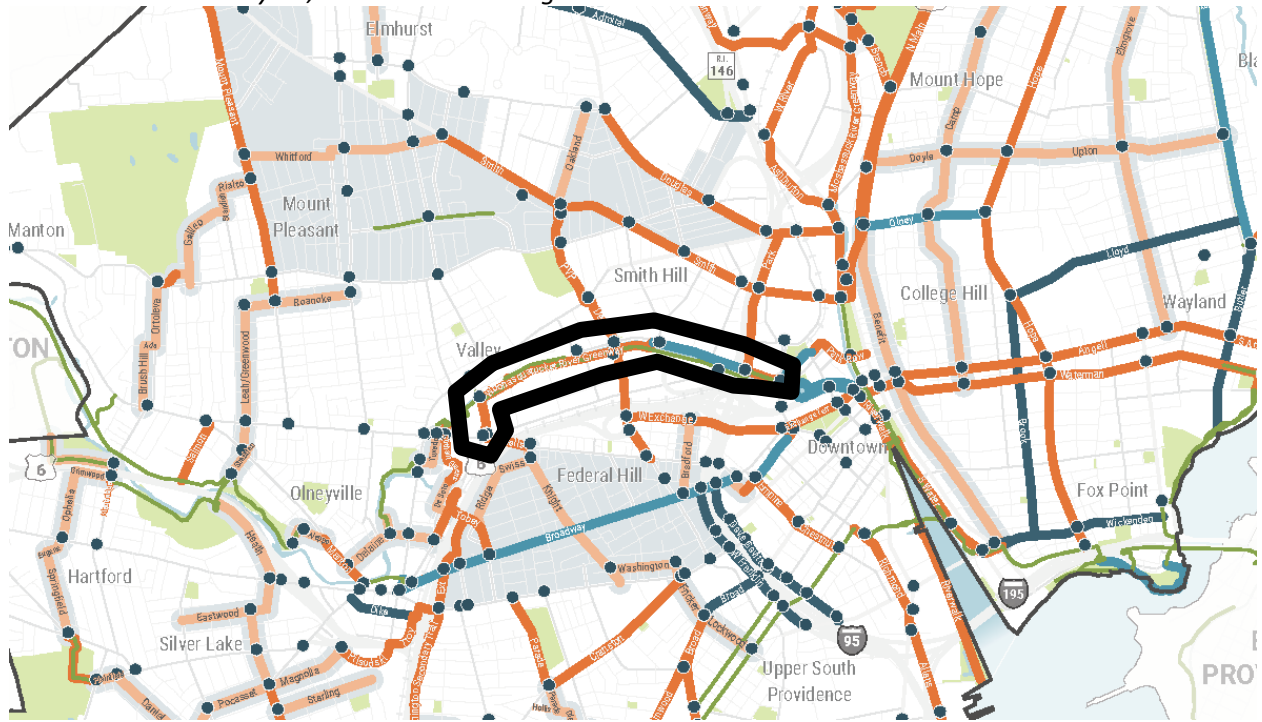

Project Background

The City of Providence Department of Planning and Development seeks comments from the BPAC regarding design plans for Woonasquatucket Greenway improvements on Promenade Street, Kinsley Avenue, Providence Place, and Eagle Street. This will be a design level review of the project and will be the second of two reviews before the Commission.

This project came before the Commission for conceptual review in June 2020. Recommendations at the time were:

- The slip lane from Kinsley Ave eastbound onto Dean St southbound should be removed,
 - This was not able to be accommodated
- A crosswalk should be added across Promenade St at the sculpture bridge,
 - This crosswalk was added to the plans
- The slip lane from Bath St southbound onto Promenade St westbound should be reconsidered, with a preference for moving utility pole and integrating a truck apron instead of a slip lane, and
 - This was not able to be accommodated



Providence Bicycle and Pedestrian Advisory Commission

Jorge O. Elorza, Mayor

- A crosswalk should be added across the south side of the Bath Street Bridge where it intersects with Providence Place,
 - This crosswalk was added to the plans
- The City should work with partners such as the Woonasquatucket River Watershed Council and the Providence Place Mall to organize “Car-free Days” events on Promenade Street, and
 - This will be discussed more as the project continues its development
- The City should monitor traffic conditions in the neighborhood especially watching for speeding on Harris Ave.
 - The Traffic Calming Advisory Group discussed adding additional speed lumps to Harris Ave between Atwells Ave and Providence Place, and gave preliminary approval to additional locations based on speeding studies.

Now at 30% design, the project is planned to advance to 90% design by July, construction documents by November, with construction beginning in Spring 2020.

Other changes since conceptual review

- A new pocket park at the intersection of Eagle St and Kinsley Ave provides space for stormwater-related features as well as park features, and involves a slight realignment of the path at that intersection.
- Additional speed lumps are incorporated into the design.
- Realignment of intersection between Harris & Providence Place unable to occur, affecting alignment of Park/Promenade intersection under Mall.
- The intersection of Promenade St with the Bath Street Bridge will now be signalized.

Respectfully submitted by Alex Ellis.



MATCH LINE SIGNING AND STRIPING PLAN NO. 12

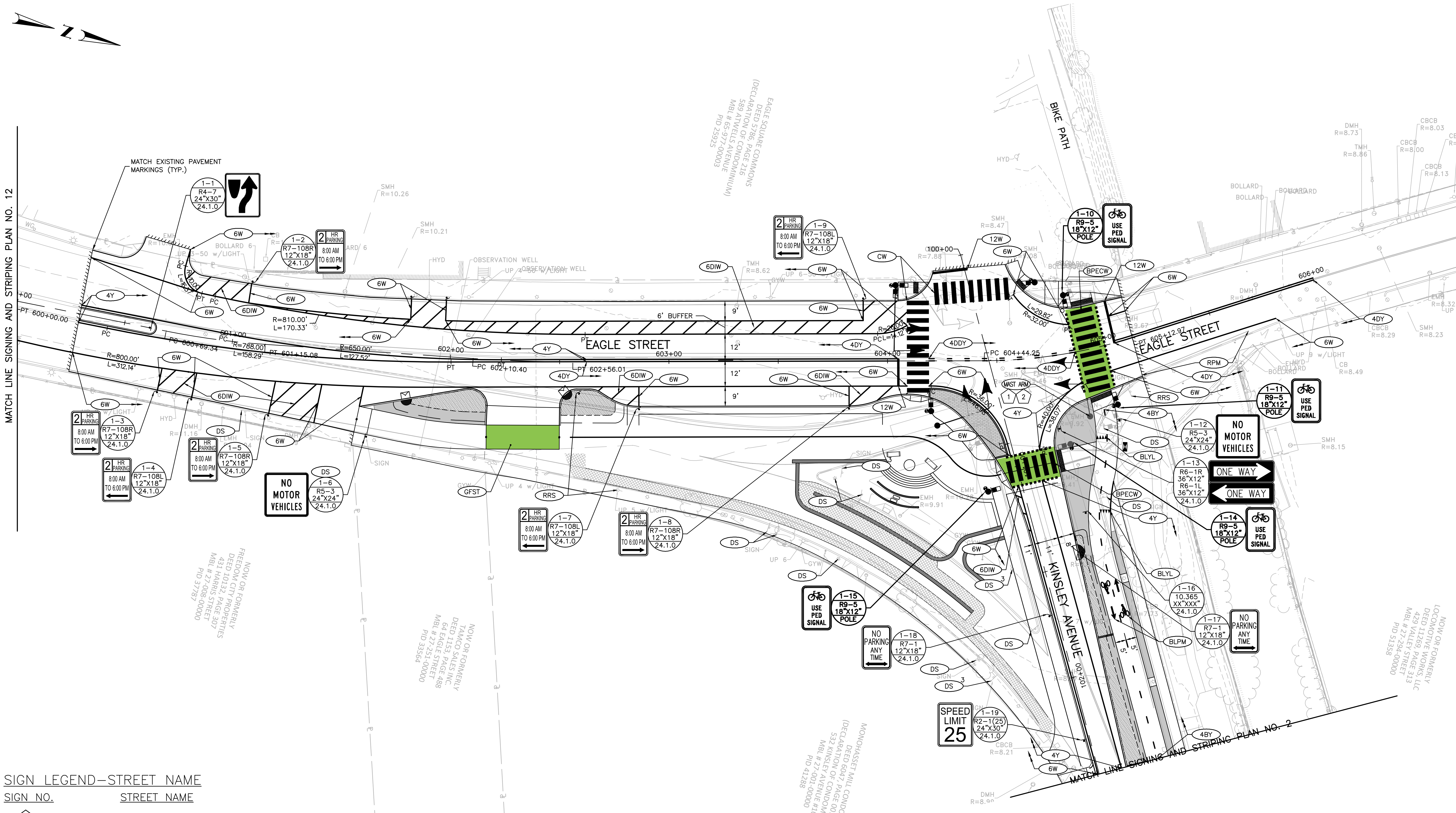

SIGN LEGEND—STREET NAME

SIGN NO.	STREET NAME
1	EAGLE STREET
2	KINSLEY AVENUE

NOTES:
 1. CONFLICTING PAVEMENT MARKINGS SHALL BE REMOVED



WOONASQUATUCKET RIVER GREENWAY

DESIGNED BY: TJS
 CHECKED BY: DBC
 DATE: 02/2021
 SHEET: 1
 OF: 12

REVISIONS			REVISIONS		
NO.	DATE	BY	NO.	DATE	BY

WOONASQUATUCKET RIVER GREENWAY
 PROVIDENCE RHODE ISLAND
SIGNING AND STRIPING PLAN

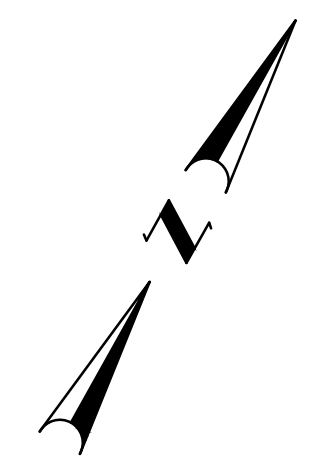

NOW OR FORMERLY
GNI REALTY EAGLE LLC,
RAL REALTY LIMITED PARTNERSHIP,
BETTE LIGHT KROM,
BARBARA S. RUBIN,
DEED 8515, PAGE 247
459 VALLEY STREET
MBL # 27-295-00000
PID 51357

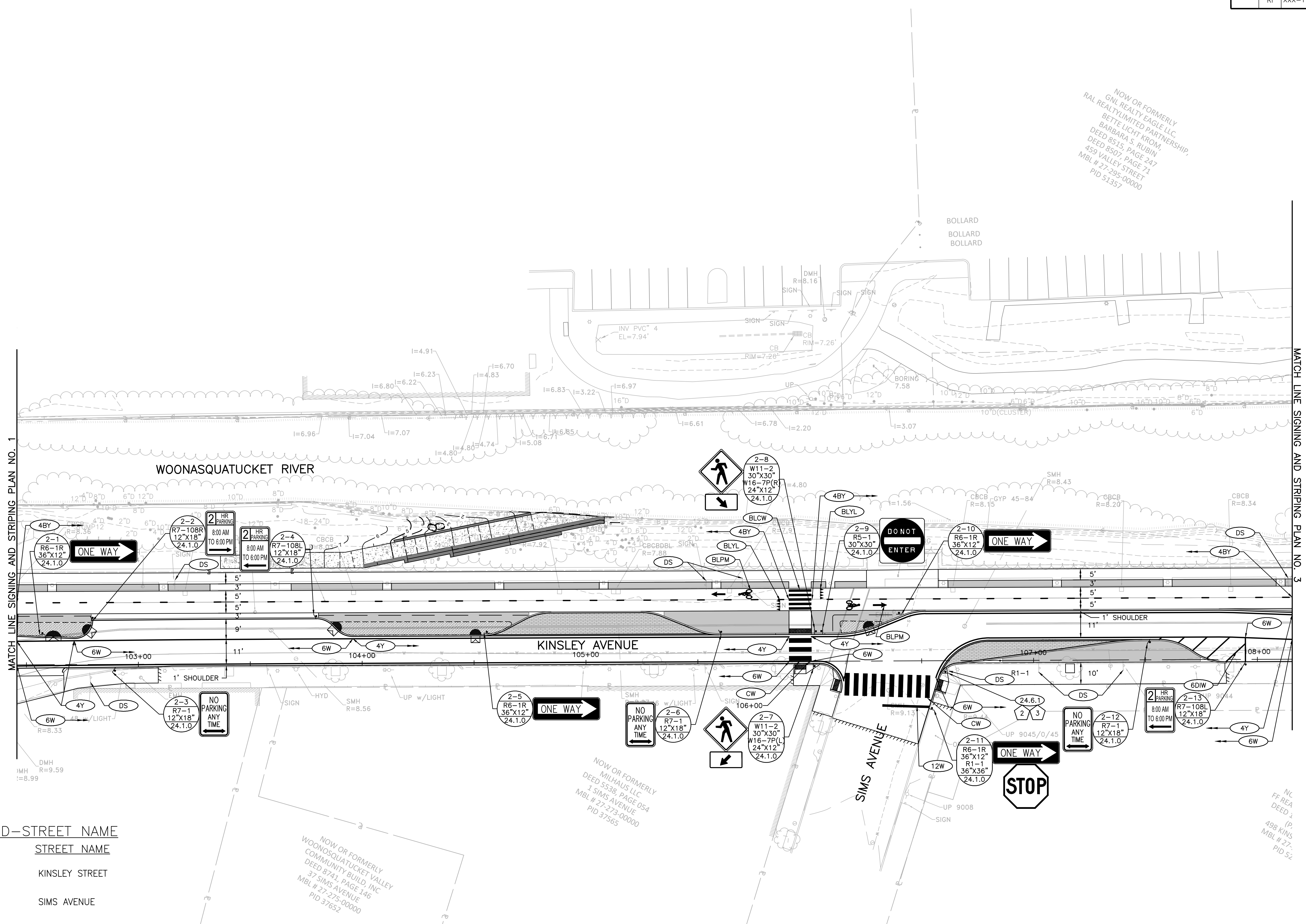

MATCH LINE SIGNING AND STRIPING PLAN NO. 1

MATCH LINE SIGNING AND STRIPING PLAN NO. 3

SIGN LEGEND—STREET NAME

SIGN NO.	STREET NAME
2	KINSLEY STREET
3	SIMS AVENUE

NOW OR FORMERLY
WOONASQUATUCKET VALLEY
COMMUNITY BUILD, INC
DEED 8741, PAGE 146
37 SIMS AVENUE
MBL # 27-275-00000
PID 37652

NOW OR FORMERLY
MILHAUS LLC
DEED 5538, PAGE 054
1 SIMS AVENUE
MBL # 27-273-00000
PID 37565

NC
FF REA
DEED 4
(P.
498 KINS
MBL # 27-
PID 52



WOONASQUATUCKET RIVER GREENWAY

DESIGNED BY: TJS
CHECKED BY: DBC
DATE: 02/2021
SHEET: 2
OF: 12

REVISIONS			REVISIONS		
NO.	DATE	BY	NO.	DATE	BY

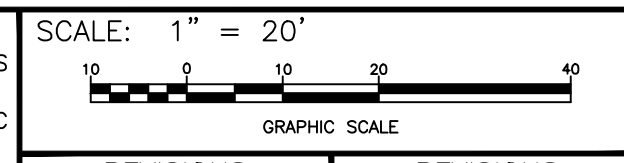

WOONASQUATUCKET RIVER GREENWAY
PROVIDENCE RHODE ISLAND
SIGNING AND STRIPING PLAN

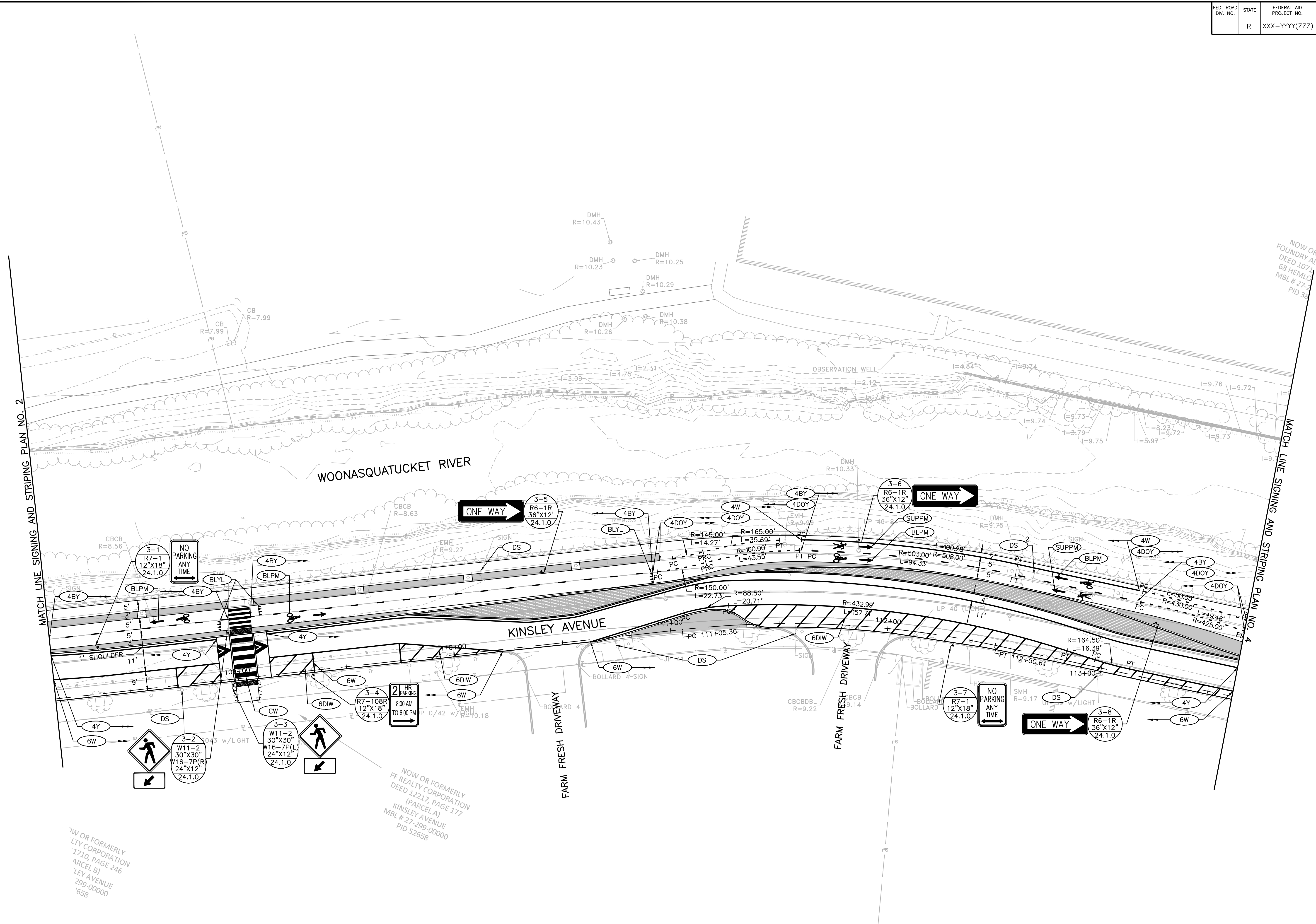
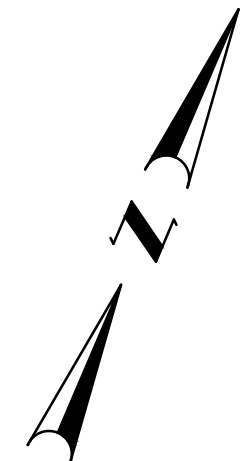

MATCH LINE SIGNING AND STRIPING PLAN NO. 2

MATCH LINE SIGNING AND STRIPING PLAN NO. 4

NW OR FORMERLY
LTY CORPORATION
'1710, PAGE 246
ARCEL (B)
LEY AVENUE
299-00000
'658

NOW OR FORMERLY
FF REALTY CORPORATION
DEED 12217, PAGE 177
(PARCEL A)
KINSLEY AVENUE
MBL # 27-299,00000
PID 52658



WOONASQUATUCKET RIVER GREENWAY

DESIGNED BY: TJS
 CHECKED BY: DBC
 DATE: 02/2021
 SHEET: 3
 OF: 12

REVISIONS			REVISIONS		
NO.	DATE	BY	NO.	DATE	BY

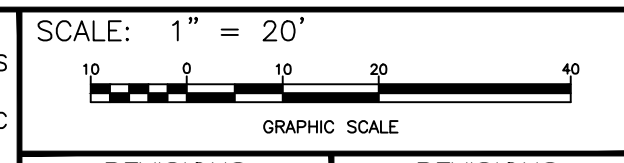

WOONASQUATUCKET RIVER GREENWAY
 PROVIDENCE RHODE ISLAND
 SIGNING AND STRIPING PLAN



FORMERLY CO MEMBERS DEED 131 HEMLOCK STREET 79-00000 PID 38844

NOW OR FORMERLY FOUNDRY ALCO MEMBERS DEED 10718, PAGE 131 38 HEMLOCK STREET MBL # 27-278-00000 PID 38843

MATCH LINE SIGNING AND STRIPING PLAN NO. 3

MATCH LINE SIGNING AND STRIPING PLAN NO. 5

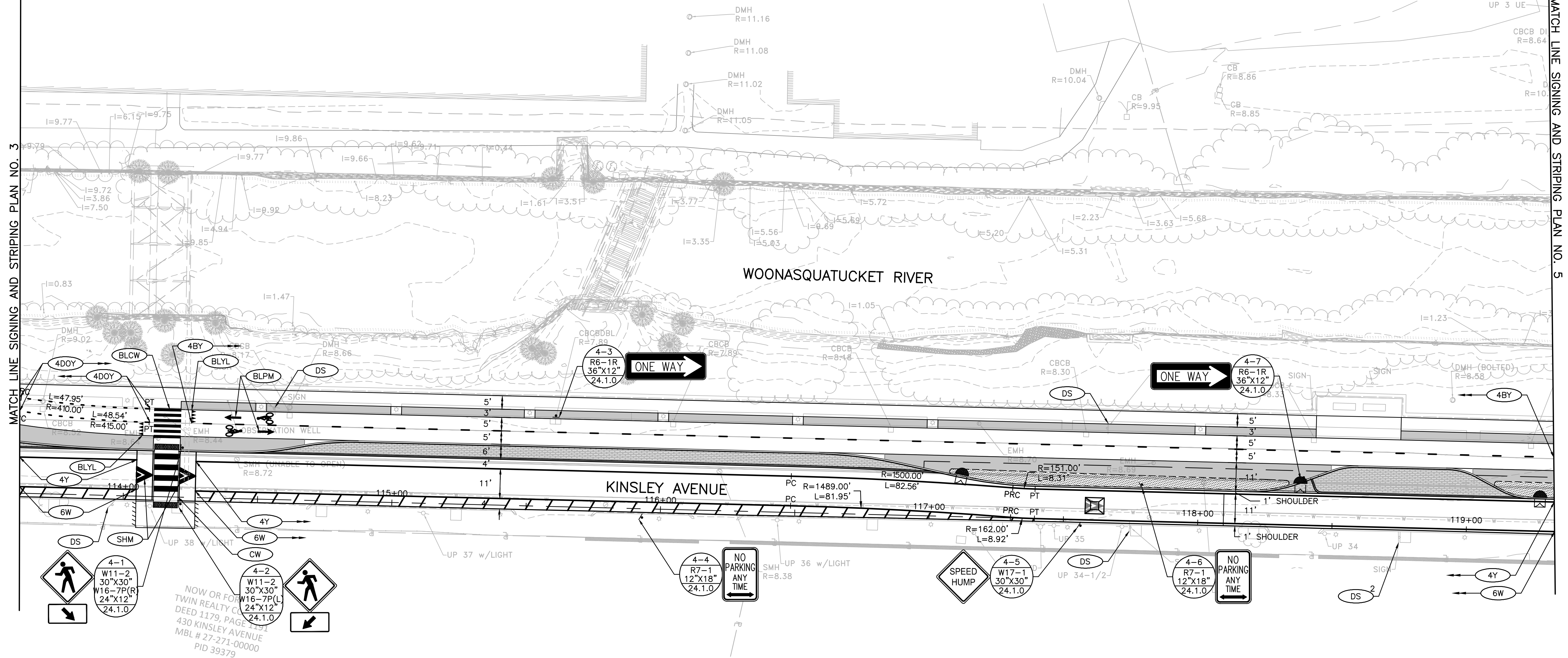

NOW OR FORMERLY TWIN REALTY CO DEED 1179, PAGE 131 430 KINSLEY AVENUE MBL # 27-271-00000 PID 39379

NOW OR FORMERLY JACOB LICHT INC DEED 2227, PAGE 105 350 KINSLEY AVENUE MBL # 27-016-00000 PID 38358



WOONASQUATUCKET RIVER GREENWAY

DESIGNED BY: TJS
 CHECKED BY: DBC
 DATE: 02/2021
 SHEET: 4
 OF: 12

SCALE: 1" = 20'
 GRAPHIC SCALE

REVISIONS			REVISIONS		
NO.	DATE	BY	NO.	DATE	BY

WOONASQUATUCKET RIVER GREENWAY
 PROVIDENCE RHODE ISLAND
 SIGNING AND STRIPING PLAN

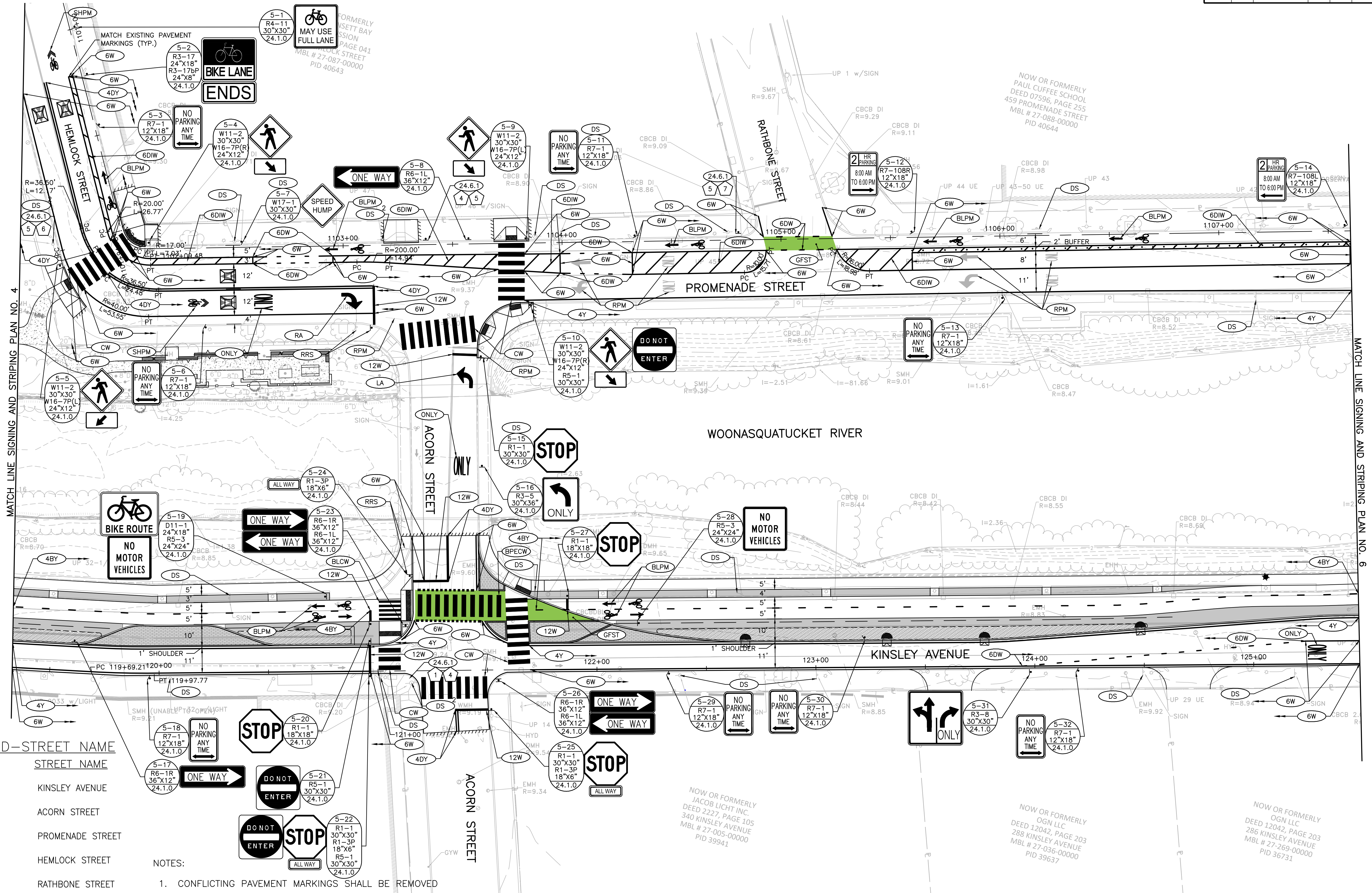

SIGN LEGEND—STREET NAME

SIGN NO.	STREET NAME
2	KINSLEY AVENUE
4	ACORN STREET
5	PROMENADE STREET
6	HEMLOCK STREET
7	RATHBONE STREET

NOTES:
 1. CONFLICTING PAVEMENT MARKINGS SHALL BE REMOVED

NOW OR FORMERLY
 JACOB LIGHT INC.
 DEED 2227, PAGE 105
 340 KINSLEY AVENUE
 MBL # 27-005-00000
 PID 39941

NOW OR FORMERLY
 OGN LLC
 DEED 12042, PAGE 203
 288 KINSLEY AVENUE
 MBL # 27-036-00000
 PID 39637

NOW OR FORMERLY
 OGN LLC
 DEED 12042, PAGE 203
 286 KINSLEY AVENUE
 MBL # 27-269-00000
 PID 36731



WOONASQUATUCKET RIVER GREENWAY

DESIGNED BY: TJS
 CHECKED BY: DBC
 DATE: 02/2021
 SHEET: 5
 OF: 12

REVISIONS			REVISIONS		
NO.	DATE	BY	NO.	DATE	BY

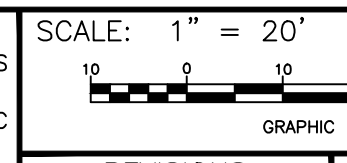

WOONASQUATUCKET RIVER GREENWAY

PROVIDENCE RHODE ISLAND

SIGNING AND STRIPING PLAN

MATCH LINE SIGNING AND STRIPING PLAN NO. 5

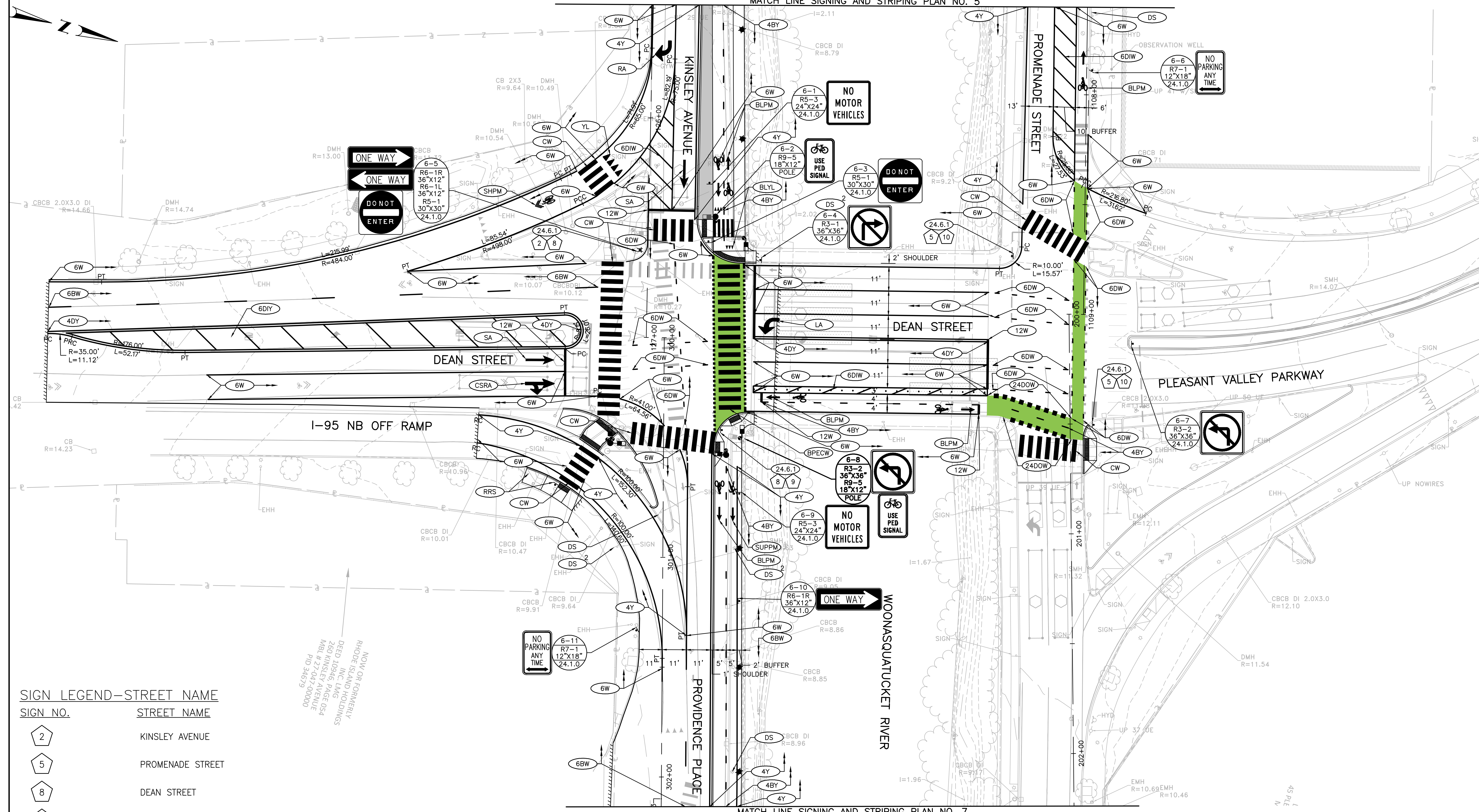

MATCH LINE SIGNING AND STRIPING PLAN NO. 7

SIGN LEGEND—STREET NAME

SIGN NO.	STREET NAME
2	KINSLY AVENUE
5	PROMENADE STREET
8	DEAN STREET
9	PROVIDENCE PLACE
10	PLEASANT VALLEY PARKWAY

NOTES:
 1. CONFLICTING PAVEMENT MARKINGS SHALL BE REMOVED

NOTE: NOW OR FORMERLY RHODE ISLAND HOLDINGS INC. LANG DEED 10946 PING 260 KINSLY AVENUE MBL # 27-047-00000 PID 34679



WOONASQUATUCKET RIVER GREENWAY

DESIGNED BY: TJS
 CHECKED BY: DBC
 DATE: 02/2021
 SHEET: 6
 OF: 12

REVISIONS			REVISIONS		
NO.	DATE	BY	NO.	DATE	BY

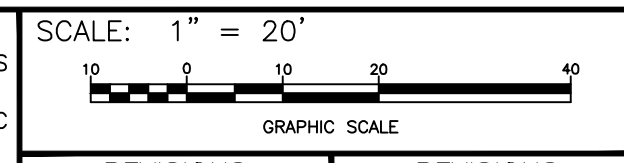

WOONASQUATUCKET RIVER GREENWAY
 PROVIDENCE RHODE ISLAND
SIGNING AND STRIPING PLAN

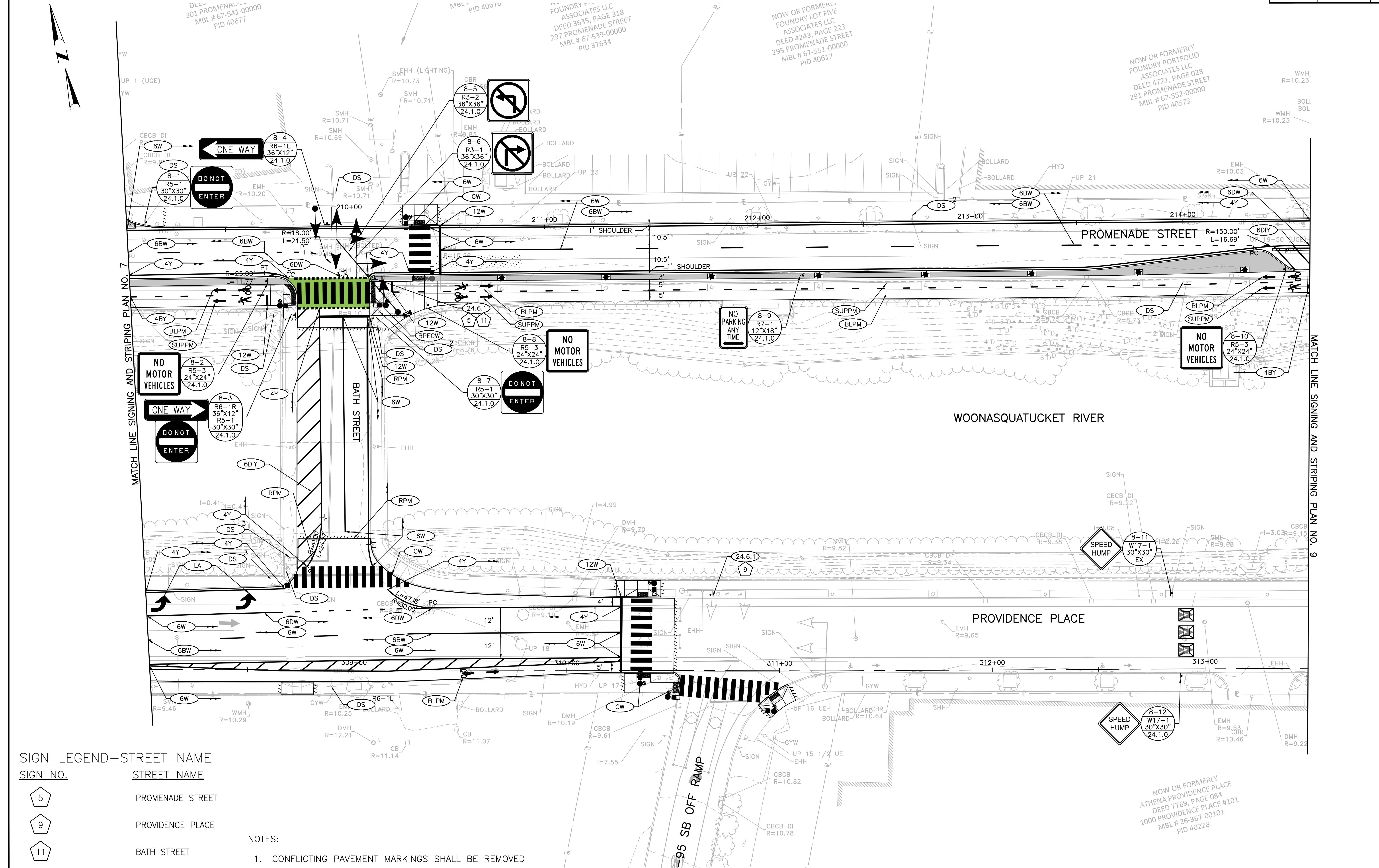

SIGN LEGEND—STREET NAME

SIGN NO.	STREET NAME
5	PROMENADE STREET
9	PROVIDENCE PLACE
11	BATH STREET

NOTES:
 1. CONFLICTING PAVEMENT MARKINGS SHALL BE REMOVED



WOONASQUATUCKET RIVER GREENWAY

DESIGNED BY: TJS
 CHECKED BY: DBC
 DATE: 02/2021
 SHEET: 8
 OF: 12

SCALE: 1" = 20'

REVISIONS			REVISIONS		
NO.	DATE	BY	NO.	DATE	BY

WOONASQUATUCKET RIVER GREENWAY
 PROVIDENCE RHODE ISLAND
SIGNING AND STRIPING PLAN

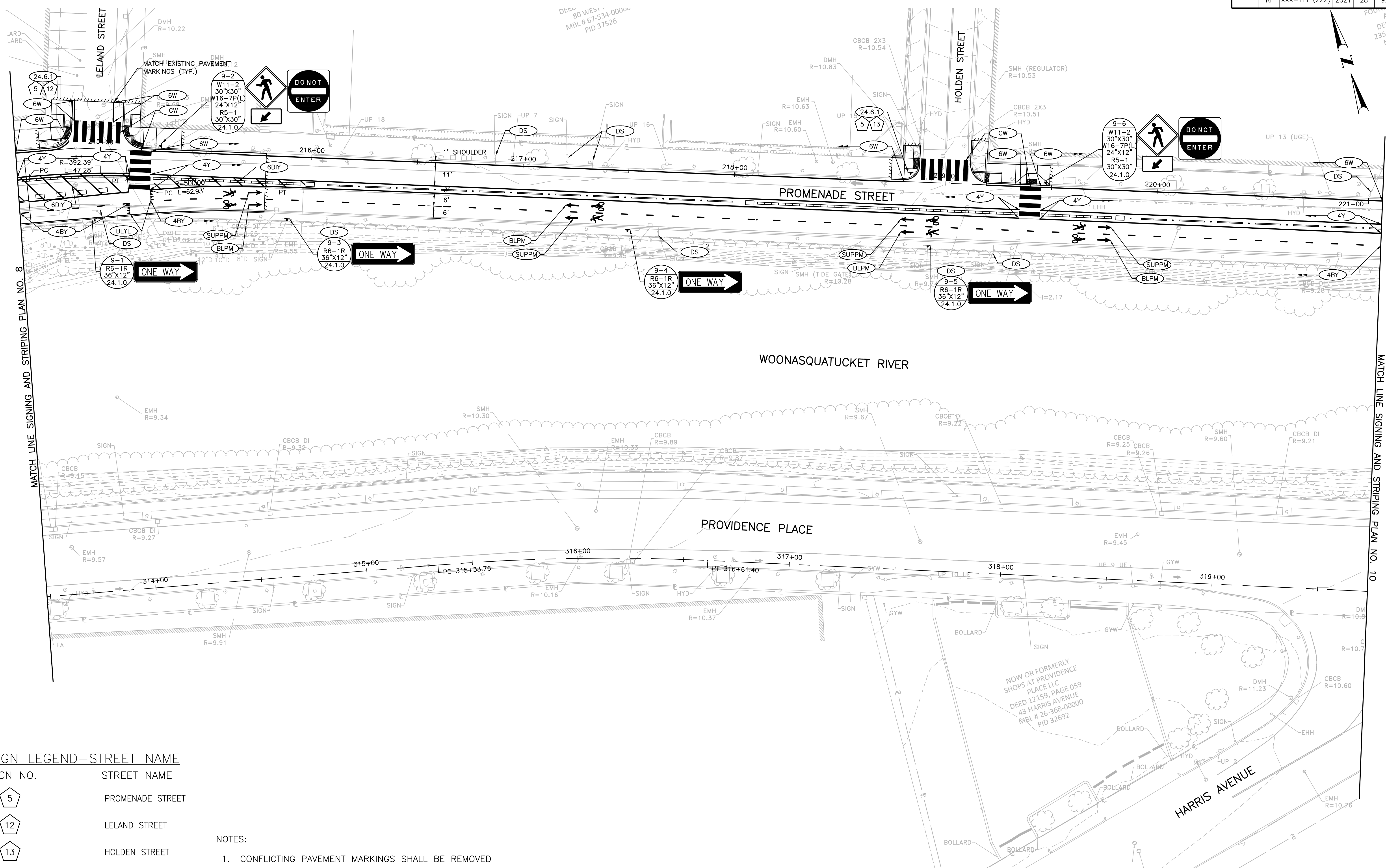

SIGN LEGEND—STREET NAME

SIGN NO.	STREET NAME
5	PROMENADE STREET
12	LELAND STREET
13	HOLDEN STREET

NOTES:

- CONFLICTING PAVEMENT MARKINGS SHALL BE REMOVED



WOONASQUATUCKET RIVER GREENWAY

DESIGNED BY: TJS
 CHECKED BY: DBC
 DATE: 02/2021
 SHEET: 9
 OF: 12

SCALE: 1" = 20'

REVISIONS			REVISIONS		
NO.	DATE	BY	NO.	DATE	BY

WOONASQUATUCKET RIVER GREENWAY
 PROVIDENCE RHODE ISLAND
SIGNING AND STRIPING PLAN

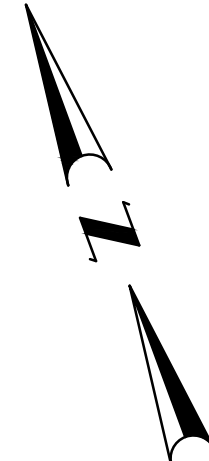

SIGN LEGEND—STREET NAME

SIGN NO.	STREET NAME
5	PROMENADE STREET
14	PARK STREET

NOTES:
 1. CONFLICTING PAVEMENT MARKINGS SHALL BE REMOVED

JR FORMERLY
 Y PARCEL FIFTEEN
 SOCIATES LLC
 D 3635, PAGE 322
 PROMENADE STREET
 IBL # 42-253-00000
 PID 34883

NOW OR FORMERLY
 PROVIDENCE PLACE GROU
 DEED 06428, PAGE 28
 1 PROVIDENCE PLAC
 MBL # 19-136-000
 PID 40024

NOW OR FORMERLY
 NATIONAL RAILROAD PASS
 CORP AMTRACK
 151 FRANCIS STREE
 MBL # 19-125-000
 PID 26678

MATCH LINE SIGNING AND STRIPING PLAN NO. 9

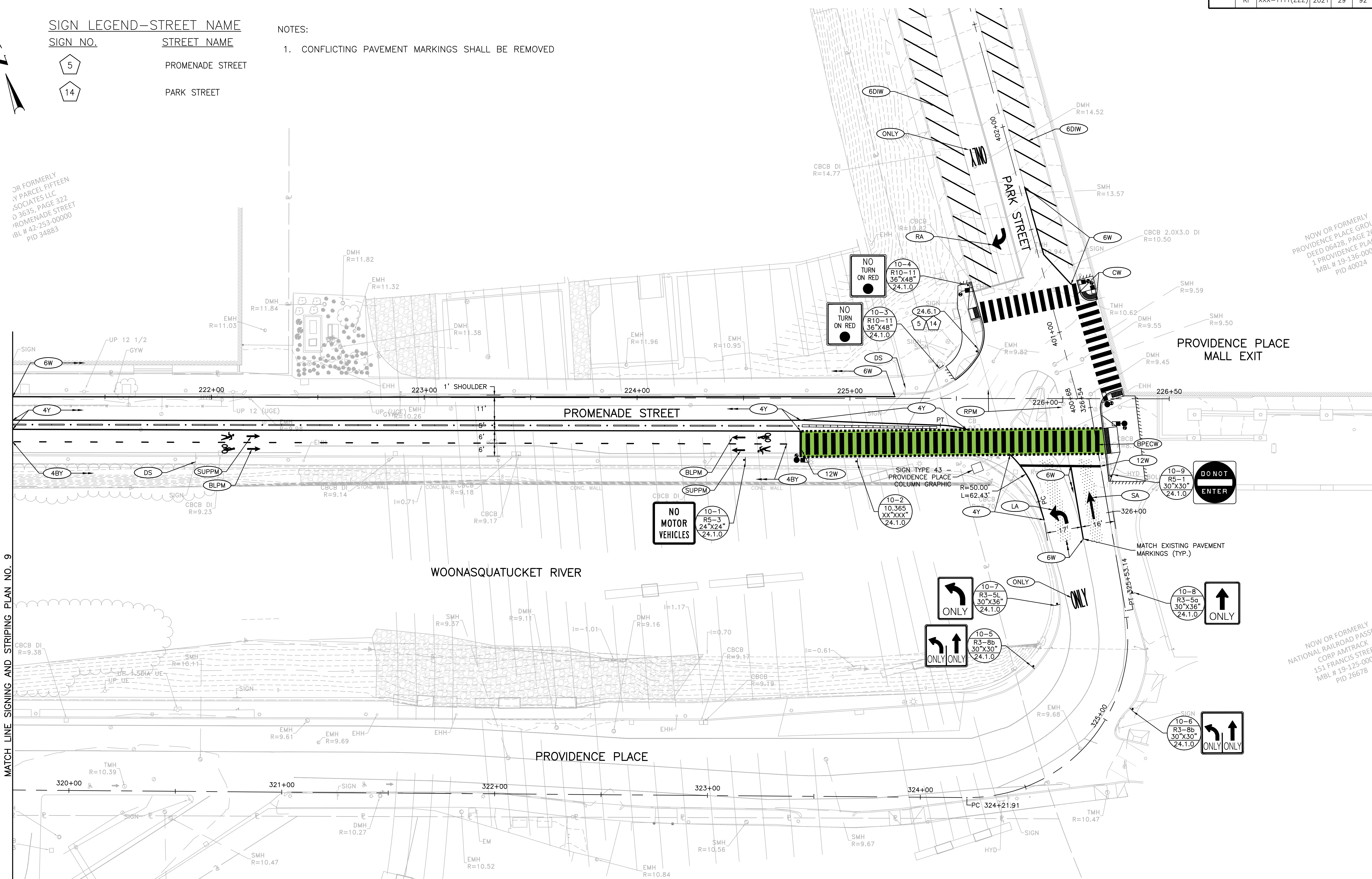

WOONASQUATUCKET RIVER GREENWAY

DESIGNED BY: TJS
 CHECKED BY: DBC
 DATE: 02/2021
 SHEET: 10
 OF: 12

SCALE: 1" = 20'
 GRAPHIC SCALE

REVISIONS			REVISIONS		
NO.	DATE	BY	NO.	DATE	BY

WOONASQUATUCKET RIVER GREENWAY
 PROVIDENCE RHODE ISLAND
SIGNING AND STRIPING PLAN

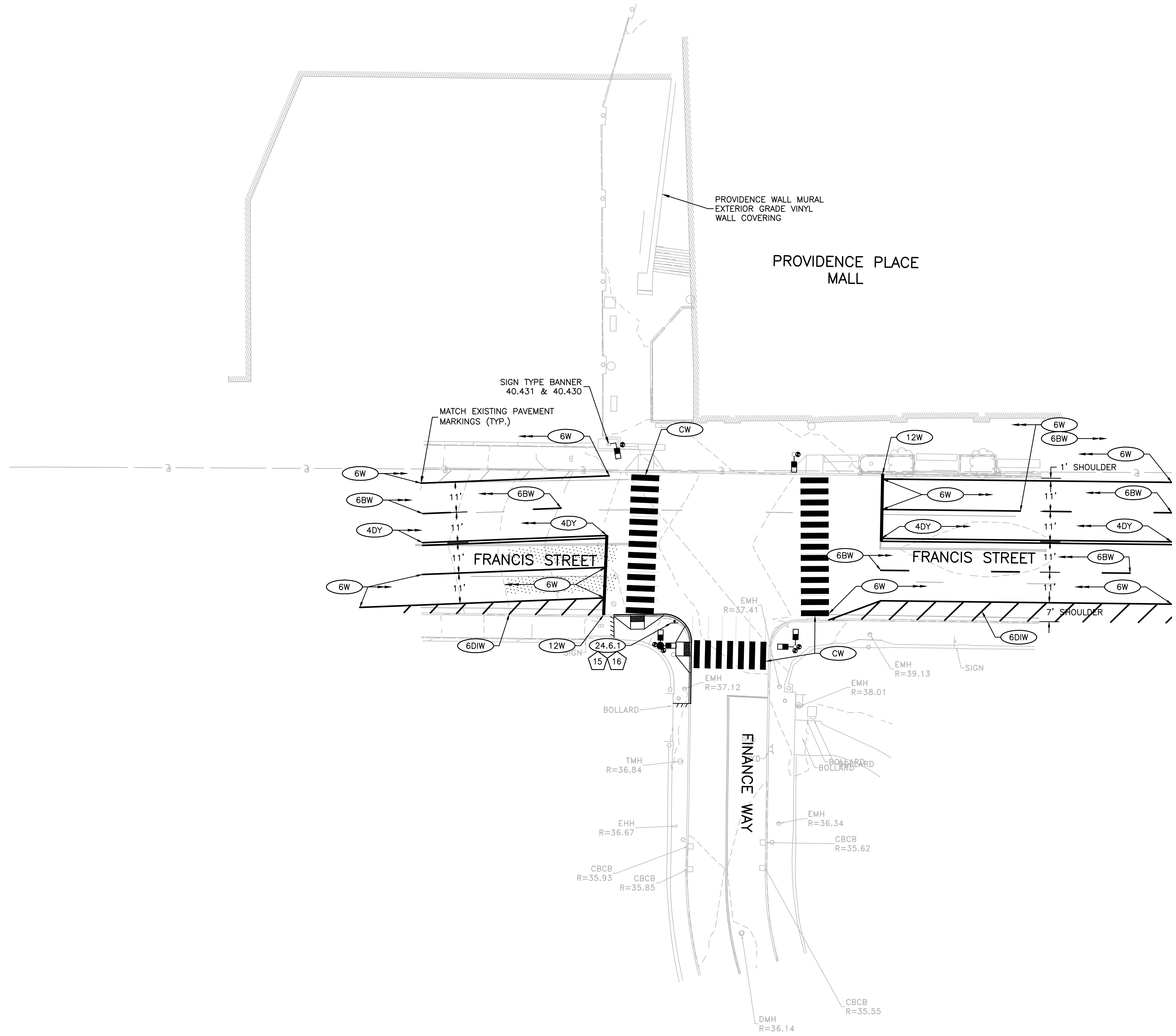
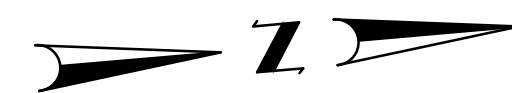

SIGN LEGEND—STREET NAME

SIGN NO.	STREET NAME
15	FRANCIS STREET
16	FRANCIS WAY

NOTES:
1. CONFLICTING PAVEMENT MARKINGS SHALL BE REMOVED



WOONASQUATUCKET RIVER GREENWAY

DESIGNED BY:	TJS
CHECKED BY:	DBC
DATE:	02/2021
SHEET:	11
OF:	12

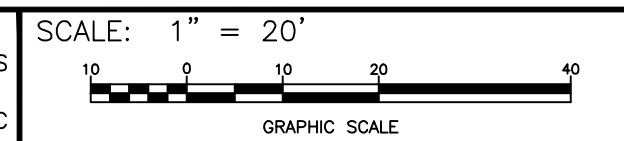

WOONASQUATUCKET RIVER GREENWAY
PROVIDENCE RHODE ISLAND
SIGNING AND STRIPING PLAN