

WOONASQUATUCKET RIVER GREENWAY



MAYOR JORGE O. ELORZA
CITY OF PROVIDENCE

WOONASQUATUCKET
RIVER
GREENWAY



WOONASQUATUCKET RIVER
WATERSHED COUNCIL

Public Meeting #2
May 28, 2020

Today's Agenda

- **Welcome**
- **Virtual Meeting Instructions**
- **Opening Remarks**
- **Presentation: Preferred Concept**
- **Public Questions & Comments**
- **Next Steps**

Virtual Meeting Instructions

- Presentation is being recorded and will be posted online
- Participants automatically muted
- Chat window available for questions or help
 - Questions may be submitted via chat at any time and will be addressed during public Q&A
- Participants can be removed for inappropriate behavior

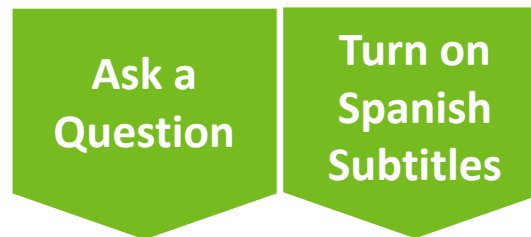

Bottom Panel of
Zoom Screen

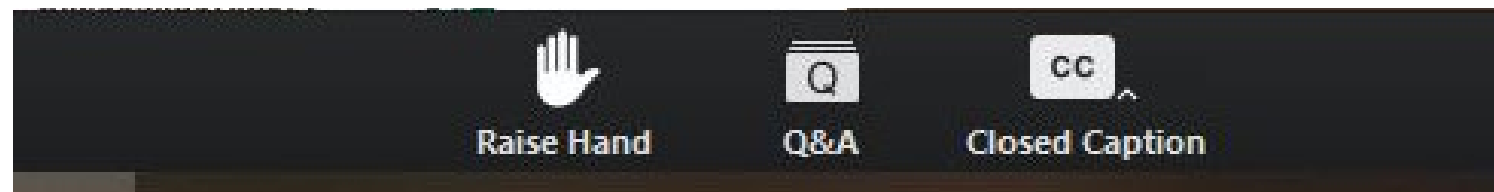

Opening Remarks

- **Mayor Jorge Elorza**

Opening Remarks

- **Council President Sabina Matos**

Corridor History: The Woonasquatucket River Greenway

- **1994:**
 - Fred Lippitt, Chair of the Providence Plan, creates Woonasquatucket River Greenway Project (WRGP), to help revitalize Olneyville
 - ✓ Most economically challenged neighborhood in PVD
 - ✓ No safe parks
 - ✓ 60% of people do not own cars
- **1998:**
 - Woonasquatucket River designated an American Heritage River
- **2001:**
 - Woonasquatucket River Watershed Council (WRWC) created



Corridor History: The Woonasquatucket River Greenway

- **2001:**
 - First on-road segment of Greenway completed from Providence Place to Valley Street
- **2006 - 2014:**
 - Kinsley Ave to Lyman Ave in Johnston off-road sections completed
 - Buttonhole Golf Course off-road
 - Eagle Square off-road
 - Donigian Park off-road
 - Woonasquatucket Adventure Park off-road
- **Today:**
 - 75 acres of parkland created along river
 - 6 well used public parks created or revitalized
 - 7 miles of on-road/off-road Greenway in Providence and Johnston
 - Invasive plants managed on all 7 miles
 - Red Shed Bike Camp teaches 100 kids to ride on Greenway every summer
 - Leveraged over \$120M for Greenway, Parks



Corridor History: The Woonasquacket River Greenway

- Transforming Public Spaces



Corridor History: The Woonasquatucket River Greenway



Corridor History: The Woonasquatucket Vision Plan (2018)

OVERALL ILLUSTRATIVE PLAN

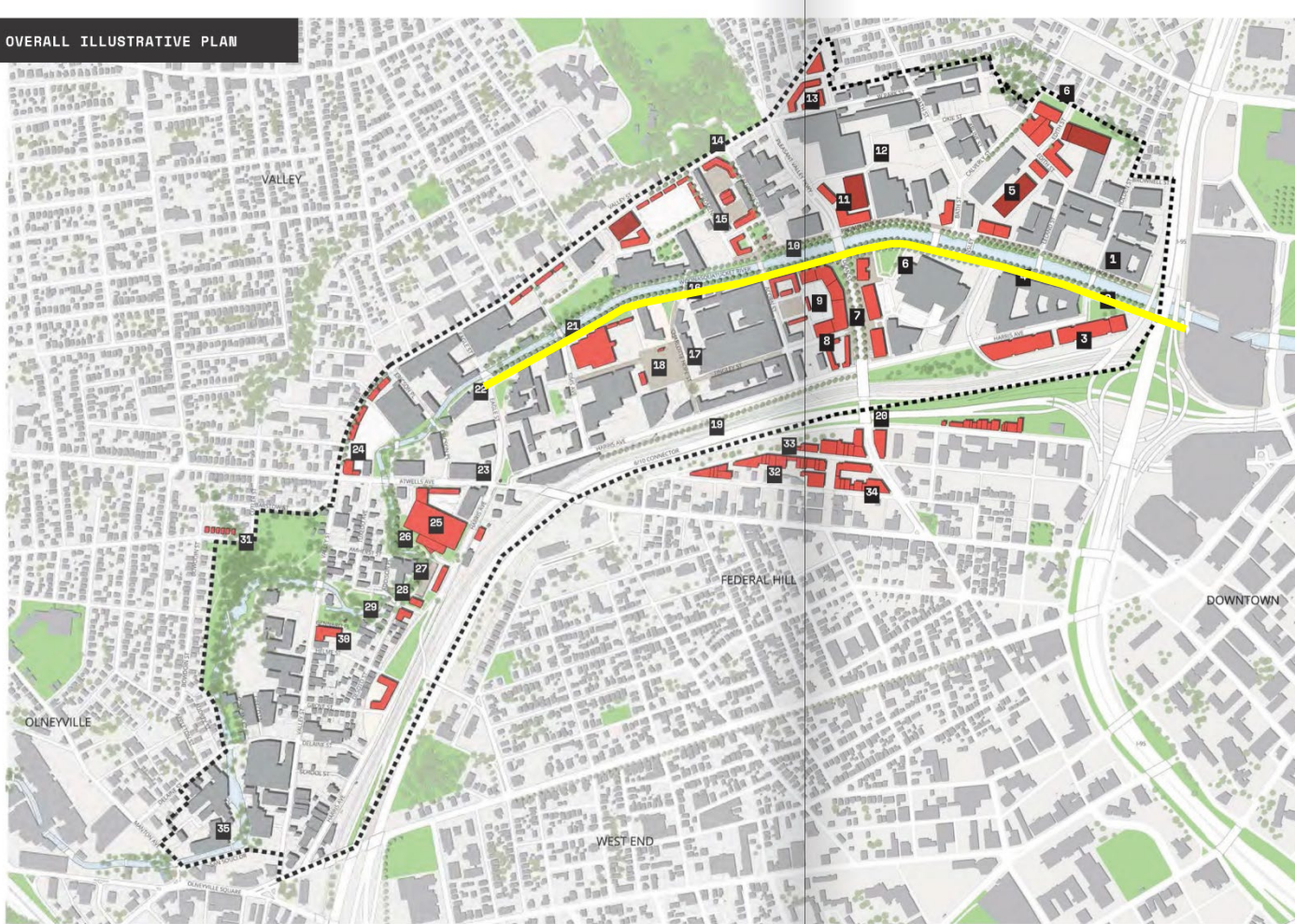

■ Vision Plan Goals:

- Improve Sustainability and Resiliency
- Support and Grow the Existing Economic Cluster around Arts, Food, and Makers
- Preserve and Create Affordable Space
- Improve Access and Connectivity
- Enhance and Maintain Public Spaces

Scope and Schedule

- **Project themes**

- Improve safety of people walking and riding bicycles
- Enhance access to the river
- Improve connectivity between Olneyville, Valley, Smith Hill and Downtown
- Mitigate flooding and improve water quality

- **Community Engagement**

- **Process**

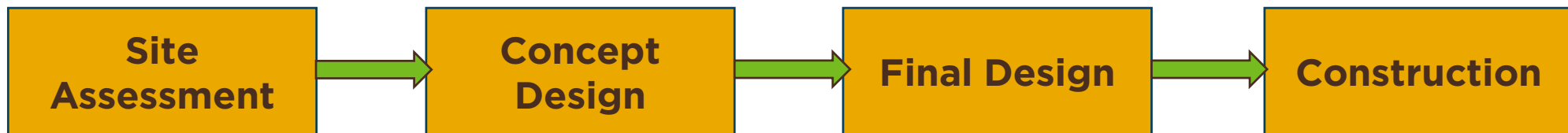

Scope and Schedule

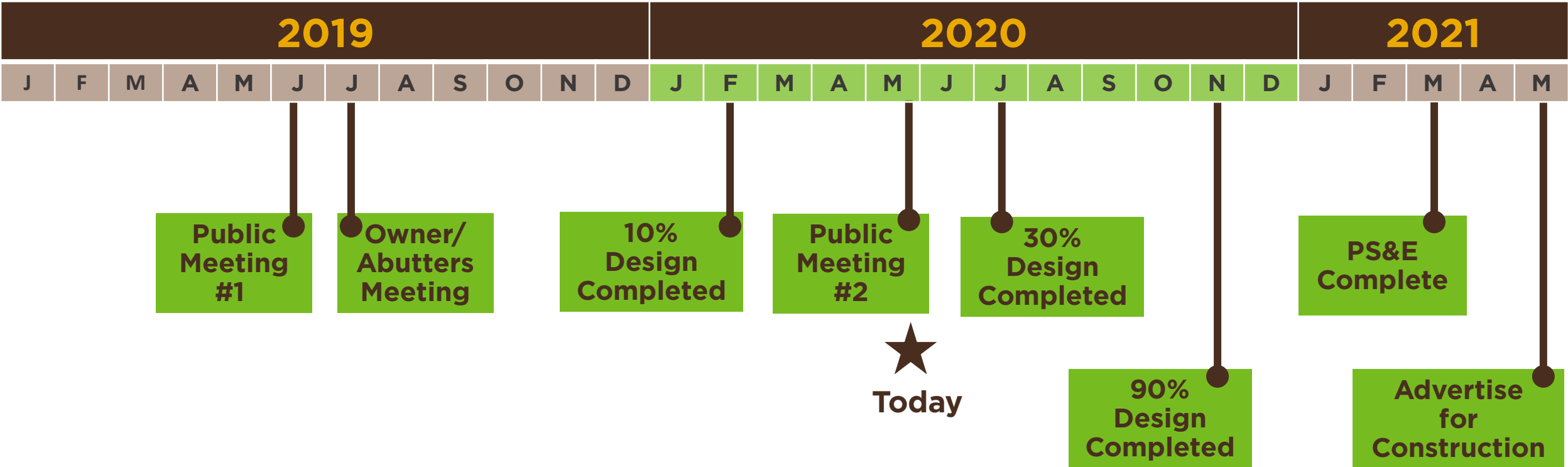

Preferred Concept - Rendering



Preferred Concept - Engineering Plans

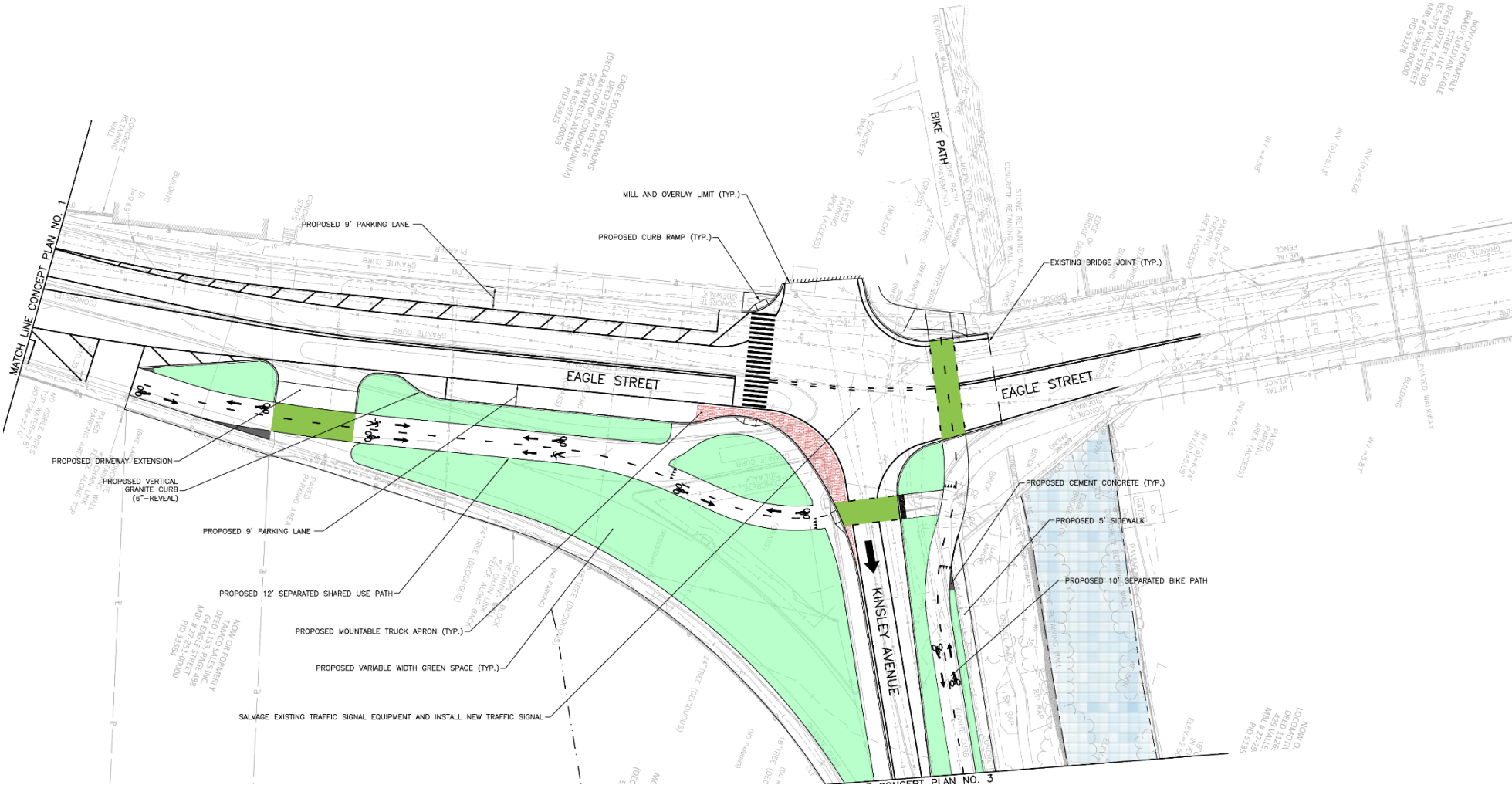

Community Green Space



Two-way separated Bicycle Facility

Preferred Concept - Engineering Plans

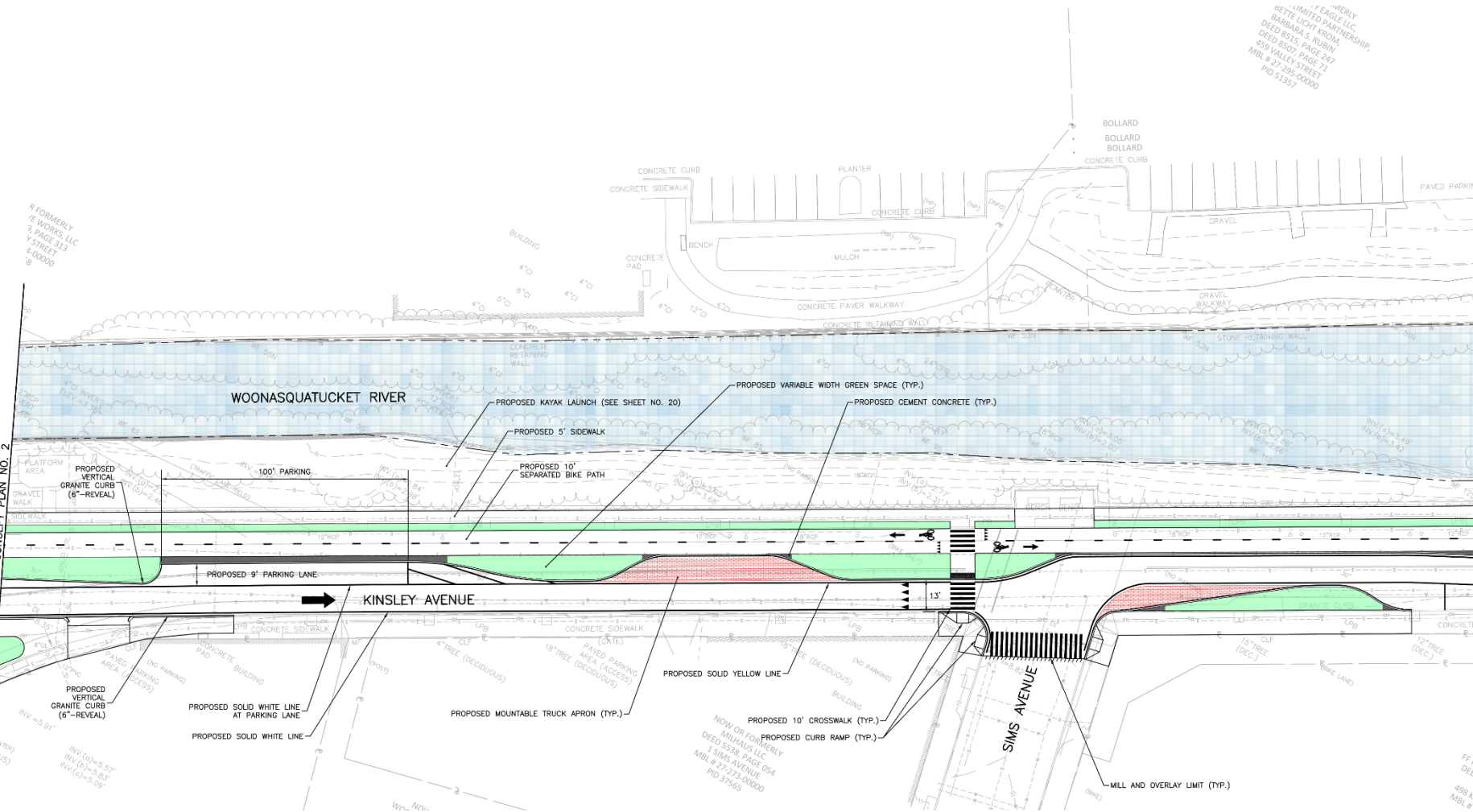

Crosswalks



Chicane

Preferred Concept - Engineering Plans

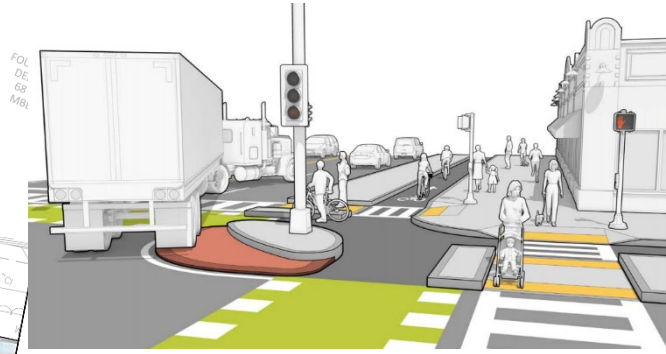
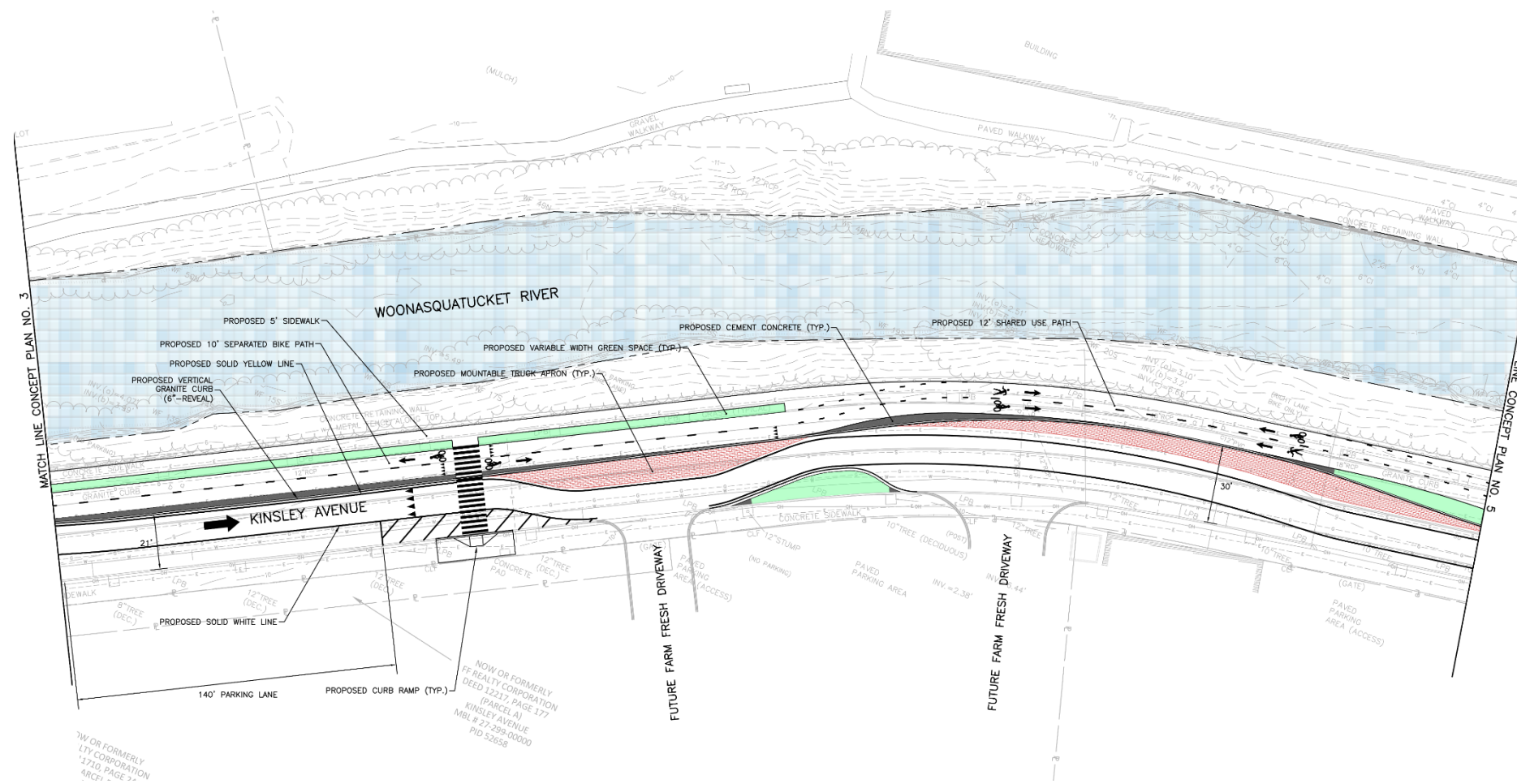

Truck Apron



Shared-use Path

Preferred Concept - Engineering Plans

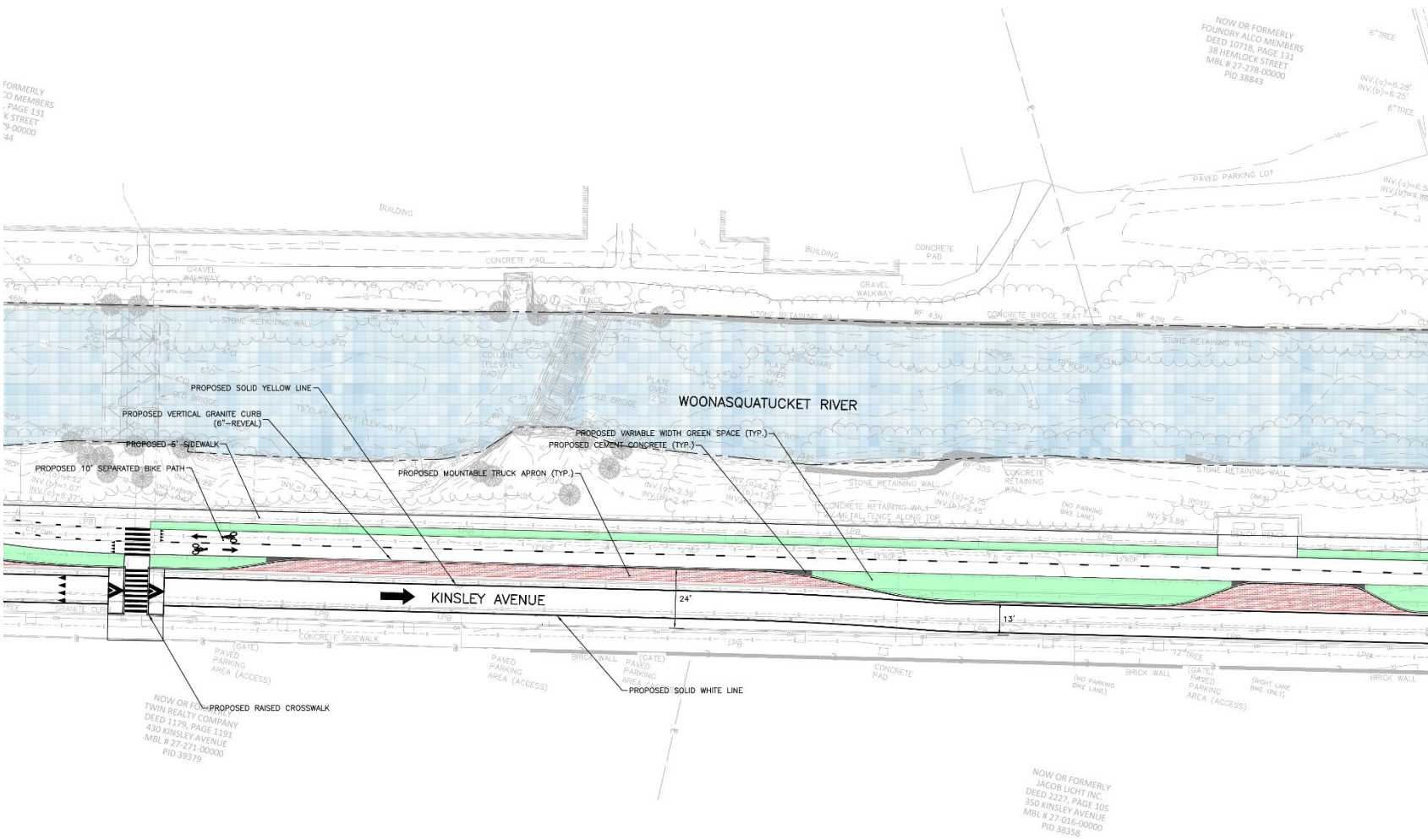

Raised Crosswalk



New Sidewalk

Preferred Concept - Engineering Plans

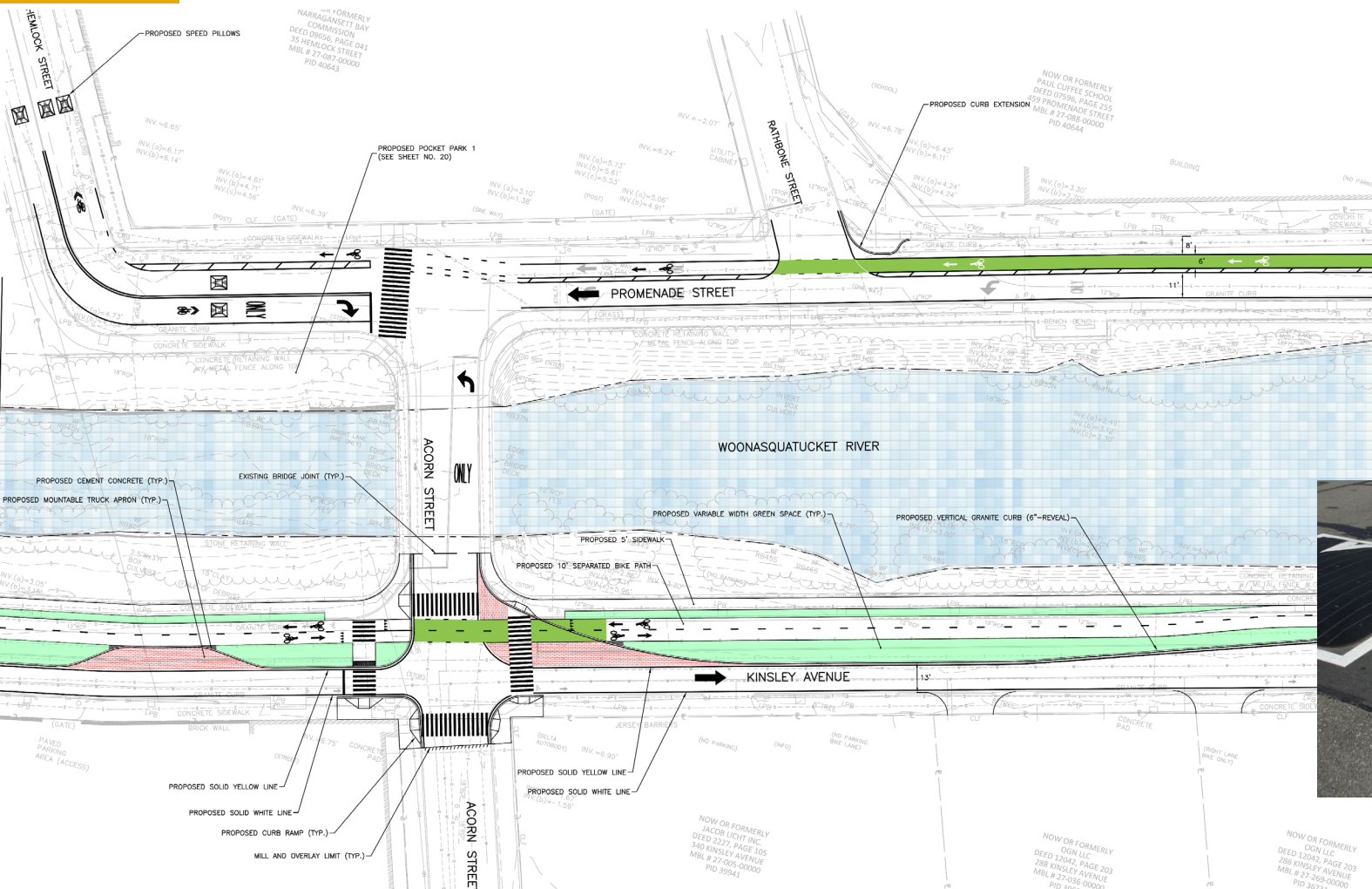

Curb Extensions



Speed Pillows



Green Pavement Markings in the Bicycle Lane

Preferred Concept - Engineering Plans

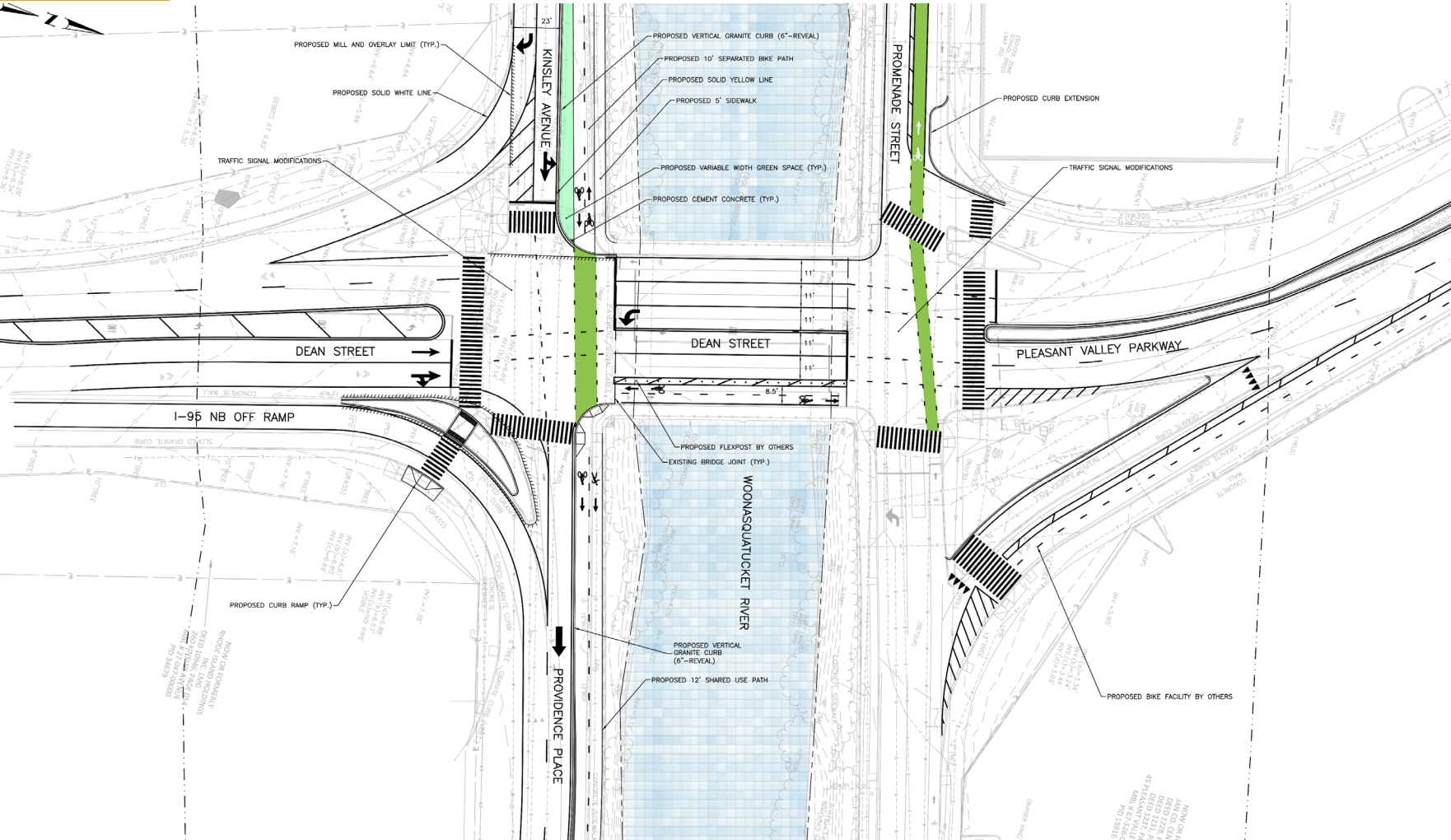

Green Pavement Markings in the Bicycle Crossing

Preferred Concept - Engineering Plans

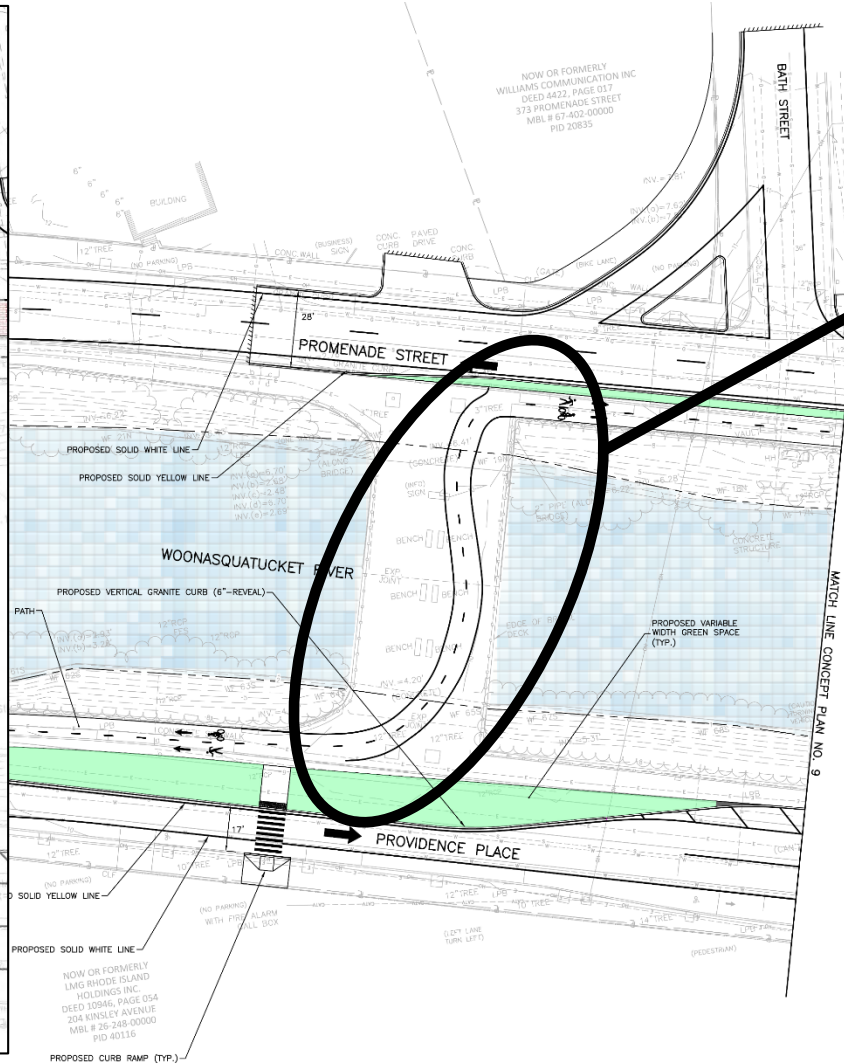
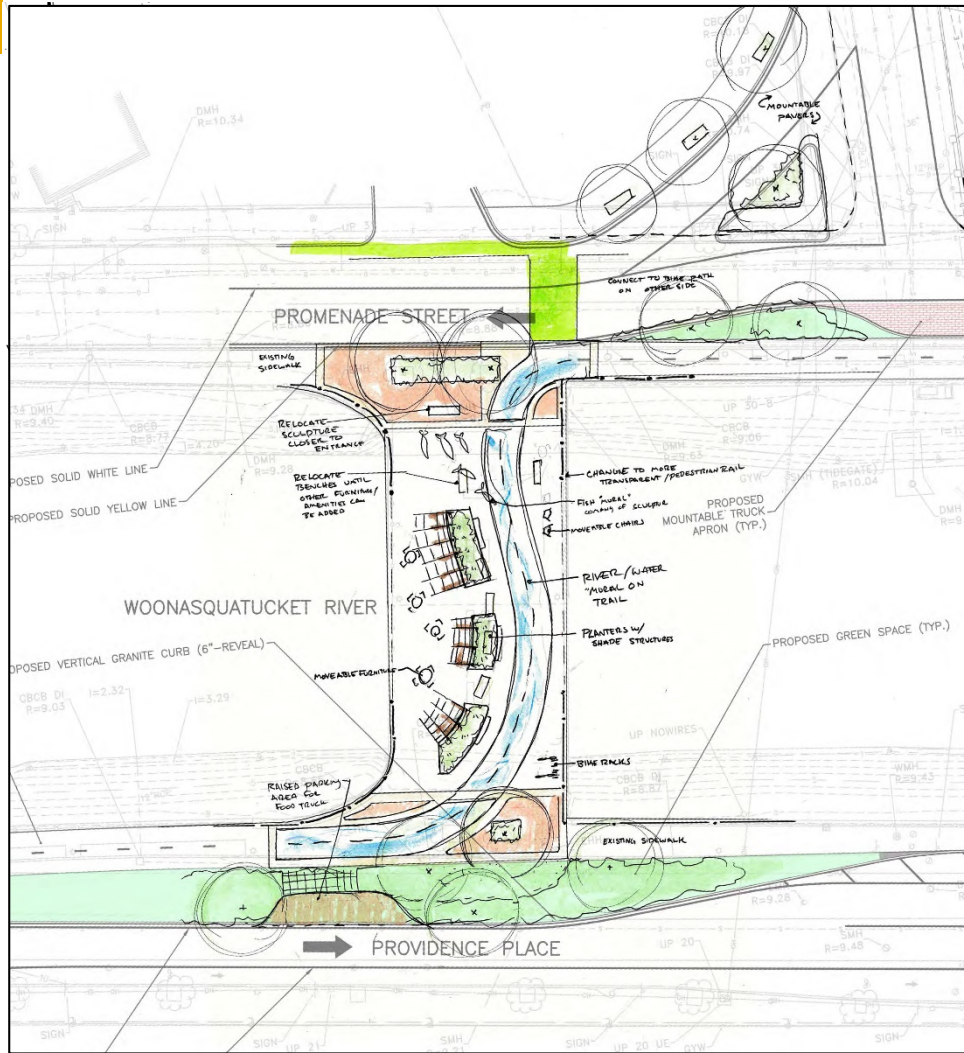

Crossing of Path over Sculpture Bridge

Preferred Concept - Engineering Plans

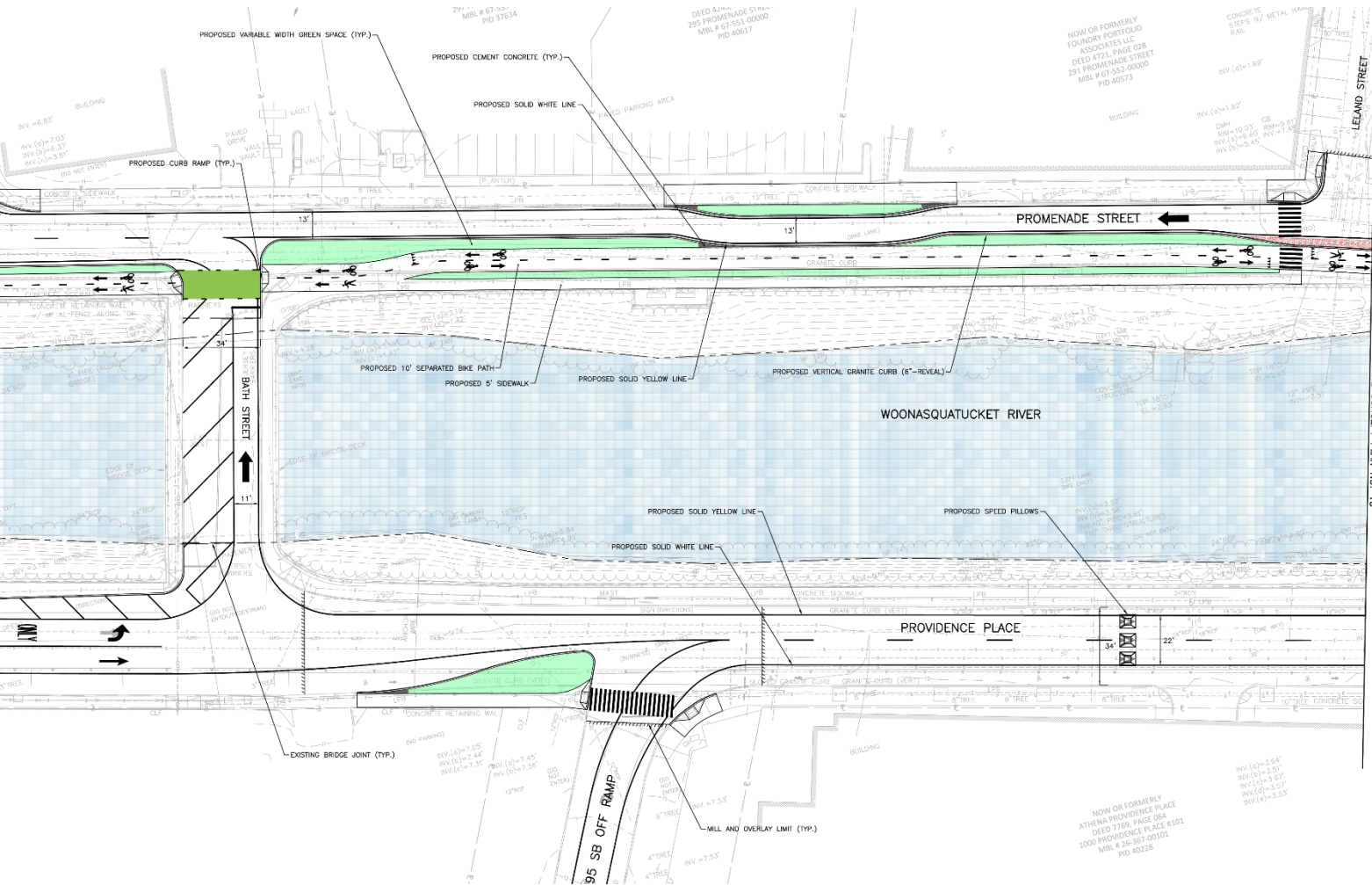

Green Buffer Space

Preferred Concept - Engineering Plans

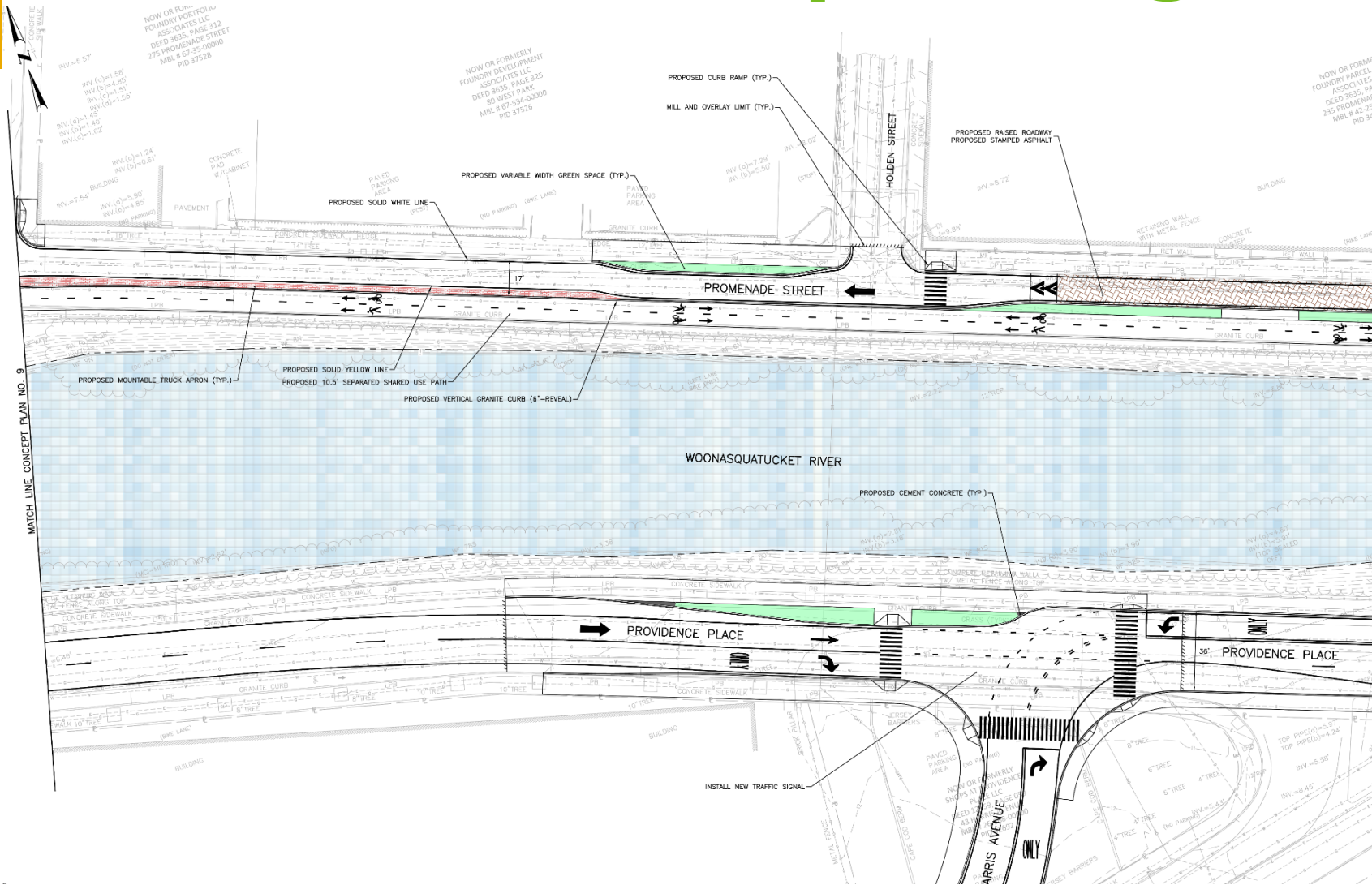

Raised Roadway

Preferred Concept - Engineering Plans

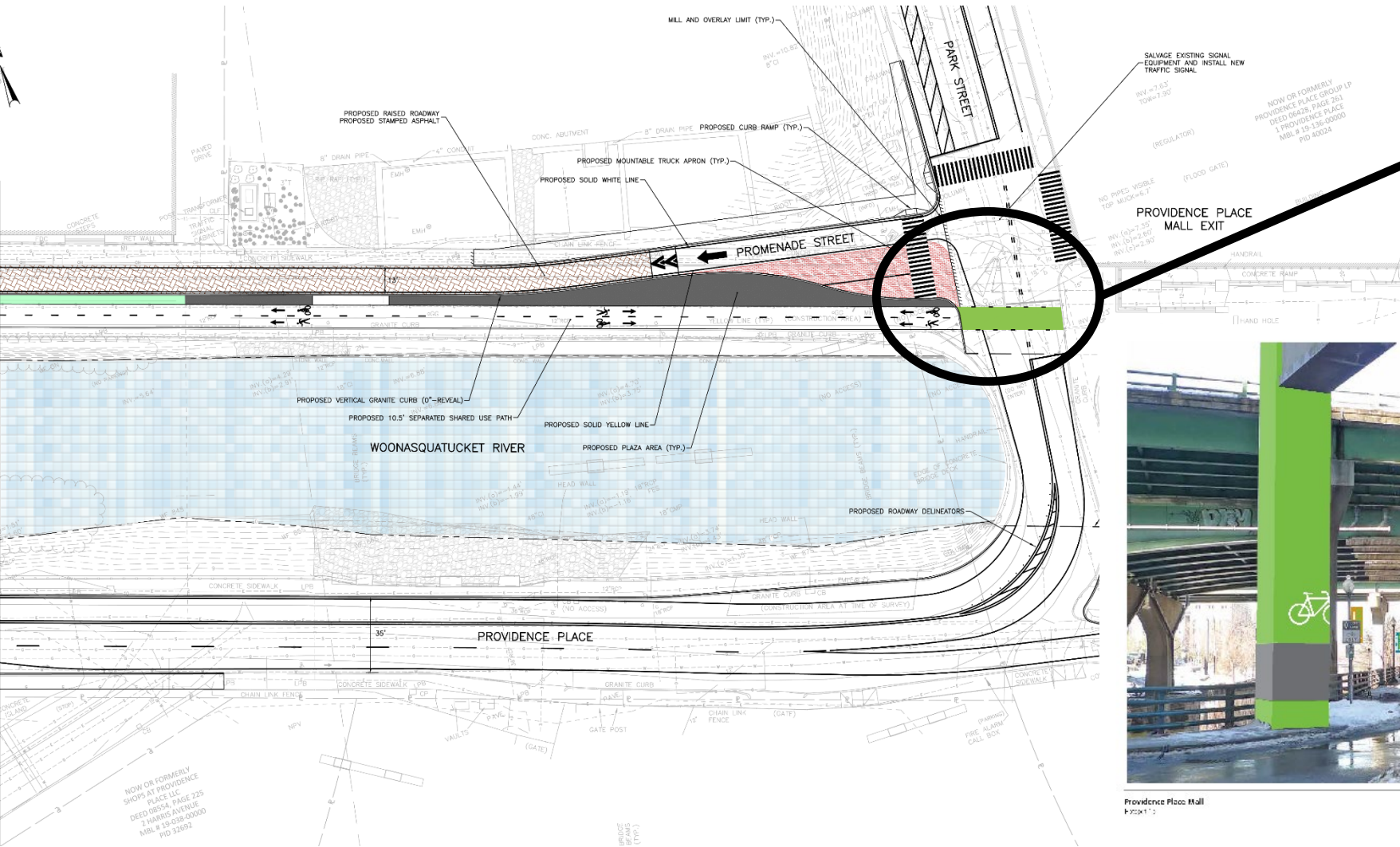

Start of proposed facility



Providence Place Mall Exit

Woonasquatucket River Greenway

Bill Estes & Associates

Preferred Concept - Engineering Plans

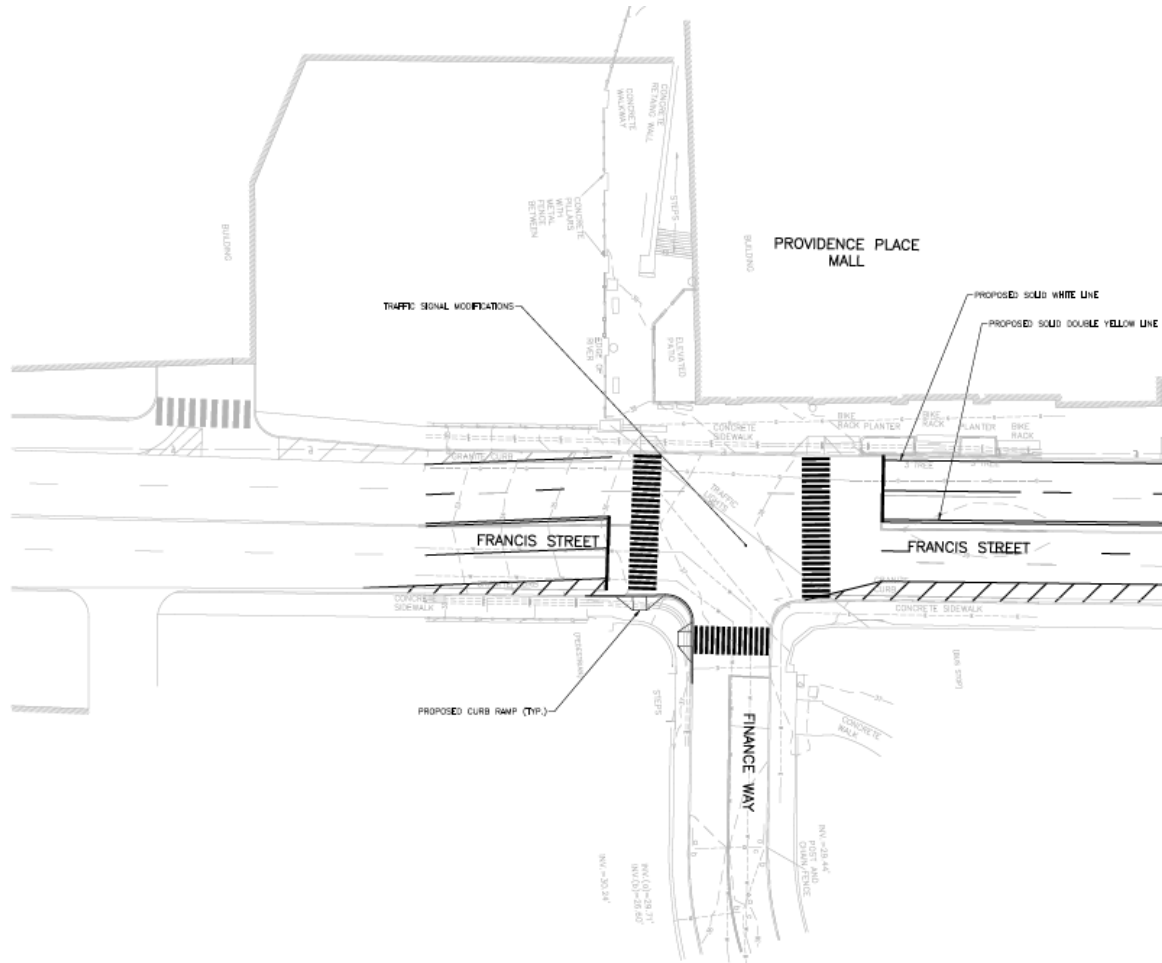

Pedestrian Curb Ramps



Pedestrian Signal Heads

Preferred Concept - WRWC Wayfinding Signage

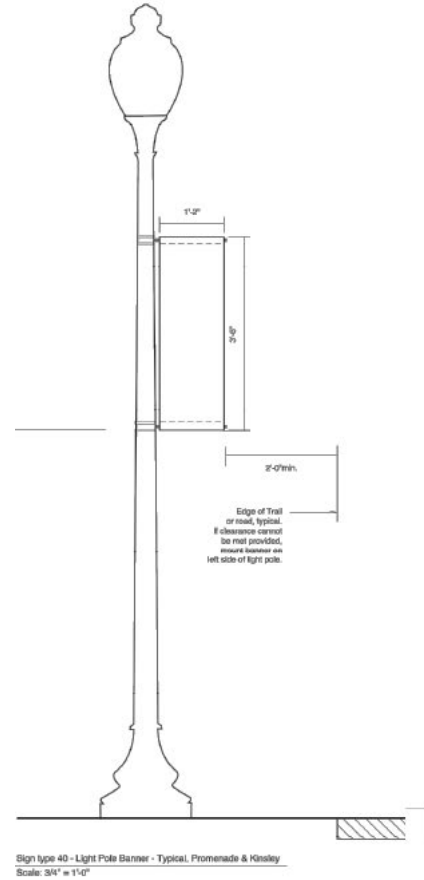

Sign type 40 - Layout Set 1
Scale: 3/4" = 1'-0"



B



Sign type 40 - Layout Set 2
Scale: 3/4" = 1'-0"



B



Sign type 40 - Layout Set 3
Scale: 3/4" = 1'-0"



B



Sign type 40 - Layout Set 4
Scale: 3/4" = 1'-0"



B

Preferred Concept - Green Infrastructure

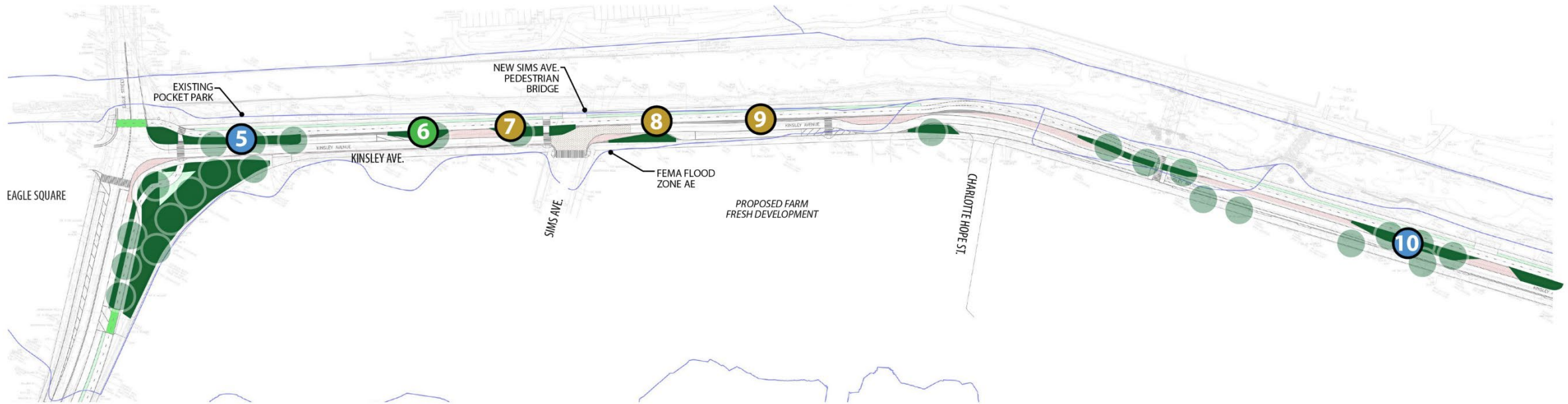

GREEN INFRASTRUCTURE KEY:

- PAVEMENT TRANSFORMED INTO GREEN SPACE
- UNDERGROUND FILTER
- TREE TRENCH
- OTHER
- BIORETENTION
- PROPOSED CANOPY TREE





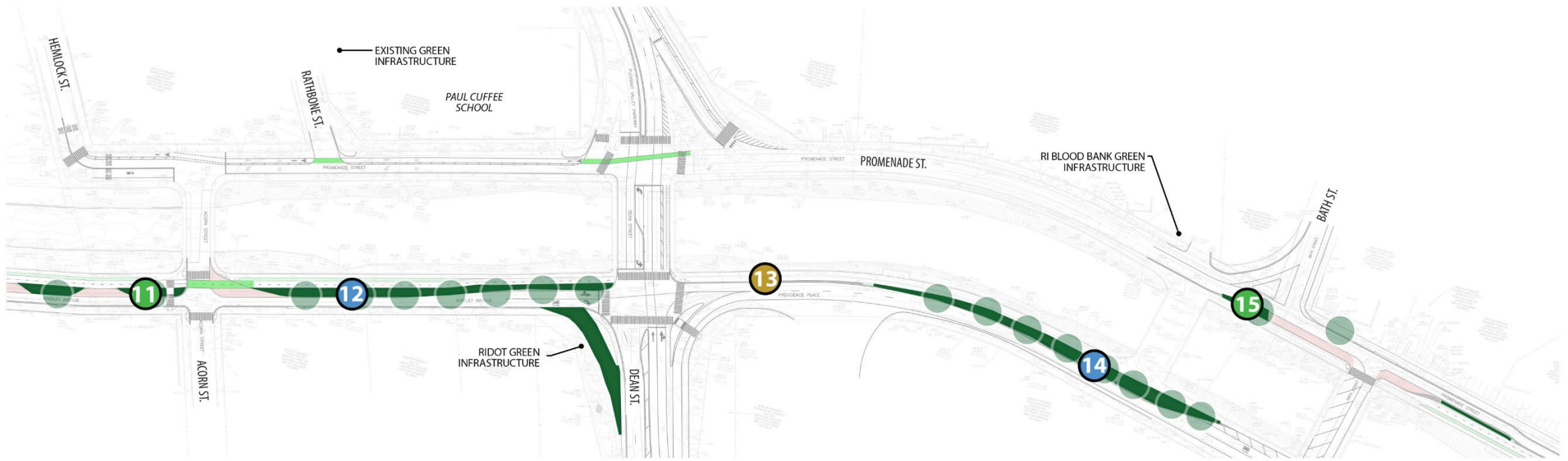

NOTES:

1. Existing conditions survey is still in progress and utility data requires verification.
2. Green infrastructure opportunities are shown at a conceptual planning level. Further infrastructure investigation, soil analysis and budget prioritization is required to determine feasibility and selection of specific practices.

Preferred Concept - Green Infrastructure



GREEN INFRASTRUCTURE KEY:

- | | | | |
|---|---------------------------------------|---|----------------------|
|  | PAVEMENT TRANSFORMED INTO GREEN SPACE |  | UNDERGROUND FILTER |
|  | TREE TRENCH |  | OTHER |
|  | BIORETENTION |  | PROPOSED CANOPY TREE |



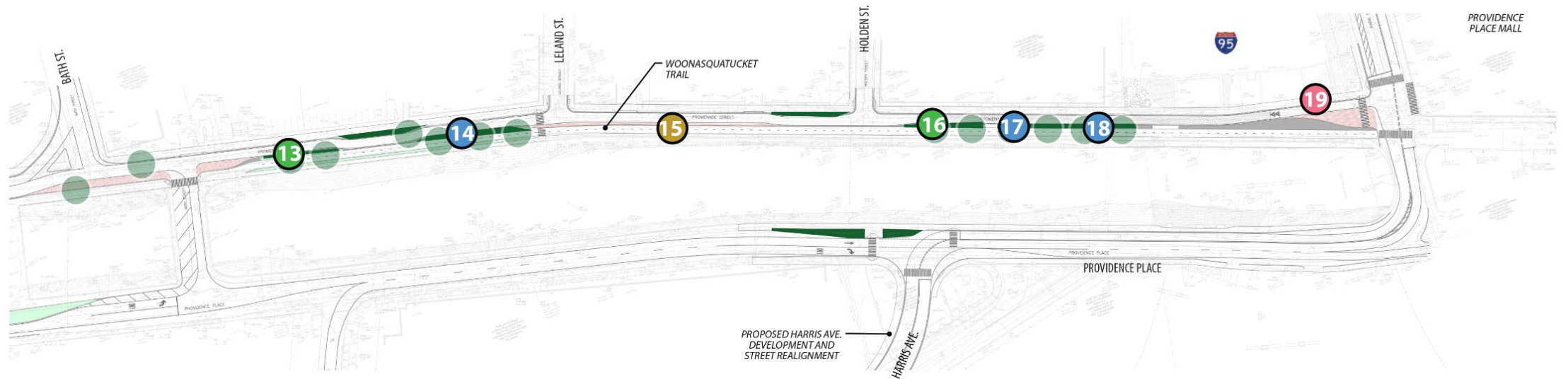

NOTES:

- Existing conditions survey is still in progress and utility data requires verification.
- Green infrastructure opportunities are shown at a conceptual planning level. Further infrastructure investigation, soil analysis and budget prioritization is required to determine feasibility and selection of specific practices.

Preferred Concept - Green Infrastructure



GREEN INFRASTRUCTURE KEY:

- | | | | |
|---|---------------------------------------|---|----------------------|
|  | PAVEMENT TRANSFORMED INTO GREEN SPACE |  | UNDERGROUND FILTER |
|  | TREE TRENCH |  | OTHER |
|  | BIORETENTION |  | PROPOSED CANOPY TREE |

NOTES:

- Existing conditions survey is still in progress and utility data requires verification.
- Green infrastructure opportunities are shown at a conceptual planning level. Further infrastructure investigation, soil analysis and budget prioritization is required to determine feasibility and selection of specific practices.

Preferred Concept - Green Infrastructure

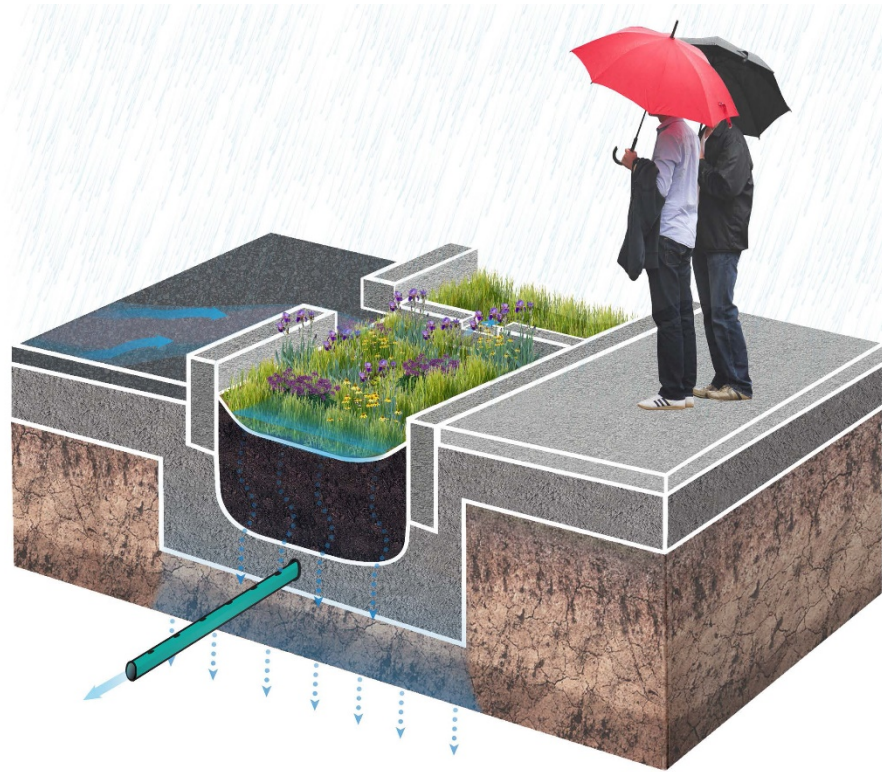

Bioretention



In Action: <https://www.facebook.com/WRWCRI/videos/1095476834142109/>

Preferred Concept - Green Infrastructure

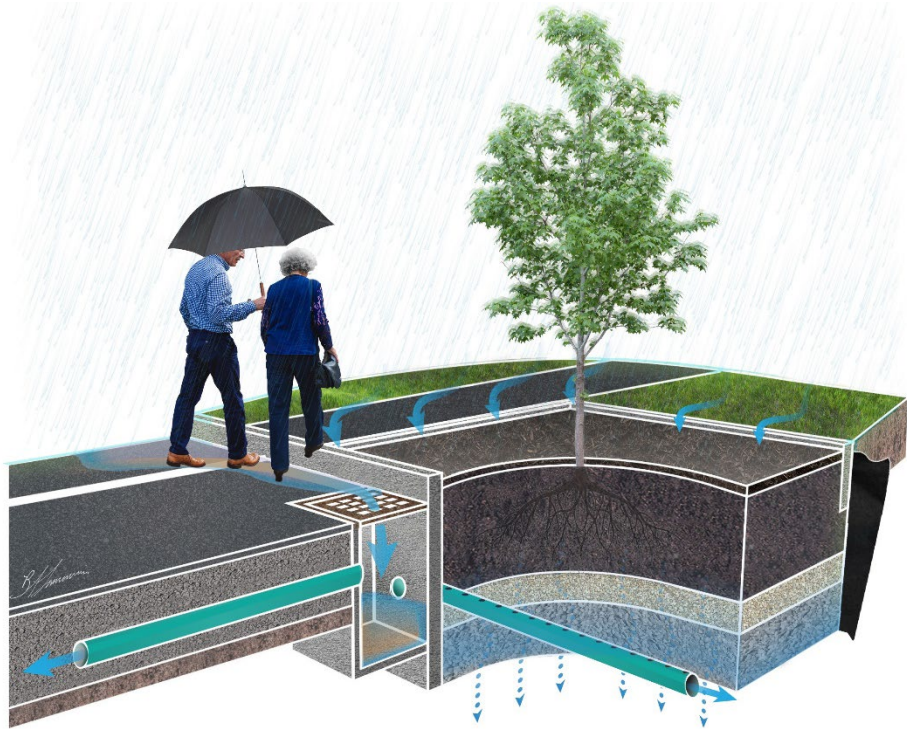

Tree Trench



Preferred Concept - Placemaking

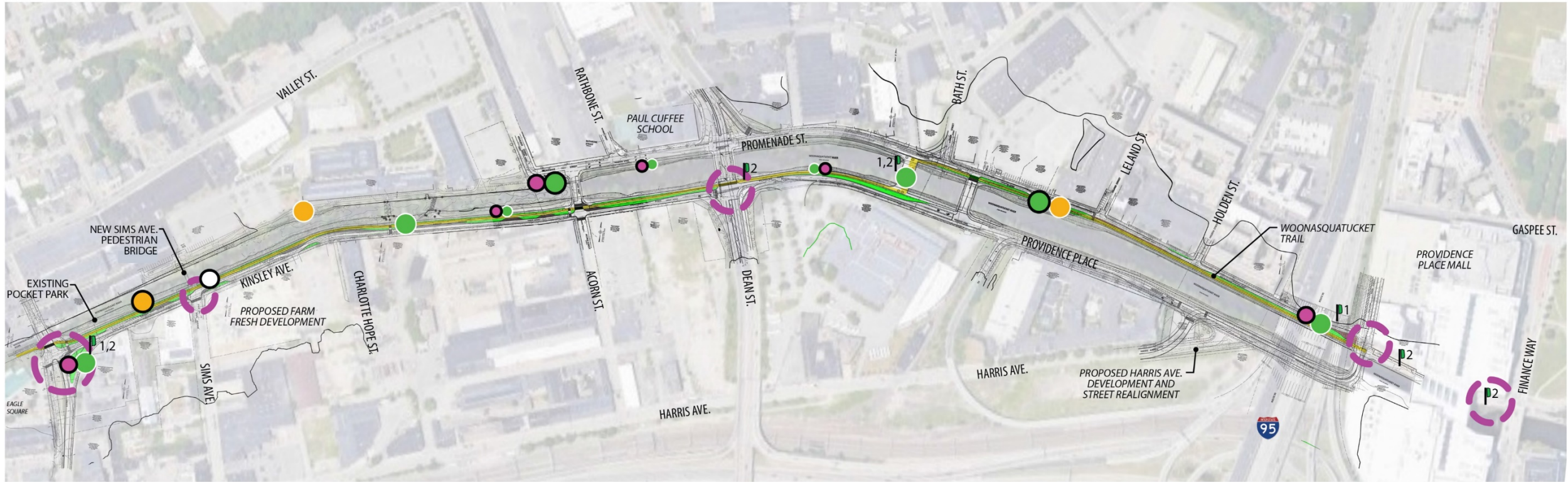

- POCKET PARKS
- FUTURE POCKET PARKS
- KAYAK LAUNCH
- FUTURE KAYAK LAUNCH
- P ORIENTATION / INFORMATIONAL SIGN
- ART LOCATIONS
- MARBLE TRAIL START
- NODES / GATEWAYS

NOTE: Map shows preliminary Phase 1 Placemaking locations. Subject to change per design development and regulatory coordination.

1. Wayfinding Kiosk
2. Directional Signage

PHASE 1 PLACEMAKING MAP

Preferred Concept - Placemaking

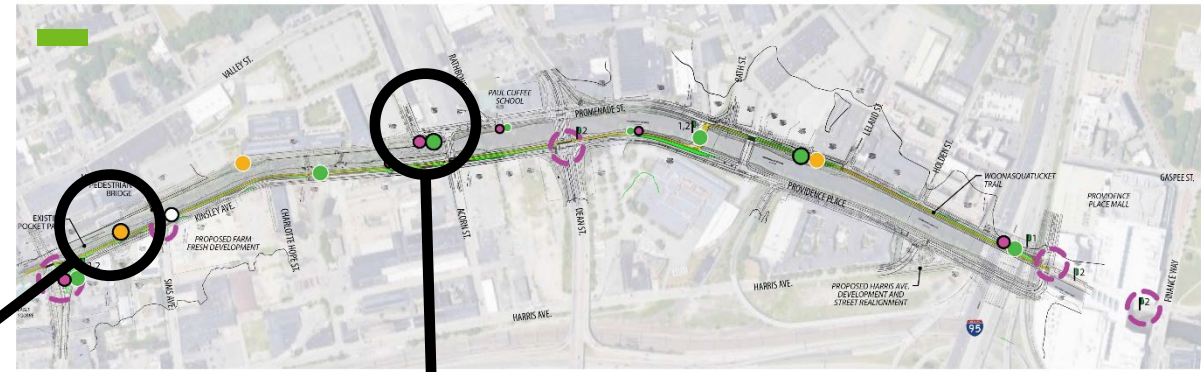

- POCKET PARKS
- FUTURE POCKET PARKS
- KAYAK LAUNCH
- FUTURE KAYAK LAUNCH
- ORIENTATION / INFORMATIONAL SIGN
- ART LOCATIONS
- MARBLE TRAIL START
- NODES / GATEWAYS

s preliminary Phase 1 Placemaking locations. Subject

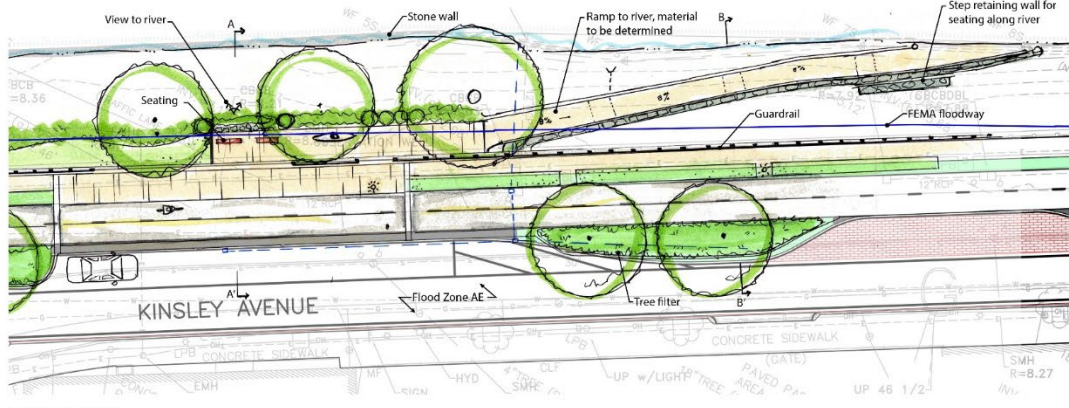

KAYAK LAUNCH

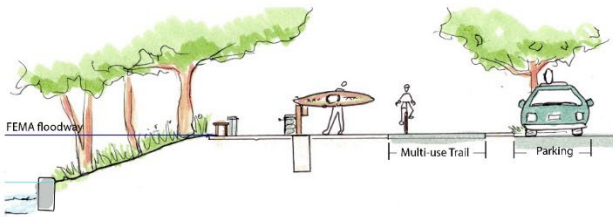

SECTION A-A'

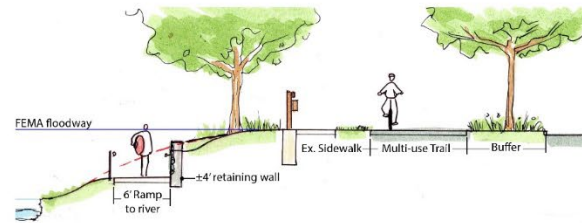

SECTION B-B'

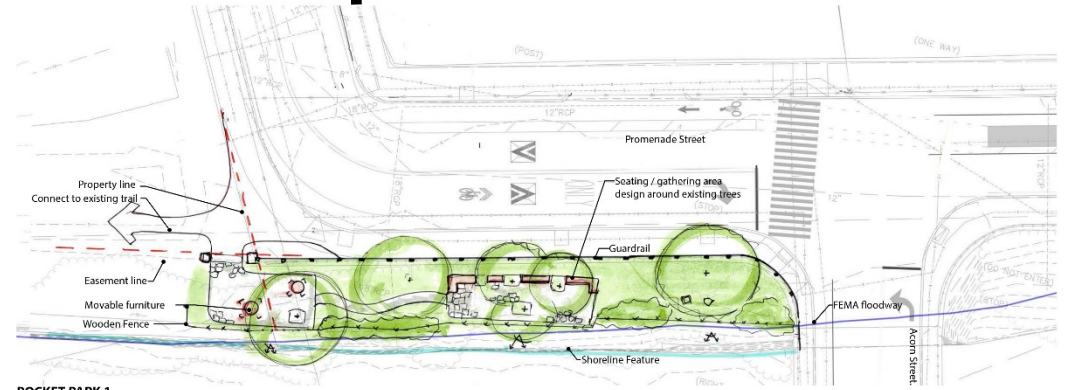

POCKET PARK 1

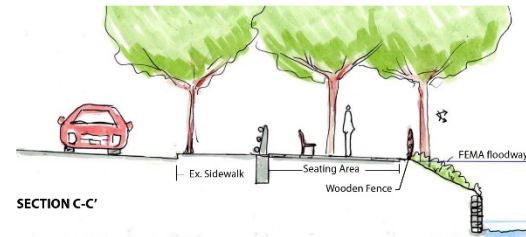

SECTION C-C'

Kayak Launch Kinsley Avenue

Pocket Park Hemlock Street & Promenade Street

Preferred Concept – Public Art

Under the I-95 overpass at Promenade and Park



Landscaping with natural and found elements along the



Greenway Arts Opportunity



The decommissioned support platform in the river under the I-95 overpass



The Eagle Square Green



Under the Mall



Pocket Park at Promenade and Hemlock



Public Questions & Comment

Next Steps

- **Public feedback on preferred concept**
- **Final design**

Closing

THANK YOU!

Alicia Lehrer, Executive Director, WRWC
Jessica Pflaumer, AICP, City of Providence

QUESTIONS?

jpflaumer@providenceri.gov
(401) 680-8400 | Ext: 8519

<http://www.providenceri.gov/planning/woonasquatucket/>

WOONASQUATUCKET
RIVER GREENWAY



WOONASQUATUCKET
RIVER
GREENWAY



WOONASQUATUCKET RIVER
WATERSHED COUNCIL