

5. CASE 21.054, 12 & 14 GEORGE STREET, Adams House, pre-1857 (COLLEGE HILL)

3 ½ stories; stuccoed, flank-gable; double-house, six bays wide with a double recessed entry in the center. The entries are filled with a classical enframing with channeled pilasters, an entablature with a dentil course, transoms and sidelights.

CONTRIBUTING

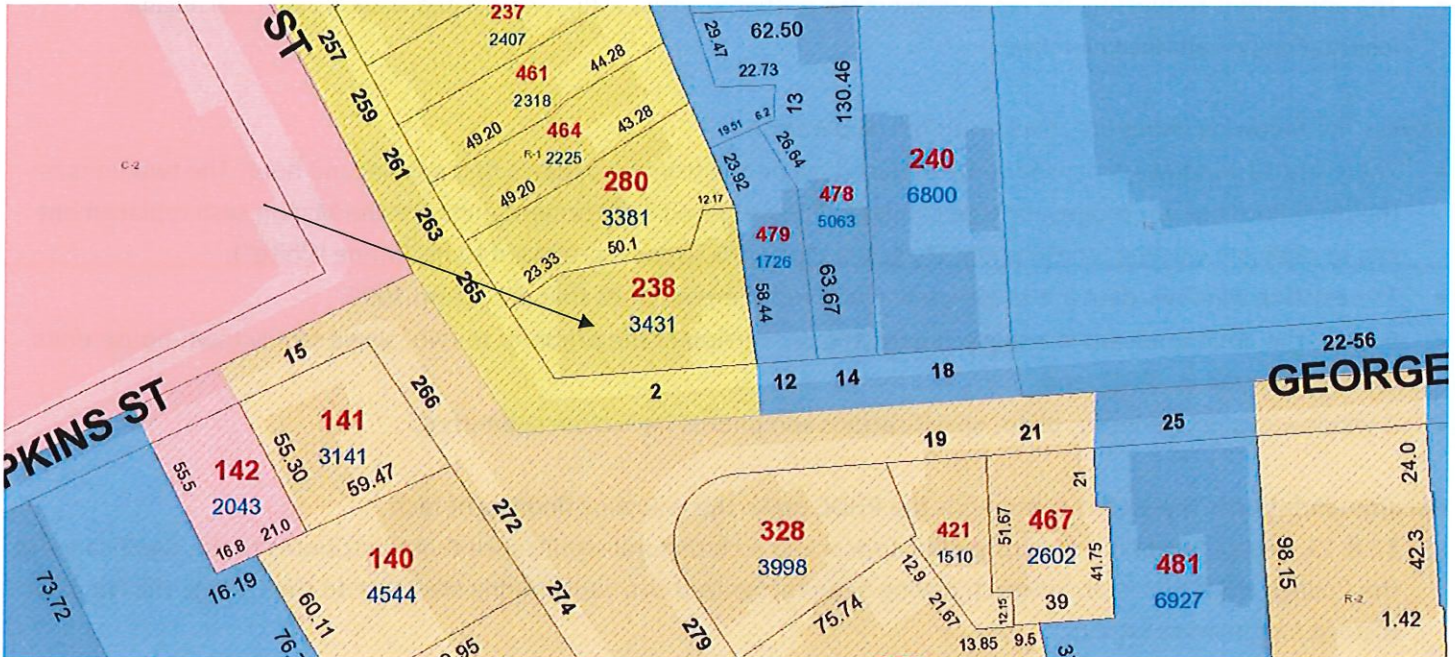

Arrow indicates 12 & 14 George Street.

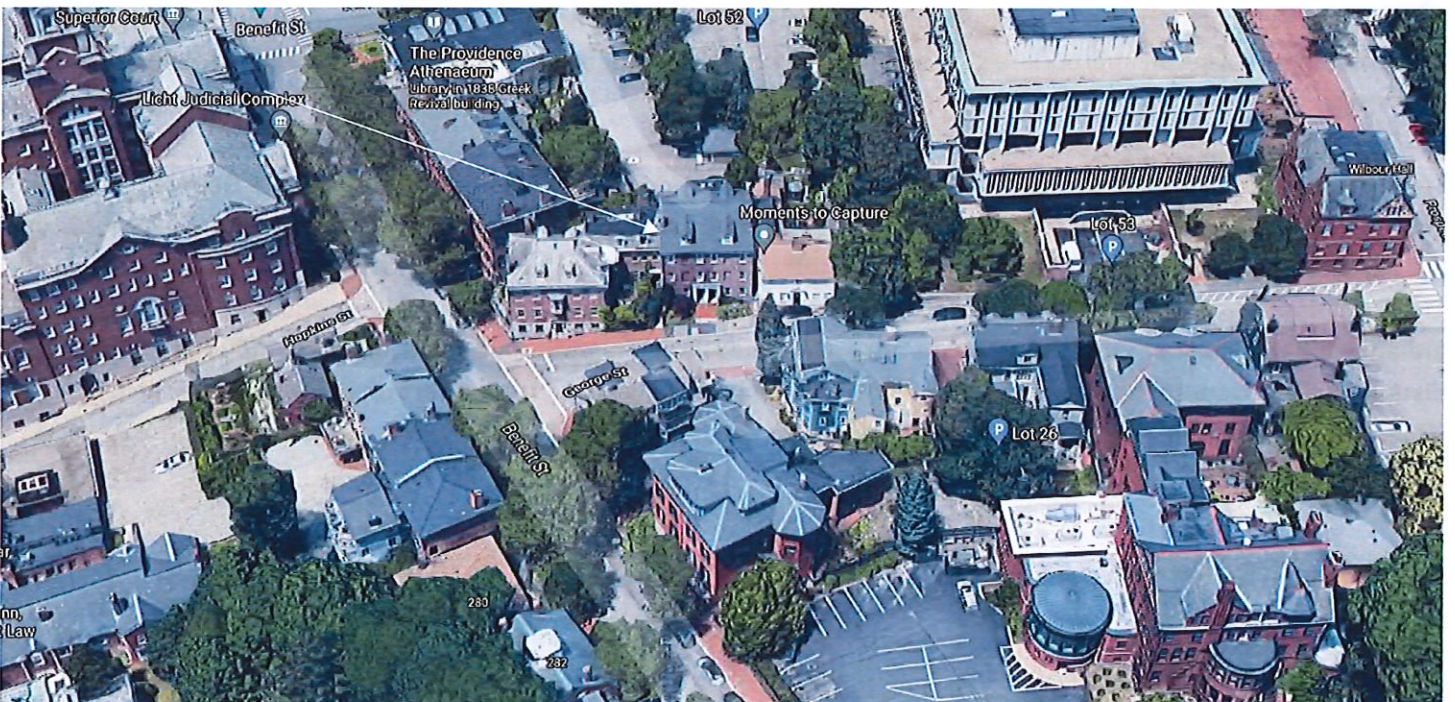

Arrow indicates project location, looking north.

Applicant/ Owner:

Architect:

Proposal: The scope of work proposed consists of Major Alterations and includes:

- The applicant is requesting the replacement of the existing windows with new insulated windows to match original fenestration (see attached narrative).

Issues: The following issues are relevant to this application:

- There are 12 windows proposed to be replaced, all on the front elevation's first and second floor. The two units on the third floor are not proposed to be changed. The proposed replacement units are the Marvin sash replacement kits to replicate existing fenestration. These are clad units (color is proposed to be "Stone White");
- The existing windows date are single-pane wood replacement units that date from 1999.
- Each of the double-houses is a single-family (the conversion of the property to two, single family town-house units were formalized in 2000); and,
- A window evaluation letter, plans, specifications and photos have been submitted.

Recommendations: The staff recommends the PHDC make the following findings of fact:

- a) 12 & 14 George Street is a structure of historical and architectural significance that contributes to the significance of the College Hill local historic district, having been recognized as a contributing structure to the College Hill National Historic Landmarks District;
- b) The application for Major Alterations is considered complete; and,
- c) The work as proposed is in accord with PHDC Standard 8 as follows: as the proposed alterations are appropriate having determined that the proposed construction is architecturally and historically compatible with the property and district having an appropriate size, scale and form that will not have an adverse effect on the property or district.

Staff recommends a motion be made stating that: The application is considered complete. 12 & 14 George Street is a structure of historical and architectural significance that contributes to the significance of the College Hill local historic district, having been recognized as a contributing structure to the College Hill National Historic Landmarks District. The Commission grants Final Approval of the proposal as submitted having determined that the proposed alterations are appropriate as the proposed alterations are architecturally and historically compatible with the property and district having an appropriate size, scale and form that will not have an adverse effect on the property or district, citing and agreeing to the recommendations in the staff report, with staff to review any additional required details.

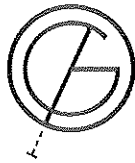

G. S. SEVIGNY
C O N S T R U C T I O N

Residential Commercial
(401) 265-5054
gssevigny@gmail.com

May 31, 2021

To Whom It May Concern;

I have been asked to evaluate the condition of the windows at 12 and 14 George Street in Providence. I am a registered General Contractor in the State of Rhode Island, Registration #42508. I am also a Licensed Construction Supervisor in the State of Massachusetts, License #CS 067740. I have 32 years of experience in the construction industry, participating in every facet of a family owned General Contracting business. Currently, I own and operate G. S. Sevigny Construction Inc. During this time I have had the opportunity to be a part of several historic renovations.

Upon examining the windows in question, I discovered that there were no original or historic window sash or jambs. All windows had been previously replaced with windows of 1990's vintage. All windows in question have some form of structural deterioration, most notably rotted sills. In my opinion these windows should be replaced with new construction type windows compliant with the PHDC, as windows are vital to a buildings overall health

Sincerely,

Greg Sevigny
President
G. S. Sevigny Construction Inc.

Gordon, George -12 George Street Marvin Clad, 4/8/21

Quote #: ZXDHBD3

A Proposal for Window and Door Products prepared for:

Job Site:

02919

Shipping Address:

HUMPHREYS MARVIN BUILDING CTR

590 MAIN RD

TIVERTON, RI 02878-1300

Project Description:

Per site visit by KJB and TPB on 3/30/21.

Featuring products from:

MARVIN 

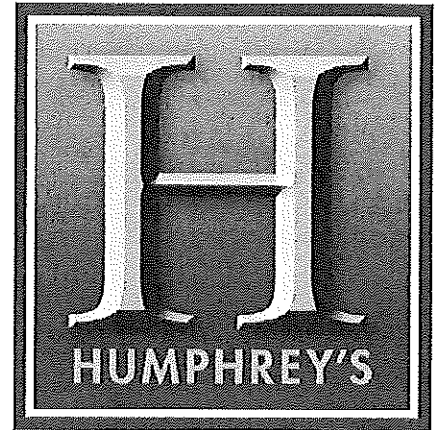

TOM BROOKS
HUMPHREYS MARVIN BUILDING CTR
590 MAIN RD
TIVERTON, RI 02878-1300

Email: tomb@hbsri.com

This report was generated on 4/8/2021 4:00:27 PM
using the Marvin Order Management System,
version 0003.07.00 (Current). Price in USD. Unit
availability and price are subject to change. Dealer
terms and conditions may apply.

UNIT SUMMARY

The following is a schedule of the windows and doors for this project. For additional unit details, please see Line Item Quotes.

Additional charges, tax or Terms and Conditions may apply. Detail pricing is per unit.

NUMBER OF LINES: 3		TOTAL UNIT QTY: 12		EXT NET PRICE: USD 16,448.20		
LINE	MARK UNIT	PRODUCT LINE	ITEM	NET PRICE	QTY	EXTENDED NET PRICE
1	Front Windows -New Construct	Ultimate	Double Hung G2 RO 35" X 66" Entered as FS 34" X 65 1/2"	1,350.25	8	10,802.00
2	Library Windows	Ultimate	Double Hung G2 RO 35" X 66" Entered as FS 34" X 65 1/2"	1,272.42	2	2,544.84
3	Back Windows -Ground Level	Ultimate	Double Hung G2 RO 35" X 66" Entered as FS 34" X 65 1/2"	1,550.68	2	3,101.36

LINE ITEM QUOTES

The following is a schedule of the windows and doors for this project. For additional unit details, please see Line Item Quotes. Additional charges, tax or Terms and Conditions may apply. Detail pricing is per unit.

Line #1	Mark Unit: Front Windows -New Construct	Net Price:		1,350.25
Qty: 8		Ext. Net Price:	USD	10,802.00

MARVIN 

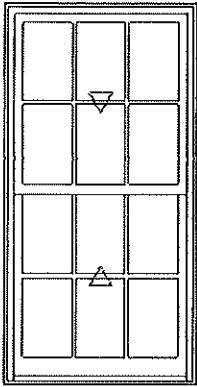

As Viewed From The Exterior

Entered As: FS
FS 34" X 65 1/2"
RO 35" X 66"
Egress Information
Width: 30 13/32" Height: 27 11/16"
Net Clear Opening: 5.85 SqFt
Performance Information
U-Factor: 0.3
Solar Heat Gain Coefficient: 0.27
Visible Light Transmittance: 0.46
Condensation Resistance: 56
CPD Number: MAR-N-425-17180-00001
ENERGY STAR: NC

Stone White Clad Exterior
Painted Interior Finish - White - Pine Interior
Ultimate Double Hung G2
Frame Size 34" X 65 1/2"
Rough Opening 35" X 66"
Top Sash
Stone White Clad Sash Exterior
Painted Interior Finish - White - Pine Sash Interior
IG
Low E2 w/Argon
Black Perimeter and Spacer Bar
5/8" SDL - With Spacer Bar - Black
Rectangular - Special Cut 3W2H
Stone White Clad Ext - Painted Interior Finish - White - Pine Int
Ogee Interior Glazing Profile
Bottom Sash
Stone White Clad Sash Exterior
Painted Interior Finish - White - Pine Sash Interior
IG
Low E2 w/Argon
Black Perimeter and Spacer Bar
5/8" SDL - With Spacer Bar - Black
Rectangular - Special Cut 3W2H
Stone White Clad Ext - Painted Interior Finish - White - Pine Int
Ogee Interior Glazing Profile
White Interior Weather Strip Package
White Exterior Weather Strip Package
Brass Sash Lock
Brass Top Sash Strike Plate Assembly Color
Aluminum Screen
Stone White Surround
Charcoal Fiberglass Mesh
***Screen/Combo Ship Loose
4 9/16" Jamb
Nailing Fin
***Note: Unit Availability and Price Is Subject to Change

Initials required

Seller: _____

Buyer: _____

Line #2	Mark Unit: Library Windows	Net Price:		1,272.42
Qty: 2		Ext. Net Price:	USD	2,544.84

MARVIN 

Stone White Clad Exterior
Primed Pine Interior
Ultimate Double Hung G2
Frame Size 34" X 65 1/2"
Rough Opening 35" X 66"
Top Sash
Stone White Clad Sash Exterior
Primed Pine Sash Interior
IG
Low E2 w/Argon
Black Perimeter and Spacer Bar
5/8" SDL - With Spacer Bar - Black

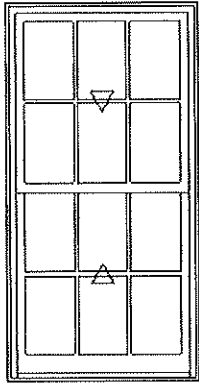

As Viewed From The Exterior

Entered As: FS
FS 34" X 65 1/2"
RO 35" X 66"

Egress Information

Width: 30 13/32" Height: 27 11/16"

Net Clear Opening: 5.85 SqFt

Performance Information

U-Factor: 0.3

Solar Heat Gain Coefficient: 0.27

Visible Light Transmittance: 0.46

Condensation Resistance: 56

CPD Number: MAR-N-425-17180-00001

ENERGY STAR: NC

Rectangular - Special Cut 3W2H
Stone White Clad Ext - Primed Pine Int
Ogee Interior Glazing Profile
Bottom Sash
Stone White Clad Sash Exterior
Primed Pine Sash Interior
IG
Low E2 w/Argon
Black Perimeter and Spacer Bar
5/8" SDL - With Spacer Bar - Black
Rectangular - Special Cut 3W2H
Stone White Clad Ext - Primed Pine Int
Ogee Interior Glazing Profile
White Interior Weather Strip Package
White Exterior Weather Strip Package
Brass Sash Lock
Brass Top Sash Strike Plate Assembly Color
Aluminum Screen
Stone White Surround
Charcoal Fiberglass Mesh
***Screen/Combo Ship Loose
4 9/16" Jamb

Nailing Fin
***Note: Unit Availability and Price is Subject to Change

Initials required

Seller: _____

Buyer: _____

Line #3	Mark Unit: Back Windows -Ground Level	Net Price:		1,550.68
Qty: 2		Ext. Net Price:	USD	3,101.36

MARVIN

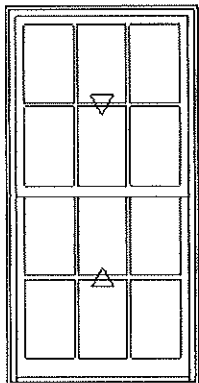

As Viewed From The Exterior

Entered As: FS
FS 34" X 65 1/2"
RO 35" X 66"

Egress Information

Width: 30 13/32" Height: 27 11/16"

Net Clear Opening: 5.85 SqFt

Performance Information

U-Factor: 0.45

Solar Heat Gain Coefficient: 0.48

Visible Light Transmittance: 0.51

Condensation Resistance: 43

CPD Number: MAR-N-425-17048-00029

Stone White Clad Exterior
Painted Interior Finish - White - Pine Interior
Ultimate Double Hung G2
Frame Size 34" X 65 1/2"
Rough Opening 35" X 66"
Glass Add For All Sash/Panels
Top Sash
Stone White Clad Sash Exterior
Painted Interior Finish - White - Pine Sash Interior
IG - 1 Lite
1/4" Laminated Interior-Clear Exterior - Not Safety
Black Perimeter Bar
5/8" SDL - No SBAR
Rectangular - Special Cut 3W2H
Stone White Clad Ext - Painted Interior Finish - White - Pine Int
Ogee Interior Glazing Profile
Bottom Sash
Stone White Clad Sash Exterior
Painted Interior Finish - White - Pine Sash Interior
IG - 1 Lite
1/4" Laminated Interior-Clear Exterior - Not Safety
Black Perimeter Bar
5/8" SDL - No SBAR
Rectangular - Special Cut 3W2H
Stone White Clad Ext - Painted Interior Finish - White - Pine Int
Ogee Interior Glazing Profile
White Interior Weather Strip Package
White Exterior Weather Strip Package
Brass Sash Lock
Brass Top Sash Strike Plate Assembly Color
Aluminum Screen
Stone White Surround
Charcoal Fiberglass Mesh
***Screen/Combo Ship Loose
4 9/16" Jamb
Nailing Fin



1 EXISTING FRONT ELEVATION (SOUTH)
SCALE: 1/4" = 1'-0"

2019 © COPYRIGHT. THIS DRAWING IS NOT TO BE USED FOR MAKING ANY REPRODUCTION THEREOF, OR FOR CONSTRUCTION OF ANY BUILDING WITHOUT FIRST OBTAINING THE WRITTEN AUTHORIZATION FROM CHRISTOPHER W. ARNER, ARCHITECT, INC.

CHRISTOPHER ARNER, ARCHITECT 1 WASHINGTON STREET NEWPORT, RI 02840 401.225.6497 WWW.CWA-AIA.COM	
12 & 14 GEORGE STREET	12 & 14 GEORGE STREET PROVIDENCE, RI PLAT 12, LOT 478
EXISTING SOUTH ELEVATION	
6-18-21	
A1	

1

PROPOSED FRONT ELEVATION (SOUTH)

SCALE: 1/4" = 1'-0"

3 T.O. FIN.FLOOR

2 T.O. FIN. FLOOR

1 T.O. SUBFLOOR
EL. 0'-0"

10'-8 1/2"

10'-2"



EXISTING DORMER
WINDOWS TO REMAIN,
TYP.

CHRISTOPHER
ARNER,
ARCHITECT
1 WASHINGTON STREET
NEWPORT, RI 02840
401.225.6497
WWW.CWA-AIA.COM

12 & 14 GEORGE STREET

12 & 14 GEORGE STREET
PROVIDENCE, RI
PLAT 12, LOT 478

PROPOSED
SOUTH ELEVATION

6-18-21

A2

2019 © COPYRIGHT. THIS DRAWING IS NOT TO BE USED FOR MAKING ANY REPRODUCTION THEREOF, OR FOR CONSTRUCTION OF ANY BUILDING WITHOUT FIRST OBTAINING THE WRITTEN AUTHORIZATION FROM CHRISTOPHER W. ARNER, ARCHITECT, INC.

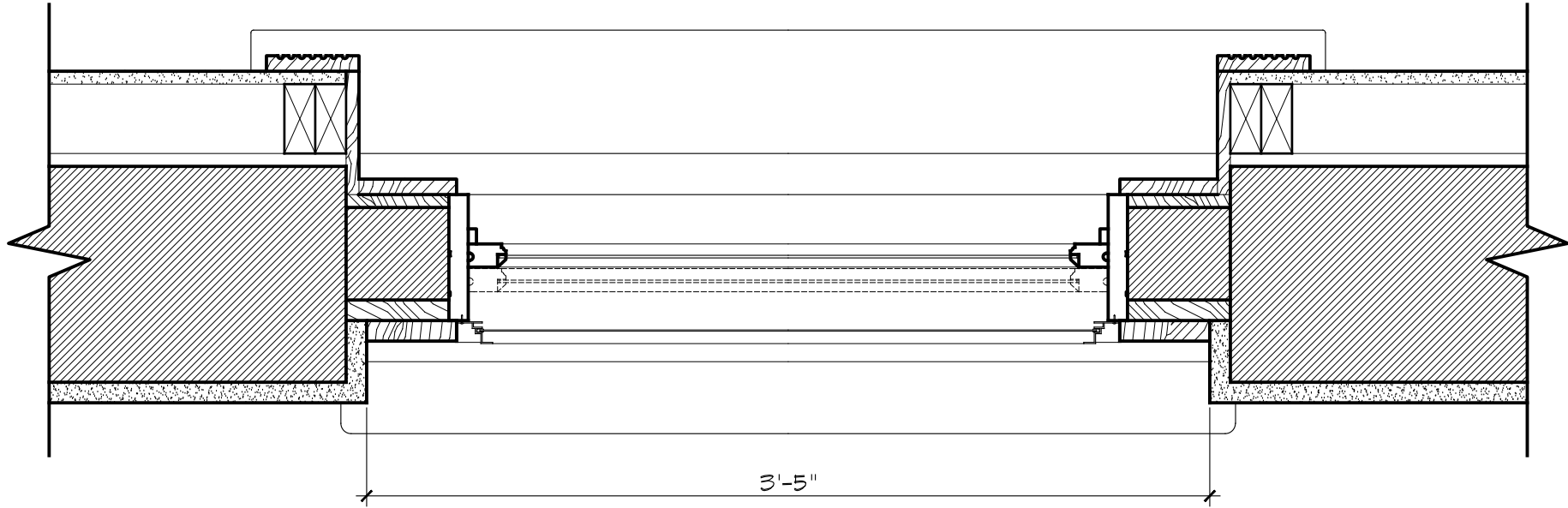

1 HORIZONTAL SECTION
1 1/2"=1'-0"
EXISTING WOOD WINDOWS

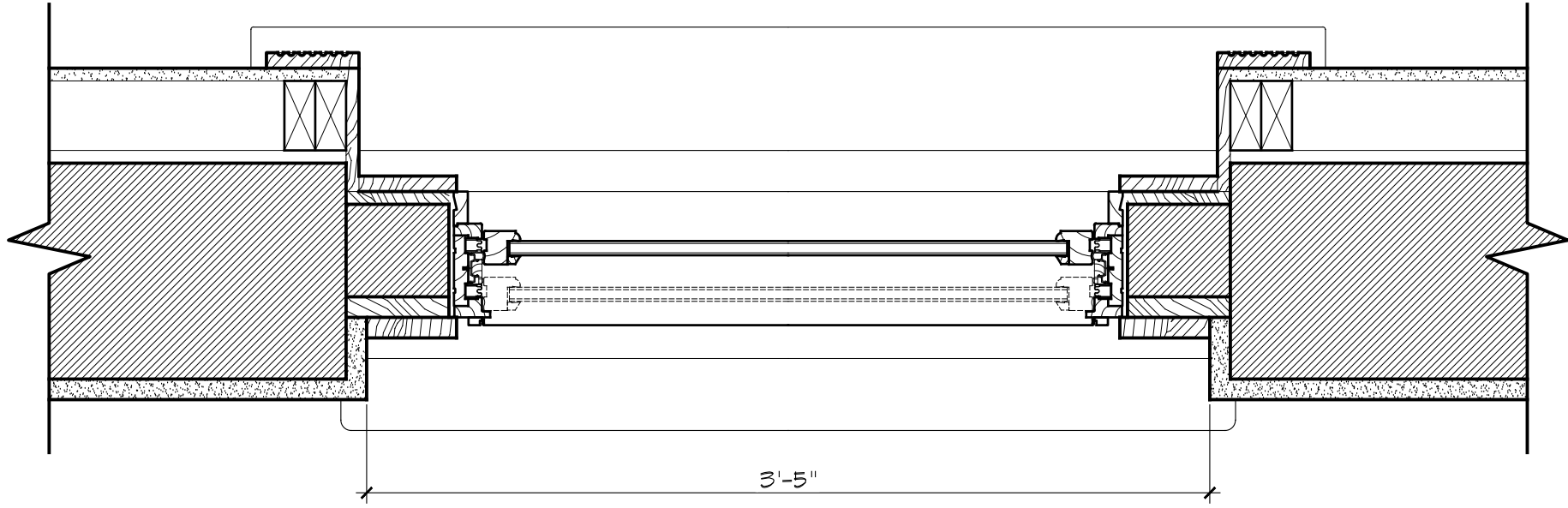

2 HORIZONTAL SECTION
1 1/2"=1'-0"
MARVIN WOOD WINDOWS

2019 © COPYRIGHT. THIS DRAWING IS NOT TO BE USED FOR MAKING ANY REPRODUCTION THEREOF, OR FOR CONSTRUCTION OF ANY BUILDING WITHOUT FIRST OBTAINING THE WRITTEN AUTHORIZATION FROM CHRISTOPHER W. ARNER, ARCHITECT, INC.

CHRISTOPHER ARNER, ARCHITECT 1 WASHINGTON STREET NEWPORT, RI 02840 401.225.6497 WWW.CWA-AIA.COM	12 & 14 GEORGE STREET	
	12 & 14 GEORGE STREET PROVIDENCE, RI PLAT 12, LOT 478	WINDOW DETAILS
6-18-21		
A3		

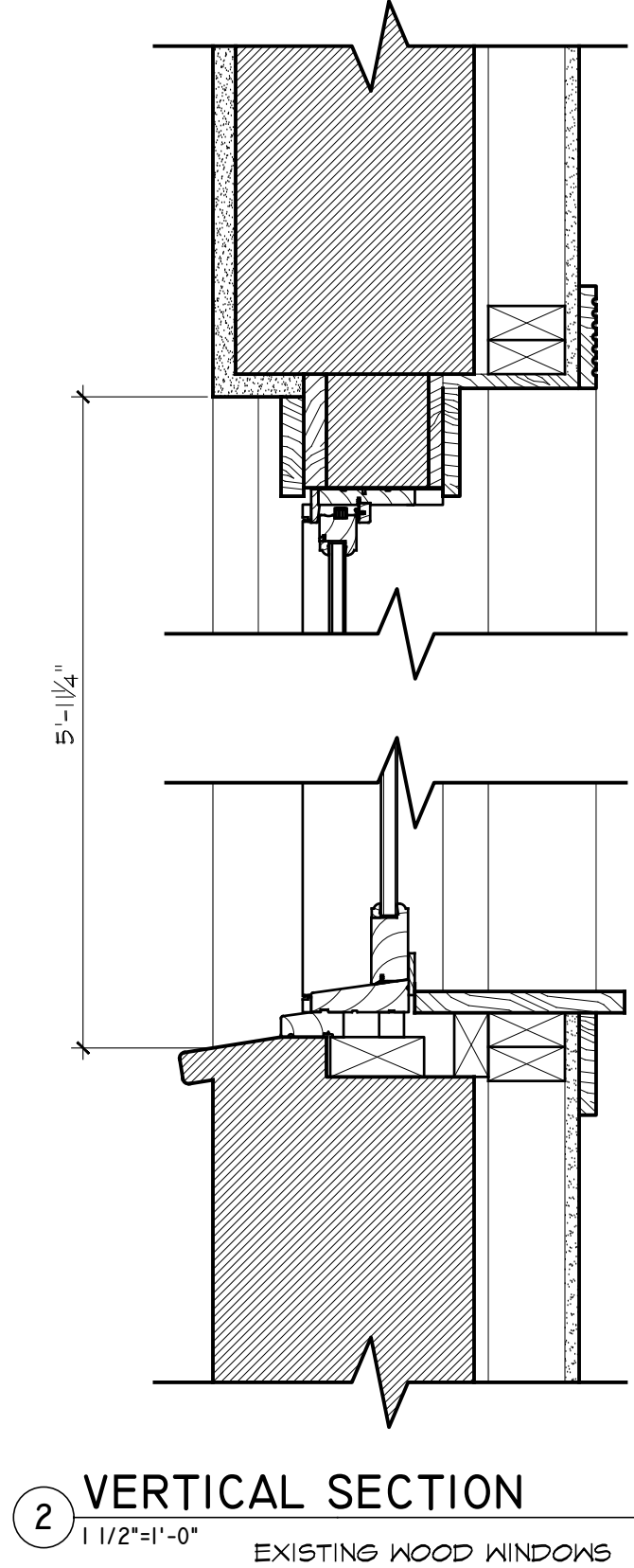
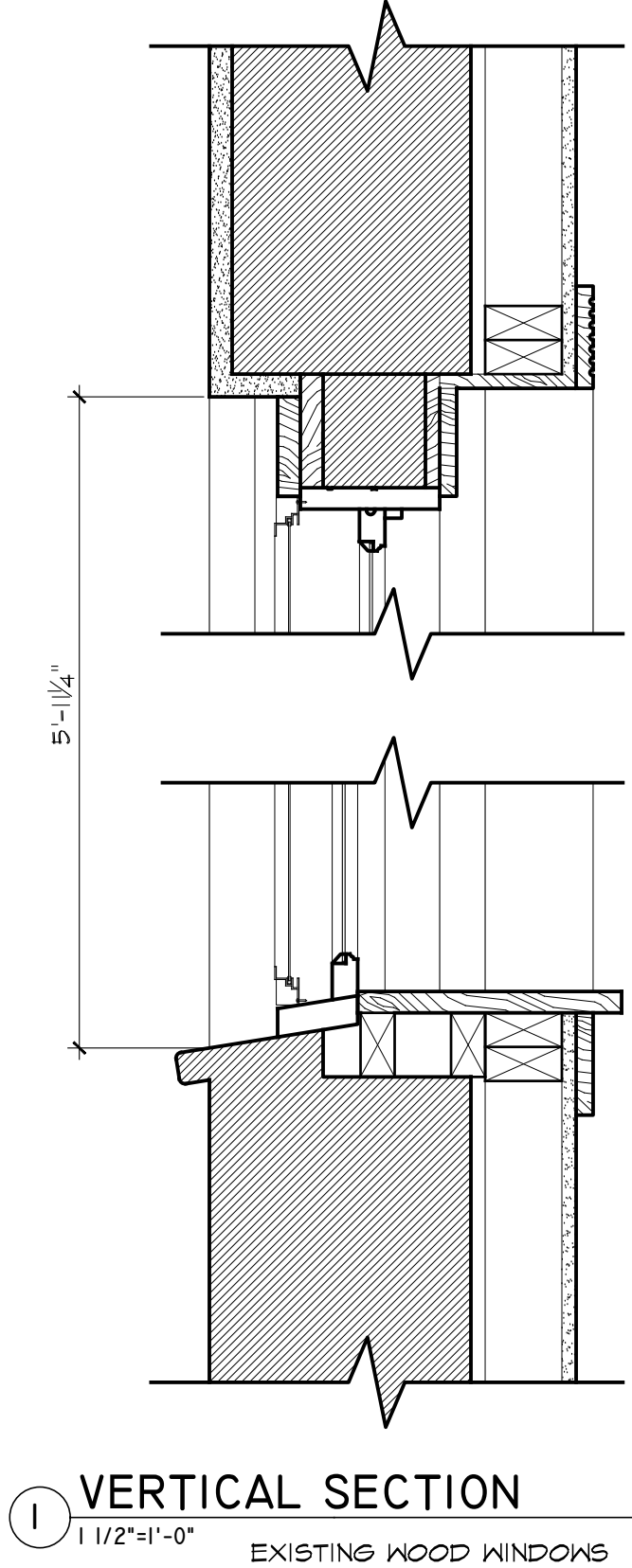

2019 © COPYRIGHT. THIS DRAWING IS NOT TO BE USED FOR MAKING ANY REPRODUCTION THEREOF, OR FOR CONSTRUCTION OF ANY BUILDING WITHOUT FIRST OBTAINING THE WRITTEN AUTHORIZATION FROM CHRISTOPHER W. ARNER, ARCHITECT, INC.

WINDOW DETAILS	12 & 14 GEORGE STREET	CHRISTOPHER ARNER, ARCHITECT 1 WASHINGTON STREET NEWPORT, RI 02840 401.225.6497 WWW.CWA-AIA.COM
	12 & 14 GEORGE STREET PROVIDENCE, RI PLAT 12, LOT 478	
	6-18-21	
A4		

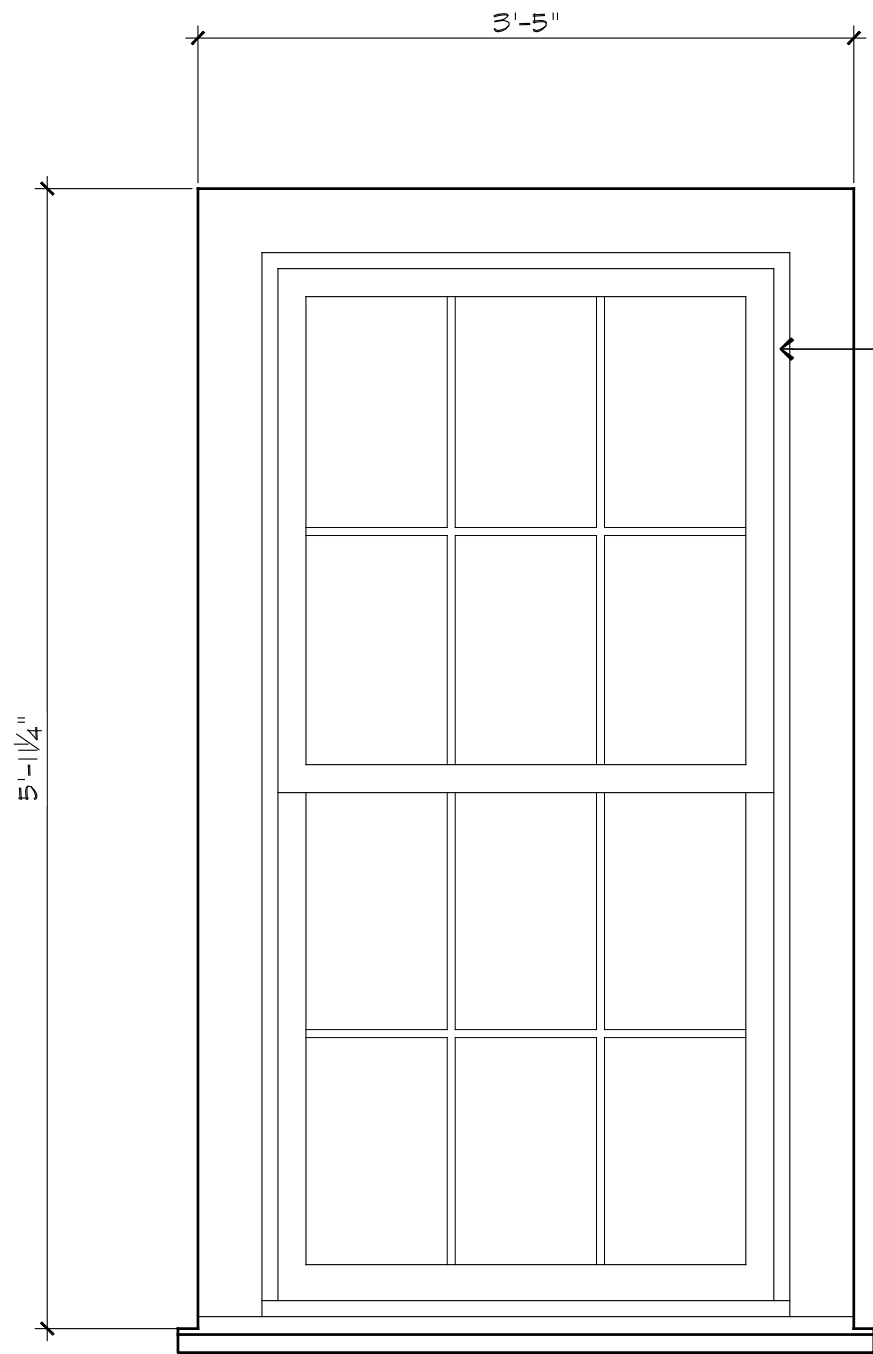

1 EXISTING WINDOW
SCALE: 1"= 1'-0"
EXISTING WOOD WINDOWS

- EXISTING ALUM.
STORM WINDOW AND
SCREEN NOT SHOWN
- 5/4 FLAT CASING, PAINT
- LINE OF SCREEN FRAME
SHOWN DASHED
- 5/8" PUTTY SIMULATED
DIVIDED LITES (SDL)
- WOOD SILL AND SUBSILL

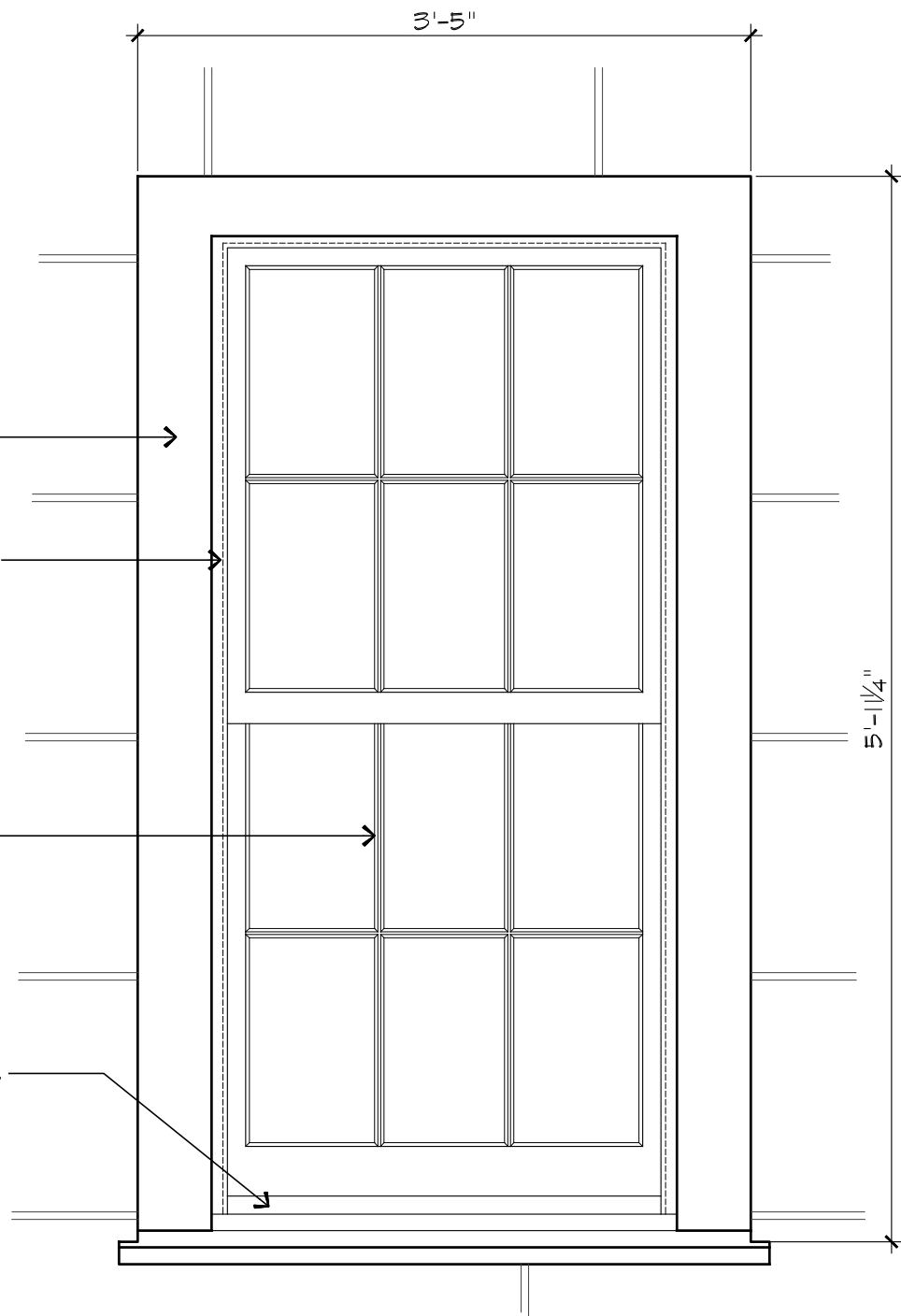

2 PROPOSED WINDOW
SCALE: 1"= 1'-0"
MARVIN WOOD WINDOWS
TYPE "A" UNITS

2019 © COPYRIGHT. THIS DRAWING IS NOT TO BE USED FOR MAKING ANY REPRODUCTION THEREOF, OR FOR CONSTRUCTION OF ANY BUILDING WITHOUT FIRST OBTAINING THE WRITTEN AUTHORIZATION FROM CHRISTOPHER W. ARNER, ARCHITECT, INC.

CHRISTOPHER ARNER, ARCHITECT 1 WASHINGTON STREET NEWPORT, RI 02840 401.225.6497 WWW.CWA-AIA.COM	12 & 14 GEORGE STREET	
	12 & 14 GEORGE STREET PROVIDENCE, RI PLAT 12, LOT 478	
WINDOW DETAILS		
		6-18-21
A5		



2019 © COPYRIGHT. THIS DRAWING IS NOT TO BE USED FOR MAKING ANY REPRODUCTION THEREOF, OR FOR CONSTRUCTION OF ANY BUILDING WITHOUT FIRST OBTAINING THE WRITTEN AUTHORIZATION FROM CHRISTOPHER W. ARNER, ARCHITECT, INC.

12 & 14 GEORGE STREET	CHRISTOPHER ARNER, ARCHITECT 1 WASHINGTON STREET NEWPORT, RI 02840 401.225.6497 WWW.CWA-AIA.COM
	12 & 14 GEORGE STREET PROVIDENCE, RI PLAT 12, LOT 478
WINDOW DETAILS	
6-18-21	
A6	



2019 © COPYRIGHT. THIS DRAWING IS NOT TO BE USED FOR MAKING ANY REPRODUCTION THEREOF, OR FOR CONSTRUCTION OF ANY BUILDING WITHOUT FIRST OBTAINING THE WRITTEN AUTHORIZATION FROM CHRISTOPHER W. ARNER, ARCHITECT, INC.

12 & 14 GEORGE STREET	CHRISTOPHER ARNER, ARCHITECT
	1 WASHINGTON STREET NEWPORT, RI 02840 401.225.6497 WWW.CWA-AIA.COM
WINDOW DETAILS	12 & 14 GEORGE STREET PROVIDENCE, RI PLAT 12, LOT 478
6-18-21	
A7	

Section Details: Operating

Scale: 3" = 1' 0"

Double Hung

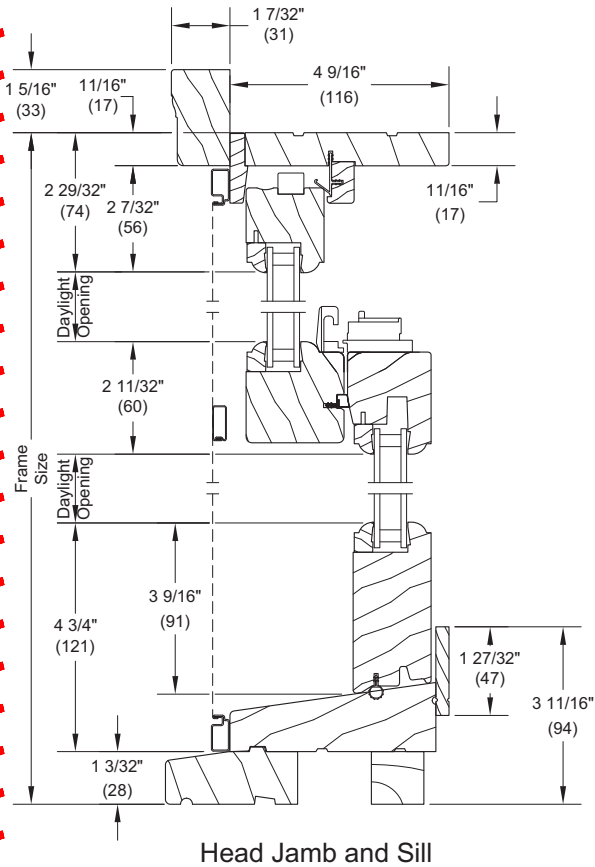

Lower Sash

Upper Sash

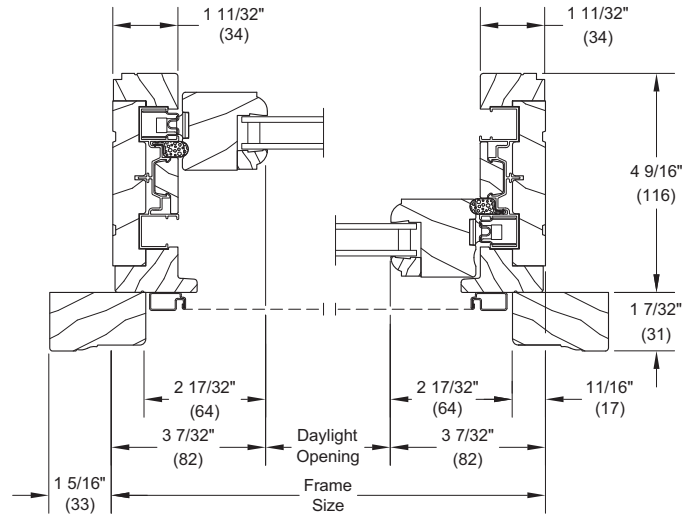

Jambs

Single Hung

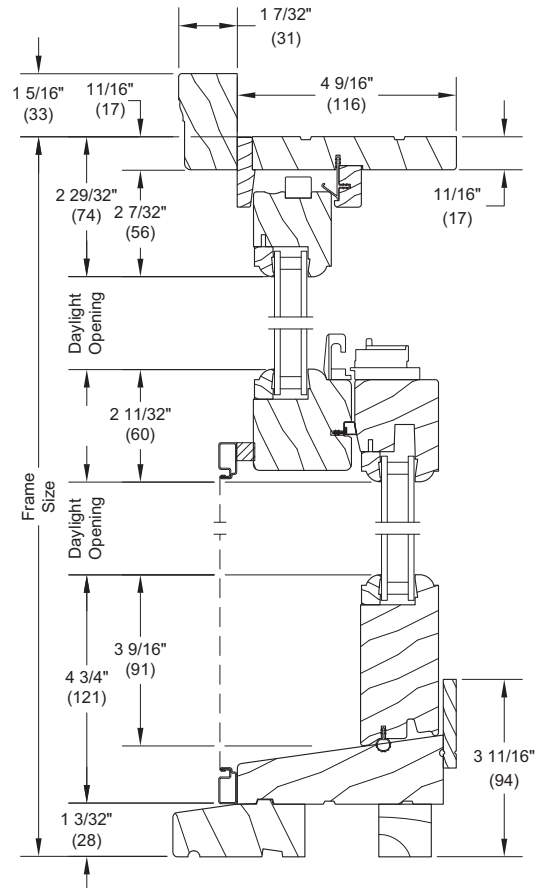
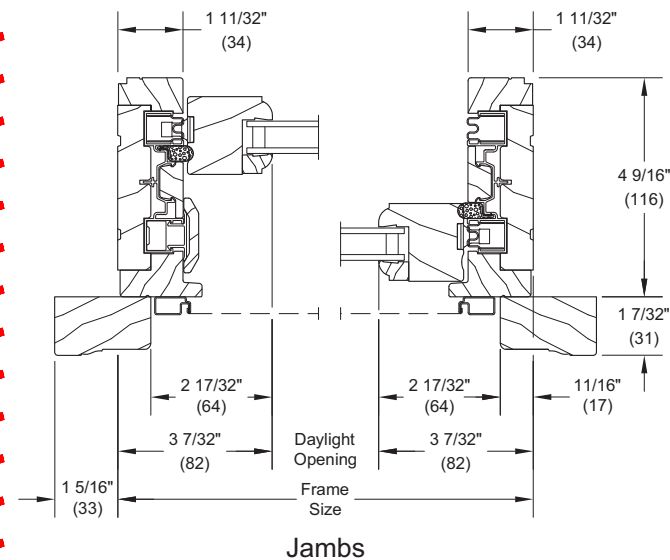

Head Jamb and Sill

Standard Insulating Glass Divided Lite Options

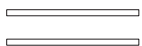

Insulating Glass

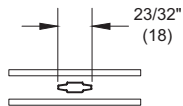

Aluminum 23/32"
Contour GBG

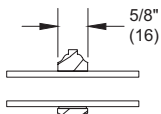

5/8" SDL

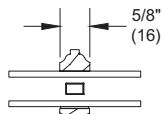

5/8" SDL
W/Spacer

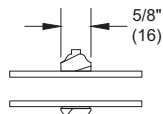

5/8" Putty
SDL

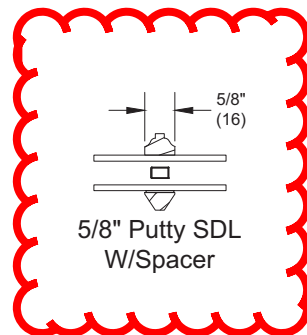

5/8" Putty SDL
W/Spacer

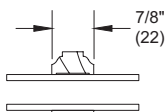

7/8" SDL

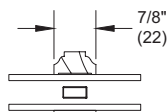

7/8" SDL
W/Spacer Bar

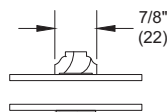

7/8" Putty SDL

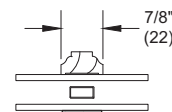

7/8" Putty SDL
W/Spacer Bar

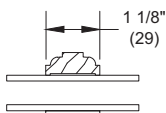

1 1/8" SDL

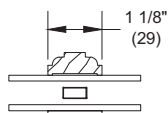

1 1/8" SDL
W/Spacer Bar

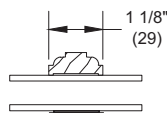

1 1/8" Putty SDL

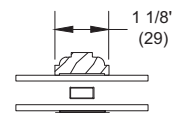

1 1/8" Putty SDL
W/Spacer Bar

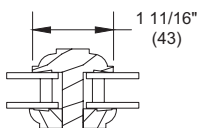

1 11/16" IG ADL

NOTE: ADL is not available with CE Mark.