



CITY OF PROVIDENCE  
Jorge O. Elorza, Mayor

## **Blackstone Boulevard Path Improvements**

### **Addendum # 1**

**October 15, 2021**

**(11 Pages)**

*Acknowledge Addendum on Bid Form*

**\*\* BID OPENING DATE REMAINS October 25, 2021\*\***

#### **Attachments:**

1. Pre-bid sign in sheet (1 page)
2. Pre-bid meeting minutes (1 page)
3. Revised Sheet L-2 & L-5 (2 pages)
4. Spec Section 32500 (4 Pages)
5. Revised Supplemental Bid Form (3 Pages)

#### **Questions/Clarifications:**

- ❖ How should pedestrian traffic be directed during construction?
  - Pedestrians will be directed to use the sidewalks on either side of Blackstone Boulevard between Mount Ave & Rochambeau. Construction fence and a sign (provided by Parks Dept) should be attached at path ends (4 in total).
  - See Attachment 3 - revised plans.
- ❖ Specification 32500 – Erosion & Sedimentation Controls is missing
  - See Attachment 4

#### **PROVIDENCE PARKS DEPARTMENT**

1000 Elmwood Avenue, Providence, Rhode Island 02907

Phone: 401-785-9450 | Fax: 401-941-5920

**[www.providenceri.gov](http://www.providenceri.gov)**



CITY OF PROVIDENCE

Jorge O. Elorza, Mayor

- ❖ Specifications 329113 & 329119 seem to be out of order
  - The labeling/numbering in these sections is off, but they are complete. Section 329113 is included in the pages numbered 329119-1 to 329119-7 and Section 329119 is numbered 329119-8 to 329119-10
  
- ❖ Will Add Alternate #2 (Stabilized Stonedust) only be done in full or can sections of it be installed as budget allows?
  - A reduced section can be installed to fit the budget if the whole length is not affordable
  
- ❖ There is no pay item for demolition. Where is the demolition/removal being paid for?
  - The list of items in the Bid Package is for listing Unit Prices only. It is not a comprehensive list of all the items required for the project. You are responsible for providing a lump sum bid for all the required work, whether it is in the unit price list or not.
  
- ❖ There are no quantities on the bid form, is it a unit price project only then?
  - See answer #3
  
- ❖ Bid Item #7 seems the same as Add Alternate #2
  - Use this line to list the unit pricing for Add Alternate #2 (see answer 3 for further clarification)
  
- ❖ Can existing stone dust/topsoil be reused?
  - Stonedust should be removed from site but topsoil can be screened and reused.
  
- ❖ Unit Price Item #5 states a 4" Gravel Base, drawings show between 6" & 8", which should be used.
  - The 4" item is incorrect. Please refer to plans for base depth
  
- ❖ Unit Price Item #14 is for Jute Mesh in locations greater than 3:1, but it is not in the drawings or specifications, is it still included in the project?
  - This item should read as greater than 4:1. There are a few locations that have slopes greater than 4:1 slope. A note has been added to the drawing and Jute Mesh is included in the attached Spec Section. See Attachment #5

**PROVIDENCE PARKS DEPARTMENT**

1000 Elmwood Avenue, Providence, Rhode Island 02907

Phone: 401-785-9450 | Fax: 401-941-5920

[www.providenceri.gov](http://www.providenceri.gov)



**CITY OF PROVIDENCE**

Jorge O. Elorza, Mayor

- ❖ What permits and associated fees are necessary?
  - Contractor is responsible for determining if any permits are necessary and obtaining any such permits prior to construction.
  
- ❖ What is the Notice to Proceed/Schedule for this project?
  - This project should be scheduled for late winter/spring 2022, work is not be started in 2021.
  
- ❖ Must the WBE and MBE goal be met separately?
  - No, see RFP Page 12, Row F
  
- ❖ Confirm all tree pruning will be performed by City prior to construction.
  - Yes, the City will be pruning in the project area in late 2021, early 2022. However, contractor should confirm with the Parks Department prior to beginning construction.
  
- ❖ Are we responsible for pruning the tree roots in the construction area?
  - Yes, roots under 2" can be removed, contact Parks Department for before removing larger roots
  
- ❖ Is there an edge treatment between path and lawn
  - No

**PROVIDENCE PARKS DEPARTMENT**

1000 Elmwood Avenue, Providence, Rhode Island 02907

Phone: 401-785-9450 | Fax: 401-941-5920

[www.providenceri.gov](http://www.providenceri.gov)

Sign-In Sheet

Non-Mandatory Pre-Bid Meeting

Tuesday October 12, 2021 at 10:00 AM – Site

Project: Blackstone Boulevard Path Improvements

<u>Name</u>	<u>Company</u>	<u>E-Mail</u>	<u>Phone</u>
Emma Donatelli	Site Tech	edonatelli@sitestechcorp.com	401-490-7483 x110
CHRIS SELLER	YARD WALKS INC.	YARDWALKS.CHAIR@GMAIL.COM	401-463-9133
Jon Trakas	NARRAGANSETT IMPROVEMENT	jtrakas@nicori.com	(401) 331-7420
David Linear	Linear Bus	David@linearbus.com	401 762-5400
MAT JESUS	CAZDI CORP	MJESUS@CAZDI.COM	401-739-8300
Tom Swella	Loureiro contractors	tswella@loureiro.com	(401) 451 9926
Max Le Brœidic	Loureiro contractors	mllebrœidic@loureiro.com	401- 829-5571
Prayan Dasgupta	PVD-	prayan@pvd.com	401-680-7243



CITY OF PROVIDENCE

Jorge O. Elorza, Mayor

**Pre-Bid Meeting – Non-Mandatory**

**Date:** Tuesday, October 12 @ 10:00 AM (Intersection of Mount Ave & Blackstone Blvd, Providence RI, 02906– Site)

**Project:** **Blackstone Boulevard Path Improvements**

**Bid Due:** October 25, 2021: by 2:15 PM – Board of Contract Meeting

**Agenda:**

1. Bid Documents, Plans & Specifications
2. Funding – **CIP**
3. MBE/WBE Utilization – 10% MBE / 10% WBE - If Sub-Contracts are to be utilized - Forms Must be Completed and Signed by MBE/WBE Coordinator for Providence. If no sub-contractors are being used – no forms are required.
4. Retainage of 5% will be held from Pay Requests until project completion
5. Insurance Certificates – Shall Include the Project Name and shall list the City of Providence as ‘Additionally Insured on a primary but non-contributing basis for General Liability Insurance per Written Contract or Agreement’ (Not Needed with Bid – After Award – GC and Sub-Contractors)
6. Performance / Payment Bond –**Required**
7. Permits – Contractor’s Responsibility to Seek Out if Permit is Needed
8. Prevailing Wage Requirements – Certified Payroll Submitted with Pay Requests – Wage Decision included in RFP
9. Sub-Contractor Utilization Form needs to be submitted with Pay Requests (If Applicable)
10. Submittals – Need Written Approval prior to purchase of Materials
11. Schedule of Values / Sequence of Work – Submitted prior to mobilization
12. Questions Need to be Submitted in Writing (5) Working Days Prior to the Opening – Sent Via E-mail to Lindsey Langenburg at [sgreenwood@providenceri.gov](mailto:sgreenwood@providenceri.gov) and Patti Jordan at [pjordan@providenceri.gov](mailto:pjordan@providenceri.gov)

**Parks Department Contact Information**

Sam Greenwood                      401-680-7299                      Landscape Architect (Primary Contact)  
E-Mail:                      [sgreenwood@providenceri.gov](mailto:sgreenwood@providenceri.gov)

**PROVIDENCE PARKS DEPARTMENT**

1000 Elmwood Avenue, Providence, Rhode Island 02907

Phone: 401-785-9450 | Fax: 401-941-5920

**[www.providenceri.gov](http://www.providenceri.gov)**



EXISTING CONDITIONS/DEMOLITION PLAN LEGEND

- 97.96 EXISTING GRADE
- - - - 98 EXISTING CONTOUR
- ○ EXISTING TREES
- ○ TREE PROTECTION
- LOW LIMIT OF WORK
- SS SILT SOCK
- ▨ AREA OF MIN 8" EXCAVATION
- ▨ AREA OF 4" EXCAVATION



LOCUST MAP  
NOT TO SCALE

DEMOLITION PLAN NOTES

1. ALL SITE PREPARATION NECESSARY TO COMPLETE THIS PROJECT IS THE SOLE RESPONSIBILITY OF THE CONTRACTOR.
2. IT IS THE CONTRACTOR'S RESPONSIBILITY TO COORDINATE WITH PROVIDENCE PARKS DEPARTMENT STAFF TO DEVELOP A SUITABLE DEMOLITION PLAN, WHICH WILL MINIMIZE PARK DISTURBANCE AND ALLOW ALL FACILITIES TO REMAIN IN OPERATION DURING THE ENTIRETY OF CONSTRUCTION.
3. UNLESS OTHERWISE NOTED, THE CONTRACTOR IS RESPONSIBLE FOR THE RELOCATION, DEMOLITION, REMOVAL AND DISPOSAL, IN A LOCATION APPROVED BY ALL GOVERNING AUTHORITIES, OF ALL EXISTING SITE ELEMENTS AND STRUCTURES INCLUDING BUT NOT LIMITED TO BITUMINOUS CONCRETE, CEMENT CONCRETE, GRAVEL, CURBS, WALKWAYS, SIDEWALKS, BERMS, FENCES, BOLLARDS, POSTS, PLANTING BEDS, TREES, SHRUBS, UTILITIES, DRAINAGE STRUCTURES AND ALL OTHER STRUCTURES SHOWN WITHIN THE LIMITS, AND WHERE NEEDED, TO ALLOW FOR NEW CONSTRUCTION. ALL ELEMENTS TO BE REMOVED SHALL BE UNDERCUT TO SUITABLE MATERIAL AND BROUGHT TO GRADE WITH SUITABLE COMPACTED FILL MATERIAL PER SPECIFICATIONS.
4. THE CONTRACTOR IS RESPONSIBLE FOR REMOVING ALL DEBRIS FROM THE SITE AND DISPOSING OF THE DEBRIS IN A PROPER AND LEGAL MANNER.
5. THE CONTRACTOR IS SPECIFICALLY CAUTIONED THAT THE LOCATION AND/OR ELEVATION OF EXISTING UTILITIES AND STRUCTURES AS SHOWN ON THESE PLANS ARE BASED ON RECORDS OF VARIOUS UTILITY COMPANIES, AND WHEREVER POSSIBLE, MEASUREMENTS TAKEN IN THE FIELD. THIS INFORMATION IS NOT TO BE RELIED UPON AS BEING EXACT OR COMPLETE. THE LOCATION OF ALL UNDERGROUND UTILITIES AND STRUCTURES SHALL BE VERIFIED IN THE FIELD BY THE CONTRACTOR PRIOR TO THE START OF CONSTRUCTION. THE CONTRACTOR MUST CONTACT THE APPROPRIATE UTILITY COMPANY, ANY GOVERNING PERMITTING AUTHORITY IN THE CITY, AND "DIGSAFE" (1-800-344-7233) AT LEAST 72 HOURS PRIOR TO ANY EXCAVATION WORK IN PREVIOUSLY UNALTERED AREAS TO REQUEST EXACT FIELD LOCATION OF UTILITIES. IT SHALL BE THE RESPONSIBILITY OF THE CONTRACTOR TO RESOLVE CONFLICTS
6. THE CONTRACTOR IS RESPONSIBLE FOR MAINTAINING ALL EXISTING UTILITIES IN WORKING ORDER AND FREE FROM DAMAGE DURING THE ENTIRE DURATION OF THE PROJECT. ALL COST RELATED TO THE REPAIR OF UTILITIES SHALL BE THE RESPONSIBILITY OF THE CONTRACTOR. EXCAVATION REQUIRED WITHIN THE PROXIMITY OF EXISTING UTILITY LINES SHALL BE DONE BY HAND. CONTRACTOR SHALL REPAIR ANY DAMAGE TO EXISTING UTILITY LINE OR STRUCTURES INCURRED DURING CONSTRUCTION OPERATIONS AT NO COST TO THE OWNER.
7. THE CONTRACTOR SHALL MAINTAIN CONTINUOUS ACCESS AND OPERATION FOR SURROUNDING FACILITIES, AS DEEMED BY THE OWNER, AT ALL TIMES DURING DEMOLITION OF THE EXISTING FACILITIES.
8. PRIOR TO DEMOLITION OCCURRING, ALL EROSION CONTROL DEVICES AND TREE PROTECTIVE MEASURES ARE TO BE INSTALLED.

BETWEEN THE PROPOSED UTILITIES AND FIELD-LOCATED UTILITIES AND SHALL REPORT ANY DISCREPANCIES TO THE LANDSCAPE ARCHITECT IMMEDIATELY. THE OWNER ASSUMES NO RESPONSIBILITY FOR DAMAGES INCURRED AS A RESULT OF UTILITIES OMITTED, INCOMPLETELY OR INACCURATELY SHOWN. THE CONTRACTOR SHALL BE RESPONSIBLE FOR MAINTAINING ACCURATE RECORDS OF THE LOCATION AND ELEVATION OF ALL WORK INSTALLED AND EXISTING UTILITIES FOUND DURING CONSTRUCTION FOR THE PREPARATION OF THE AS-BUILT PLAN.



COPYRIGHT (C) CITY OF PROVIDENCE PARKS DEPARTMENT, ALL RIGHTS RESERVED 2021.  
NO PART OF THIS DOCUMENT MAY BE REPRODUCED, STORED IN A RETRIEVAL SYSTEM OR TRANSMITTED IN ANY FORM OR BY ANY MEANS, ELECTRONIC, MECHANICAL, PHOTOCOPYING, RECORDING OR OTHERWISE WITHOUT THE PRIOR WRITTEN PERMISSION OF THE CITY OF PROVIDENCE PARKS DEPARTMENT. ANY MODIFICATIONS TO THIS DOCUMENT WITHOUT THE WRITTEN PERMISSION OF THE CITY OF PROVIDENCE PARKS DEPARTMENT SHALL RENDER IT INVALID AND UNUSABLE.

NO.	REVISION	DATE
1	Pedestrian Direction/Jute	10.15.21

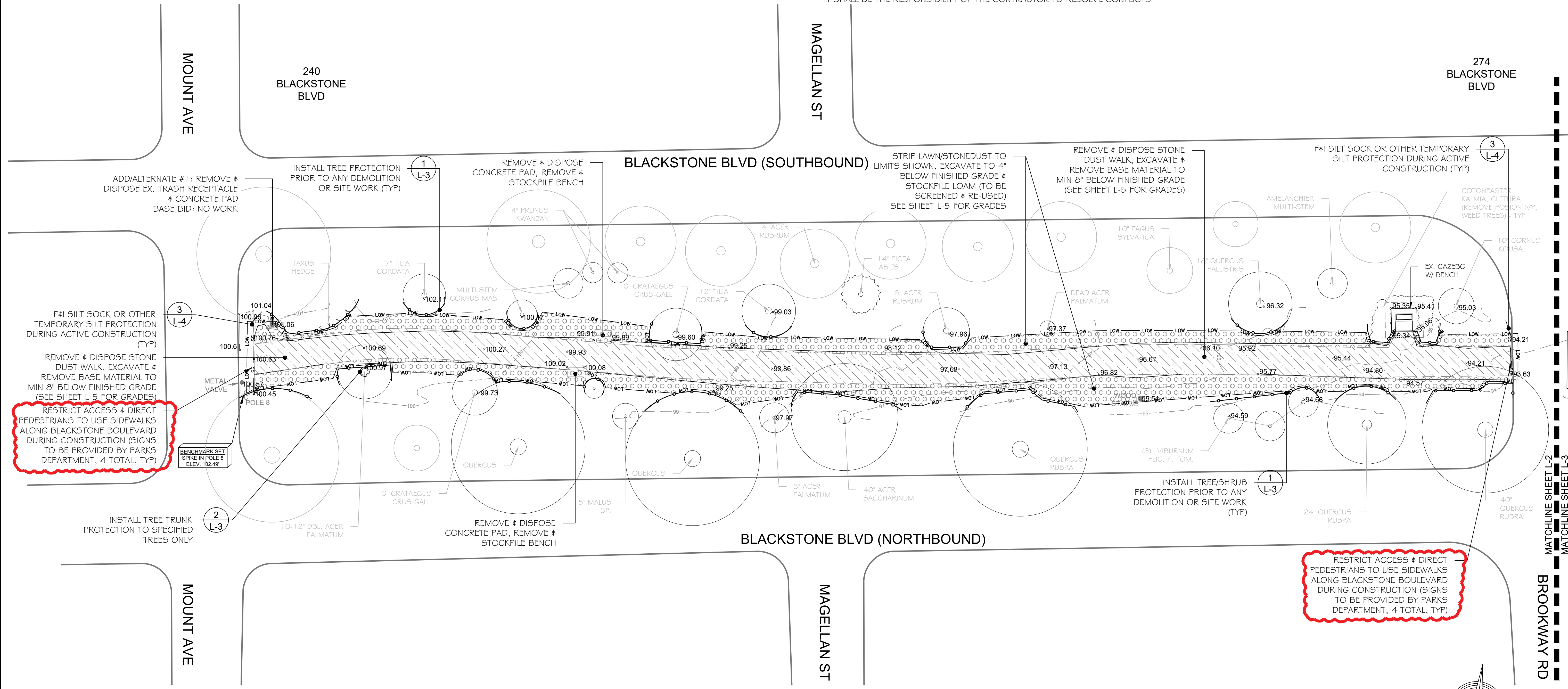

RESTRICT ACCESS & DIRECT PEDESTRIANS TO USE SIDEWALKS ALONG BLACKSTONE BOULEVARD DURING CONSTRUCTION (SIGNS TO BE PROVIDED BY PARKS DEPARTMENT, 4 TOTAL, TYP)

RESTRICT ACCESS & DIRECT PEDESTRIANS TO USE SIDEWALKS ALONG BLACKSTONE BOULEVARD DURING CONSTRUCTION (SIGNS TO BE PROVIDED BY PARKS DEPARTMENT, 4 TOTAL, TYP)

**EXISTING CONDITIONS/DEMO PLAN 1**  
**BLACKSTONE BLVD PATH IMPROVEMENTS PROJECT**  
**240-350 BLACKSTONE BOULEVARD**  
FILE: BLACKSTONE\_BLDV\_PATH\_EX.DWG

DATE:	9/16/21
SCALE:	1"=20'-0"
DRAWN BY:	SG
CHECKED/ APPROVED:	MG
SHEET NO.	L-2
	2 OF 7

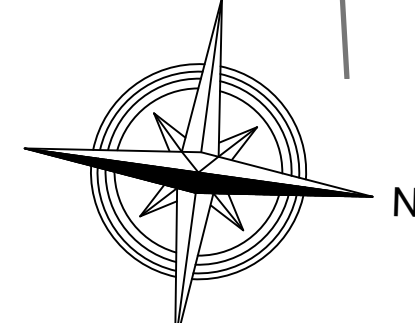
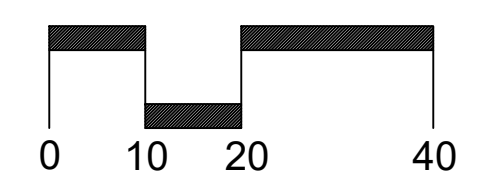





LOCUS MAP  
NOT TO SCALE

### GRADING PLAN LEGEND

- 97.96 EXISTING GRADE
- + 97.83 PROPOSED GRADE
- - - 98 - - - EXISTING CONTOUR
- 99 — PROPOSED CONTOUR
- ○ ○ EXISTING TREES
- ⊗ PROPOSED TREE
- ○ ○ TREE PROTECTION
- LOW — LIMIT OF WORK
- SS — SILT SOCK
- CHIP-SEAL
- STONEDUST PATH

### GRADING PLAN NOTES

1. ALL AREAS DISTURBED BY CONSTRUCTION TO BE LOAMED & HYDROSEED
2. TREE PROTECTION FENCING TO BE SECURED IN PLACE AS INDICATED ON PLANS PRIOR TO ANY CONSTRUCTION
3. FEATHER LOAM INTO EXISTING LAWN AT EDGE OF NEWLY GRADED AREAS

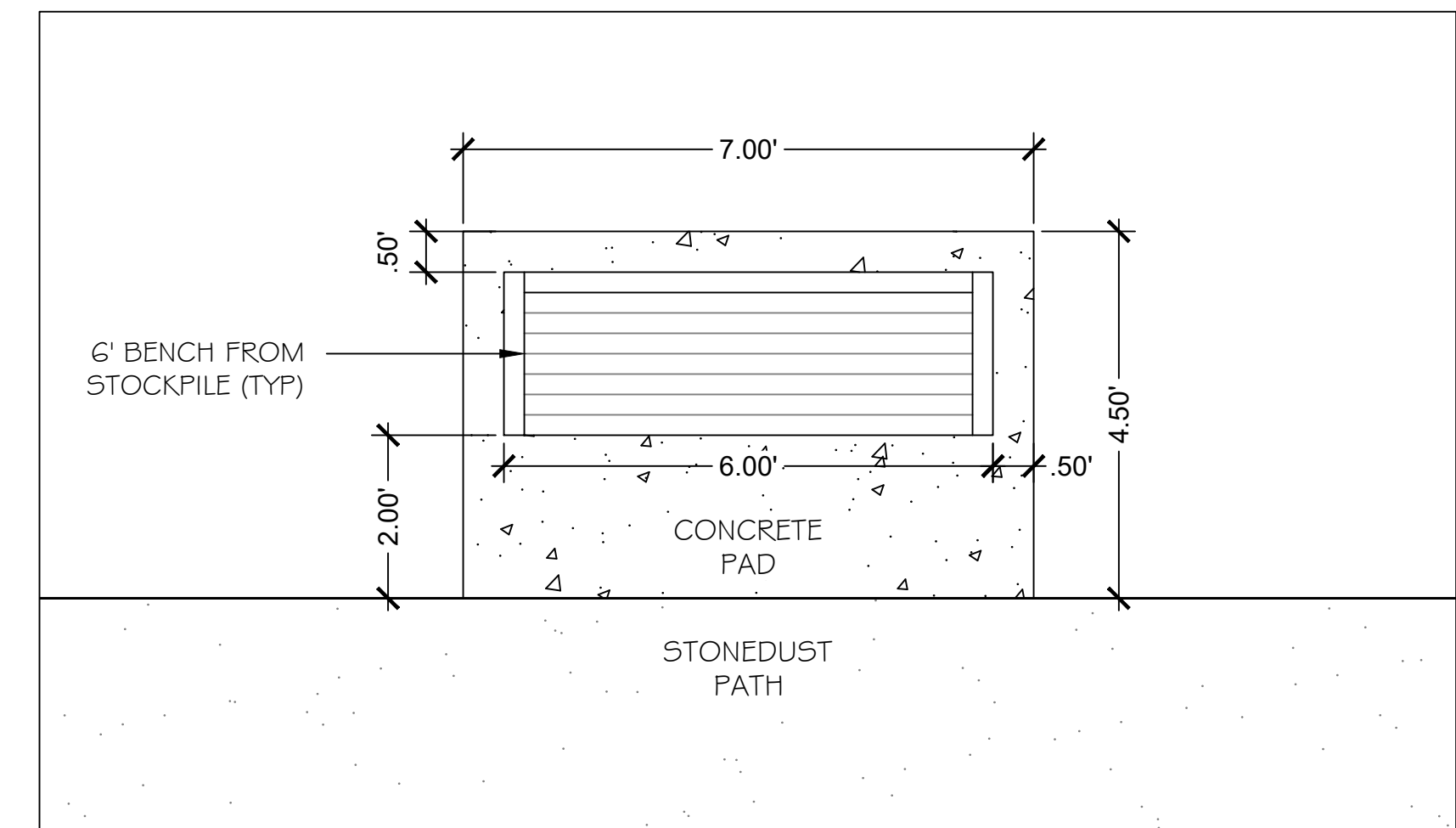

A TYPICAL BENCH ON CONCRETE PAD LAYOUT PLAN  
L-5 NOT TO SCALE

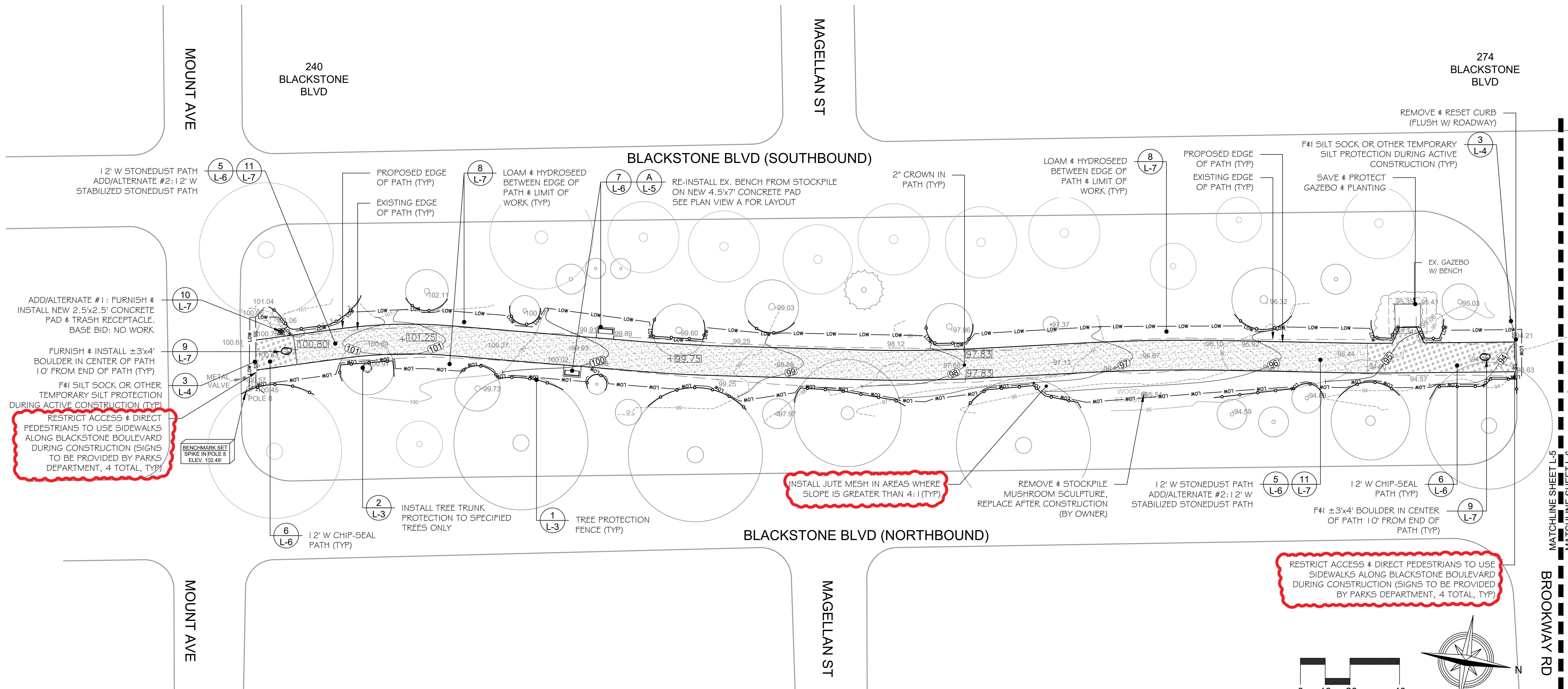

COPYRIGHT (C) CITY OF PROVIDENCE PARKS DEPARTMENT, ALL RIGHTS RESERVED 2021.  
NO PART OF THIS DOCUMENT MAY BE REPRODUCED, STORED IN A RETRIEVAL SYSTEM OR TRANSMITTED IN ANY FORM OR BY ANY MEANS, ELECTRONIC, MECHANICAL, PHOTOCOPYING, RECORDING OR OTHERWISE WITHOUT THE PRIOR WRITTEN PERMISSION OF THE CITY OF PROVIDENCE PARKS DEPARTMENT. ANY MODIFICATIONS TO THIS DOCUMENT WITHOUT THE WRITTEN PERMISSION OF THE CITY OF PROVIDENCE PARKS DEPARTMENT SHALL RENDER IT INVALID AND UNUSABLE.

NO.	REVISION	DATE
1	Pedestrian Direction/Jute	10.15.21

# GRADING PLAN 1

## BLACKSTONE BLVD PATH IMPROVEMENTS PROJECT

### 240-350 BLACKSTONE BOULEVARD

FILE: BLACKSTONE\_BLDV\_PATH\_CR.dwg

DATE:	9/16/21
SCALE:	1"=20'-0"
DRAWN BY:	SG
CHECKED/ APPROVED:	MG
SHEET NO.	L-5
	5 OF 7





## SECTION 312500 - EROSION AND SEDIMENTATION CONTROLS

### PART 1 - GENERAL

#### 1.1 SUMMARY

- A. Furnish all labor, materials, equipment and incidentals required and perform all installation, maintenance, removal and area cleanup related to erosion and sedimentation control work required to meet Federal, State, and local permit requirements and as shown on the Drawings and as specified herein. The work shall include, but not necessarily be limited to; installation of temporary access ways and staging areas, compost filter socks, catch basin sediment filters (silt sack), sediment removal and disposal, device maintenance, removal of temporary devices, and final cleanup.
- B. Related Sections:
  - 1. Section 329119 - Landscape Grading.

#### 1.2 REFERENCES

- A. EPA document titled: "Stormwater Management for Construction Activities — Developing Pollution Prevention Plans and Best Management Practices" document number EPA 832-R-92-005, dated 1992, or most recent edition. State, County Conservation Districts or local Conservation Commission standards can be substituted for the EPA standard if the State, County or Local Conservation Commission standards is equal to, or more detailed than, the EPA standard.
- B. State of Rhode Island Department of Transportation Standard Specifications for Road and Bridge Construction, Current Edition with latest addenda.

#### 1.3 SUBMITTALS

- A. Submit, in accordance with Division 01 10 00 – General Requirements: Submittal Procedures ten (10) days after award of Contract, technical product literature for all commercial products to be used for erosion and sedimentation control.
- B. If a NPDES General Permit is required, Contractor shall, prior to the start of construction:
- C. Prepare and submit the EPA NPDES Notice of Intent to Discharge to the applicable EPA office in accordance with EPA regulations. Submit one copy of the permit to Owner's Representative for informational purposes only.
  - 1. Prepare and submit a Stormwater Pollution Prevention Plan (SWPPP) in accordance with the U.S. Environmental Protection Agency (EPA) National Pollution Discharge





Elimination System (NPDES) General Permit for this work. Submit one copy of the permit to Owner's Representative for informational purposes only.

#### 1.4 QUALITY ASSURANCE

- A. Be responsible for the timely installation and maintenance of all erosion and sedimentation control devices necessary to prevent the movement of sediment from the construction site to off-site areas or into the stream system via surface runoff or underground drainage systems. Measures in addition to those shown on the Drawings necessary to prevent the movement of sediment off site shall be installed, maintained, removed, and cleaned up at the expense of the Contractor. No additional charges to the Owner will be considered.
- B. Where Contractor's efforts to control erosion and sediment have been demonstrated to be ineffective or potentially ineffective in the opinion of the Owner's Representative, the Owner's Representative may order that additional measures be implemented and constructed at no additional cost to the Owner.
- C. Perform Work in accordance with requirements of Section 310513, Section 312213.
- D. Perform Work according to Municipality of Public Works standards.

#### PART 2 - PRODUCTS

##### 2.1 MATERIALS

- A. Catch Basin sediment control devices shall be sediment capture devices specifically designed for this purpose such as "Silt Sack" by Geo-Synthetics, LLC or approved equal.
- B. When work is performed outside of normal seeding window straw mulch shall be utilized on all newly graded areas to protect areas against washouts and erosion. Straw mulch shall be comprised of threshed straw of oats, wheat, barley, or rye that is free from noxious weeds, mold or other objectionable material. The straw mulch shall contain at least 50 percent by weight of material to be 10-in or longer. Straw shall be in an air-dry condition and suitable for placement with blower equipment.
- C. If newly seeded areas contain slopes greater than 3:1 install Jute Mesh/Netting for erosion control. Jute Mesh should conform to following specifications:
  - 1. Open Area: 70 - 75%
  - 2. Mesh size: 11mm x 18mm
  - 3. Water Absorption: >450% of fabric weight
  - 4. Thickness: 0.25 inch (6 mm)
  - 5. Recommended shear stress: 0.45 lbs./sq.ft. (22 N/sq.m)
  - 6. Recommended flow capacity: 6 fps (1.8 m/s)
- D. Compost Filter Sock



- E. Machine produced.
  - 1. Straw filled tubes of compacted straw of rice, wheat or barley.
  - 2. Compost filter sock to be certified as weed free.
  - 3. Netting for tubes to be seamless, high density polyethylene with ultra violet inhibitors.
  - 4. Roll length to be 10.0 feet to 25.0 feet.
  - 5. Weight per linear foot, 12-inch: 2.5 lbs. minimum 9-inch: 1.5 lbs. minimum
  - 6. Stakes shall be wooden, 1 1/8-inch x 1 1/8-inch x 2.5 feet long, with lower ends tapered to facilitate driving into compacted soil. Rebar may be substituted for wooden stakes

### PART 3 - EXECUTION

#### 3.1 INSTALLATION

- A. Catch basin sediment control devices shall be installed according to manufacturer's recommendations and as directed by the Owner's Representative.
- B. Staging areas and stabilized construction entrance shall be surfaced with a minimum depth of 6 inches of crushed stone (if so directed by the Owner's Representative). Stabilized construction entrances shall be installed as shown on the Plans.

#### 3.2 MAINTENANCE AND INSPECTION

- A. Inspections
- B. Make a visual inspection of all erosion and sedimentation control devices once per week and promptly after every rainstorm. If such inspection reveals that additional measures are needed to prevent movement of sediment to offsite areas, promptly install additional devices as needed. Sediment controls in need of maintenance shall be repaired promptly.
- C. Device Maintenance
- D. Sediment Filters
  - 1. Catch basin sediment control devices shall be cleaned of sediment in a manner as recommended by the manufacturer and as directed by the Owner's Representative. Remove sediment from filter bag when saturated with sediment as directed by the Owner's Representative.

#### 3.3 REMOVAL AND FINAL CLEANUP

- A. Once the site has been permanently stabilized against erosion, remove all sediment control devices and sediment. Dispose sediment and all waste materials in a proper manner.
- B. When sediment accumulation in sedimentation structures has reached a point one-third depth of sediment structure or device, remove and dispose of sediment.





- C. Do not damage structure or device during cleaning operations.
- D. Clean channels when depth of sediment reaches approximately one half channel depth.
- E. Clean channels when depth of sediment reaches approximately one half channel depth.

END OF SECTION 312500



**BOARD OF CONTRACT AND SUPPLY  
CITY OF PROVIDENCE, RHODE ISLAND**

**SUPPLEMENTAL BID FORM**

**BLACKSTONE BOULEVARD PATH IMPROVEMENTS**

**BASE BID:**

Blackstone Boulevard Path Improvements Project is located in the median of Blackstone Blvd from Mount Ave to Rochambeau Ave (south to north) in Providence RI. Blackstone Blvd is an active walking trail that extends from Butler Avenue towards Hope Street for a total of 1.6 miles. The Providence Parks Department is seeking to repair a segment of the path to correct uneven walkway surfacing and to prevent further erosion in sloped areas. The success of this project would potentially invigorate restoration on future segments of the trail.

The Providence Parks Department is seeking qualified contractors to provide construction services for regrading and re-surfacing eroded path. Proposed work will include but is not limited to: grading, bituminous sidewalks, stone dust path installation, bio swale, rip rap and seeding.

All Contractors shall possess substantial credentials in good standing and be able to perform tasks as describe in this Bid. Contractor shall be familiar with all Local and State Regulations to ensure public health and safety.

In addition to stating the Total Base Bid, The bidder shall state Unit Prices for related work listed under each bid item which represents the work items included in the Total Base Bid. The Unit Prices are quoted for computing adjustments to the Base Bid prior to Contract award, as well as during the course of construction, based upon extra work ordered by the City or for work countermanded, reduced or omitted by the City in order to stay within the Project budget.

Base Bid Items and Unit prices are to be Completed prices to be added or deducted on the basis of quantities of work involved, for each item in place in the unit indicated.

**BASE BID:** The Base Bid scope of work for this project shall include, but not be limited to the following: complete furnishing and installing stone dust path, minor grading, chip-seal asphalt paving, sub base reconstruction, tree protection, installation of concrete pads and benches from stockpile, loam and hydroseeding

ADD/ALTERNATES: #1 – Remove existing trash receptacle, furnish & install new 55 gal trash receptacle on 30” sq concrete pad.  
#2 – Furnish & install stabilized stone dust with organic lock additive.

**All Work Included in this Project Shall be Completed for the lump sum of:**

\_\_\_\_\_ Dollars  
(\$ \_\_\_\_\_), **TOTAL BASE BID**

**ADD ALTERNATES:**

- 1. Add Alt # 1 – F&I 1 (ONE) 55 GAL TRASH RECEPTACLE ON CONCRETE PAD - Per Lump Sum

\_\_\_\_\_ LS \$ \_\_\_\_\_  
*price in writing*

**BIDDER:** \_\_\_\_\_





**BOARD OF CONTRACT AND SUPPLY  
CITY OF PROVIDENCE, RHODE ISLAND**

2. **Add Alt #2 - F&I 3" STABILIZED STONEDUST WITH ORGANIC LOCK APPLICATION COMPLETE - Per Lump Sum**

\_\_\_\_\_ LS \$ \_\_\_\_\_  
*price in writing*

**UNIT PRICES:**

1. **F&I TEMPORARY TREE AND PLANT PROTECTION - Per linear Foot**

\_\_\_\_\_ LF \$ \_\_\_\_\_  
*price in writing*

2. **F&I TEMPORARY TREE TRUNK PROTECTION - Per linear Foot**

\_\_\_\_\_ LF \$ \_\_\_\_\_  
*price in writing*

3. **F&I SILT SOCK EROSION CONTROL – Per Linear Foot**

\_\_\_\_\_ LF \$ \_\_\_\_\_  
*price in writing*

4. **F&I CATCH BASIN SEDIMENT TRAP – Per Each**

\_\_\_\_\_ LF \$ \_\_\_\_\_  
*price in writing*

5. **F&I PROCESSED GRAVEL BASE - Per Cubic Yard**

\_\_\_\_\_ CY \$ \_\_\_\_\_  
*price in writing*

6. **F&I 2" PROCESSED STONEDUST PATH COMPLETE - Per Square Yard**

\_\_\_\_\_ SY \$ \_\_\_\_\_  
*price in writing*

**BIDDER:** \_\_\_\_\_



**BOARD OF CONTRACT AND SUPPLY  
CITY OF PROVIDENCE, RHODE ISLAND**

**7. F&I 3" STABILIZED STONEDUST WITH ORGANIC LOCK APPLICATION COMPLETE - Per Sq Yard**

\_\_\_\_\_ SY \$ \_\_\_\_\_  
*price in writing*

**8. F&I 3/8" CRUSHED STONE CHIP SEAL BITUMINOUS SIDEWALK COMPLETE - Per Square Foot**

\_\_\_\_\_ SF \$ \_\_\_\_\_  
*price in writing*

**9. F&I 4" 3 (THREE) CONCRETE PADS FOR BENCHES COMPLETE – Per Square Foot**

\_\_\_\_\_ SF \$ \_\_\_\_\_  
*price in writing*

**10. INSTALL 3 (THREE) WOOD & IRON BENCHES FROM STOCKPILE – Lump Sum**

\_\_\_\_\_ LS \$ \_\_\_\_\_  
*price in writing*

**11. F&I 3/4" SCREENED LOAM INSTALLED COMPLETE - Per Cubic Yard**

\_\_\_\_\_ CY \$ \_\_\_\_\_  
*price in writing*

**12. FINE GRADE 1/4" HYDRO SEED COMPLETE - Per Square Foot**

\_\_\_\_\_ SF \$ \_\_\_\_\_  
*price in writing*

**13. F&I 4 (FOUR) +/-3 FT x +/-4 FT BOULDER COMPLETE - Per Each**

\_\_\_\_\_ EA \$ \_\_\_\_\_  
*price in writing*

**14. F&I EROSION CONTROL JUTE MESH FOR SLOPE ≤ 4:1 - Per Square Foot**

\_\_\_\_\_ SF \$ \_\_\_\_\_  
*price in writing*

**BIDDER:** \_\_\_\_\_