

September 19, 2020

Dear Zoning Board Committee,

We are requesting re-approval for the re-zoning application for Special Use Permit (Section 1901.B.3) for Franchesca's at Waterplace events venue. We had been approved by the board for a special use permit for a reception facility back on December 11th, 2019.

Following the approval, we picked up our original resolution for the Department of Inspection and Standards. Still, we misunderstood what we needed to do next to register with the Lands Registered Records office. We would have identified this issue sooner, but when COVID-19 escalated, it shut down all business for the venue and shifted our focus to survive the season without any revenue coming in. Also, during the riots and looting that happened in Providence, our venue's windows were smashed, and we had to focus on getting those fixed ASAP.

Now that business is coming back quickly, and understanding that our initial zoning approval has expired, we're requesting that you reconsider and reinstate the original approval for our Special Use Permit.

Thank you in advance for your consideration and understanding. If you have any questions or need further clarification, please do not hesitate to reach out at (401)767-7799.

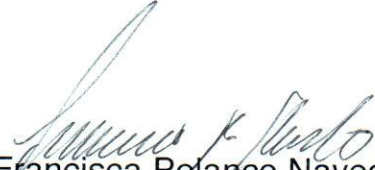
Francisca Polanco Navedo
CEO-Franchesca's at Waterplace LLC

INSPECTION & STANDARDS
RECEIVED
SEP 17 2020

SEP 17 2020

**CITY OF PROVIDENCE
ZONING BOARD OF REVIEW**

APPLICATION FOR VARIANCE OR SPECIAL USE PERMIT

Check Each Type Zoning Relief Sought:

| |
|-------------------------------------|
| <input type="checkbox"/> |
| <input type="checkbox"/> |
| <input checked="" type="checkbox"/> |

Variance – Use *
Variance – Dimensional*
Special Use Permit **

* Attach Appendix A to apply for a Use or Dimensional Variances

**Attach Appendix B to apply for a Special Use Permit

Applicant: Francisca Polanco Navedo

Address 123 Olney Avenue, N. Providence, RI
Zip Code 02911

E-mail Franchescanavedo@yahoo.com
Phone 401-383-0717
Home/Office

401-767-7799
Mobile (Cell)

Owner: Jacky Ko

Address 1488 Mineral Spring Ave, N. Providence
Zip Code 02904

E-mail Jacky@Jackysrestaurant.com
Phone 401-353-0088
Home/Office

401-529-5383
Mobile (Cell)

Lessee: Francisca Polanco Navedo

Address 123 Olney Avenue, N. Providence, RI
Zip Code 02911

E-mail franchescanavedo@yahoo.com
Phone: 401-383-0717
Home/Office

401-767-7799
Mobile (Cell)

Does the proposal require review by any of the following (check each):

- Downtown Design Review Committee
- I-195 Redevelopment District Commission
- Capital Center Commission
- Historic District Commission

1. Location of Property: 200 Exchange Street, Unit B, Providence, RI 02903
Street Address

2. Zoning District(s): D1-Downtown
Special purpose or overlay district(s): _____

3a. Date owner purchased the Property: 11/19/2010

3b. Month/year of lessee's occupancy: January, 2019

3. Dimensions of each lot:

| | | | | | | | | |
|-------|-----|----------|--------|-------|--------|------------|-------|---------|
| Lot # | 102 | Frontage | 35' 3" | depth | 46' 5" | Total area | 1,643 | sq. ft. |
| Lot # | | Frontage | | depth | | Total area | | sq. ft. |
| Lot # | | Frontage | | depth | | Total area | | sq. ft. |

4. Size of each structure located on the Property:

| | | | |
|----------------------|----------------------------|--------------|-------------------------|
| Principal Structure: | Total gross square footage | 1643 sq. ft. | THIS IS THE AREA OF THE |
| Footprint | 1643 sq. ft. | Height | 11'-9" |
| | | Floors | 1 |

| | | |
|----------------------|----------------------------|--------|
| Accessory Structure: | Total gross square footage | |
| Footprint | | Floors |

| | | |
|-----------------------------------|-----------------------------|--------|
| 5. Size of proposed structure(s): | Total gross square footage: | N/A |
| Footprint | N/A | Floors |

6a. Existing Lot coverage: (include all buildings, decks, etc.) 1643 sq.ft.

6b. Proposed Lot coverage: (include new construction) N/A

7a. Present Use of Property (each lot/structure):
Rental Venue

7b. Legal Use of Property (each lot/structure) as recorded in Dept. of Inspection & Standards:
Flower Shop (NO. 105612) Will apply for building permit change to a Reception Venue.

8. Proposed Use of Property (each lot/structure):
Franchesca's at Waterplace is a premiere event venue location in waterplace park for corporate event weddings, special occasions, that could include live music/DJ as a source of entertainment.

9. Number of Current Parking Spaces: N/A

10. Describe the proposed construction or alterations (each lot/structure):
N/A

11. Are there outstanding violations concerning the Property under any of the following:

- Zoning Ordinance
- RI State Building Code
- Providence Housing Code

12. List all Sections of the Zoning Ordinance from which relief is sought and description of each section:

Table 12-1 For Reception Facility in the D1 district.

A facility that provides hosting and rental services of a banquet hall or similar facilities for private events including, but not limited to, wedding receptions, holiday parties, and fundraisers, with food and beverages that are prepared and served on-site or by a cater to invited guests during intermittent dates and hours of operation. Live entertainment maybe provided as an ancillary use as part of an event. A reception facility is not operated as a restaurant with regular hours of operation.

13. Explain the changes proposed for the Property.

Franchesca's at Waterplace, an amusement facility (event venue), would like to request a special use permit for use per zoning table 12-1 of reception facility as defined by section 1204. As an event venue, the guests that we host require various forms of music and entertainment at weddings and special events.

This would allow us to have live entertainment, music/DJ at our venue during booked dates. Thus bringing even more business to the city of Providence.

The undersigned acknowledge(s) and agree(s) that members of the Zoning Board of Review and its staff may enter upon the exterior of the Property in order to view the Property prior to any hearing on the application.

The undersigned further acknowledge(s) that the statements herein and in any attachments or appendices are true and accurate, and that providing a false statement in this application may be subject to criminal and/or civil penalties as provided by law, including prosecution under the State and Municipal False Claims Acts. Owner(s)/Applicant(s) are jointly responsible with their attorneys for any false statements.

Owner(s):

Jacky Ko

Type Name

Signature

Jacky Ko

Type Name

Signature

Applicant(s):

Francisca Polanco Navedo

Type Name

Signature

Francisca Polanco Navedo

Type Name

Signature

All requirements listed and described in the Instruction Sheet must be met or this application will not be considered complete.

APPENDIX B

APPLICATION(S) FOR SPECIAL USE PERMIT

1. **Identify the section(s) of the Ordinance that provides for the special use permit.**

Table 12-1 For Reception Facility in the D1 district.

A facility that provides hosting and rental services of a banquet hall or similar facilities for private events including, but not limited to, wedding receptions, holiday parties, and fundraisers, with food and beverages that are prepared and served on-site or by a cater to invited guests during intermittent dates and hours of operation. Live entertainment maybe provided as an ancillary use as part of an event. A reception facility is not operated as a restaurant with regular hours of operation.

2. **State all facts that demonstrate that the proposed special use will not substantially injure the use and enjoyment of neighboring property.**

- Franchesca's at Waterplace is located at the center of Waterplace park where many live events and entertainment often takes place.
- All music and live entertainment will take place within the venue.
- The surrounding area includes many venues approved for live entertainment, both indoor and outdoor, as found at Skyline at Waterplace.
- Waterfire events also take place right outside the doors of Franchesca's at Waterplace, which also offers live entertainment and music.

3. **State all facts that demonstrate that the proposed special use will not significantly devalue neighboring property.**

- Franchesca's at Waterplace is a high-end event venue for weddings, corporate events and special occasions, thus making Waterplace Park even more desirable.
- Being a premiere **indoor event venue**, all live music and entertainment will be kept at a reasonable level, as to not disturb neighboring properties.

4. **State all facts that demonstrate that the proposed special use will not be detrimental or injurious to the health or welfare of the community.**

- Franchesca's at Waterplace is up to date on all regulations and focused on providing pristine accommodations for our guests, including safety, cleanliness and upscale facilities.
- Special events like these, containing music and live entertainment, enhance the appeal of Waterplace Park, thus inviting even more people to come and enjoy what it has to offer.

**IF THE APPLICANT IS AN EDUCATIONAL OR HEALTH CARE INSTITUTION,
COMPLETE PAGES 10 AND 11 BELOW**

Franchesca's At Waterplace
 Lot-102 200 Exchange St Unit B
 Providence, RI 02903

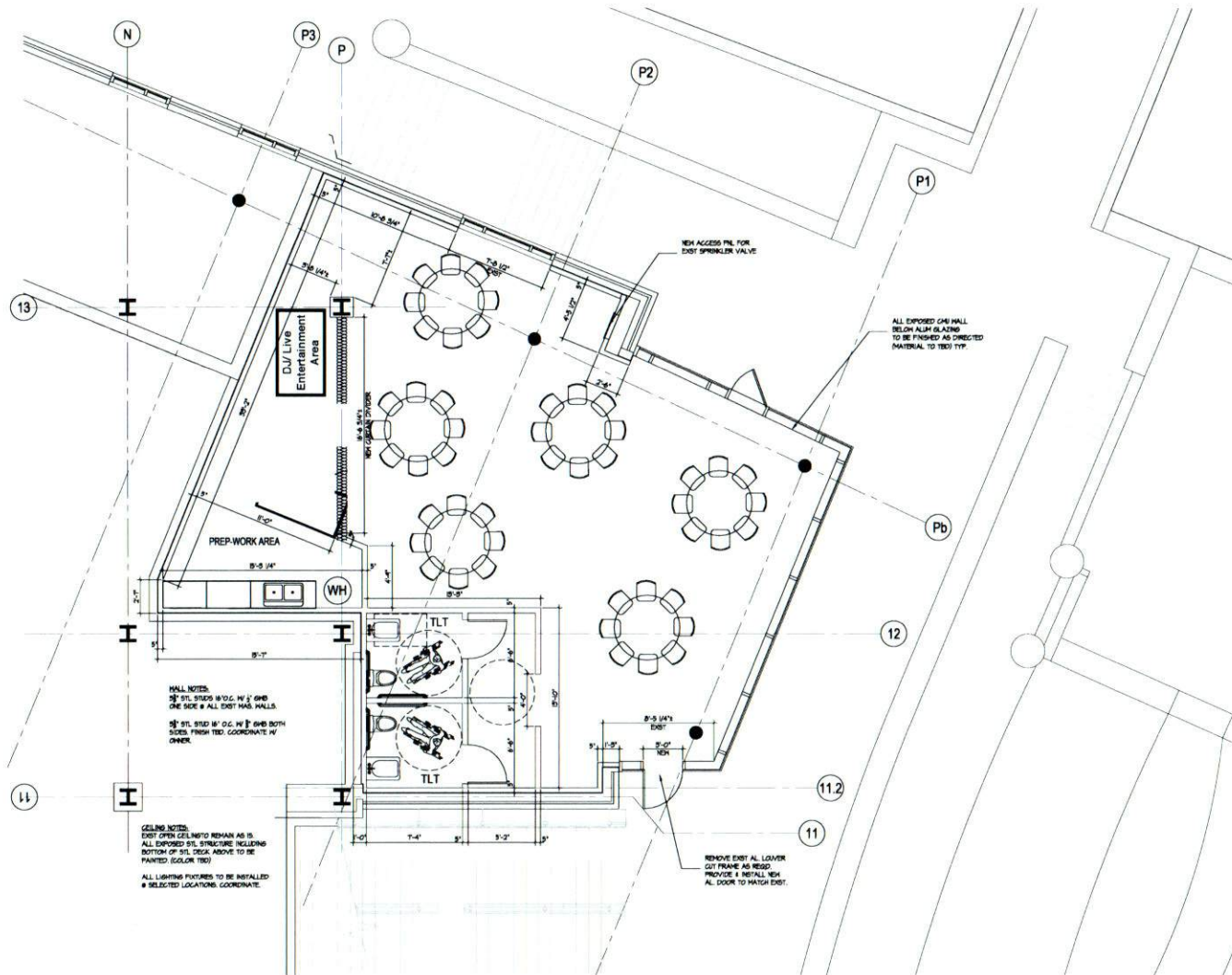

200ft Radius Plan
200 Exchange St Unit B
Lot 102 **November, 2019**



| PLAT | LOT | UNIT # | LOT ADDRESS | ZIP CODE | OWNER | OWNER ADDRESS | CITY | STATE | ZIP CODE | OWNER #2 | OWNER 2 ADDRESS | CITY | STATE | ZIP CODE |
|------|-----|--------|--------------------------|----------|---------------------------------|----------------------------------|------------------|-------|----------|---------------------------------|-------------------------|----------------|-------|----------|
| 019 | 118 | 0 | 1 Moshassuck Ct | 02903 | Capital Properties Inc | 5 Steeple St | Providence | RI | 02903 | | Steeple St | | | |
| 019 | 102 | 000A | 18 Finance Way | | Allogenic Holdings LLC | PO Box 584 | Providence | RI | 02901 | | PO Box 584 | | | |
| 019 | 102 | 000B | 18 Finance Way | | II LLC Jacky's Realty | 39 Riverview Dr | North Providence | RI | 02904 | | Riverview Dr | | | |
| 019 | 102 | C | 100 Exchange St Unit C | | Jacky's Realty II LLC | 383 Metacom Ave | Bristol | RI | 02809 | | Metacom Ave | | | |
| 019 | 102 | 000D | 100 Exchange St | 02903 | Imagine Brighter LLC | 100 Exchange St | Providence | RI | 02903 | | Exchange St | | | |
| 019 | 102 | 000E | 100 Exchange St | 02903 | Latorella-DiMille Pamela E | 170 Atlantic Ave | Warwick | RI | 02888 | DiMille Daniel R | 170 Atlantic Ave | Warwick | RI | 02888 |
| 019 | 102 | 000F | 100 Exchange St | 02903 | Holdings Allogenic | PO Box 584 | Providence | RI | 02901 | | PO Box 584 | | | |
| 019 | 102 | 201 | 100 Exchange St Unit 201 | 02903 | Zaller Marc | 100 Exchange St | Providence | RI | 2903 | | Shaw Rd | | | |
| 019 | 102 | 202 | 100 Exchange St | 02903 | Sullivan Martha | 100 Exchange St | Providence | RI | 2903 | | PO Box 526 | | | |
| 019 | 102 | 203 | 100 Exchange St | 02903 | Doberstein Cody A | 100 Exchange St | Providence | RI | 2903 | Doberstein Linda B Trustee | 123 Leonard Dr | Tiverton | RI | 02878 |
| 019 | 102 | 204 | 100 Exchange St 204 | 02903 | Juillard Louis | 100 Exchange St | Providence | RI | 02903 | Juillard Anne Marie | 100 Exchange St | Providence | RI | 02903 |
| 019 | 102 | 211 | 200 Exchange St Unit 211 | 02903 | Crespi Jeanne-Marie | 200 Exchange St | Providence | RI | 02903 | | Exchange St | | | |
| 019 | 102 | 213 | 200 Exchange St Unit 213 | 02903 | Strohecker Carol Trustee | 400 Marquette Ave | Minneapolis | MN | 55401 | | Marquette Ave #1711 Ave | | | |
| 019 | 102 | 214 | 200 Exchange St | 02903 | Wasserman Eric D Trustee | 200 Exchange St | Providence | RI | 02903 | | Exchange St | | | |
| 019 | 102 | 215 | 200 Exchange St Unit 215 | 02903 | Huang Jing | 200 Exchange St | Providence | RI | 02903 | Yu Hana | 200 Exchange St | Providence, RI | RI | 02903 |
| 019 | 102 | 217 | 200 Exchange St | 02903 | Byahatti Pramila | 200 Exchange St | Providence, RI | RI | 02903 | | Exchange St | | | |
| 019 | 102 | 301 | 100 Exchange St Unit 301 | 02903 | Mathur Arjun | 100 Exchange St | Providence | RI | 02903 | Mathur Anupam | 100 Exchange St | Providence | RI | 02903 |
| 019 | 102 | 302 | 100 Exchange St | 02903 | Bank Of America, NA | Harding and Carbon 3903 Bellaire | Houston | TX | 77025 | Parker, Jr, Co-Trustee Gordon L | 100 North Loop West | Providence | RI | 02903 |
| 019 | 102 | 304 | 100 Exchange St | 02903 | Cohen Evan | 100 Exchange St | Providence, RI | RI | 02903 | Cohen Anne | 100 Exchange St | Providence, RI | RI | 02903 |
| 019 | 102 | 306 | 100 Exchange St Unit 306 | 02903 | Krupa Michael H | 120 87th St | New York | NY | 10128 | | 87th St | | | |
| 019 | 102 | 307 | 100 Exchange St | 02903 | Dai Matthew | 100 Exchange St | Providence, RI | RI | 02903 | | Exchange St | | | |
| 019 | 102 | 312 | 200 Exchange St | 02903 | Kirtan Mehmet E | 200 Exchange St | Providence | RI | 02903 | | Exchange St | | | |
| 019 | 102 | 313 | 200 Exchange St Unit 313 | 02903 | Pascoe David F | 200 Exchange St | Providence | RI | 02903 | Pascoe Bonnie L | 200 Exchange St | Providence | RI | 02903 |
| 019 | 102 | 314 | 200 Exchange St Unit 314 | 02903 | Keolnthosone Ratsamy M | 200 Exchange St | Providence, RI | RI | 02903 | | Exchange St | | | |
| 019 | 102 | 316 | 200 Exchange St Unit 316 | 02903 | WALTON MARCUS B | 200 Exchange St | Providence | RI | 02903 | | Exchange St | | | |
| 019 | 102 | 317 | 200 Exchange St Unit 317 | 02903 | Riley Mary A | 200 Exchange St | Providence | RI | 02903 | | Exchange St | | | |
| 019 | 102 | 401 | 100 Exchange St Unit 401 | 02903 | Keefe Lawrence E | 100 Exchange St | Providence | RI | 02903 | | Exchange St | | | |
| 019 | 102 | 402 | 100 Exchange St Unit 402 | 02903 | Livingstone Matthew J | 100 Exchange St | Providence | RI | 02903 | | Exchange St | | | |
| 019 | 102 | 403 | 100 Exchange St | 02903 | Alexander Stephon | 100 Exchange St | Providence | RI | 02903 | | Exchange St | | | |
| 019 | 102 | 404 | 100 Exchange St | 02903 | Applegate Lynda | 100 Exchange St | Providence | RI | 02903 | McDonald Paul | 100 Exchange St | Providence | RI | 02903 |
| 019 | 102 | 405 | 100 Exchange St Unit 405 | 02903 | Braddon Regina Towne Trustee | 100 Exchange St | Providence | RI | 2903 | | Dutton St, Suite 401 | | | |
| 019 | 102 | 406 | 100 Exchange St Unit 406 | 02903 | Maldana Juan Carlos | 556 Natick Ave | Cranston | RI | 2921 | | Exchange St | | | |
| 019 | 102 | 407 | 100 Exchange St Unit 407 | 02903 | Xing Baoyue | 100 Exchange St | Providence | RI | 02903 | Zhang Zhe | 100 Exchange St | Providence | RI | 02903 |
| 019 | 102 | 411 | 200 Exchange St Unit 411 | 02903 | Lu Shao-Ning | 200 Exchange St | Providence | RI | 02903 | | Exchange St | | | |
| 019 | 102 | 412 | 200 Exchange St Unit 412 | 02903 | Haas Pamela | 200 Exchange St | Providence | RI | 02903 | | Exchange St | | | |
| 019 | 102 | 413 | 200 Exchange St Unit 413 | 02903 | Lustig Donald E Trustee | 200 Exchange St | Providence | RI | 02903 | | Exchange St | | | |
| 019 | 102 | 414 | 200 Exchange St Unit 414 | 02903 | McNulty Family Limited Partners | 573 Mendon Rd | Cumberland | RI | 02864 | | Mendon Rd | | | |
| 019 | 102 | 415 | 200 Exchange St Unit 415 | 02903 | Lam Chien Ya Joyce | 129 Summit Ave | Wakefield | RI | 02879 | | Summit Ave | | | |
| 019 | 102 | 417 | 200 Exchange St Unit 417 | 02903 | Malloy Gary T | 200 Exchange St | Providence | RI | 02903 | | Exchange St | | | |
| 019 | 102 | 501 | 100 Exchange St Unit 501 | 02903 | Leng Qin | 100 Exchange St | Providence | RI | 02903 | | Exchange St | | | |
| 019 | 102 | 504 | 100 Exchange St Unit 504 | 02903 | Mao Chenxi | 100 Exchange St | Providence | RI | 02903 | | Exchange St | | | |
| 019 | 102 | 505 | 100 Exchange St Unit 505 | 02903 | Razavinejad Arash | 100 Exchange St | Providence | RI | 02903 | | Exchange St | | | |
| 019 | 102 | 506 | 100 Exchange St Unit 506 | 02903 | Krupa Michael H | 120 87th St | New York | NY | 10128 | | 87th St | | | |
| 019 | 102 | 507 | 100 Exchange St Unit 507 | 02903 | Fausto-Sterling Anne Trustee | 100 Exchange St | Providence | RI | 02903 | Vogel Paula A Trustee | 100 Exchange St | Providence | RI | 02903 |
| 019 | 102 | 512 | 200 Exchange St Unit 512 | 02903 | Ahmad Omar K | 200 Exchange St | Providence | RI | 02903 | | Exchange St | | | |
| 019 | 102 | 513 | 200 Exchange St Unit 513 | 02903 | Vansant Charles Frederick | 200 Exchange St | Providence | RI | 02903 | Vansant Kavita Keswani | 200 Exchange St | Providence | RI | 02903 |
| 019 | 102 | 514 | 200 Exchange St Unit 514 | 02903 | Teunissen Byron | 200 Exchange St | Providence | RI | 02903 | Teunissen Lixlan | 200 Exchange St | Providence, RI | RI | 02903 |
| 019 | 102 | 516 | 200 Exchange St Unit 516 | 02903 | Lyeil Andrew | 200 Exchange St | Providence | RI | 02903 | | Exchange St | | | |
| 019 | 102 | 517 | 200 Exchange St Unit 517 | 02903 | Ames David A Trustee | 200 Exchange St | Providence | RI | 02903 | Landau Carol Trustee | 200 Exchange St | Providence, RI | RI | 02903 |
| 019 | 102 | 601 | 100 Exchange St Unit 601 | 02903 | Killenberg Christopher G | 100 Exchange St | Providence | RI | 02903 | Killenberg Susan D | 100 Exchange St | Providence | RI | 02903 |
| 019 | 102 | 603 | 100 Exchange St Unit 603 | 02903 | MONIZ MATTHEW J | 100 Exchange St | Providence | RI | 2903 | | Revolutionary Way | | | |
| 019 | 102 | 604 | 100 Exchange St Unit 604 | 02903 | Vincent Bartolini | 100 Exchange St | Providence | RI | 02903 | Bartolini Therese O | 100 Exchange St | Providence | RI | 02903 |
| 019 | 102 | 605 | 100 Exchange St Unit 605 | 02903 | Julia Shackelton | 100 Exchange St | Providence | RI | 02903 | | Exchange St | | | |
| 019 | 102 | 606 | 100 Exchange St Unit 606 | 02903 | Barros Rusdael | 20 Bayberry Ave | Provincetown | MA | 2657 | Andonian Scott | 100 Riverside Dr | Providence | RI | 02903 |
| 019 | 102 | 607 | 100 Exchange St | 02903 | Schoenfeld Larry J | 100 Exchange St | Providence | RI | 02903 | Schoenfeld Barbara B | 100 Exchange St | Providence | RI | 02903 |
| 019 | 102 | 611 | 200 Exchange St Unit 611 | 02903 | Volpe Lisa M | 200 Exchange St | Providence | RI | 02903 | Zarcaro Mark C | 200 Exchange St | Providence | RI | 02903 |
| 019 | 102 | 612 | 200 Exchange St Unit 612 | 02903 | Berman Meredith | 200 Exchange St | Providence | RI | 02903 | | Exchange St | | | |
| 019 | 102 | 613 | 200 Exchange St | 02903 | Srivastava Vikas | 200 Exchange St | Providence | RI | 02903 | Shukla Anita | 200 Exchange St | Providence | RI | 02903 |
| 019 | 102 | 614 | 200 Exchange St Unit 614 | 02903 | Ferris Peter | 200 Exchange St | Providence | RI | 02903 | Ferris Carolann | 200 Exchange St | Providence | RI | 02903 |
| 019 | 102 | 615 | 200 Exchange St Unit 615 | 02903 | DiBisce Michael Trustee | 200 Exchange St | PROVIDENCE | RI | 02903 | | Exchange St | | | |
| 019 | 102 | 616 | 100 Exchange St Unit 616 | 02903 | Roger Castellani | 15 Mechanic St | Provincetown | MA | 2657 | | Exchange St | | | |
| 019 | 102 | 617 | 200 Exchange St Unit 617 | 02903 | Salesi Paul J Trustee | 200 Exchange St | Providence | RI | 02903 | Salesi Maryann Trustee | 200 Exchange St | Providence, RI | RI | 02903 |
| 019 | 102 | 618 | 200 Exchange St Unit 618 | 02903 | Nakayama Thomas | 200 Exchange St | Providence | RI | 02903 | Karbonski David | 200 Exchange St | Providence | RI | 02903 |
| 019 | 102 | 701 | 100 Exchange St Unit 701 | 02903 | DIMITROV VALENTIN V | 100 Exchange St | Providence | RI | 2903 | | Bryant Ct | | | |
| 019 | 102 | 702 | 100 Exchange St | 02903 | Deeran Patel | 100 Exchange St | Providence | RI | 02903 | | 100 Exchange St | Providence | RI | 02903 |
| 019 | 102 | 704 | 100 Exchange St Unit 704 | 02903 | Gold Bruce M | 100 Exchange St | Providence | RI | 02903 | | Exchange St | | | |
| 019 | 102 | 705 | 100 Exchange St Unit 705 | 02903 | Talley James | 100 Exchange St | Providence | RI | 02903 | | Exchange St | | | |
| 019 | 102 | 706 | 100 Exchange St Unit 706 | 02903 | Paris Christopher | 100 Exchange St | Providence | RI | 02903 | | Exchange St | | | |
| 019 | 102 | 707 | 100 Exchange St | 02903 | Donnelly Constance A | 100 Exchange St | Providence | RI | 02903 | | Exchange St | | | |
| 019 | 102 | 712 | 200 Exchange St | 02903 | Boslego Jordan N | 200 Exchange St | Providence | RI | 02903 | | Exchange St | | | |
| 019 | 102 | 713 | 200 Exchange St Unit 713 | 02903 | Adams Mechelle G | 200 Exchange St | Providence | RI | 02903 | | Exchange St | | | |
| 019 | 102 | 714 | 200 Exchange St Unit 714 | 02903 | Nah Yu Jin | 200 Exchange St | Providence | RI | 02903 | | Exchange St | | | |
| 019 | 102 | 716 | 200 Exchange St | 02903 | Ferris Monte | 200 Exchange St | Providence | RI | 02903 | | Exchange St | | | |
| 019 | 102 | 717 | 200 Exchange St | 02903 | Wortman Paul M | 200 Exchange St | Providence | RI | 02903 | Wortman Camille B | 200 Exchange St | Providence | RI | 02903 |
| 019 | 102 | 801 | 100 Exchange St Unit 801 | 02903 | Lawrence P McCarthy | 100 Exchange St | Providence | RI | 02903 | McCarthy Sharon | 100 Exchange St | Providence | RI | 02903 |
| 019 | 102 | 803 | 100 Exchange St Unit 803 | 02903 | Gul Amber | 100 Exchange St | Providence | RI | 02903 | | Exchange St | | | |
| 019 | 102 | 804 | 100 Exchange St Unit 804 | 02903 | Sgourou Roxie | 100 Exchange St | Providence | RI | 02903 | Sgourou Thomas | 100 Exchange St | Providence | RI | 02903 |
| 019 | 102 | 805 | 100 Exchange St Unit 805 | 02903 | Kong Insu | 32 Happy Valley Rd | Westerly | RI | 02891 | Kong Mary Minn | 32 Happy Valley Rd | Westerly | RI | 02891 |
| 019 | 102 | 806 | 100 Exchange St Unit 806 | 02903 | Tezel Sinan | 100 Exchange St | Providence | RI | 02903 | | Exchange St | | | |
| 019 | 102 | 807 | 100 Exchange St | 02903 | Kerr Molly M | 100 Exchange St | Providence | RI | 02903 | | Exchange St | | | |

| | | | | | | | | | | | | | | |
|-----|-----|------|--------------------------------|-------|-------------------------------|------------------------------------------------------------|-----------------|----|-------|---------------------|----------------------------|----------------|----|-------|
| 019 | 102 | 1504 | 100 Exchange St | 02903 | Pellicio William J Trustee | 100 Exchange St | Providence | RI | 02903 | | Exchange St | | | |
| 019 | 102 | 1505 | 100 Exchange St Unit 1505 | 02903 | REMS LLC | 450 Veterans Memorial Pky | East Providence | RI | 02914 | | Veterans Memorial Pky | | | |
| 019 | 102 | 1506 | 100 Exchange St Unit 1506 | 02903 | Woodward Andrew A | 100 Exchange St | Providence | RI | 02903 | Woodward Kristen A | 100 Exchange St | Providence | RI | 02903 |
| 019 | 102 | 1507 | 100 Exchange St Unit 1507 | 02903 | Orellana Alexandra I | 100 Exchange St | Providence | RI | 02903 | | Exchange St | | | |
| 019 | 102 | 1511 | 200 Exchange St Unit 1511 | 02903 | Ducoff Robert J | 200 Exchange St | Providence | RI | 02903 | Ducoff Diane F | 200 Exchange St | Providence | RI | 02903 |
| 019 | 102 | 1512 | 200 Exchange St Unit 1512 | 02903 | Mcdermott Stemberg Thomas | 200 Exchange St | Providence | RI | 2903 | | 74th St | | | |
| 019 | 102 | 1513 | 200 Exchange St Unit 1513 | 02903 | Kraemer Michael F | 200 Exchange St | Providence, RI | RI | 02903 | Kraemer Ross F | 200 Exchange St | Providence, RI | RI | 02903 |
| 019 | 102 | 1514 | 200 Exchange St Unit 1514 | 02903 | Paolino Donna M Trustee | 100 Westminster St, Suite 1700 | Providence | RI | 02903 | | Westminster St, Suite 1700 | | | |
| 019 | 102 | 1601 | 100 Exchange St Unit 1601 | 02903 | Romero William | 100 Exchange St | Providence, RI | RI | 02903 | Romero Loretta M | 100 Exchange St | Providence, RI | RI | 02903 |
| 019 | 102 | 1602 | 100 Exchange St Unit 1602 | 02903 | Reeves Stamatis | 100 Exchange St | Providence, RI | RI | 02903 | | Exchange St | | | |
| 019 | 102 | 1603 | 100 Exchange St Unit 1603 | 02903 | Hager Susan | 100 Exchange St | Providence, RI | RI | 02903 | | Exchange St | | | |
| 019 | 102 | 1604 | 100 Exchange St | 02903 | Valentini Andrea B | 100 Exchange St | Providence | RI | 02903 | | Exchange St | | | |
| 019 | 102 | 1611 | 200 Exchange St Unit 1611 | 02903 | Spies Richard R | 200 Exchange St | Providence, RI | RI | 02903 | Spies Sandra M | 200 Exchange St | Providence, RI | RI | 02903 |
| 019 | 102 | 1614 | 200 Exchange St | 02903 | Nauman Joseph | 200 Exchange St | Providence, RI | RI | 02903 | | Exchange St | | | |
| 019 | 102 | 1701 | 100 Exchange St Unit 1701 | 02903 | Penrelli W Vincent Trustee | 100 Exchange St | Providence, RI | RI | 02903 | | Exchange St | | | |
| 019 | 102 | 1702 | 100 Exchange St | 02903 | Anderson Frohman Trustee | 100 Exchange St | Providence, RI | RI | 02903 | | SOUTH MAIN St | | | |
| 019 | 102 | 1703 | 100 Exchange St Unit 1703 | 02903 | Buerman Magnus G | 100 Exchange St | Providence | RI | 02903 | | Exchange St | | | |
| 019 | 102 | 1704 | 100 Exchange St | 02903 | Conroy Robert Trustee | 100 Exchange St | Providence | RI | 02903 | | Exchange St | | | |
| 019 | 102 | 1801 | 100 Exchange St Unit 1801 | 02903 | Percy Thomas J | 100 Exchange St | Providence, RI | RI | 02903 | | Exchange St | | | |
| 019 | 102 | 1802 | 100 Exchange St Unit 1802 | 02903 | Jack Elias | 100 Exchange St | Providence, RI | RI | 02903 | Elias Sandra L | 100 Exchange St | Providence, RI | RI | 02903 |
| 019 | 102 | 1803 | 100 Exchange St Unit 1803 | 02903 | Michael Mazzoja | 100 Exchange St | Providence, RI | RI | 02903 | | 100 Exchange St | Providence, RI | RI | 02903 |
| 019 | 102 | 1804 | 100 Exchange St | 02903 | Holland Amy E | 100 Exchange St | Providence, RI | RI | 02903 | Oliveira Nicholas P | 100 Exchange St | Providence, RI | RI | 02903 |
| 019 | 102 | BC85 | 500 Exchange St Unit BC85 | 02903 | Capitol Properties Inc | C/O Intercontinental Developers Inc 1270 Soldiers Field Rd | Boston | MA | 2135 | | Exchange St | | | |
| 019 | 102 | PH11 | 200 Exchange St Unit PH11 | 02903 | Kumar Rajiv | 200 Exchange St | Providence | RI | 02903 | | Exchange St | | | |
| 019 | 102 | PH12 | 200 Exchange St | 02903 | Chin Tamara | 200 Exchange St | Providence | RI | 02903 | Gandhi Leela | 200 Exchange St | Providence | RI | 02903 |
| 019 | 131 | 0 | 12 Memorial Blvd | 02903 | City Of Providence | 25 Dorrance St | Providence | RI | 02903 | | Dorrance St | | | |
| 019 | 114 | 0 | 5 Mashassuck Ct | 02903 | Capital Properties Inc | 5 Steeple St | Providence | RI | 02903 | | Steeple St | | | |
| 019 | 105 | 0 | 50 Park Row West | 02903 | Avalon Properties Inc | 671 GLEBE Rd | ARLINGTON | VA | 22203 | | GLEBE Rd | | | |
| 019 | 123 | 0 | 1 Finance Way | | State of Rhode Island | Providence, RI 02903 | Providence | RI | 02903 | | Providence, RI 02903 | | | |
| 019 | 115 | 0 | 65 Park Row West | 02903 | Capital Properties Inc | 49 Weybosset St | Providence | RI | 02903 | | Weybosset St | | | |
| 019 | 138 | 0 | 150 Memorial Blvd | 02903 | LLC UNION STREET PARKING | 1 CITIZENS PLZ | PROVIDENCE | RI | 02903 | | Exchange Ter | | | |
| 019 | 108 | 00TX | 15 Finance Way | | 15 Park Row West Holdings LLC | 7 St.Paul St | Baltimore | MD | 21202 | | St.Paul St | | | |
| 019 | 102 | 0802 | 100 Exchange St | 02903 | Zhang Yong Ming Trustee | 285 Rumstick Rd | Barrington | RI | 02806 | | | | | |
| 019 | 102 | 0502 | 100 Exchange St Unit 502 | 02903 | Leng Qin | 100 Exchange St | Providence | RI | 02903 | | | | | |
| 019 | 102 | 0602 | 100 Exchange St Unit 602 | 02903 | Shammas Ines | 100 Exchange St | Providence | RI | 02903 | | | | | |
| 019 | 102 | 1101 | 18 Finance Way Unit 1101 | | Feo Dimitri | 100 Exchange St | Providence | RI | 02903 | | | | | |
| 019 | 102 | 1016 | 100 Exchange St | 02903 | Gabrielle Mark L | 200 Exchange St | Providence | RI | 02903 | | | | | |
| 019 | 102 | 1413 | 200 Exchange St Unit 1413 | 02903 | Trilla Francisco | 200 Exchange St | Providence | RI | 02903 | | | | | |
| 019 | 102 | 416 | 200 Exchange St Unit 416 | 02903 | Baustina Karmina Elma P | 200 Exchange St | Providence | RI | 02903 | | | | | |
| 019 | 102 | 1612 | 200 Exchange St Unit 1612 | 02903 | Stupell Todd | 200 Exchange St | Providence, RI | RI | 02903 | | | | | |
| 019 | 102 | 453 | 1000 Providence Place Unit 453 | 02903 | Wong Tin Lai | 1000 Providence Pl | Providence | RI | 02903 | | | | | |

Capital Properties Inc
5 Steeple St
Providence RI, 02903

Allogenic Holdings LLC
PO Box 584 000A
Providence RI, 02901

II LLC Jacky's Realty
39 Riverview Dr 000B
North Providence RI, 02904

Jackys Realty II LLC
383 Metacom Ave C
Bristol RI, 02809

Imagine Brighter LLC
100 Exchange St 000D
Providence RI, 02903

Pamela E Latorella-DiMille
170 Atlantic Ave 000E
Warwick RI, 02888

Holdings Allogenic
PO Box 584 000F
Providence RI, 02901

Marc Zaller
100 Exchange st 201
Providence RI, 2903

Martha Sullivan
100 Exchange st 202
Providence RI, 2903

Cody A Doberstein
100 Exchange St 203
Providence RI, 2903

Louis Juillard
100 Exchange St 204
Providence RI, 02903

Jeanne-Marie Crespi
200 Exchange St 211
Providence RI, 02903

Trustee Carol Strohecker
400 Marquette Ave 213
Minneapolis MN, 55401

Trustee Eric D Wasserman
200 Exchange St 214
Providence RI, 02903

Jing Huang
200 Exchange St 215
Providence RI, 02903

Julia R Shackelton
100 Exchange St
Providence, RI 02903

Pramila Byahatti
200 Exchange St 217
Providence, RI RI, 02903

Arjun Malthur
100 Exchange St 301
Providence RI, 02903

Bank Of America, NA
C/O Harding and Carbon 3903
Bellaire Blvd 302
Houston TX, 77025

Evan Cohen
100 Exchange St 304
Providence, RI RI, 02903

Michael H Krupa
120 87th St 306
New York NY, 10128

Matthew Dai
100 Exchange St 307
Providence, RI RI, 02903

Mehmet E Kirtan
200 Exchange St 312
Providence RI, 02903

David F Pascoe
200 Exchange St 313
Providence RI, 02903

Ratsamy M Keointhisone
200 Exchange St 314
Providence, RI RI, 02903

MARCUS B WALTON
200 Exchange St 316
Providence RI, 02903

Mary A Riley
200 Exchange St 317
Providence RI, 02903

Lawrence E Keefe
100 Exchange St 401
Providence RI, 02903

Matthew J Livingstone
100 Exchange St 402
Providence RI, 02903

Stephon Alexander
100 Exchange St 403
Providence RI, 02903

Lynda Applegate
100 Exchange St 404
Providence RI, 02903

Trustee Regina Towne
Bragdon
100 Exchange st 405 405
Providence RI, 2903

Juan Carlos Maidana
556 Natick Ave 406
Cranston RI, 2921

Baoyue Xing
100 Exchange St 407
Providence RI, 02903

Shao-Ning Lu
200 Exchange St 411
Providence RI, 02903

Pamela Haas
200 Exchange St 412
Providence RI, 02903

Trustee Donald E Lustig
200 Exchange St 413
Providence RI, 02903

Mcnulty Family Limited
Partnership for Realty
573 Mendon Rd 414
Cumberland RI, 02864

Lam Chien Ya Joyce
129 Summit Ave 415
Wakefield RI, 02879

Gary T Malloy
200 Exchange St 417
Providence RI, 02903

Qin Leng
100 Exchange St 501
Providence RI, 02903

Chenxi Mao
100 Exchange St 504
Providence RI, 02903

Arash Razavinejad
100 Exchange St 505
Providence RI, 02903

Michael H Krupa
120 87th St 506
New York NY, 10128

Trustee Anne Fausto-Sterling
100 Exchange St 507
Providence RI, 02903

Omar K Ahmad
200 Exchange St 512
Providence RI, 02903

Charles Frederick Vansant
200 Exchange St 513
Providence RI, 02903

Byron Teunisen
200 Exchange St 514
Providence RI, 02903

Andrew Lyell
200 Exchange St 516
Providence RI, 02903

Trustee David A Trustee Ames
200 Exchange St 517
Providence RI, 02903

Christopher G Killenberg
100 Exchange St 601
Providence RI, 02903

MATTHEW J MONIZ
100 Exchange St 603
Providence RI, 2903

Vincent Bartolini
100 Exchange St 604
Providence RI, 02903

Rusdael Barros
20 Bayberry Ave 606
Provincetown MA, 2657

Larry J Schoenfeld
100 Exchange St 607
Providence RI, 02903

Lisa M Volpe
200 Exchange St 611
Providence RI, 02903

Meredith Berman
200 Exchange St 612
Providence RI, 02903

Vikas Srivastava
200 Exchange St 613
Providence RI, 02903

Peter Ferris
200 Exchange St 614
Providence RI, 02903

Trustee Michael DiBiase
200 Exchange St 615
PROVIDENCE RI, 02903

Roger Castellani
15 Mechanic St 616
Provincetown MA, 2657

Trustee Paul J Salesi
200 Exchange St 617
Providence RI, 02903

Thomas Nakayama
200 Exchange St 618
Providence RI, 02903

VALENTIN V DIMITROV
100 Exchange St 701
Providence RI, 2903

Deeran Patel
100 Exchange St 702
Providence RI, 02903

Bruce M Gold
100 Exchange St 704
Providence RI, 02903

James Talley
100 Exchange St 705
Providence RI, 02903

Christopher Parisi
100 Exchange St 706
Providence RI, 02903

Constance A Donnelly
100 Exchange St 707
Providence RI, 02903

Jordan N Boslego
200 Exchange St 712
Providence RI, 02903

Mechelle G Adams
200 Exchange St 713
Providence RI, 02903

Nah Yu Jin
200 Exchange St 714
Providence RI, 02903

Monte Ferris
200 Exchange St 716
Providence RI, 02903

Paul M Wortman
200 Exchange St 717
Providence RI, 02903

Lawrence P McCarthy
100 Exchange St 801
Providence RI, 02903

Amber Gul
100 Exchange St 803
Providence RI, 02903

Roxie Sgouros
100 Exchange St 804
Providence RI, 02903

Insu Kong
32 Happy Valley Rd 805
Westerly RI, 02891

Sinan Tezel
100 Exchange St 806
Providence RI, 02903

Molly M Kerr
100 Exchange St 807
Providence RI, 02903

Joseph M Farrar
200 Exchange St 811
Providence RI, 02903

Seema Amin
200 Exchange St 812
Providence RI, 2903

200 Exchange Street Unit 813,
LLC
56 Lancashire Dr 813
Mansfield MA, 02048

McNulty Family Limited
Partnership For Realty
573 Mendon Rd 814
Cumberland RI, 02864

John F Jr Reid
PO Box 788 815
West Falmouth MA, 02574

Trustee Robert S Kingsbury
358 Route 113 817
Holderness NH, 03245

Gregg A Cutlip
200 Exchange St 818
Providence RI, 02903

George P Tager Jr
100 Exchange St 901
Providence RI, 02903

Anthony Italiano
228 Tether Way 902
Doylestown PA, 18901

Roberto Serrano
100 Exchange St 904
Providence RI, 02903

Dilek Arikan
100 Exchange St 905
Providence, RI RI, 02903

Cara E Ogar
100 Exchange St 906
Providence RI, 02903

Andrew S Lyell
100 Exchange St 907
Providence RI, 02903

Stephen Biondi
200 Exchange St 912
Providence RI, 02903

John Sepe
200 Exchange St 914
Providence RI, 02903

Annie Wang
200 Exchange St 916
Providence RI, 02903

Laila Qadan
200 Exchange St 917
Providence RI, 02903

James E Griffin Jr
100 Exchange St PH1
Providence RI, 02903

James M Cerullo
100 Exchange St PH2
Providence RI, 02903

Trustee Frederick N Levinger
100 Exchange St PH3
Providence RI, 02903

Robert Ricci
100 Exchange St 1001
Providence RI, 02903

Zhong Zhang
12 Bluff Head Rd 1002
Sharon MA, 02067

Trustee Carolyn J Dagostino
100 Exchange St 1003
Providence RI, 02903

Harvey J Makadon
100 Exchange St 1004
Providence RI, 02903

Xiaowen Lin
100 Exchange St 1005
Providence RI, 02903

Jo Marie Maxson
100 Exchange St 1006
Providence RI, 02903

Robert F Stupell
100 Exchange St 1007
Providence RI, 02903

Liu Wang
200 Exchange St 1011
Providence RI, 02903

Carolina Jimenez Madiedo
200 Exchange St 1012
Providence RI, 02903

Todd Stupell
200 Exchange St 1013
Providence RI, 02903

Elizabeth M Martino
200 Exchange St 1014
Providence RI, 02903

Logan Powell
200 Exchange St 1015
Providence RI, 02903

Stanley J Casper Co-Trustees
17 La Panta St 1017
Orinda CA, 94563

David Litwin
200 Exchange St 1018
Providence RI, 02903

Faisal Zubair
100 Exchange St 1102
Providence RI, 2903

Maureen L Harkavy
100 Exchange St 1104
Providence RI, 02903

Stephanie Ann Jacobson-Landon
100 Exchange St 1105
Providence RI, 02903

Vinay Rao
100 Exchange St 1106
Providence RI, 02903

Charles K Tashima
100 Exchange St 1107
Providence RI, 02903

David B Choi
200 Exchange St 1112
Providence RI, 02903

William N Tiftt
200 Exchange St 1113
Providence RI, 02903

Siqi Yao
200 Exchange St 1114
Providence RI, 02903

Vitaly Sorkin
200 Exchange St 1116
Providence RI, 2903

SAMUEL J SHAMOON
200 Exchange St 1117
PROVIDENCE RI, 02903

David J Valletta
PO Box 472 1201
CLINTON CT, 06413

Ning Cai
100 Exchange St 1202
Providence RI, 02903

Sani Kubilay Konukoglu
100 Exchange St 1203
Providence RI, 02903

Peter P Marsiglia
100 Exchange St 1204
Providence RI, 02903

Tam John Chi On Trustee
100 Exchange St 1205
Providence RI, 2903

Louis M Amoriggi
100 Exchange St 1206
Providence RI, 02903

Mcnulty Family Limited
Partnership for Realty
573 Mendon Rd 1207
Cumberland RI, 02864

Siu Roberto Trustee
200 Exchange St 1211
Providence RI, 02903

Richard K Lim
200 Exchange St 1212
Providence RI, 02903

Lee S Golden
200 Exchange St 1213
Providence RI, 02903

Jonathan D Arruda
200 Exchange St 1214
Providence RI, 02903

Ellen M Corneau
200 Exchange St 1215
Providence RI, 02903

Living Trust Richard L Gold
200 Exchange St 1216
Providence RI, 02903

Trustee Lisa M Abbott
200 Exchange St 1217
Providence RI, 02903

Thomas Moloney
200 Exchange St 1218
Providence RI, 02903

Joyce Ambrosino
100 Exchange St 1301
Providence RI, 02903

Rafaelina Gomez
100 Exchange St 1302
Providence RI, 02903

Debra Sue Rose
100 Exchange St 1304
Providence RI, 02903

Trevor Parente
100 Exchange St 1305
Providence RI, 02903

Ralph Rodriguez
100 Exchange St 1306
Providence RI, 02903

David L McVicker
100 Exchange St 1307
Providence RI, 02903

Geanina O Costea
200 Exchange St 1312
Providence RI, 02903

E Alcaraz Achilles Romualdo
200 Exchange St 1313
Providence RI, 02903

Kumar Meetesh
200 Exchange St 1314
Providence RI, 02903

Donna L Golemme
 20 Dassance Dr 1316
 Foxboro MA, 02035

Mark A Male
 200 Exchange St 1317
 Providence RI, 02903

Michael McMullen
 100 Exchange St 1401
 Providence RI, 02903

Richman Tiger LLC
 12 Slyvan Glen Ct 1403
 Burr Ridge IL, 60527

Xue Suizhou
 100 Exchange St 1404
 Providence RI, 02903

Hamdali Adelhaq
 100 Exchange St 1405
 Providence RI, 02903

Marianne Tracy
 100 Exchange St 1406
 Providence RI, 02903

Holly Senocak
 100 Exchange St 1407
 Providence RI, 02903

Melvin G Alperin
 200 Exchange St 1411
 Providence RI, 02903

Exchange Street LLC
 21 Danfield Rd 1412
 St Louis MO, 63124

Trustee Constance Lee
 Donnelly
 200 Exchange St 1414
 Providence RI, 02903

Wong Tin Lai J
 903 PROVIDENCE PI 1501
 PROVIDENCE RI, 02903

Naresh K Dasari
 100 Exchange St 1502
 Providence RI, 02903

Trustee William J Pellicio
 100 Exchange St 1504
 Providence RI, 02903

REMS LLC
 450 Veterans Memorial Pky 1505
 East Providence RI, 02914

Andrew A Woodward
 100 Exchange St 1506
 Providence RI, 02903

Alexandra I Orellana
 100 Exchange St 1507
 Providence RI, 02903

Robert J Ducoff
 200 Exchange St 1511
 Providence RI, 02903

Mcdermott Stemberg Thomas
 200 Exchange st 1512
 Providence RI, 2903

Michael F Kraemer
 200 Exchange St 1513
 Providence, RI RI, 02903

Trustee Donna M Paolino
 100 Westminster St, Suite 1700
 1514
 Providence RI, 02903

William Romero
 100 Exchange St 1601
 Providence, RI RI, 02903

Stamatis Reeves
 100 Exchange St 1602
 Providence, RI RI, 02903

Susan Hager
 100 Exchange St 1603
 Providence, RI RI, 02903

Andrea B Valentini
 100 Exchange St 1604
 Providence RI, 02903

Richard R Spies
 200 Exchange St 1611
 Providence, RI RI, 02903

Joseph Nauman
 200 Exchange St 1614
 Providence, RI RI, 02903

Perrelli W Vincent Trustee
 100 Exchange St 1701
 Providence, RI RI, 02903

Trustee Frohman Anderson
 100 Exchange St 1702
 Providence, RI RI, 02903

Magnus G Buerman
 100 Exchange St 1703
 Providence RI, 02903

Trustee Robert Conroy
 100 Exchange St 1704
 Providence RI, 02903

Thomas J Percy
 100 Exchange St 1801
 Providence, RI RI, 02903

Jack A Elias
 100 Exchange St 1802
 Providence, RI RI, 02903

Micheal Mazzola
 100 Exchange St 1803
 Providence, RI RI, 02903

Amy E Holland
 100 Exchange St 1804
 Providence, RI RI, 02903

Capitol Properties Inc
 C/O Intercontinental Developers
 InC 1270 Soldeirs Field Rd BCBS
 Boston MA, 2135

Rajiv Kumar
 200 Exchange St PH11
 Providence RI, 02903

Tamara Chin
 200 Exchange St PH12
 Providence RI, 02903

City Of Providence
 25 Dorrance St 0
 Providence RI, 02903

Capital Properties Inc
 5 Steeple St 0
 Providence RI, 02903

Avalon Properties Inc
 671 GLEBE Rd 0
 ARLINGTON VA, 22203

State of Rhode Island
 Providence, RI 02903 0
 Providence RI, 02903

Capital Properties Inc
 49 Weybosset St 0
 Providence RI, 02903

LLC UNION STREET PARKING
 1 CITIZENS PLZ 0
 PROVIDENCE RI, 02903

15 Park Row West Holdings LLC
 7 St.Paul St 00TX
 Baltimore MD, 21202

Zhang Yong Ming Trustee
 285 Rumstick Rd 0802
 Barrington RI, 02806

Qin Leng
 100 Exchange St 0502
 Providence RI, 02903

Ines Shammass
 100 Exchange St 0602
 Providence RI, 02903

Dimitri Feo
 100 Exchange St 1101
 Providence RI, 02903

Mark L Gabrielle
 200 Exchange St 1016
 Providence RI, 02903

Trilla Francisco
 200 Exchange St 1413
 Providence RI, 02903

Baustina Karmina Elma P
 200 Exchange St 416
 Providence RI, 02903

Stupell Todd Gabrielle
 200 Exchange St 1612
 Providence, RI RI, 02903

Tin Lai Wong
 1000 Providence Pl Unit 453
 Providence, RI 02903

Ehsan Afshin
 100 Exchange St 305
 Providence RI, 02903

Palumbo Joseph
 200 Exchange St 1613
 Providence, RI RI, 02903

Wong Tin Lai
 1000 Providence Pl 453
 Providence RI, 02903

Patel Sonal J
 200 Exchange St 816
 Providence, RI RI, 02903

Bautista Karmina Elma P
 200 Exchange St 418
 Providence RI, 02903



State of Rhode Island and Providence Plantations
 Department of State - Business Services Division

RECEIVED
 R.I. DEPT. OF STATE
 BUS SVCS DIV
 2013 NOV 28 AM 11:15

Fictitious Business Name Statement
 DOMESTIC or FOREIGN Limited Liability Company

→ Filing Fee: \$50.00

Pursuant to the provisions of RIGL 7-16-9 the undersigned limited liability company hereby submits the following statement for authority to transact business in the state of Rhode Island under a fictitious business name:

| | |
|----------------------------------------------------------------------------------------------------------------------------------------------------------------------------|---------------------------------------------------------------------------------------------------|
| 1. Entity ID Number 1083157 | 2. Exact Name of the Limited Liability Company FRANCESCO'S event and Floral Design, LLC |
| 3. The fictitious business name to be used is: FRANCESCO'S UNDER PARK | |
| 4. The limited liability company is organized under the laws of: RI | 5. The date of formation is: 03-11-15 |
| 6. Applicant is otherwise authorized to do business in the state of Rhode Island. | |
| Under penalty of perjury, I declare and affirm that I have examined this Fictitious Business Name Statement and that the information contained herein is true and correct. | |
| Name of Applicant Limited Liability Company FRANCESCO'S event and Floral Design, LLC | Date 11/28/16 |
| Signature of Authorized Person FRANCESCO'S event and Floral Design, LLC | |

MAIL TO:
 Division of Business Services
 148 W. River Street, Providence, Rhode Island 02904-2000
 Phone: (401) 222-3349
 Website: www.sos.ri.gov

FILED

NOV 28 2013

BY _____

If you have any questions, please call us at (401) 222-3040, Monday through Friday, between 9:30 a.m. and 4:30 p.m., or email corporations@sos.ri.gov.

FORM 62 (B) LLC - Revised: 1/2017