





# P

## Providence Bicycle and Pedestrian Advisory Commission

Jorge O. Elorza, Mayor

### Project Description

The Woonasquatucket River Greenway has been in development since 1994. It features a mixture of on-road and off-road segments connecting from the Providence Place Mall into Johnston. The section on Kinsley Ave and Promenade St is one of the oldest designated on-road portions, and has long been discussed for upgrading to a separated trail along the River.

The plans call for such a separated path, alongside the southern side of the river (Kinsley Ave and Providence Place) between Eagle Street and Bath Street, and along the north side of the river (Promenade Street) between Bath Street and Park Street. Kinsley Ave is planned to be converted to one-way car traffic, and throughout the corridor the plan includes new green space for stormwater retention and truck aprons to ensure abutting properties are able to maintain their operational needs. The path is planned to cross the river at the Sculpture Bridge near Bath Street, and connect to the ramp under the mall at Park Street.

Details of the plans are shown on the attached slides from the May public meeting.

Respectfully submitted by Alex Ellis.

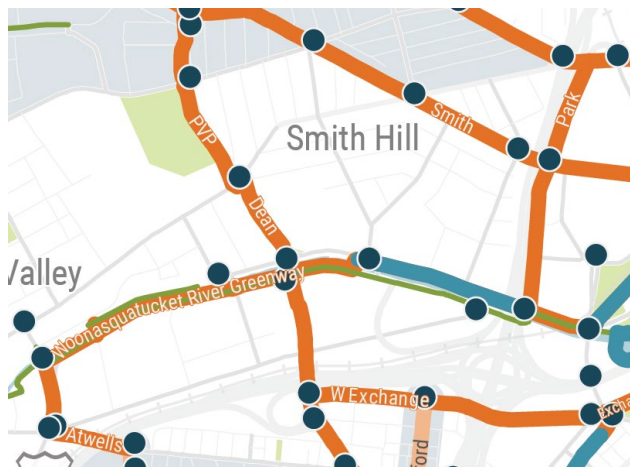

*Urban Trail Network map from Great Streets Plan, showing area around the project*



# WOONASQUATUCKET RIVER GREENWAY



MAYOR JORGE O. ELORZA  
CITY OF PROVIDENCE

WOONASQUATUCKET  
RIVER  
**GREENWAY**



WOONASQUATUCKET RIVER  
WATERSHED COUNCIL

**Public Meeting #2**  
**May 28, 2020**



# Today's Agenda

- **Welcome**
- **Virtual Meeting Instructions**
- **Opening Remarks**
- **Presentation: Preferred Concept**
- **Public Questions & Comments**
- **Next Steps**



# Virtual Meeting Instructions

- Presentation is being recorded and will be posted online
- Participants automatically muted
- Chat window available for questions or help
  - Questions may be submitted via chat at any time and will be addressed during public Q&A
- Participants can be removed for inappropriate behavior

Ask a  
Question

Turn on  
Spanish  
Subtitles

Bottom Panel of  
Zoom Screen



Raise Hand



Q&A



Closed Caption



# Opening Remarks

- **Mayor Jorge Elorza**



# Opening Remarks

- **Council President Sabina Matos**



# Corridor History:

## The Woonasquatucket River Greenway

- **1994:**
  - Fred Lippitt, Chair of the Providence Plan, creates Woonasquatucket River Greenway Project (WRGP), to help revitalize Olneyville
    - ✓ Most economically challenged neighborhood in PVD
    - ✓ No safe parks
    - ✓ 60% of people do not own cars
- **1998:**
  - Woonasquatucket River designated an American Heritage River
- **2001:**
  - Woonasquatucket River Watershed Council (WRWC) created





# Corridor History:

## The Woonasquatucket River Greenway

- **2001:**
  - First on-road segment of Greenway completed from Providence Place to Valley Street
- **2006 - 2014:**
  - Kinsley Ave to Lyman Ave in Johnston off-road sections completed
  - Buttonhole Golf Course off-road
  - Eagle Square off-road
  - Donigian Park off-road
  - Woonasquatucket Adventure Park off-road
- **Today:**
  - 75 acres of parkland created along river
  - 6 well used public parks created or revitalized
  - 7 miles of on-road/off-road Greenway in Providence and Johnston
  - Invasive plants managed on all 7 miles
  - Red Shed Bike Camp teaches 100 kids to ride on Greenway every summer
  - Leveraged over \$120M for Greenway, Parks





# Corridor History: The Woonasquatucket River Greenway

- Transforming Public Spaces

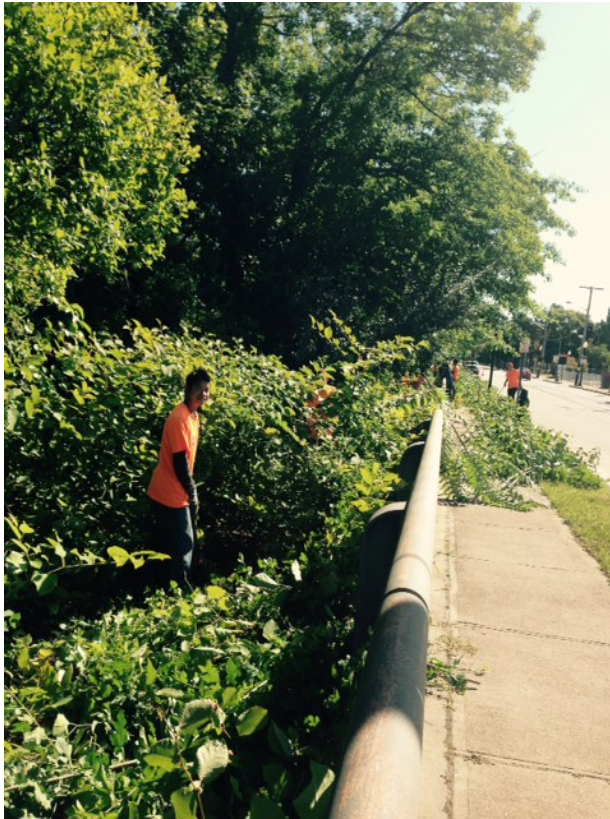



# Corridor History:

## The Woonasquatucket River Greenway

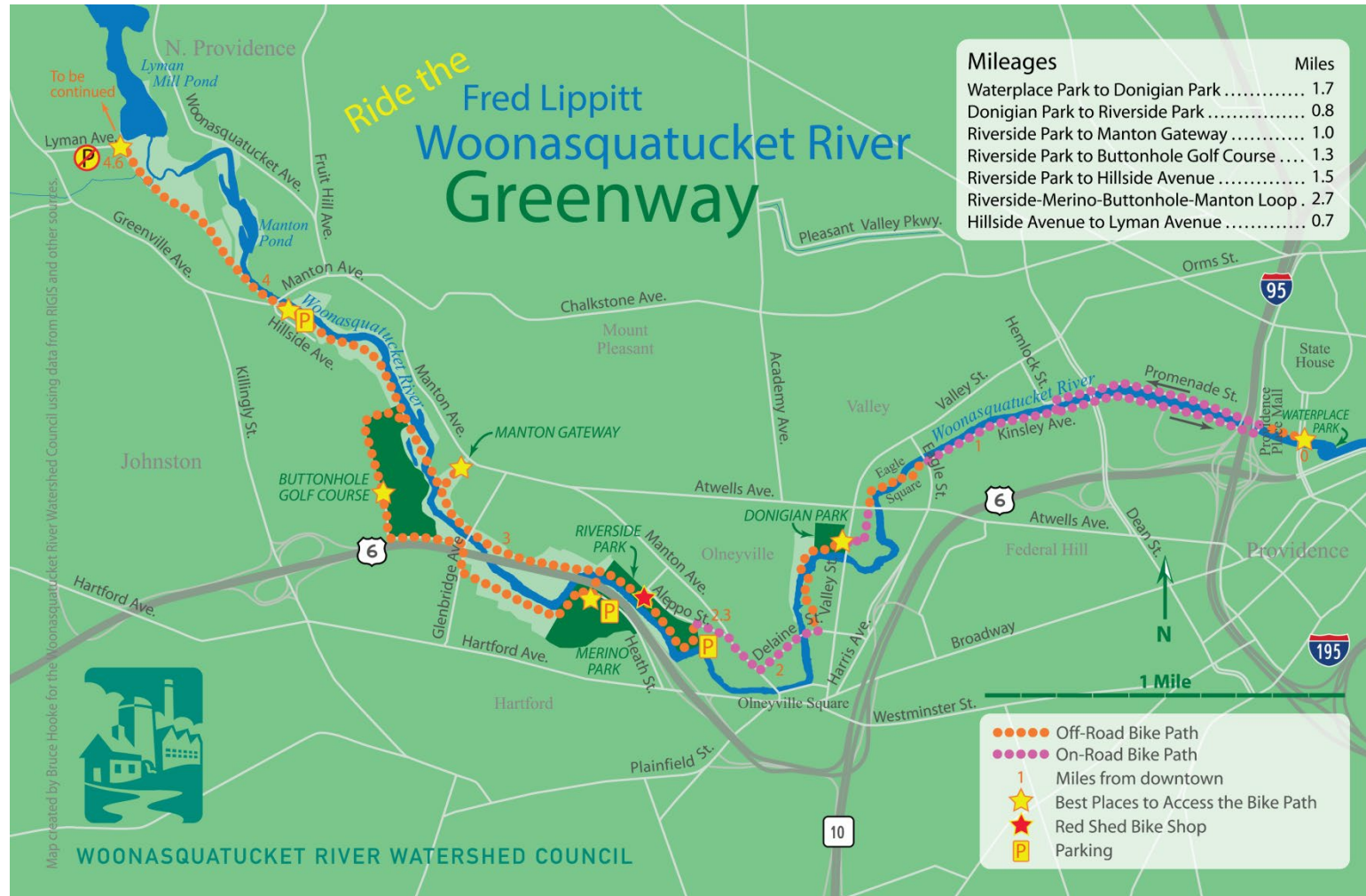



# Corridor History: The Woonasquatucket Vision Plan (2018)

OVERALL ILLUSTRATIVE PLAN

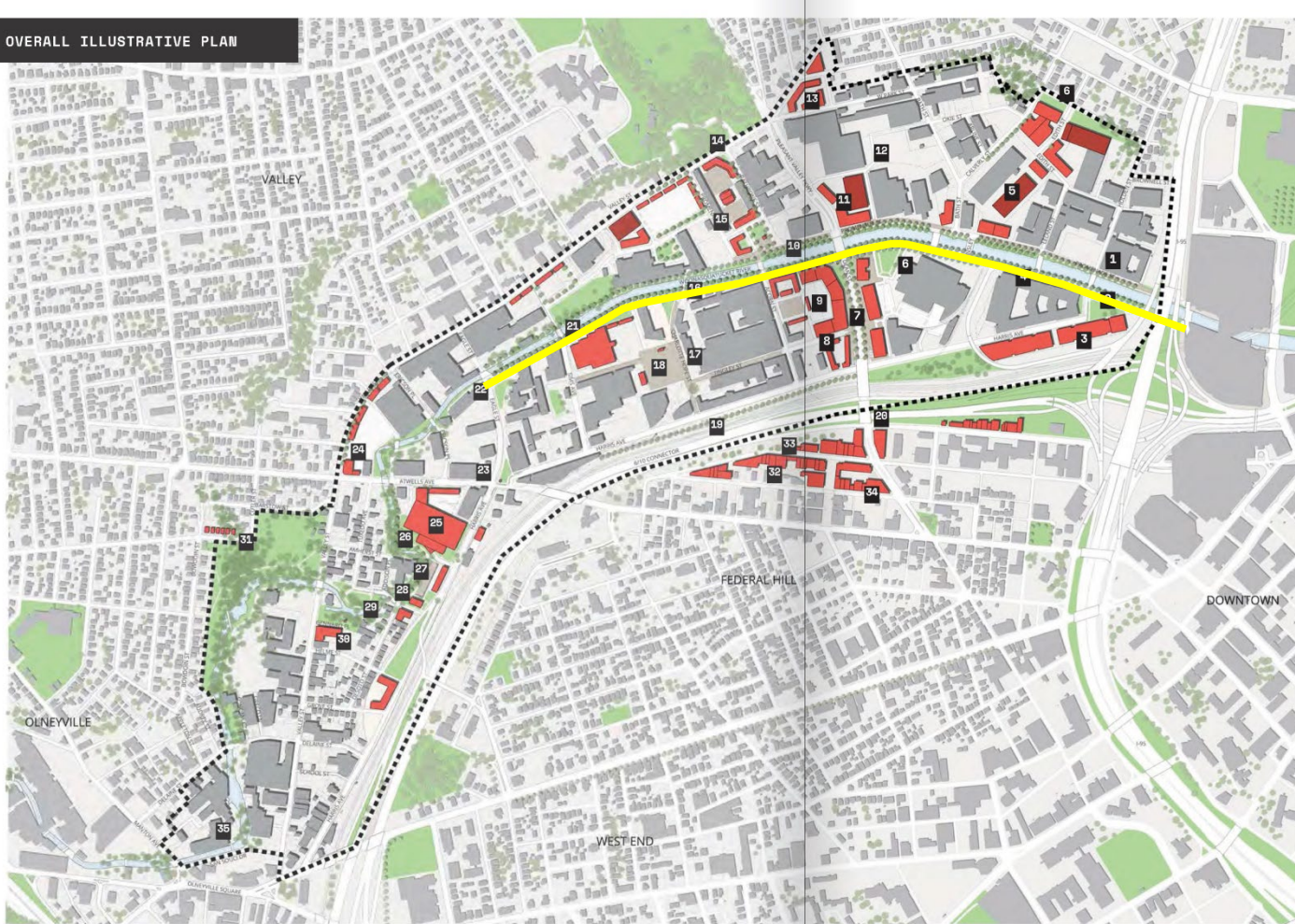

## ■ Vision Plan Goals:

- Improve Sustainability and Resiliency
- Support and Grow the Existing Economic Cluster around Arts, Food, and Makers
- Preserve and Create Affordable Space
- Improve Access and Connectivity
- Enhance and Maintain Public Spaces



# Scope and Schedule

- **Project themes**

- Improve safety of people walking and riding bicycles
- Enhance access to the river
- Improve connectivity between Olneyville, Valley, Smith Hill and Downtown
- Mitigate flooding and improve water quality

- **Community Engagement**

- **Process**

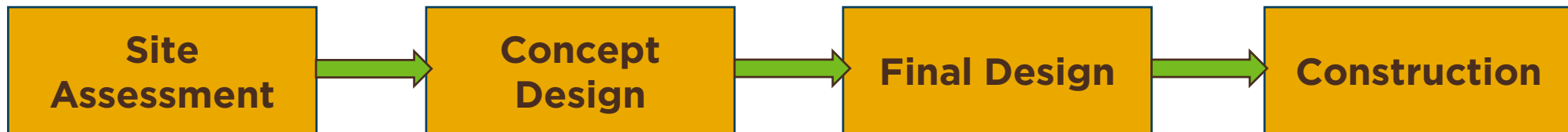



# Scope and Schedule

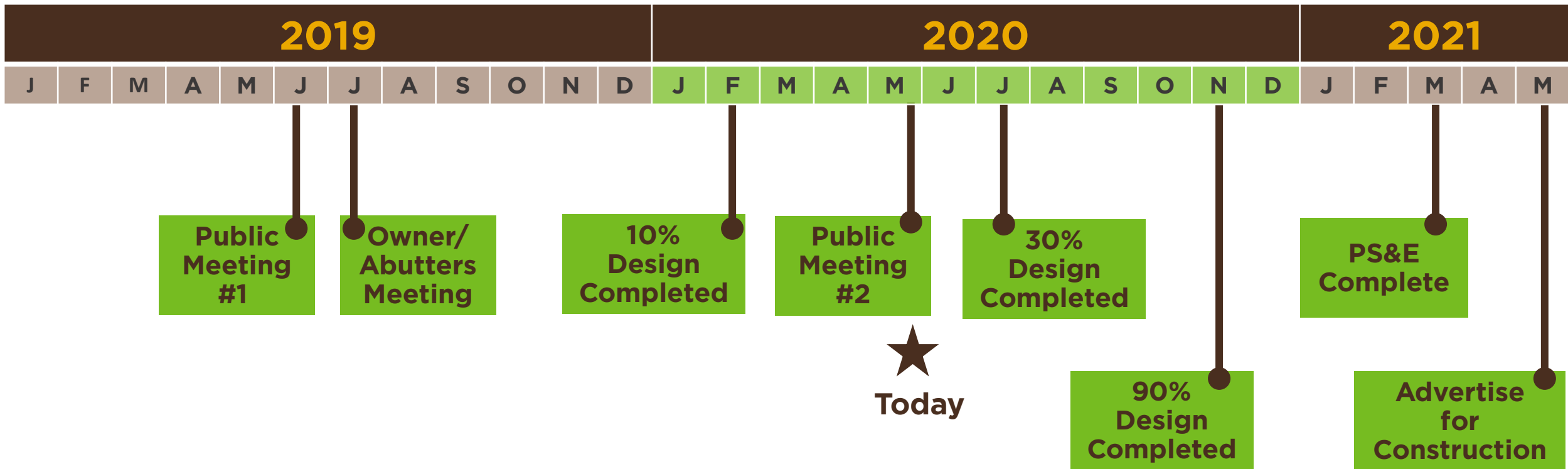



# Preferred Concept – Rendering









# Preferred Concept – Engineering Plans

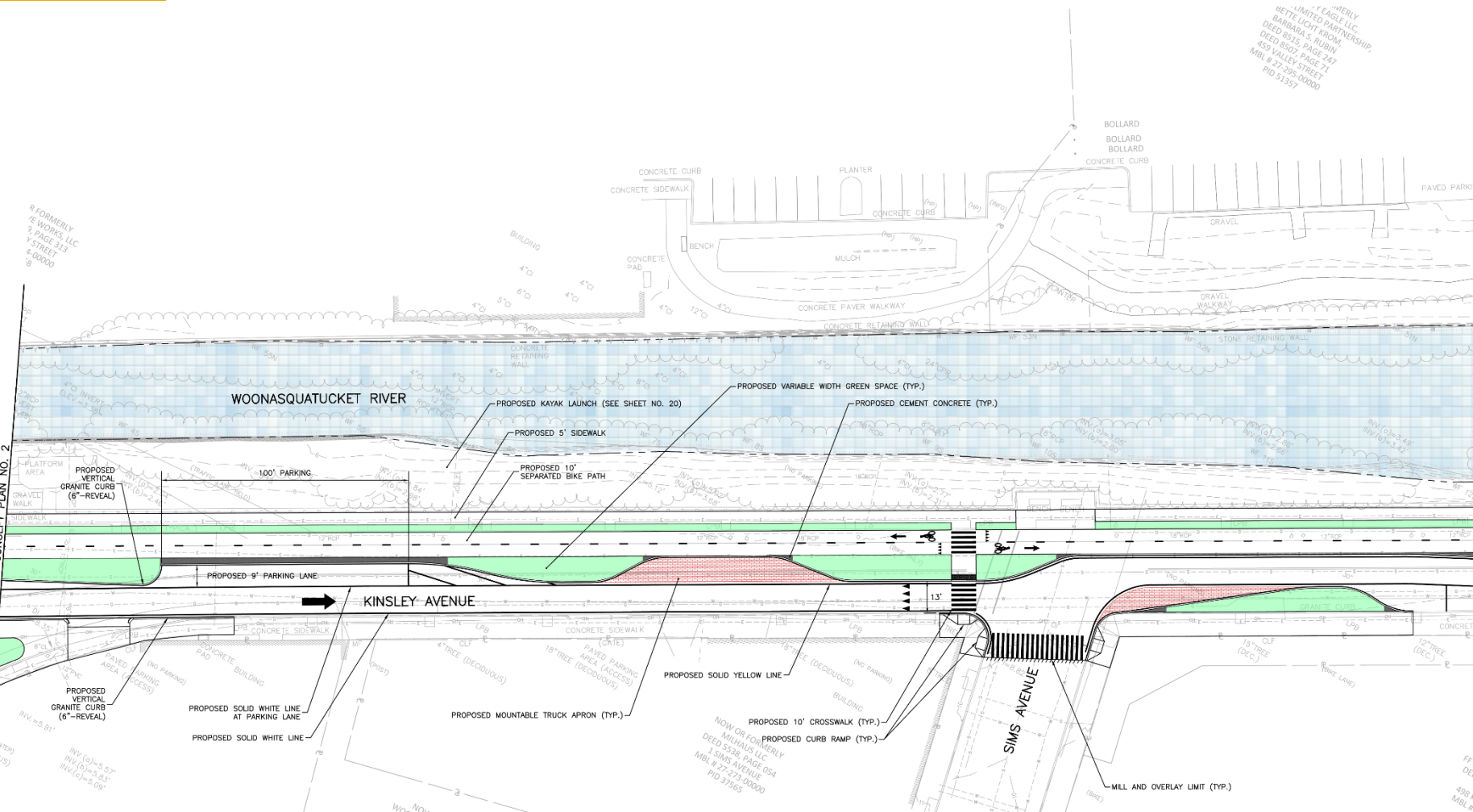

Crosswalks



Chicane



# Preferred Concept – Engineering Plans

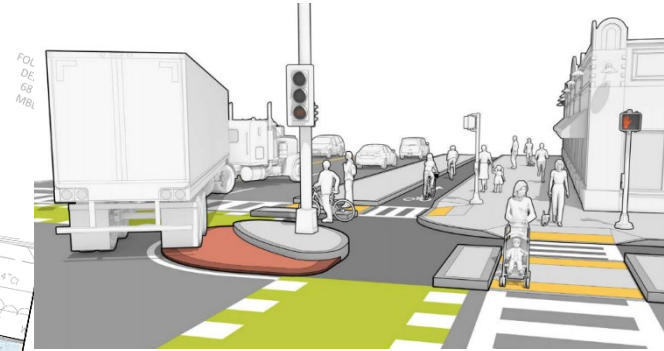
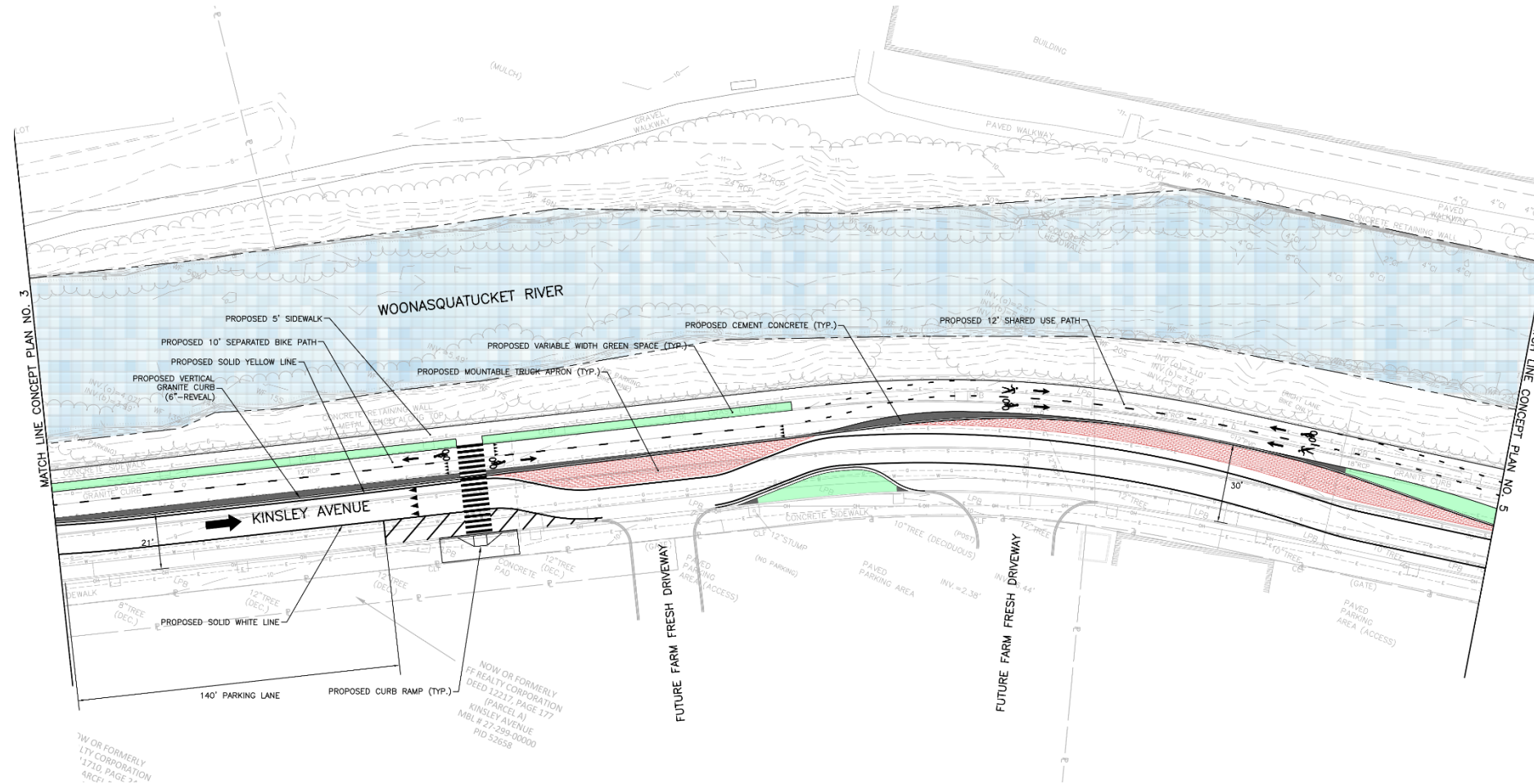

Truck Apron



Shared-use Path



# Preferred Concept – Engineering Plans

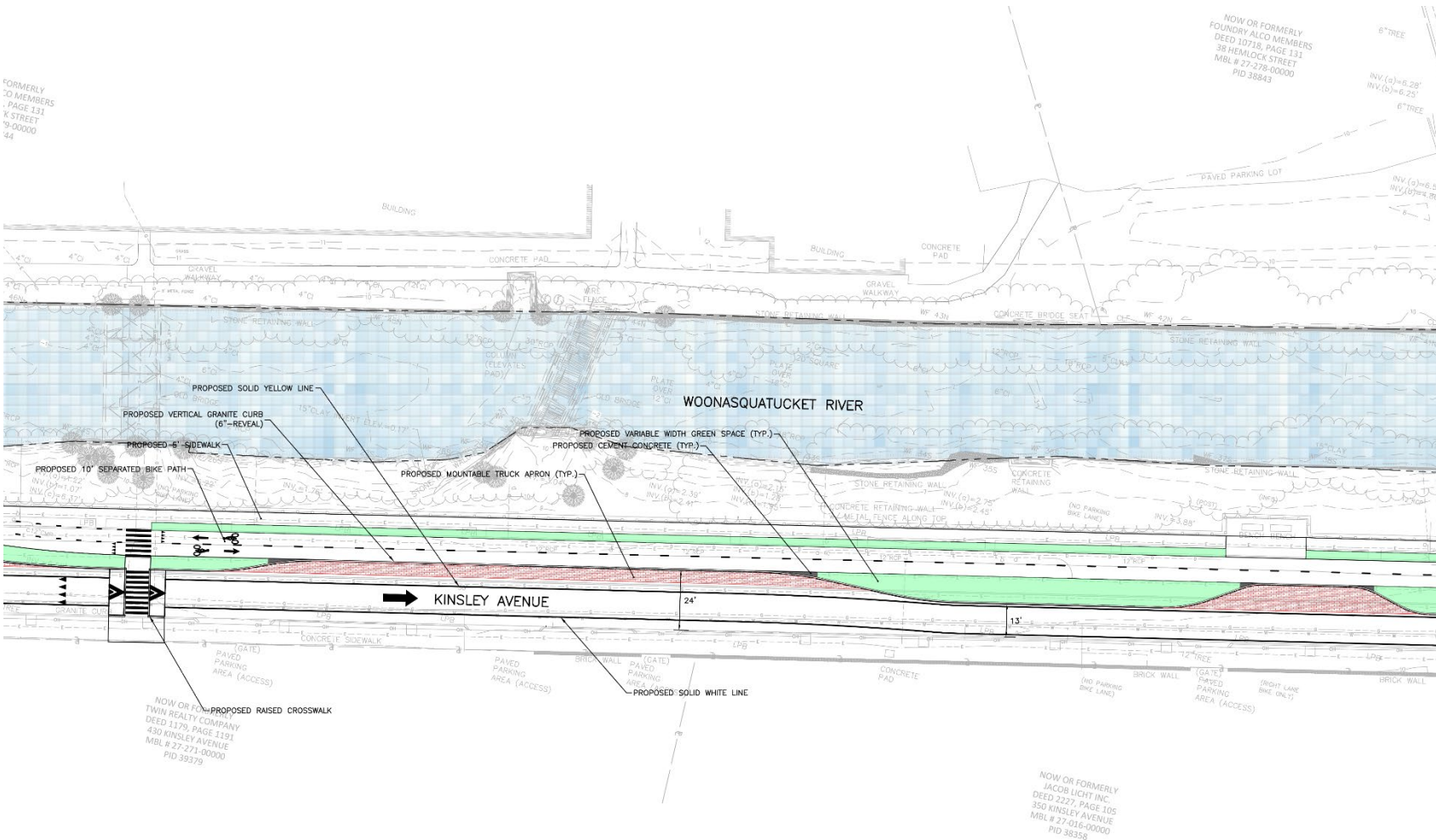

**Raised Crosswalk**



**New Sidewalk**

**WOONASQUACKET  
RIVER GREENWAY**



**WOONASQUACKET  
RIVER  
GREENWAY**



**WOONASQUACKET RIVER  
WATERSHED COUNCIL**



# Preferred Concept – Engineering Plans

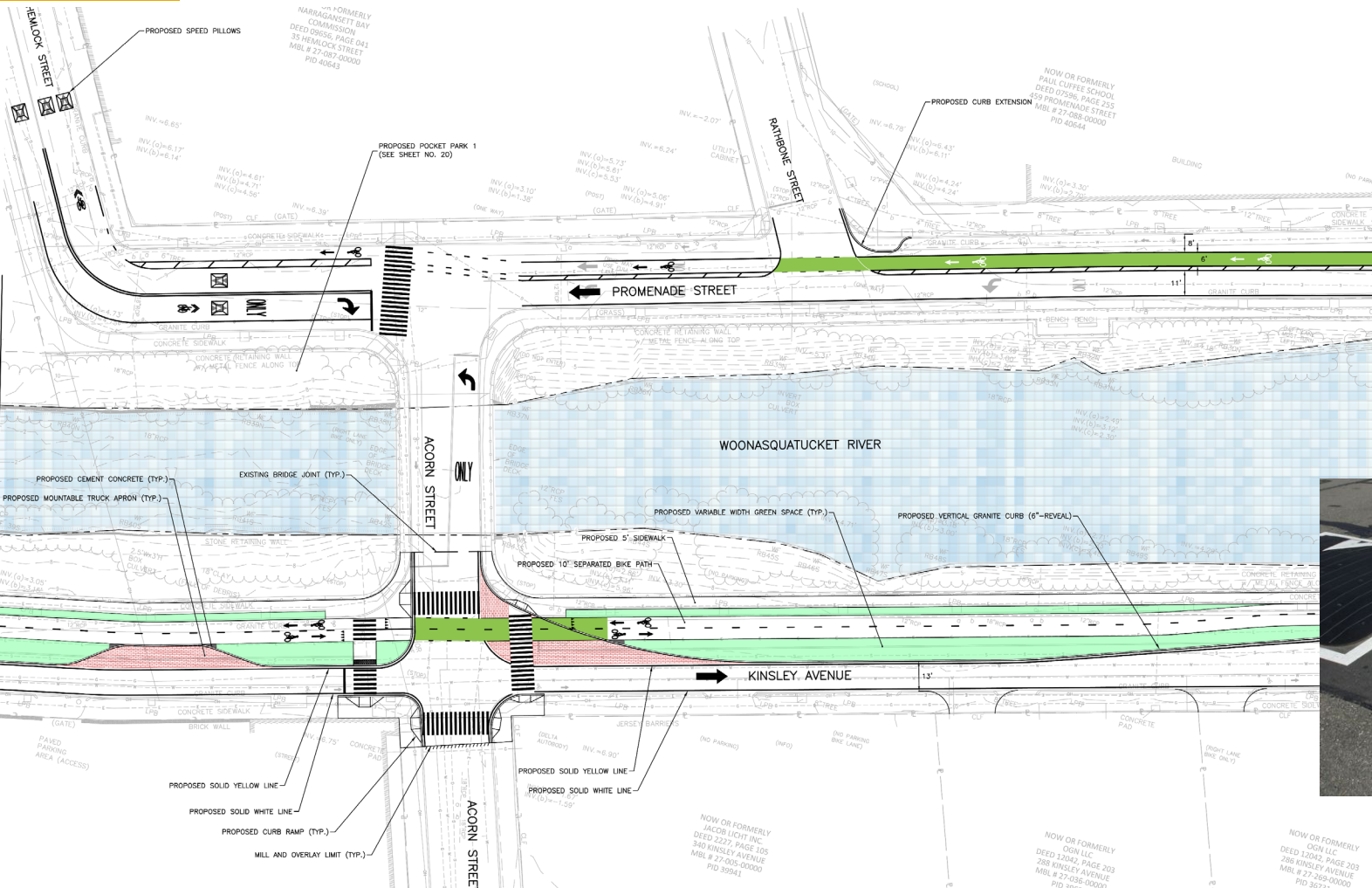

**Curb Extensions**



**Speed Pillows**



**Green Pavement Markings in the Bicycle Lane**

**WOONASQUATUCKET RIVER GREENWAY**



**WOONASQUATUCKET RIVER GREENWAY**



**WOONASQUATUCKET RIVER WATERSHED COUNCIL**



# Preferred Concept – Engineering Plans

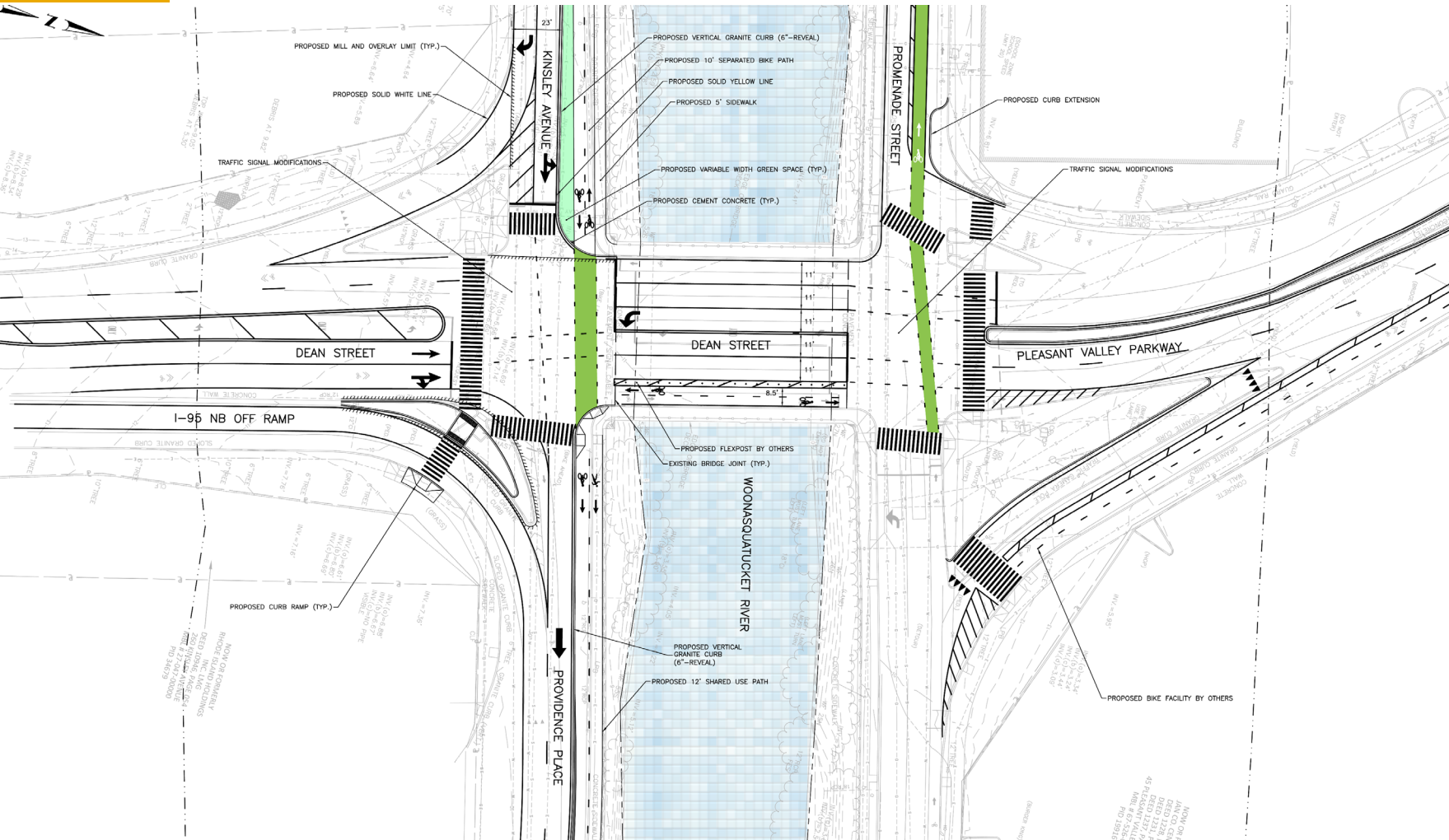

**Green Pavement Markings in the Bicycle Crossing**



# Preferred Concept – Engineering Plans

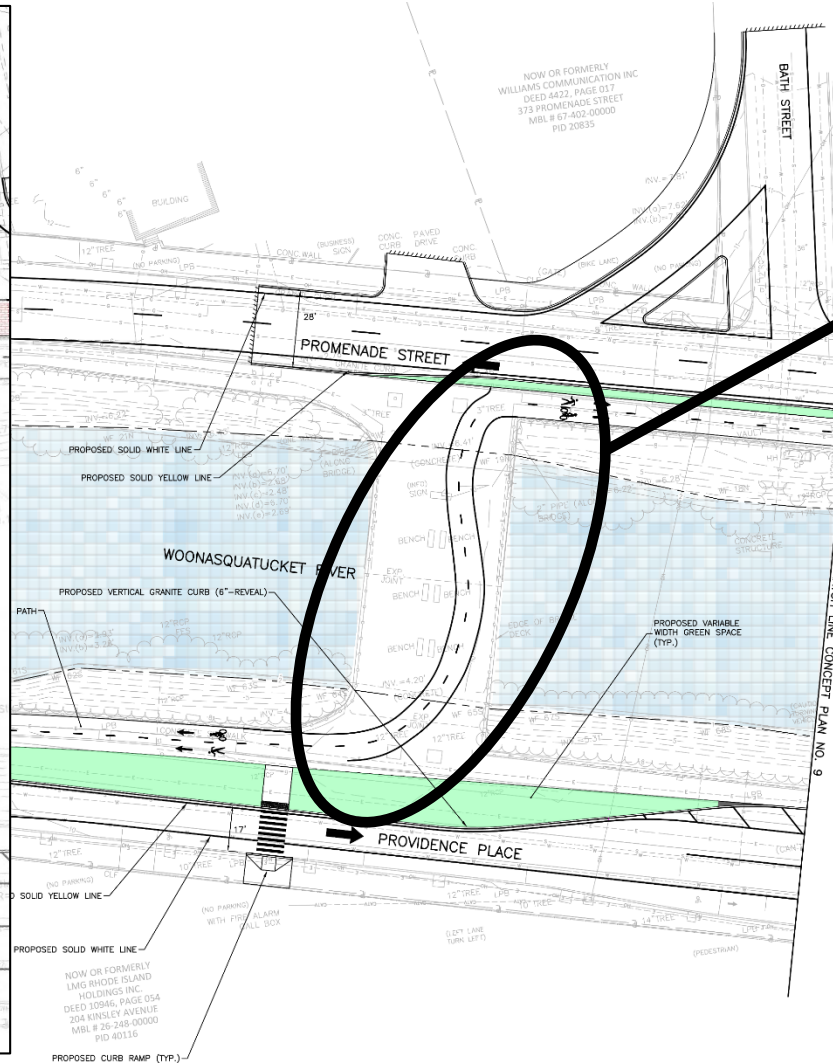
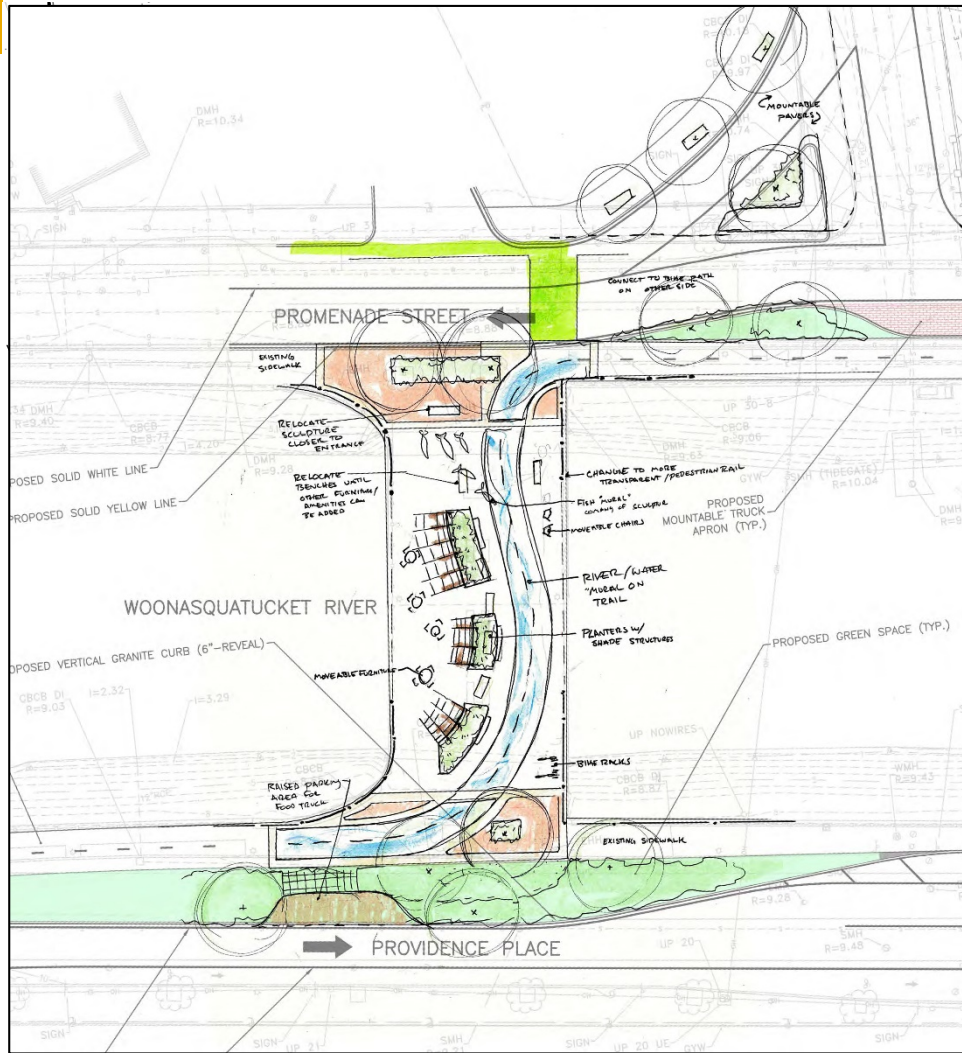

**Crossing  
of Path  
over  
Sculpture  
Bridge**



# Preferred Concept - Engineering Plans

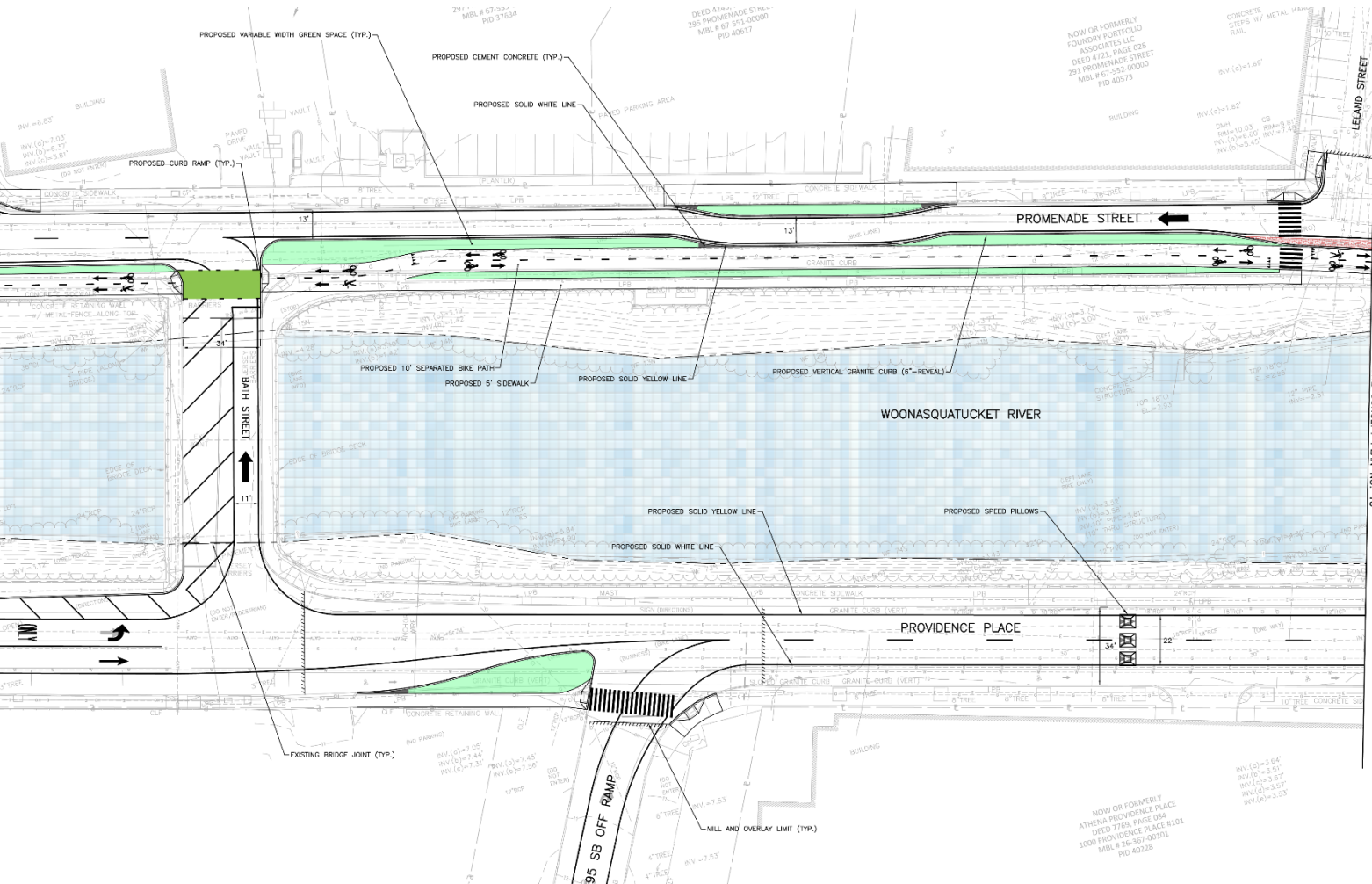

Green Buffer Space



# Preferred Concept – Engineering Plans

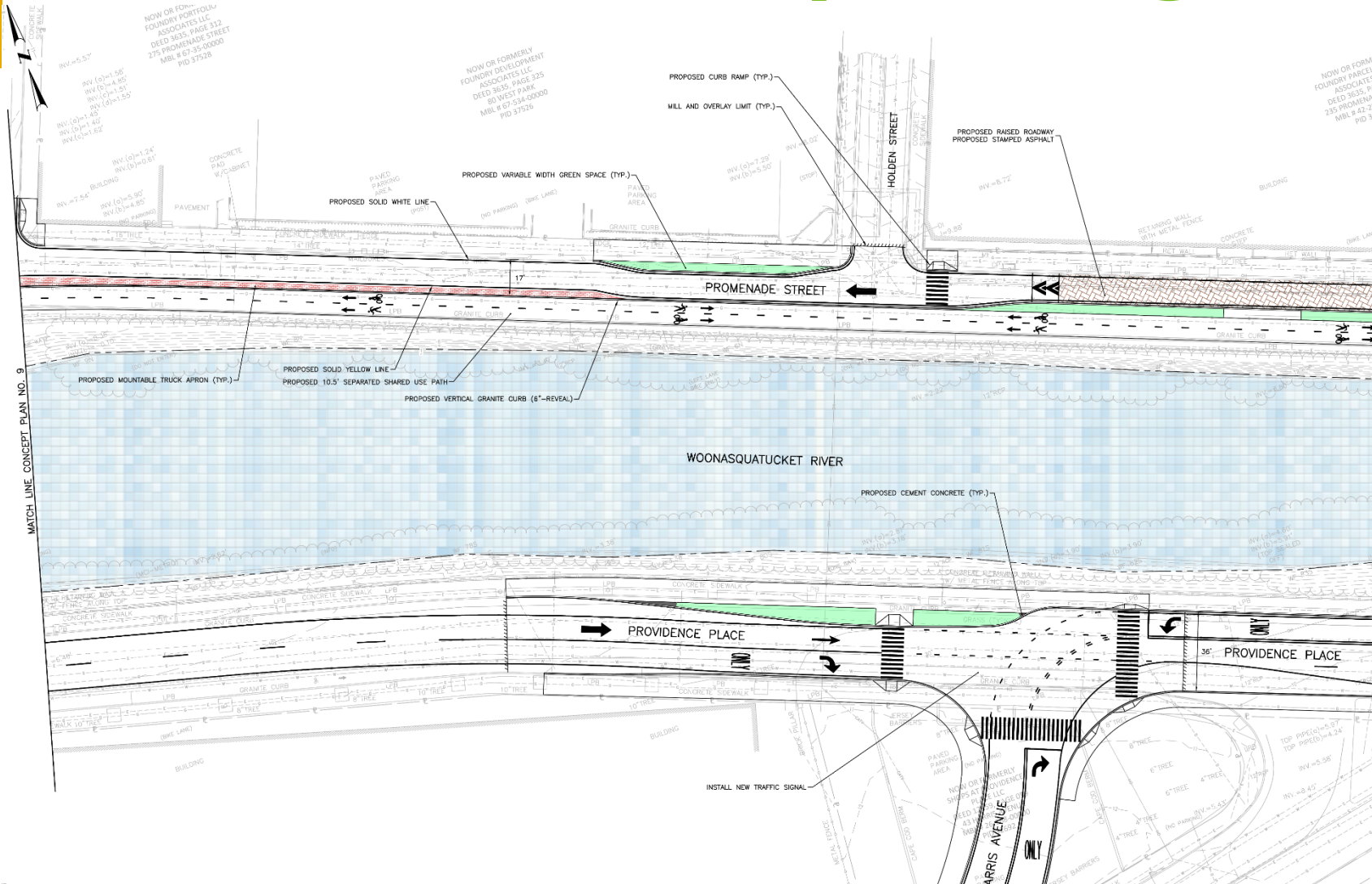

**Raised Roadway**



# Preferred Concept – Engineering Plans

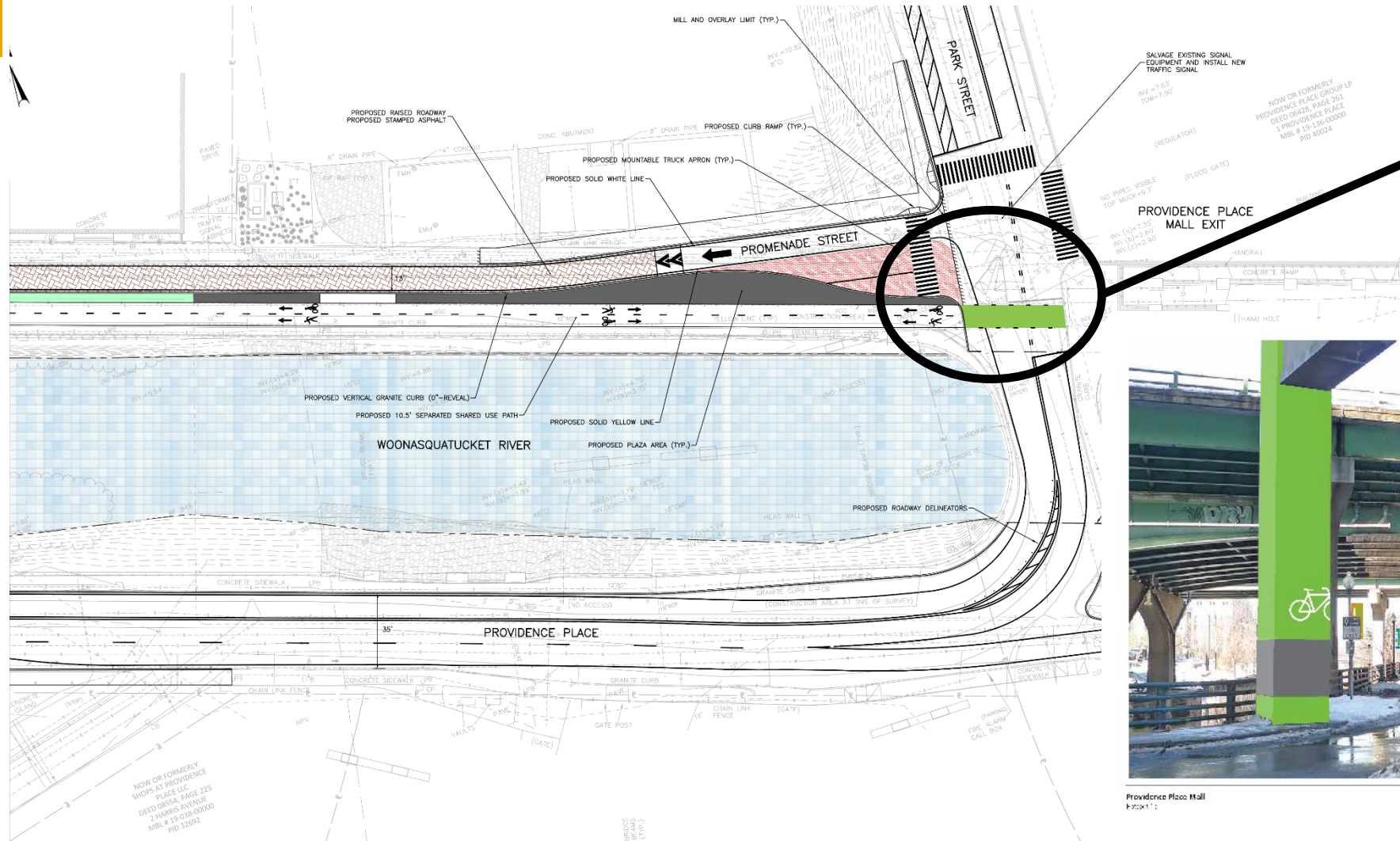

Start of  
proposed  
facility



Providence Place Mall  
Exit 112



Woonasquatucket River Greenway  
Scale 1:1000

Job Dates & Activities  
Summer 2018













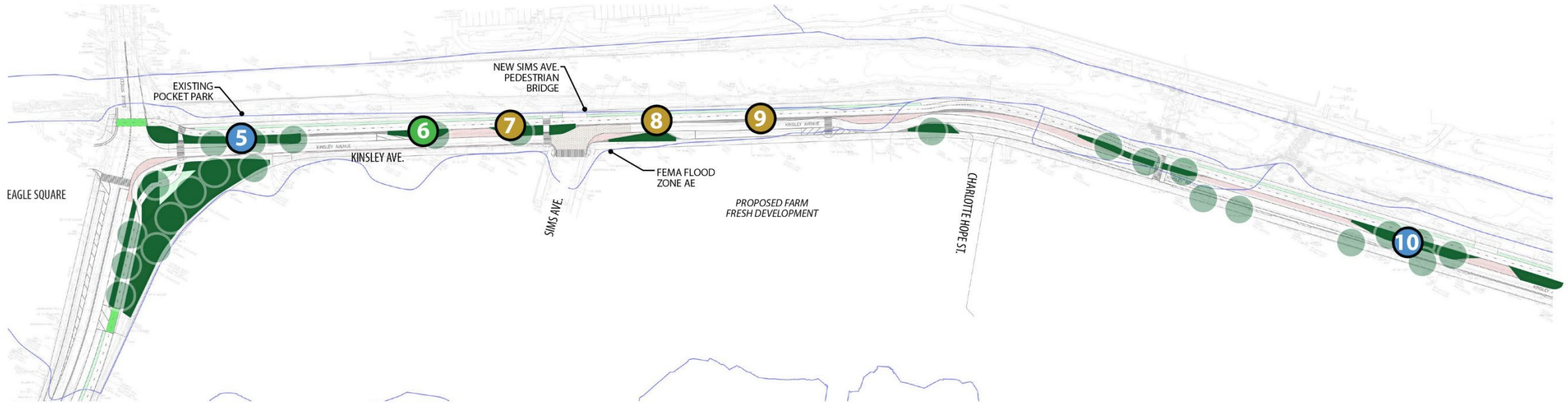



# Preferred Concept – Green Infrastructure



## GREEN INFRASTRUCTURE KEY:

	PAVEMENT TRANSFORMED INTO GREEN SPACE		UNDERGROUND FILTER
	TREE TRENCH		OTHER
	BIORETENTION		PROPOSED CANOPY TREE

## NOTES:

1. Existing conditions survey is still in progress and utility data requires verification.
2. Green infrastructure opportunities are shown at a conceptual planning level. Further infrastructure investigation, soil analysis and budget prioritization is required to determine feasibility and selection of specific practices.



# Preferred Concept – Green Infrastructure

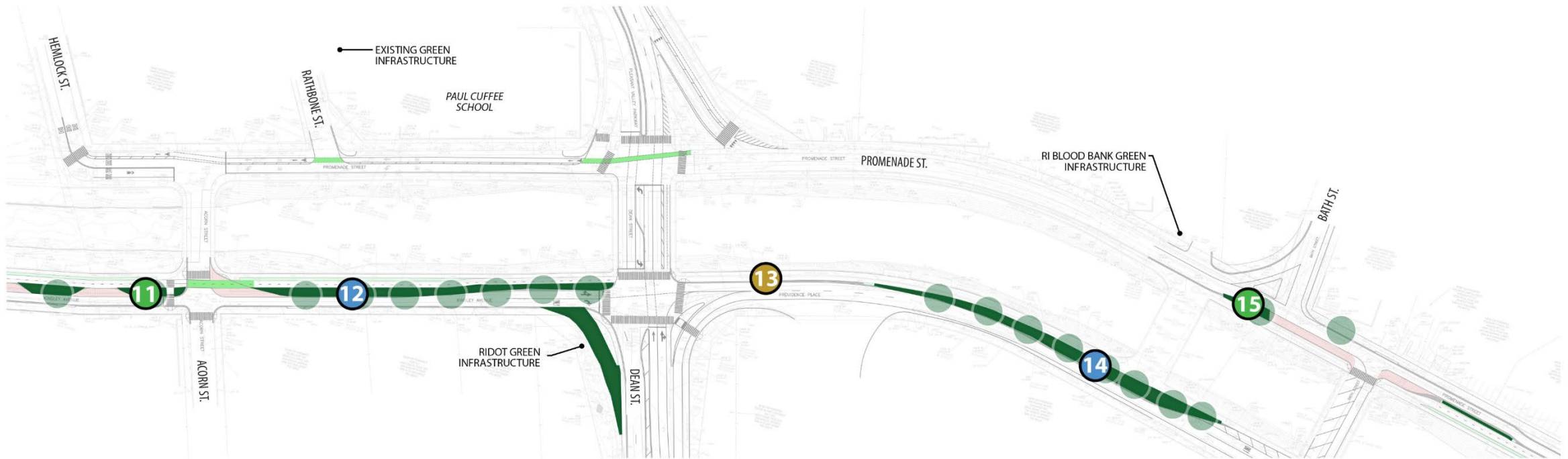

## GREEN INFRASTRUCTURE KEY:

	PAVEMENT TRANSFORMED INTO GREEN SPACE		UNDERGROUND FILTER
	TREE TRENCH		OTHER
	BIORETENTION		PROPOSED CANOPY TREE

## NOTES:





- Existing conditions survey is still in progress and utility data requires verification.
- Green infrastructure opportunities are shown at a conceptual planning level. Further infrastructure investigation, soil analysis and budget prioritization is required to determine feasibility and selection of specific practices.

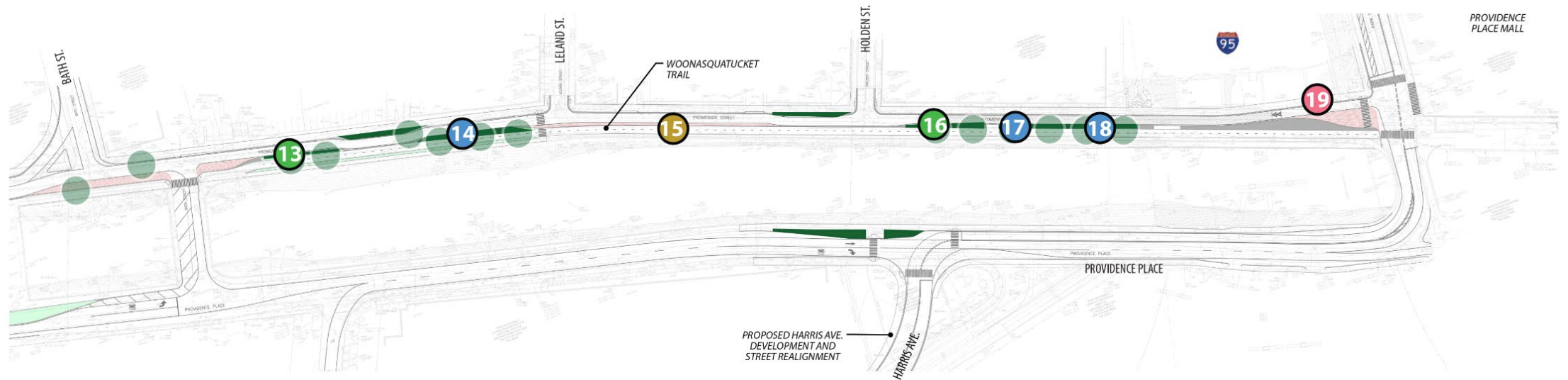

# Preferred Concept – Green Infrastructure



## GREEN INFRASTRUCTURE KEY:

	PAVEMENT TRANSFORMED INTO GREEN SPACE		UNDERGROUND FILTER
	TREE TRENCH		OTHER
	BIORETENTION		PROPOSED CANOPY TREE

## NOTES:

1. Existing conditions survey is still in progress and utility data requires verification.
2. Green infrastructure opportunities are shown at a conceptual planning level. Further infrastructure investigation, soil analysis and budget prioritization is required to determine feasibility and selection of specific practices.



# Preferred Concept – Green Infrastructure

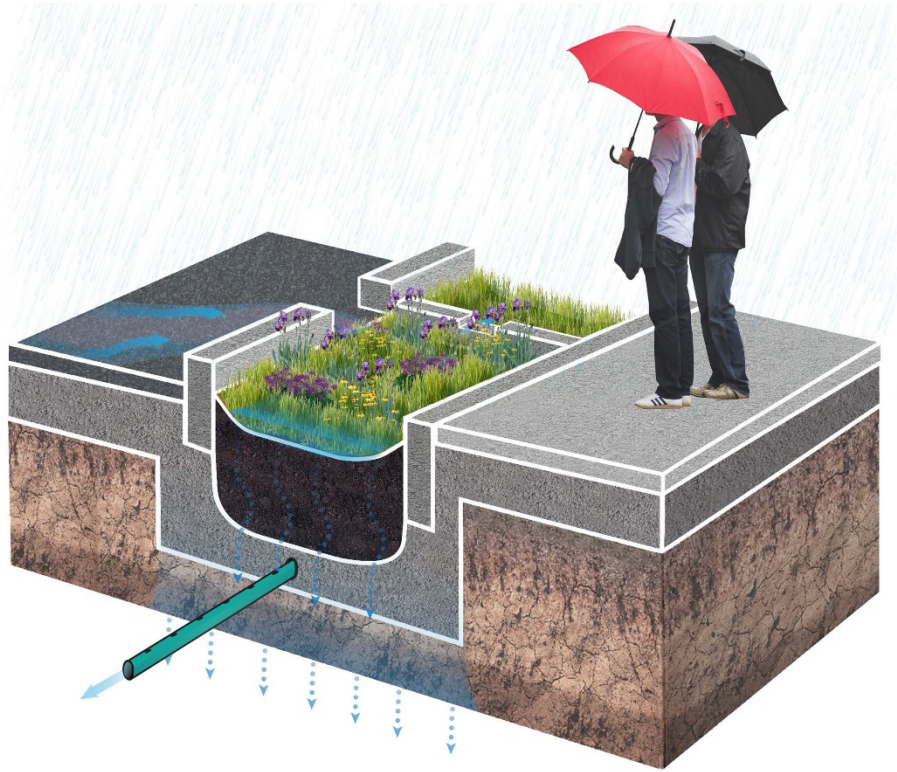

**Bioretention**



In Action: <https://www.facebook.com/WRWCRI/videos/1095476834142109/>



# Preferred Concept – Green Infrastructure

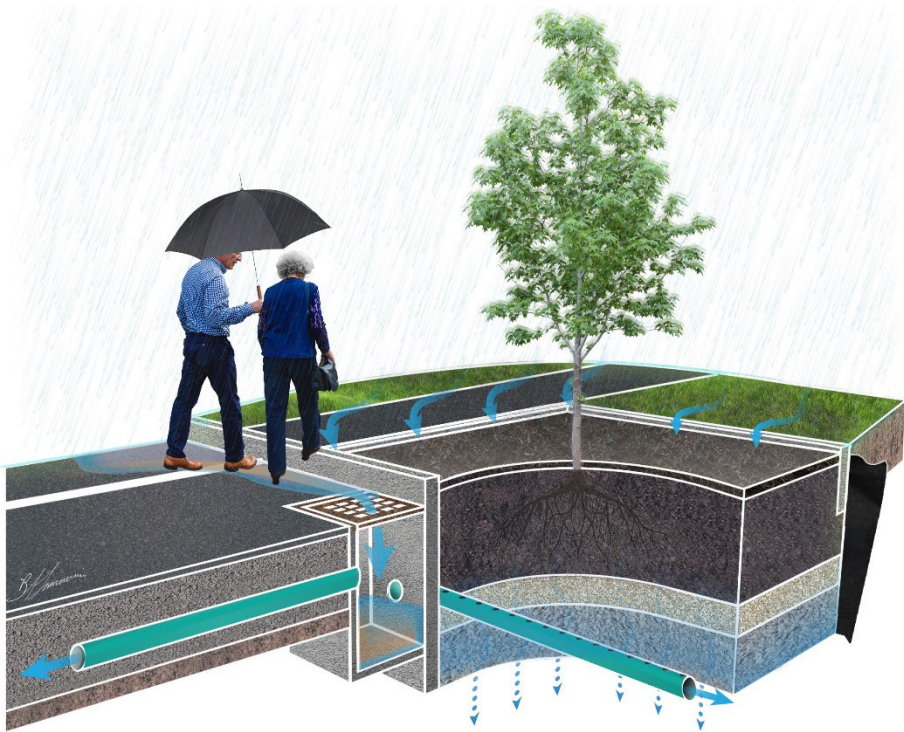

Tree Trench





# Preferred Concept – Placemaking

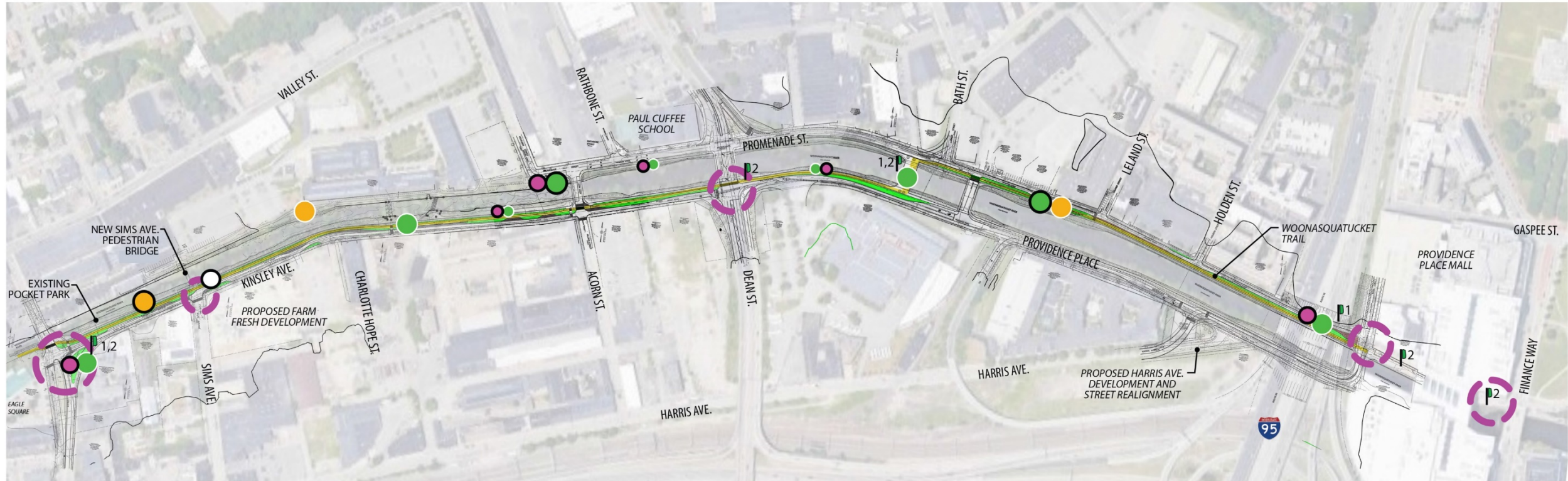

- POCKET PARKS    ● FUTURE POCKET PARKS    ● KAYAK LAUNCH    ● FUTURE KAYAK LAUNCH
- ORIENTATION / INFORMATIONAL SIGN    ● ART LOCATIONS    ○ MARBLE TRAIL START    ○ NODES / GATEWAYS

NOTE: Map shows preliminary Phase 1 Placemaking locations. Subject to change per design development and regulatory coordination.

1. Wayfinding Kiosk
2. Directional Signage

PHASE 1 PLACEMAKING MAP



# Preferred Concept – Placemaking

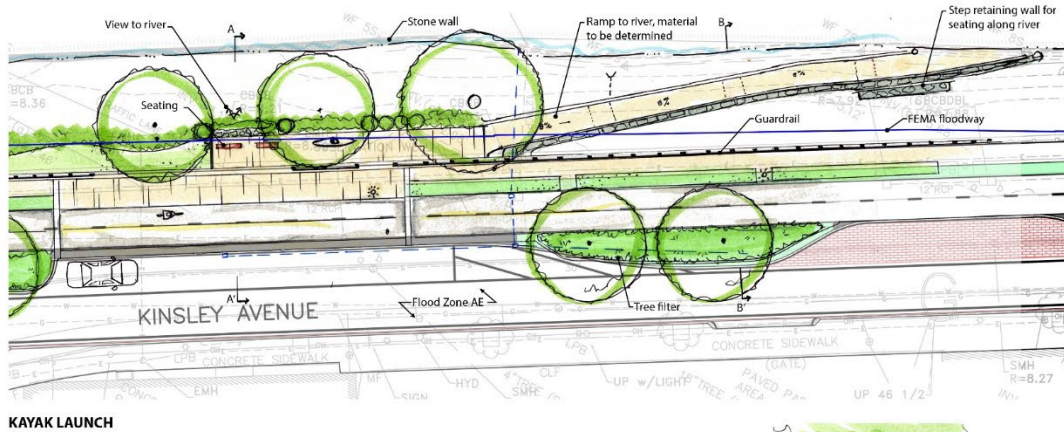
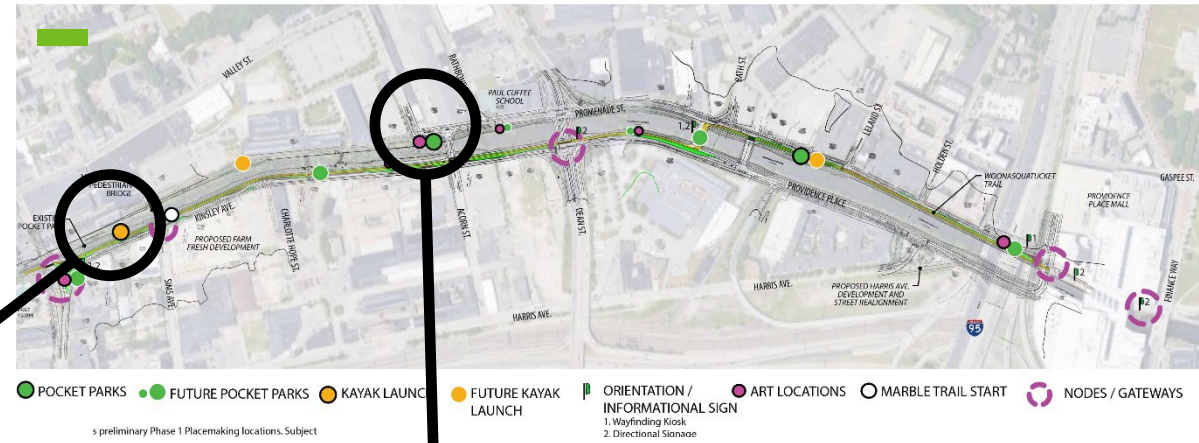

KAYAK LAUNCH

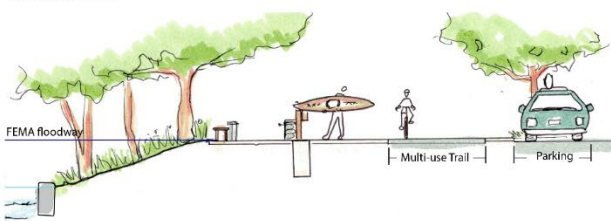

SECTION A-A'

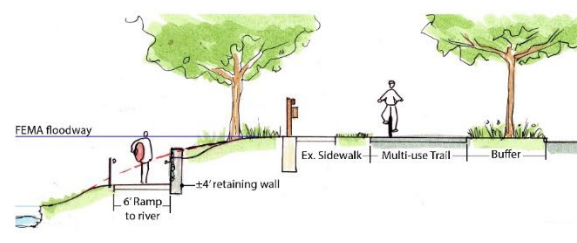

SECTION B-B'

**Kayak Launch  
Kinsley Avenue**

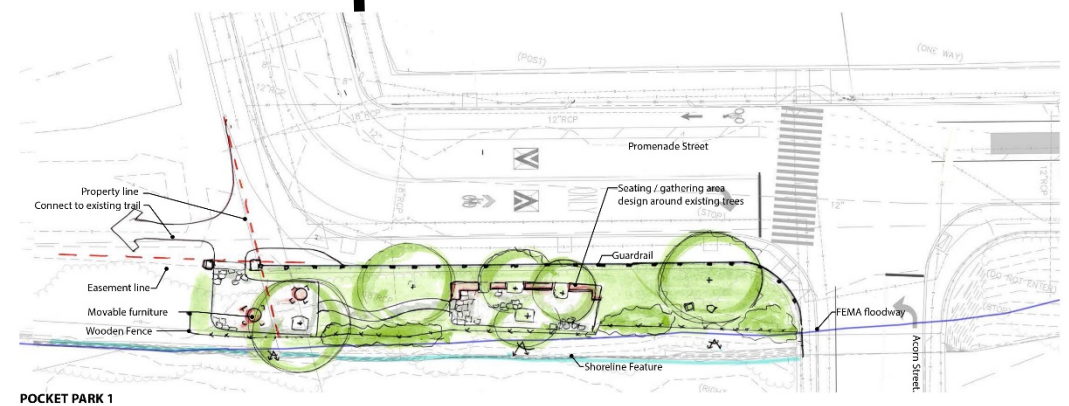

POCKET PARK 1

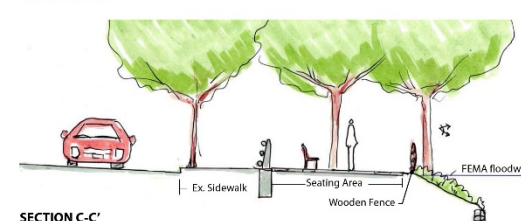

SECTION C-C'

**Pocket Park  
Hemlock Street & Promenade Street**



# Preferred Concept – Public Art

**Under the I-95 overpass  
at Promenade and Park**



**Landscaping with  
natural and found  
elements along the**



**Greenway Arts Opportunity**



**The decommissioned  
support platform in  
the river under the  
I-95 overpass**



**The Eagle Square Green**



**Under the Mall**



**Pocket Park at Promenade  
and Hemlock**





# Public Questions & Comment



# Next Steps

- **Public feedback on preferred concept**
- **Final design**



# Closing

## THANK YOU!

Alicia Lehrer, Executive Director, WRWC  
Jessica Pflaumer, AICP, City of Providence

## QUESTIONS?

[jpflaumer@providenceri.gov](mailto:jpflaumer@providenceri.gov)  
(401) 680-8400 | Ext: 8519

<http://www.providenceri.gov/planning/woonasquatucket/>

WOONASQUATUCKET  
RIVER GREENWAY



WOONASQUATUCKET  
RIVER  
GREENWAY



WOONASQUATUCKET RIVER  
WATERSHED COUNCIL