

Athletic Facility Upgrades at Moses Brown



MOSES BROWN
QUAKERS



Why Video Scoreboard?

- Current scoreboard 20+ years old.
- Videoboards are becoming new standard for scoreboards.

Videoboard Timeline/Highlights

- Plan to Install Video Scoreboard in late October 2022.
- Proposed Scoreboard location faces away from Weymouth Ave.
- No sound comes from scoreboard; sound controlled from new central sound system in press box set to meet City noise ordinance for residential areas (65 DBA)
- MB Board already requiring limited uses – no corporate advertising.
- Developing tree planting plan for spring '23 to screen view.



This summer and fall Moses Brown will complete a total renovation and expansion of outdoor play spaces and make dramatic enhancements to the spectator experience of Campanella Field.



The play and outdoor education spaces directly behind the Lower School (facing Weymouth Ave.) - for Nursery through 1st graders - will be expanded and completely re-imagined, with a variety of structures to support cooperative play, individual exploration, and a sense of joy.



The upper play and outdoor education spaces for 2nd – 4th grades will also be entirely remade with a design that seamlessly integrates hillside spectator seating, an expanded Alumni Terrace, and a new press box.

MOSES BROWN SCHOOL LOWER SCHOOL & KING "DOC" ODELL TRACK RENOVATION

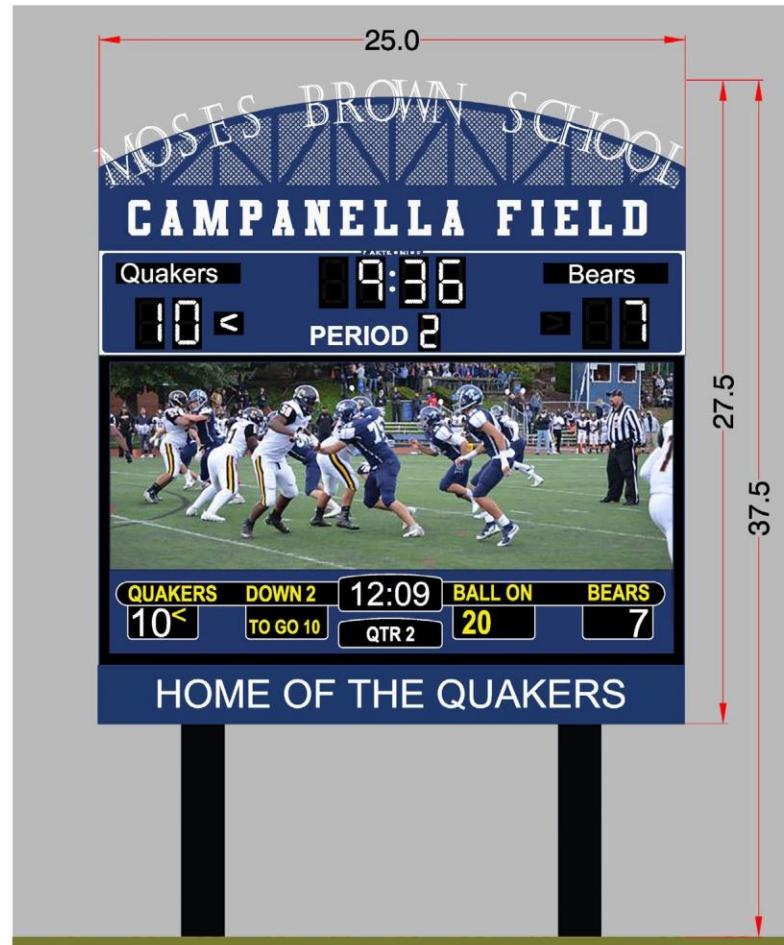

MOSES BROWN SCHOOL LOWER SCHOOL & KING "DOC" ODELL TRACK RENOVATION Providence Sound Ordinance Levels

(c) With the exception of sound levels or standards specifically authorized or prohibited in this article, the following are the maximum permissible sound levels allowed at or within the real property boundary of a receiving land use or two hundred (200) feet from its source:

Sounds Levels by Receiving Land Use*

Zoning District	Time	Sound Limit (dBA)
Residential	7:00 a.m. to 9:59 p.m.	65 dBA
	10:00 p.m. to 6:59 a.m.	55 dBA
Downtown	2:00 a.m. to 7:00 a.m.	55 dBA
	All other times	75 dBA
Commercial / Industrial	2:00 a.m. to 7:00 a.m.	55 dBA
	All other times	75 dBA
Open Spaces	2:00 a.m. to 7:00 a.m.	55 dBA
	All other times	75 dBA
Waterfront	2:00 a.m. to 7:00 a.m.	55 dBA

* "Receiving land use" means the property where the noise can be heard

MOSES BROWN SCHOOL

LOWER SCHOOL & KING "DOC" ODELL TRACK RENOVATION

Public Address Speaker Placement Section

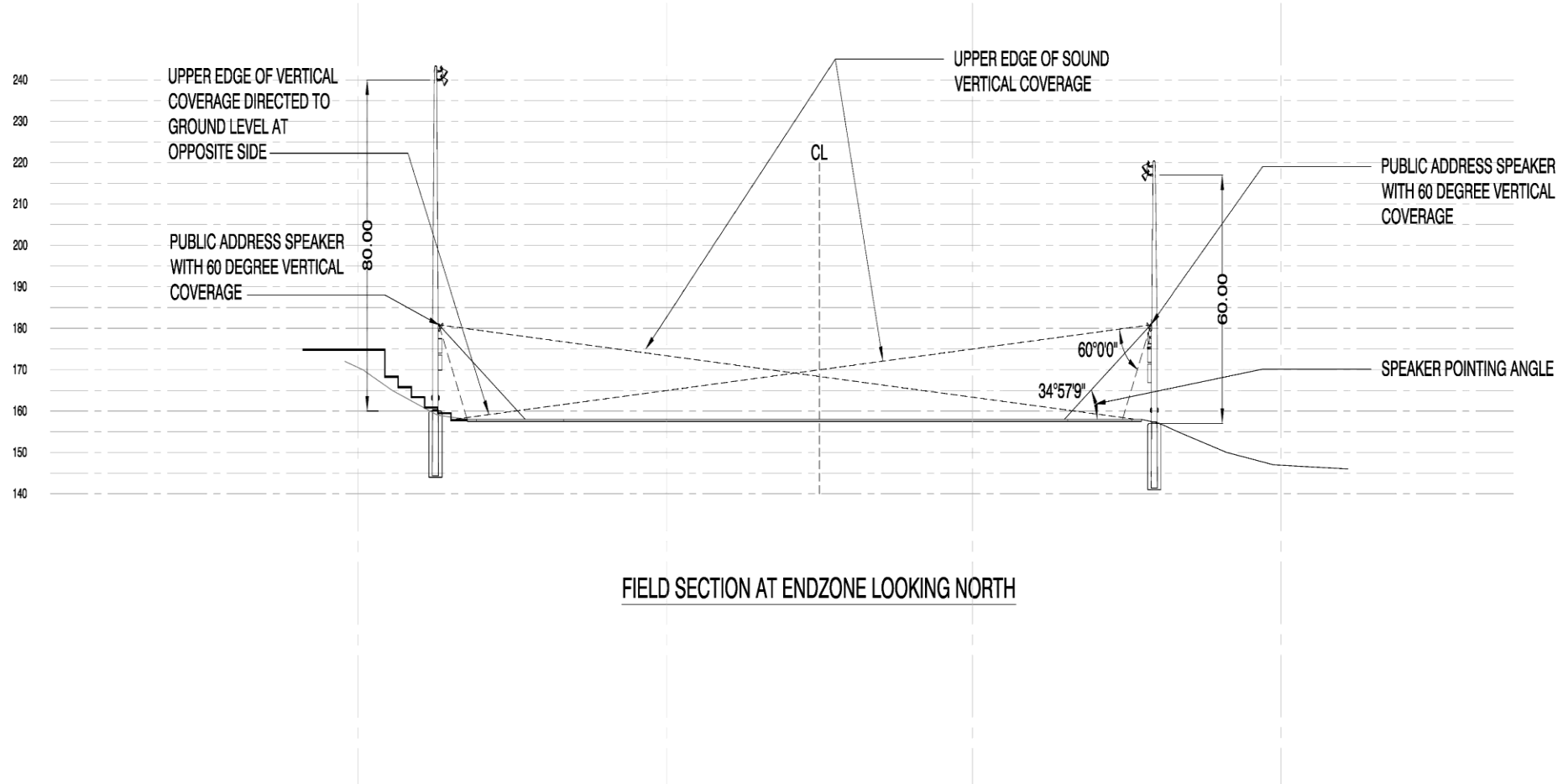

Videoboard Use Parameters

Videoboard Intensions:

- Campus collaborations with visual arts, digital arts and performing arts
- Off campus collaborations with Providence Career Technical Academy
- Celebrate students
- Campus announcements and community engagement opportunities such as:
 - Upcoming events (open house, performing arts events, speakers, forums, PA/PDC meetings, etc.)
 - Performing and visual arts activities, movie nights, etc.



Commitment To Neighbors Needs

- Additional security for marquee events
- Wind screen considerations for additional light and noise barrier
- Strategic planting of trees and shrubs around the Weymouth side of campus
- Do a soil study on Weymouth hill
- Arborvitaes behind storage bin in spring/block neighbor to bin
- Garbage pick-up after major events
- Fall leaf pick up (resume pre-covid practice)
- Continue neighborhood plowing
- Strategic placement of speakers and videoboard



MOSES BROWN SCHOOL TERESA A CAMPANELLA MEMORIAL FIELD SCOREBOARD AND SPORT LIGHTING IMPROVEMENTS

Providence, Rhode Island

ISSUED FOR DEVELOPMENT PLAN REVIEW
SEPTEMBER 20, 2022

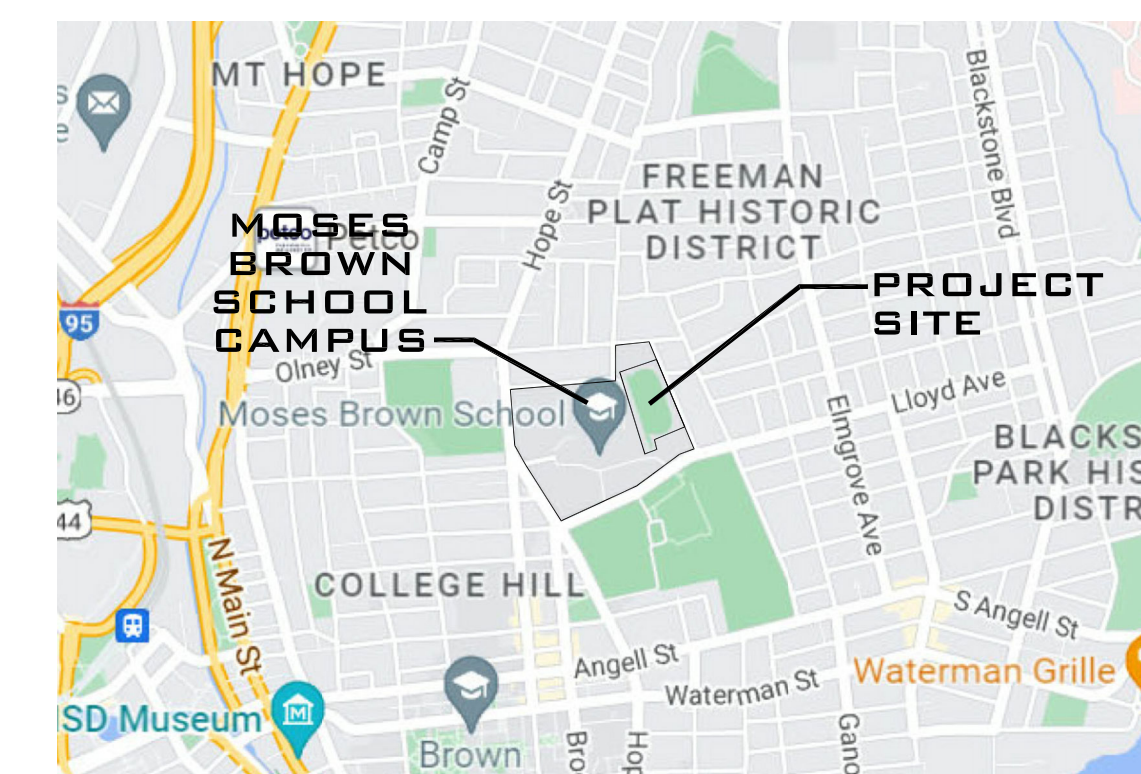

LOCUS PLAN
SCALE: 1" = 2,000'

SPORTS CONSULTANT AND CIVIL ENGINEER:

JJA Sports, LLC
Westford, Massachusetts

LAND SURVEYOR:

CAPUTO & WICK
RUMFORD, RHODE ISLAND

DRAWING INDEX

CO-0	COVER SHEET
C1-1	LAYOUT AND MATERIALS PLAN
C2-1	SCOREBOARD DETAILS AND SECTIONS

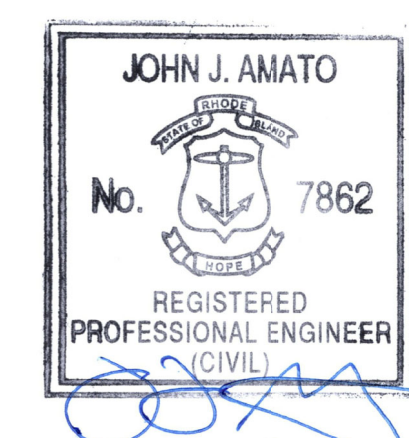

JJA SPORTS, LLC

CO-0

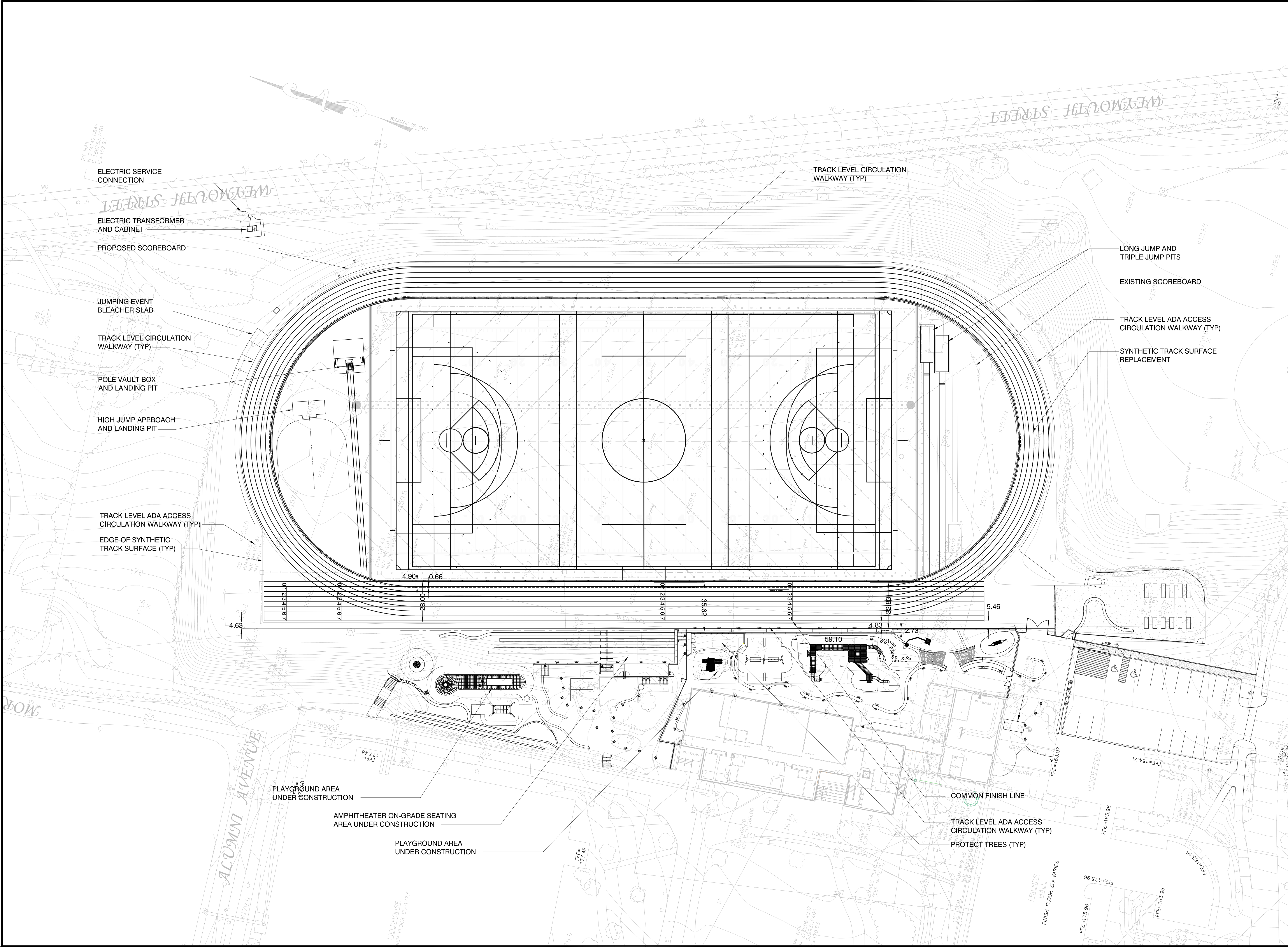

JJA SPORTS, LLC
88 CHAMBERLAIN ROAD
WESTFORD, MASSACHUSETTS 01886
(978) 692-0247 JJA SPORTS.COM

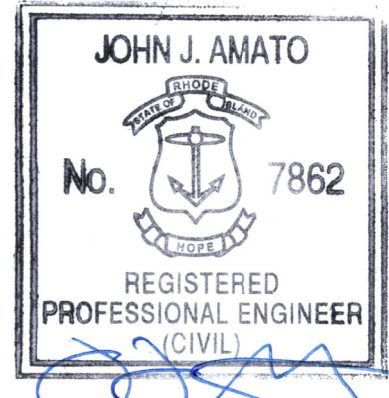

CONSULTANTS

MOSES BROWN SCHOOL
TERESA A CAMPANELLA MEMORIAL FIELD
SCOREBOARD AND SPORT LIGHTING
IMPROVEMENTS
PROVIDENCE, RHODE ISLAND

	09.20.22	ISSUED FOR PERMIT
MARK	DATE	DESCRIPTION
ISSUE DATE:		09.20.22
PROJECT NO:		0197
CAD DWG FILE:		xx
DRAWN BY:		JJA
CHECKED BY:		JJA
<hr/>		
Scale:		1"=30'
<hr/>		
Sheet Title:		

LAYOUT AND
MATERIALS
PLAN

C1-1

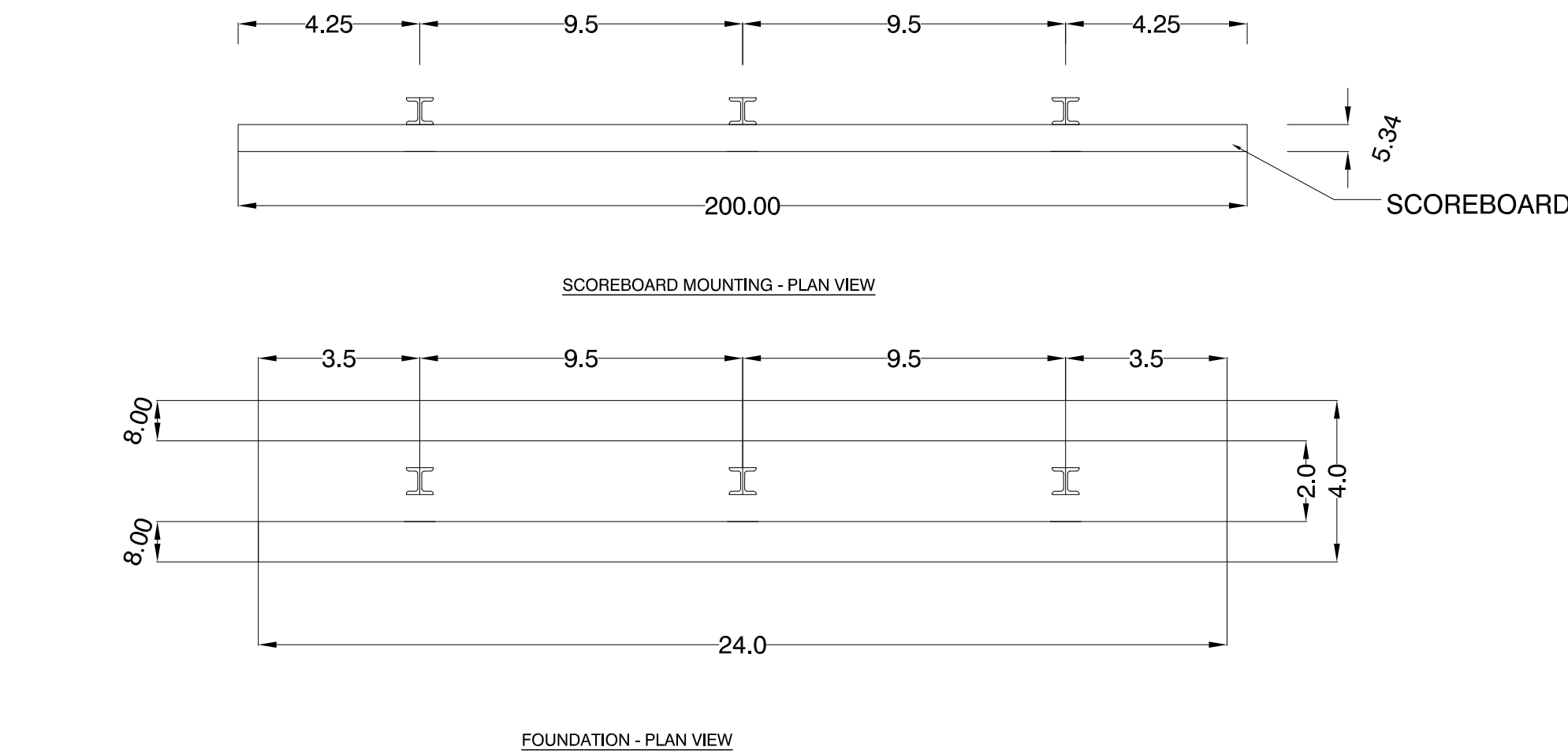

- NOTES:
1. SCOREBOARD SHALL BE CAPABLE OF SCORING FOR FOOTBALL, SOCCER, LACROSSE, AND FIELD HOCKEY.
 2. COLUMNS DEPICTED ARE PROVIDED FOR GENERAL REFERENCE. THE CONTRACTOR SHALL PROVIDE A CODE COMPLIANT FINAL DESIGN FOR THE APPROVED SCOREBOARD AND SUPPORT SYSTEM, DESIGNED BY A LICENSED STRUCTURAL ENGINEER AS PART OF THE SUBMITTAL PROCESS. THE DESIGN SHALL BE SUITABLE FOR SUBMITTAL TO THE BUILDING DEPARTMENT FOR OBTAINING A BUILDING PERMIT.
 3. FOOTINGS AND REINFORCEMENT DEPICTED ARE PROVIDED FOR GENERAL REFERENCE. THE CONTRACTOR SHALL PROVIDE A CODE COMPLIANT FINAL DESIGN FOR THE APPROVED SCOREBOARD AND SUPPORT SYSTEM, DESIGNED BY A LICENSED STRUCTURAL ENGINEER AS PART OF THE SUBMITTAL PROCESS. THE DESIGN SHALL BE SUITABLE FOR SUBMITTAL TO THE BUILDING DEPARTMENT FOR OBTAINING A BUILDING PERMIT.
 4. THE SCOREBOARD SHALL PROTECTION SCREENING FOR THE BOARD.
 5. THE SCOREBOARD COLOR SHALL MATCH THE SELECTED SCHOOL COLORS.
 7. THE SCOREBOARD PUBLIC ADDRESS SYSTEM SHALL OPERATE THROUGH THE THE SOUND SPEAKERS MOUNTED ON THE PRESS BOX AND SHALL MEET PROVIDENCE MUNICIPAL CODE CHAPTER 16 REQUIREMENTS

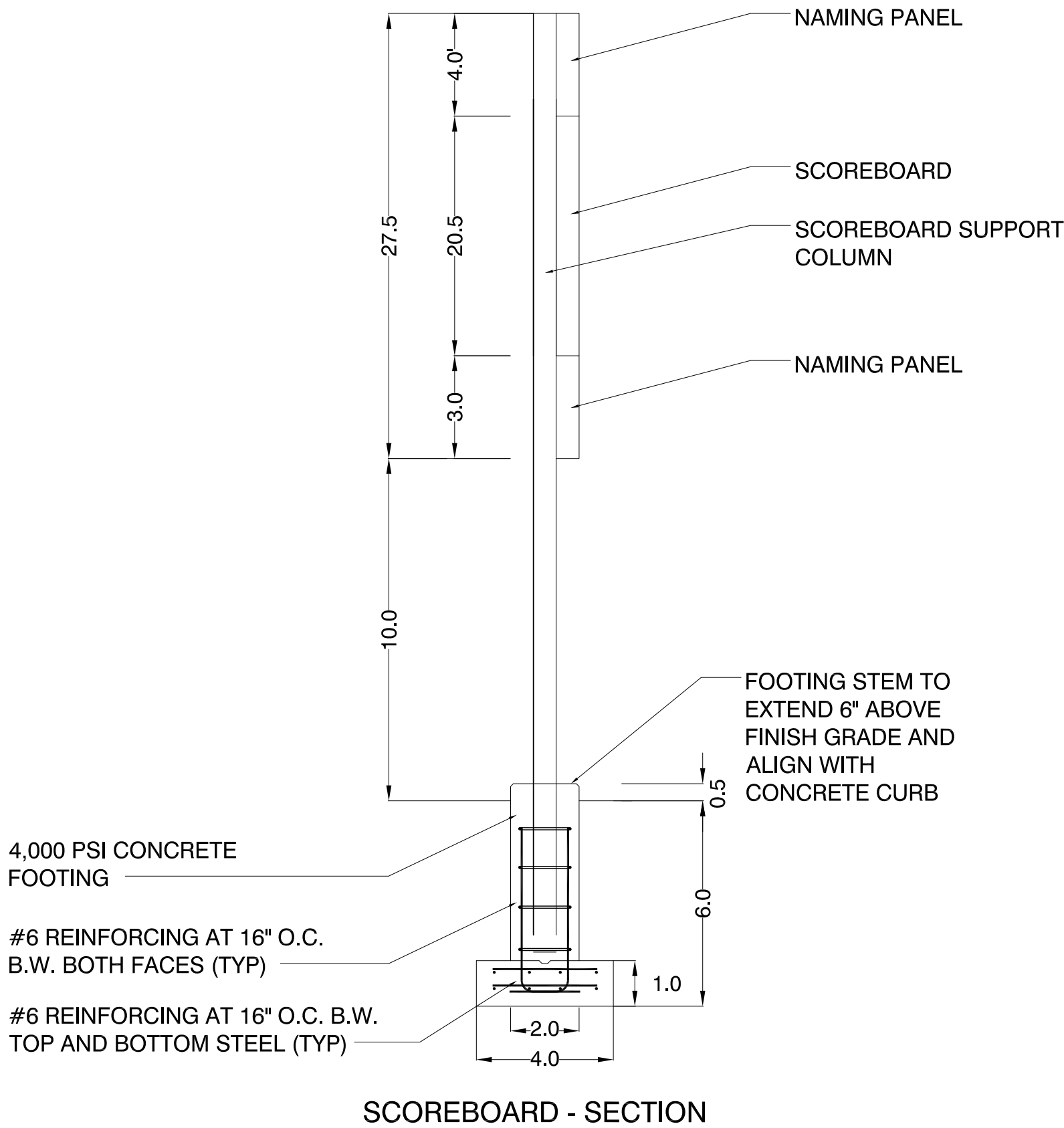
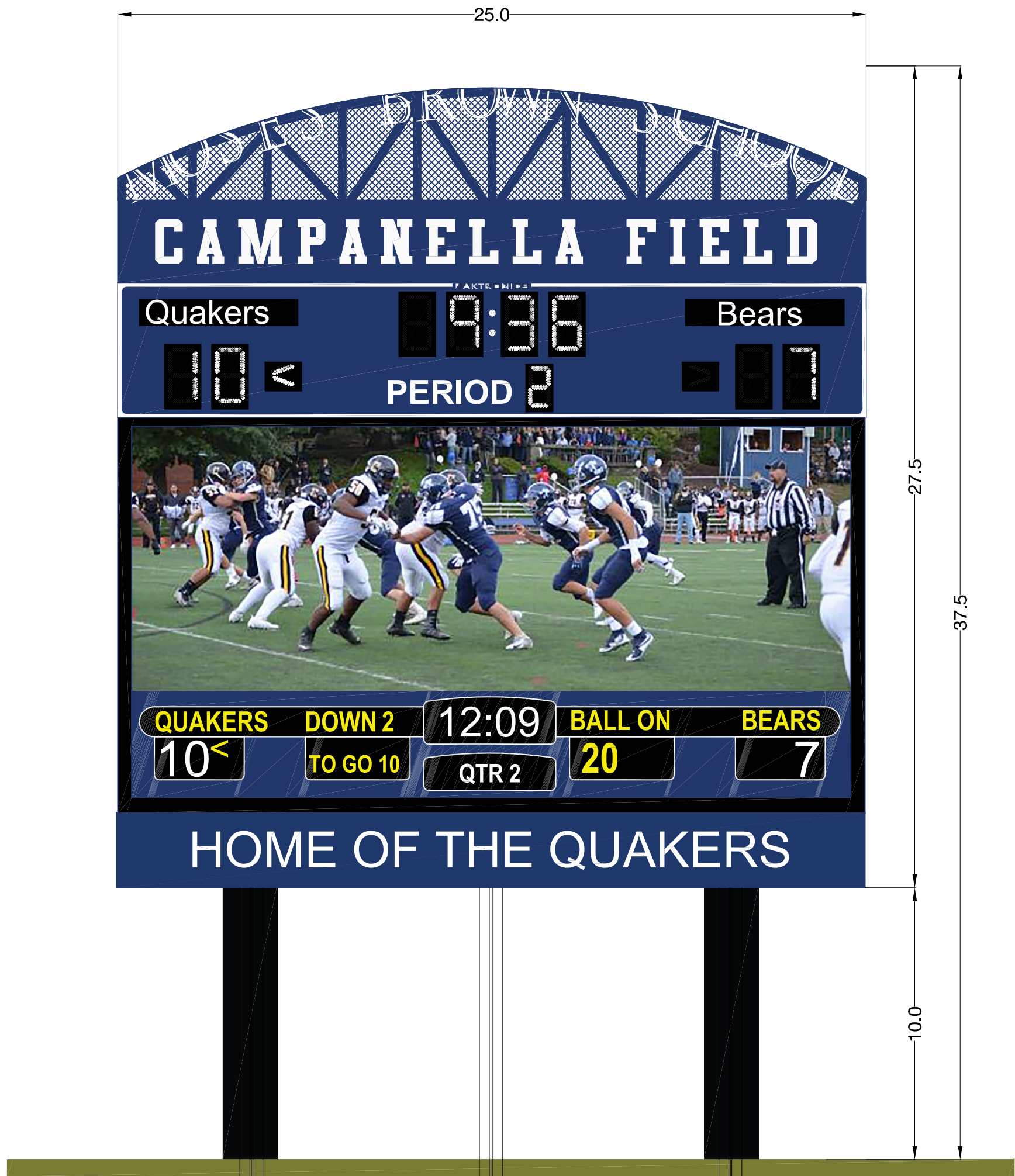

1 SCOREBOARD
N.T.S.



JJA SPORTS, LLC
88 CHAMBERLAIN ROAD
WESTFORD, MASSACHUSETTS 01886
(978) 692-0247 JJA SPORTS.COM

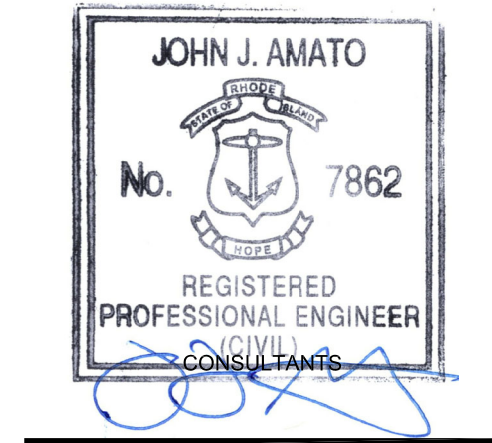

MOSES BROWN SCHOOL
TERESA A CAMPANELLA MEMORIAL FIELD
SCOREBOARD AND SPORT LIGHTING
IMPROVEMENTS
PROVIDENCE, RHODE ISLAND

MARK	DATE	DESCRIPTION
09.20.22	ISSUED FOR DPR	
ISSUE DATE: 08.30.22		
PROJECT NO: 0160		
CAD DWG FILE: xs		
DRAWN BY: JJA		
CHECKED BY: JJA		
Scale: AS NOTED		
Sheet Title:		

SCOREBOARD
DETAILS AND
SECTIONS