

PLANT SCHEDULE LOT 429 (CANOPY REQUIREMENT: (1) LARGE TREE, (1) MEDIUM TREE, (3) SMALL TREES)

QTY.	SYMB.	BOTANICAL NAME	COMMON NAME	SIZE	ROOT BALL	COMMENT	TREE CANOPY
3	AG-RP	Amelanchier canadensis 'Glenn Form'	Rainbow Pillar Serviceberry	8/10' CLUMP	B&B	Multi-leader Clump Form	SMALL TREE
1	BN-H	Betula nigra 'Heritage'	Heritage River Birch	14-16' CLUMP	B&B	(3) Leader Clump Form	LARGE TREE
1	CK	Cladrastis kentukea	Yellowwood	2.5-3" CAL.	B&B		MEDIUM TREE
2	PC-CS	Pyrus calleryana 'Cleveland Select'	Cleveland Select Ornamental Pear	3-3.5" CAL.	B&B		MEDIUM TREE

PLANT SCHEDULE LOT 430 (CANOPY REQUIREMENT: (1) MEDIUM TREE, (3) SMALL TREES)

QTY.	SYMB.	BOTANICAL NAME	COMMON NAME	SIZE	ROOT BALL	COMMENT	TREE CANOPY
3	AG-RP	Amelanchier canadensis 'Glenn Form'	Rainbow Pillar Serviceberry	8/10' CLUMP	B&B	Multi-leader Clump Form	SMALL TREE
2	PC-CS	Pyrus calleryana 'Cleveland Select'	Cleveland Select Ornamental Pear	3-3.5" CAL.	B&B		MEDIUM TREE

PLANT SCHEDULE LOT 431 (CANOPY REQUIREMENT: (1) MEDIUM TREE, (4) SMALL TREES)

QTY.	SYMB.	BOTANICAL NAME	COMMON NAME	SIZE	ROOT BALL	COMMENT	TREE CANOPY
1	BN-H	Betula nigra 'Heritage'	Heritage River Birch	14-16' CLUMP	B&B	(3) Leader Clump Form	LARGE TREE
4	PC-CS	Pyrus calleryana 'Cleveland Select'	Cleveland Select Ornamental Pear	3-3.5" CAL.	B&B		MEDIUM TREE

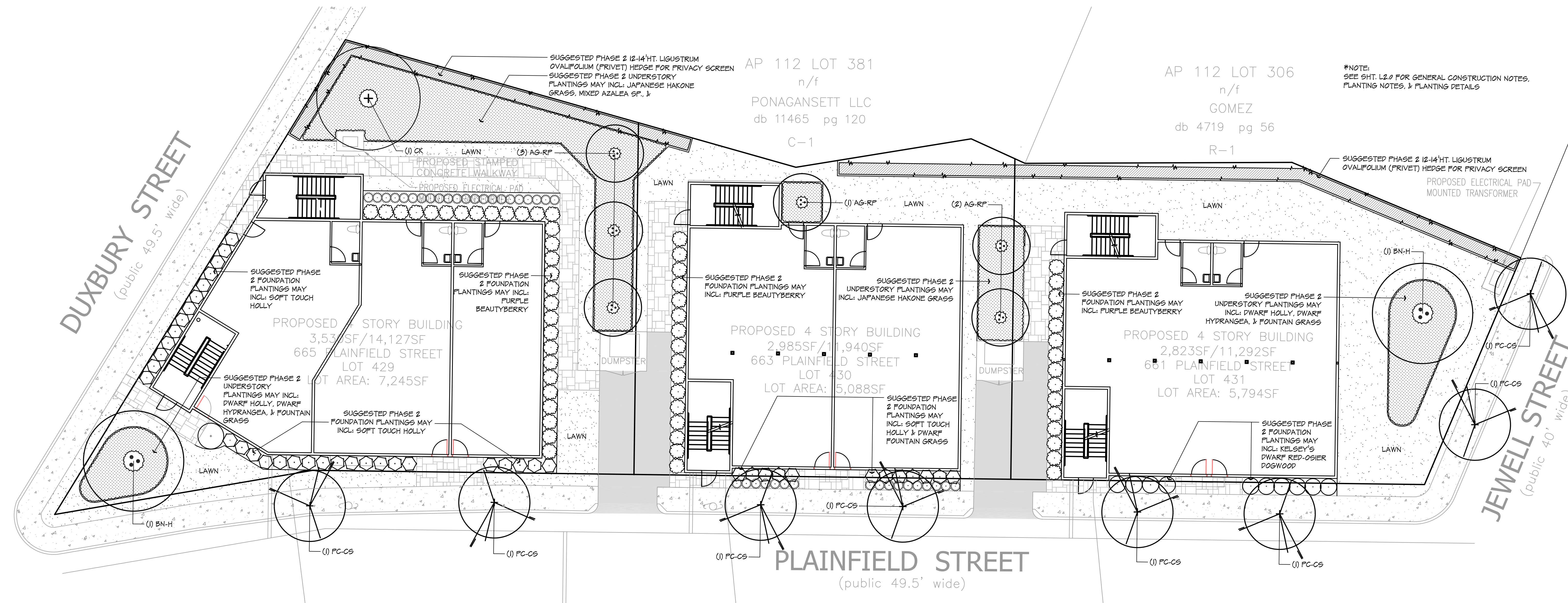

NOTE: FOR PERMITTING ONLY - NOT FOR CONSTRUCTION

INFINITY DESIGN GROUP, INC.

LANDSCAPE ARCHITECTURE & SITE PLANNING

640 THAMES ST
NEWPORT, RI 02840
TEL: 401.846.1610
E: psweeney@infinitydesigninc.com

www.infinitydesigninc.com
A Rhode Island Corporation

© COPYRIGHT
OWNERSHIP AND USE OF DOCUMENTS: THESE DRAWINGS, SPECIFICATIONS AND/OR OTHER DOCUMENTS ARE THE PROPERTY OF THE LANDSCAPE ARCHITECT AND HAVE BEEN PREPARED FOR THE OWNER. FOR THIS PROJECT AT THE SITE AND ARE NOT TO BE USED, IN WHOLE OR IN PART, FOR ANY OTHER PURPOSE, LOCATION OR OWNER WITHOUT WRITTEN CONSENT OF THE LANDSCAPE ARCHITECT.

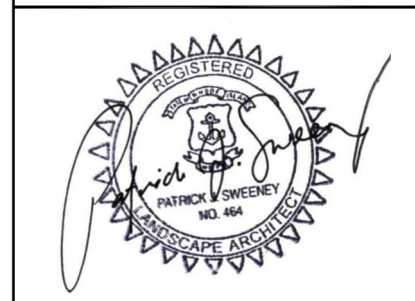

MIXED USE DEVELOPMENT

661, 663, & 665 PLAINFIELD ST., PROVIDENCE, RI 02895

DATE: 06/16/23

DRAWN BY: PS CHECKED BY: PS

SCALE: 1" = 10'-0"

LANDSCAPE PLAN

SHEET: **L1.0**

GENERAL CONSTRUCTION NOTES

1. NOTIFY DIG-SAFE AND LOCAL AUTHORITIES PRIOR TO ANY TYPE OF SITE PREPARATION OR CONSTRUCTION AT 811 or DIGSAFE.COM.
2. CONTRACTOR IS RESPONSIBLE FOR OBTAINING ALL REQUIRED PERMITS AND ASSOCIATED FEES FOR CONSTRUCTION.
3. LIMIT OF WORK LINE IS PROPERTY LINE UNLESS OTHERWISE INDICATED.
4. LOCATION, SUPPORT, PROTECTION AND RESTORATION OF ALL EXISTING UTILITIES AND APPURTENANCES SHALL BE THE RESPONSIBILITY OF THE CONTRACTOR. IT SHALL BE THE RESPONSIBILITY OF THE CONTRACTOR, PRIOR TO CONSTRUCTION, TO DETERMINE IN THE FIELD THE ACTUAL LOCATIONS AND ELEVATIONS OF ALL EXISTING UTILITIES WHETHER SHOWN ON THE PLAN OR NOT. THE CONTRACTOR SHALL CALL UTILITY PROTECTION SERVICE 72 HOURS PRIOR TO CONSTRUCTION. REPORT ANY DISCREPANCIES TO THE LANDSCAPE ARCHITECT.
5. CONTRACTOR TO NOTIFY LANDSCAPE ARCHITECT IF ADDITIONAL INFORMATION IS REQUIRED FOR BIDS OR CONSTRUCTION.
6. ALL EXISTING UTILITIES TO REMAIN OPERABLE DURING CONSTRUCTION. ANY NECESSARY TEMPORARY DISCONNECTIONS MUST BE COORDINATED W/ THE OWNER AND THE UTILITY CONCERNED. CONTRACTOR SHALL TERMINATE SERVICE ACCORDING TO UTILITY COMPANY SPECIFICATIONS.
7. CONTRACTOR TO REPAIR ANY DAMAGE TO UTILITY LINES OR STRUCTURES DURING CONSTRUCTION. DAMAGES SHALL BE REPAIRED AT NO ADDITIONAL COST TO OWNER AND TO OWNER'S UTILITY COMPANY'S SATISFACTION.
8. STORAGE AREAS FOR CONTRACTOR'S EQUIPMENT, PARKING, AND MATERIALS STOCKPILE SHALL BE IN THOSE AREAS APPROVED BY THE LANDSCAPE ARCHITECT AND OWNER.
9. ALL AREAS OUTSIDE THE LIMIT OF WORK LINE SHALL BE PROTECTED AND RESTORED TO THEIR ORIGINAL CONDITION IF DAMAGED DURING CONSTRUCTION.
10. CONDUCT ALL OPERATIONS W/ MINIMUM INTERFERENCE TO STREETS, SIDEWALKS, AND ACCESS TO THE PROPERTY AND BUILDING. PROVIDE, ERECT, AND MAINTAIN BARRICADES AS NECESSARY TO PROTECT USER'S SAFETY.
11. CONTRACTOR TO MAINTAIN WORK SITE IN AN ORDERLY MANNER, KEEPING THE PREMISES AND SURROUNDING AREAS FREE FROM ACCUMULATION OF DEBRIS AND TRASH RELATED TO WORK.

PLANTING NOTES

1. ALL PLANTS TO HAVE THE SAME RELATIONSHIP TO FINISH GRADE AFTER SETTLEMENT AS TO THEIR ORIGINAL GRADE BEFORE DIGGING. LOCATE PLANT COLLAR TWO OR THREE INCHES HIGHER THAN PLANTING SOIL MIX TO ENSURE CORRECT FINAL RELATIONSHIP.
2. APPLY AN APPROVED ANTI-DESSICANT TO ALL EVERGREENS BEFORE THEIR FIRST WINTER.
3. FLOOD ALL PLANTS WITH CLEAN WATER TWICE IN THE FIRST 24 HOURS AFTER PLANTING. CONTRACTOR TO ARRANGE FOR ALL PLANTS TO BE PLANTED WITHIN THREE DAYS AFTER DELIVERY TO THE SITE UNLESS OTHERWISE APPROVED BY THE LANDSCAPE ARCHITECT.
4. NEVER CUT A LEADER.
5. TRIM ONLY BROKEN OR DEAD BRANCHES FROM EVERGREEN PLANTS.
6. THE CONTRACTOR SHALL SUPPLY ALL PLANT MATERIAL AND MULCH IN SUFFICIENT QUANTITIES TO COMPLETE PLANTING AS SHOWN ON THE DRAWINGS. DRAWING QUANTITIES TAKE PRECEDENCE OVER THE PLANT LIST QUANTITIES.
7. ALL PLANT MATERIAL SHALL CONFORM TO THE GUIDELINES SET FORTH BY THE AMERICAN STANDARD FOR NURSERY STOCK, PUBLISHED BY THE AMERICAN ASSOCIATION OF NURSERYMEN, INC.
8. ALL TREES SHALL HAVE THE BEST FACE SIDE EXPOSED.
9. ALL PLANTS SHALL BE BALLED AND BURLAPPED OR CONTAINER GROWN, UNLESS OTHERWISE APPROVED BY THE LANDSCAPE ARCHITECT.
10. CONTRACTOR TO STAKE TREE LOCATIONS FOR APPROVAL BY LANDSCAPE ARCHITECT.
11. ALL TREES TO RECEIVE A MINIMUM OF THREE INCHES OF MULCH. ALL SHRUBS, VINES, AND GROUND COVER TO RECEIVE A MINIMUM OF TWO INCHES OF MULCH.
12. BOTANICAL NAMES SHALL TAKE PRECEDENCE OVER COMMON NAMES.
13. WHERE SPECIFIED, CALIPER SIZE TO BE OVERRIDING FACTOR IN TREE SELECTION.
14. STAKE OR GUY ALL TREES AND LARGE EVERGREEN MATERIAL.
15. CONTRACTOR TO PROVIDE A ONE YEAR GUARANTEE ON ALL PLANT MATERIAL. CONTRACTOR TO MAINTAIN ALL PLANTINGS UNTIL FINAL PROJECT ACCEPTANCE. GUARANTEE PERIOD TO BEGIN AT PROJECT ACCEPTANCE.
16. ALL PLANT MATERIAL TO BE INSTALLED PRIOR TO FINAL TOP-DRESSING.
17. NO PLANTING BEFORE THE ACCEPTANCE OF ROUGH GRADING.

NOTE: FOR PERMITTING ONLY - NOT FOR CONSTRUCTION

Notes:

1- Trees shall be of quality prescribed in crown observations and root observations details and specifications.

2- See specifications for further requirements related to this detail.

Trunk caliper shall meet ANSI Z60 current edition for root ball size.

Root ball modified as required.

Round-topped soil berm 4" high x 8" wide above root ball surface shall be constructed around the root ball. Berm shall begin at root ball periphery.

Bottom of root ball rests on existing or recompacted soil.

3x widest dimension of root ball.

SECTION VIEW

Central leader. (See crown observations detail).

Root ball surface shall be positioned to be one-quarter above finished grade. Prior to mulching, lightly tamp soil around the root ball in 6" lifts to brace tree. Do not over compact. When the planting hole has been backfilled, pour water around the root ball to settle the soil.

Existing site soil added to create a smooth transition from the top of the raised root ball to the finished grade at a 15% max. slope.

4" layer of mulch. No more than 1" of mulch on top of root ball. (See specifications for mulch).

Original grade. Finished grade.

Loosened soil. Dig and turn the soil to reduce compaction to the area and depth shown. Existing soil.

1 TREE PLANTING DETAIL

SCALE: N.T.S.

NOTES

1. AT PLANTING PRUNE ONLY BROKEN OR DEAD BRANCHES PER ANSI 300 STANDARD.

2. PLANTING PIT/TRENCH SHALL BE DUG DEEP ENOUGH TO ALLOW AT LEAST 1/8TH OF ROOT BALL TO SET ABOVE EXISTING GRADE.

3. SET PLANTS IN ERECT, STABLE, AND UNIFORM POSITIONS IN THE CENTER OF THE PLANTING PIT. ORIENT BEST FACE OF PLANT TO BE THE MOST VISIBLE.

4. UNLESS OTHERWISE DIRECTED BY COUNTY URBAN FORESTER, BACKFILL SOIL MIXTURE WILL BE 3/4 EXISTING SOIL CLEANED OF DEBRIS (GRAVEL, ROCKS, STICKS, TRASH, ETC.) AND MIXED WITH 1/4 ORGANIC MATERIAL (COMPOSTED BARK, LEAF MOLD, OR OTHER PLANT DEBRIS PROCESSED TO A POINT OF DECAY AND APPROVED BY THE COUNTY URBAN FORESTER. PEAT MOSS MAY NOT BE USED).

5. CONTRACTOR SHALL REMOVE EXCESS SOIL & DEBRIS FROM SITE.

6. DO NOT PLACE MULCH IN CONTACT WITH STEM OF SHRUBS

THIS DETAIL SUPERSEDES ALL OTHER SHRUB PLANTING

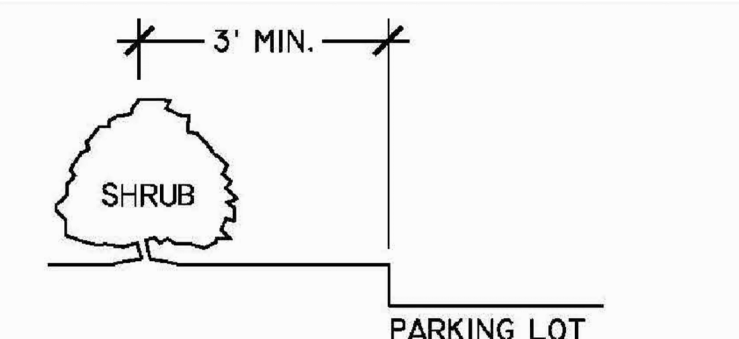

TYPICAL SHRUB PLACEMENT NEAR PARKING LOTS NOT TO SCALE

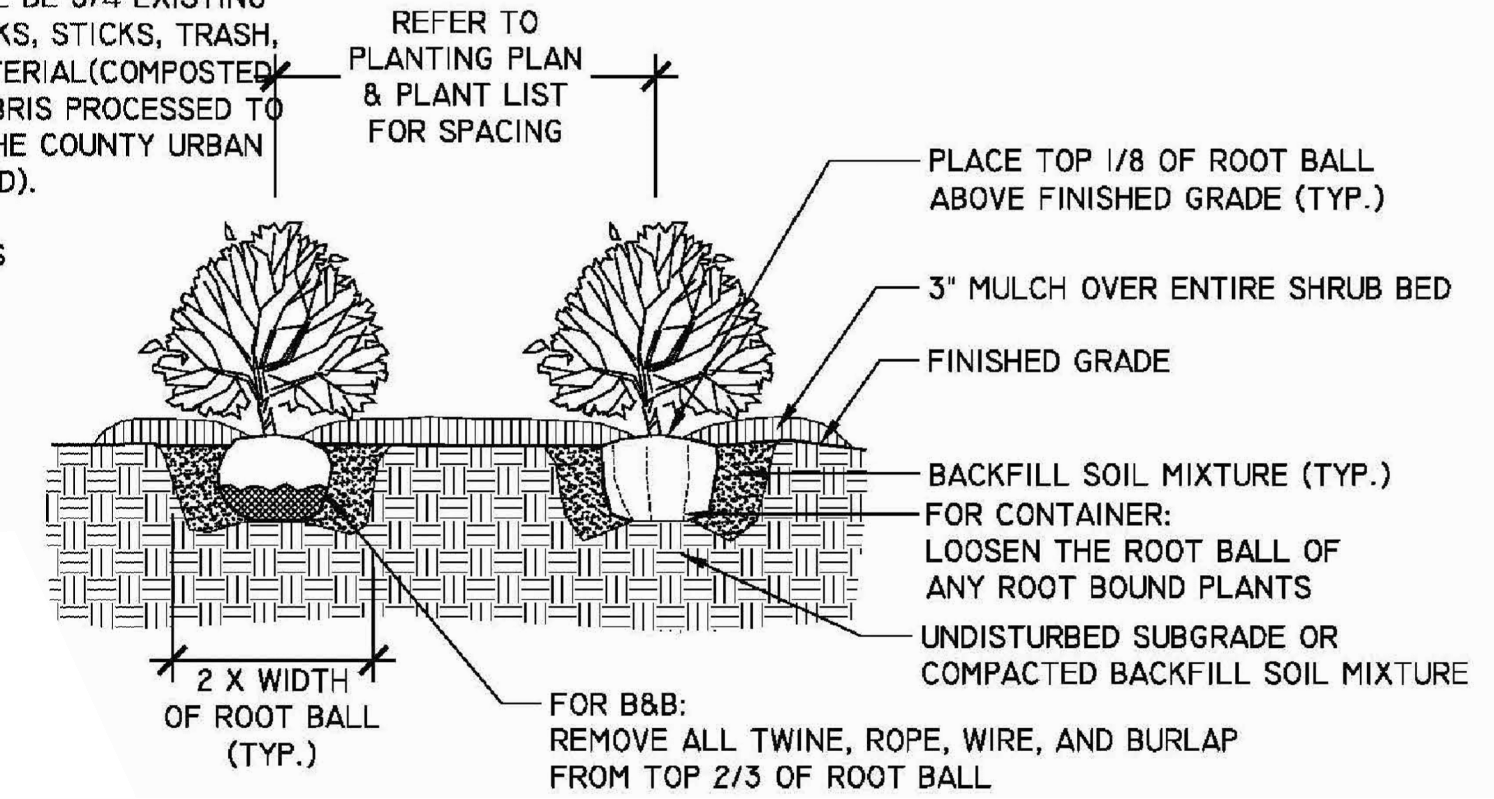

2 SHRUB PLANTING DETAIL

SCALE: N.T.S.

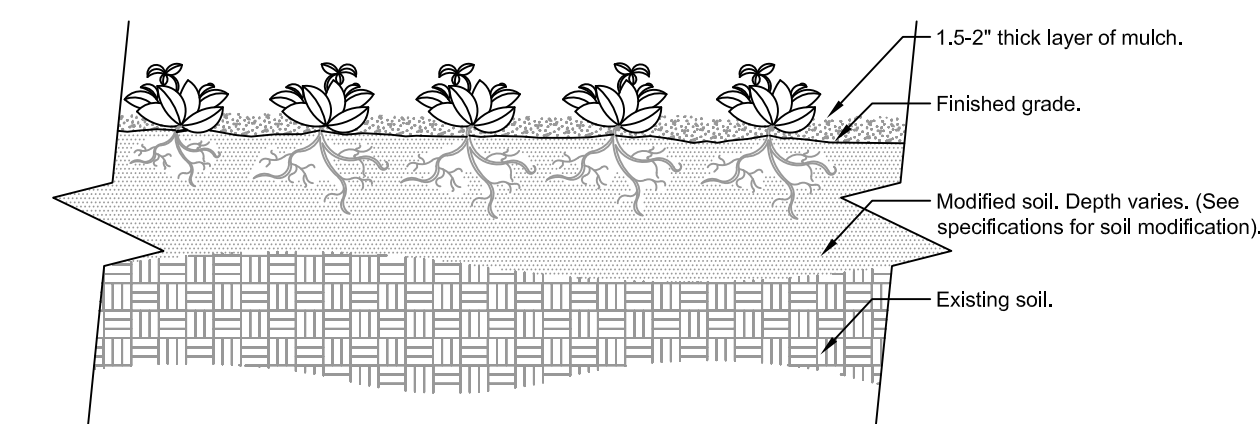

SECTION VIEW

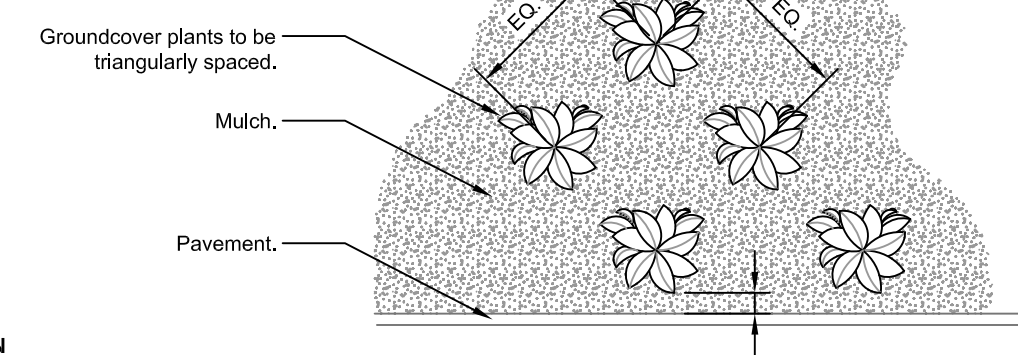

PLAN

Notes:
1- See planting legend for groundcover species, size, and spacing dimension.
2- Small roots (1/2" or less) that grow around, up, or down the root ball periphery are considered a normal condition in container production and are acceptable however they should be eliminated at the time of planting. Roots on the periphery can be removed at the time of planting. (See root ball shaving container detail).
3- Settle soil around root ball of each groundcover prior to mulching.

3 GROUND COVER PLANTING DETAIL

SCALE: N.T.S.

INFINITY DESIGN GROUP, INC.



LANDSCAPE ARCHITECTURE & SITE PLANNING
640 THAMES ST
NEWPORT, RI 02840
TEL: 401.846.1610
E: psweeney@infinitydesigninc.com
www.infinitydesigninc.com
A Rhode Island Corporation

© COPYRIGHT
OWNERSHIP AND USE OF DOCUMENTS: THESE DRAWINGS, SPECIFICATIONS, AND/OR OTHER DOCUMENTS ARE THE PROPERTY OF THE LANDSCAPE ARCHITECT AND HAVE BEEN PREPARED FOR THE OWNER. FOR THIS PROJECT AT THIS SITE AND ARE NOT TO BE USED, IN WHOLE OR IN PART, FOR ANY OTHER PURPOSE, LOCATION OR OWNER WITHOUT WRITTEN CONSENT OF THE LANDSCAPE ARCHITECT.



MIXED USE DEVELOPMENT
661, 663, & 665 PLAINFIELD ST., PROVIDENCE, RI 02895

DATE:
06/16/23

DRAWN BY: PS
CHECKED BY: PS

SCALE:
AS NOTED

LANDSCAPE PLAN
(DETAILS & NOTES)

SHEET:

L2.0