

Armory
1989, expanded 2004
509 properties

City of Providence - Planning & Development Department
Proposed Armory LHD expansion

Legend

- Proposed Armory Expansion
- Existing LHD



Broadway
1982; 164 properties

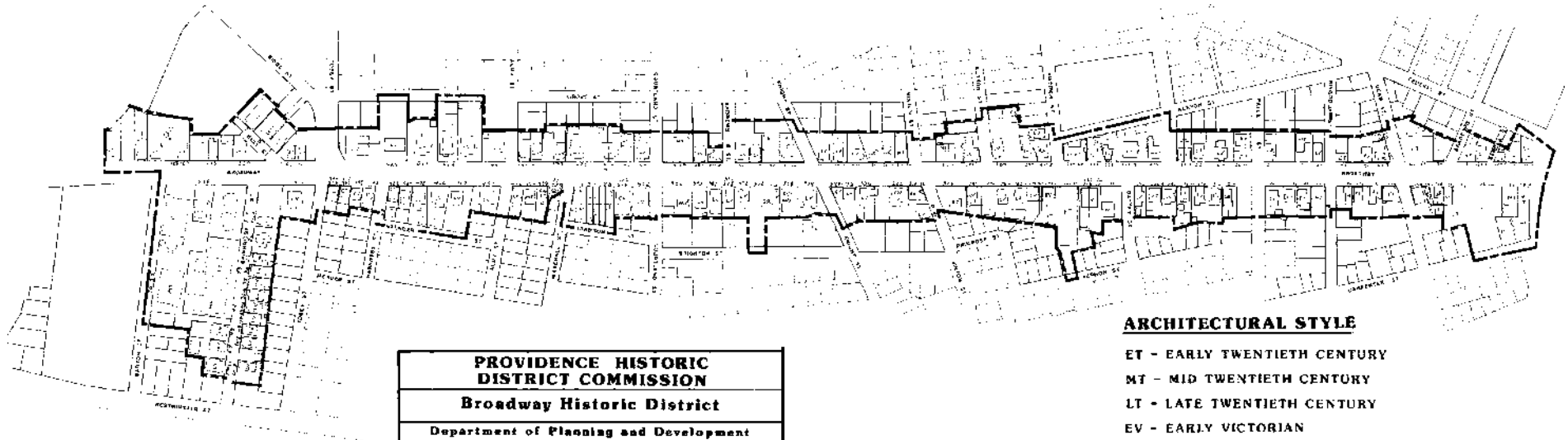

PROVIDENCE HISTORIC DISTRICT COMMISSION	
Broadway Historic District	
Department of Planning and Development City of Providence Rhode Island	
	ADOPTED: SEPTEMBER 10, 1982 ORDINANCE #494

ARCHITECTURAL STYLE

- ET - EARLY TWENTIETH CENTURY
- MT - MID TWENTIETH CENTURY
- LT - LATE TWENTIETH CENTURY
- EV - EARLY VICTORIAN
- LV - LATE VICTORIAN
- F - FEDERAL
- GR - GREEK REVIVAL
- C - COLONIAL
- BOUNDARY LINE



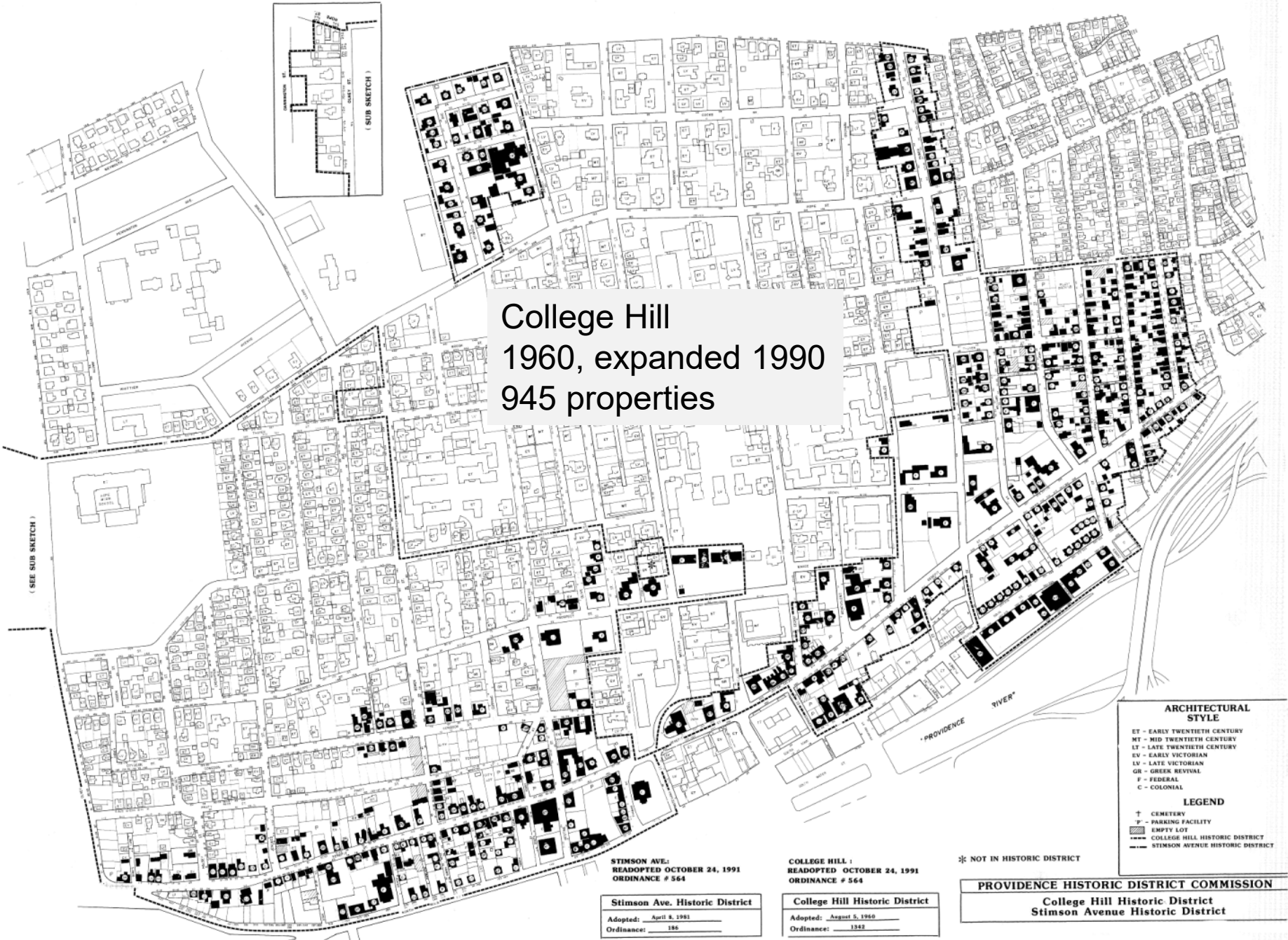

College Hill
 1960, expanded 1990
 945 properties

STIMSON AVE.
 READOPTED OCTOBER 24, 1991
 ORDINANCE # 564

COLLEGE HILL
 READOPTED OCTOBER 24, 1991
 ORDINANCE # 564

Stimson Ave. Historic District
 Adopted: April 5, 1991
 Ordinance: 186

College Hill Historic District
 Adopted: August 5, 1990
 Ordinance: 1242

- ARCHITECTURAL STYLE**
- ET - EARLY TWENTIETH CENTURY
 - MT - MID TWENTIETH CENTURY
 - LT - LATE TWENTIETH CENTURY
 - EV - EARLY VICTORIAN
 - LV - LATE VICTORIAN
 - QR - GREEN REVIVAL
 - F - FEDERAL
 - C - COLONIAL
- LEGEND**
- † CEMETERY
 - P PARKING FACILITY
 - EMPTY LOT
 - COLLEGE HILL HISTORIC DISTRICT
 - STIMSON AVENUE HISTORIC DISTRICT
- * NOT IN HISTORIC DISTRICT

PROVIDENCE HISTORIC DISTRICT COMMISSION
 College Hill Historic District
 Stimson Avenue Historic District

Power-Cooke
2021; 90 properties

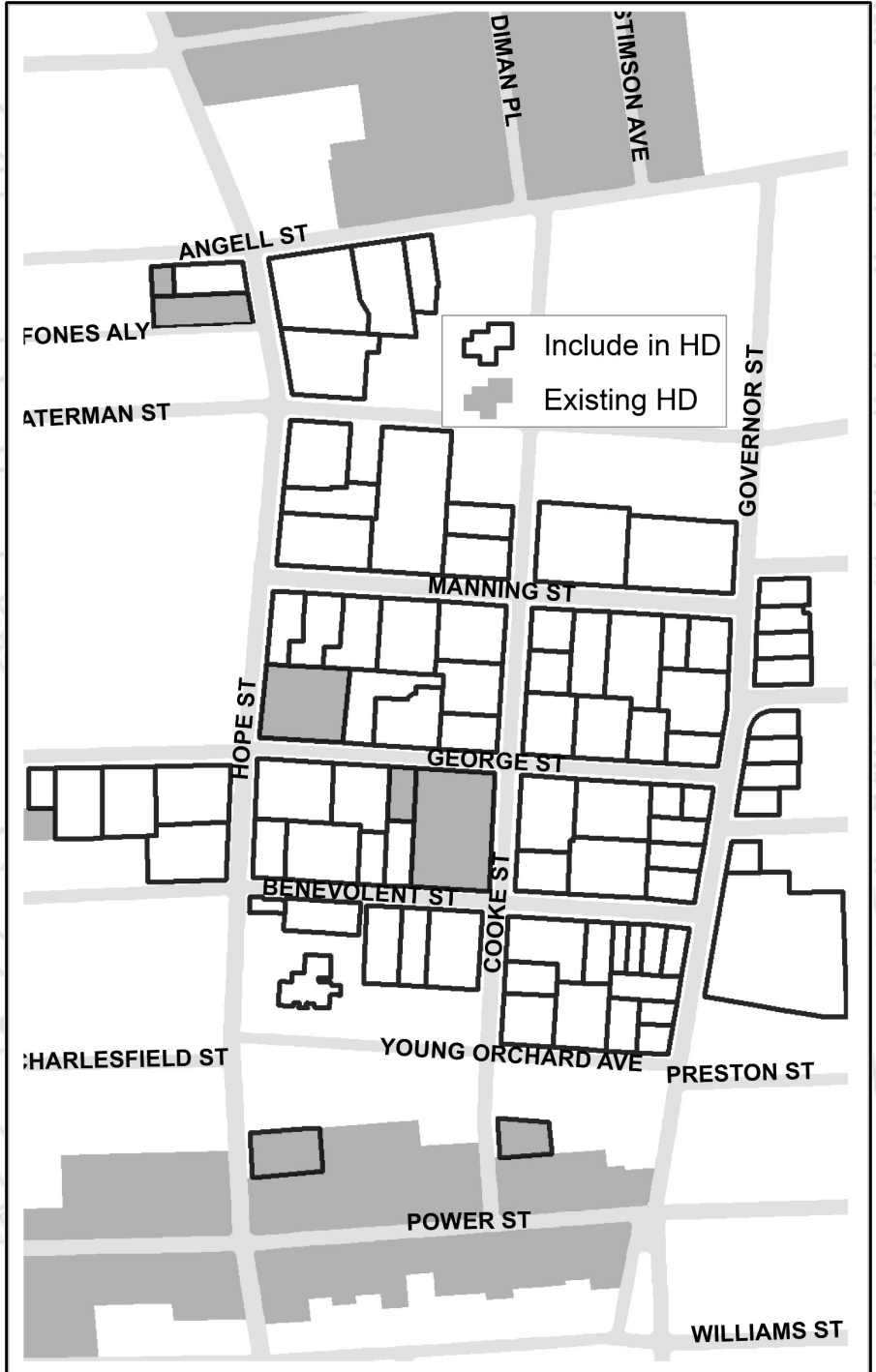

South Elmwood 1992; 123 Properties

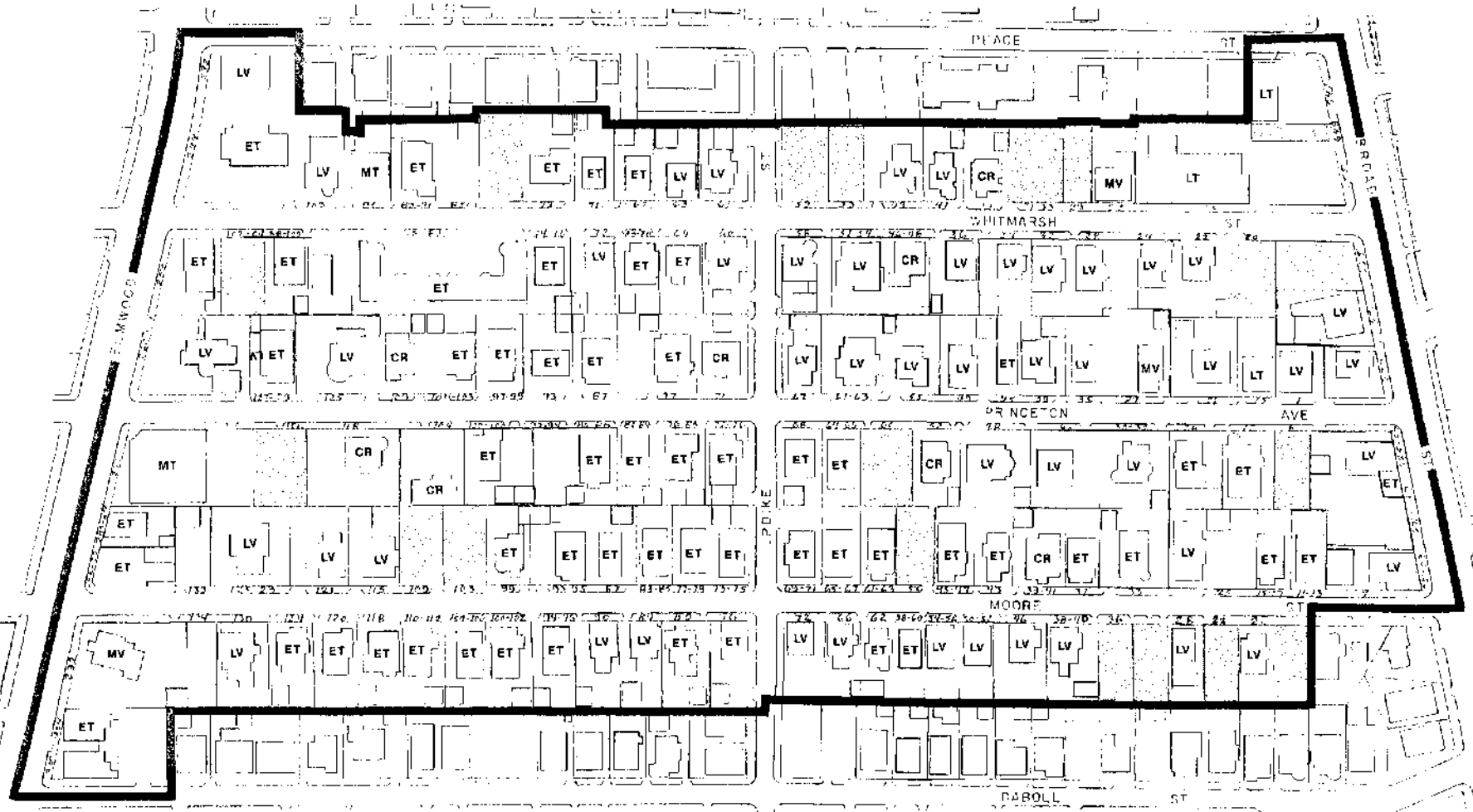

Stimson Avenue 1981; 32 Properties

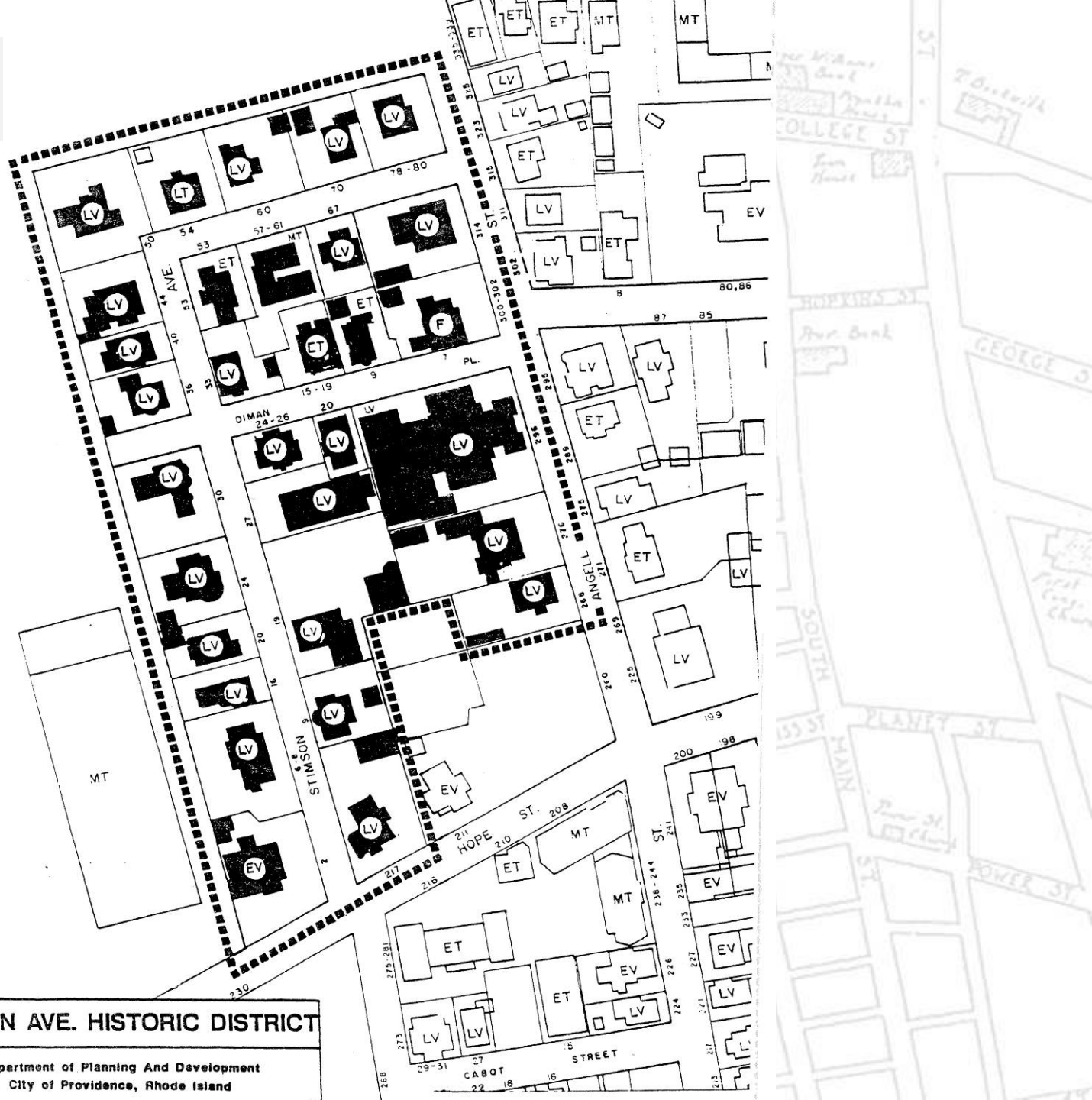

STIMSON AVE. HISTORIC DISTRICT

Department of Planning And Development
City of Providence, Rhode Island