



CITY OF PROVIDENCE, RHODE ISLAND

Department: Department of Public Property

RFP Title: Vincent Brown Rec Center Interior Windows

Opening Date: 02/26/2024

Addendum #: 1

Issue Date: 02/22/2024.

The purpose of this addendum is to publish SKA 1.0 detailing mirror acrylic plexiglass panels to be included in the base bid.

VINCENT BROWN
RECREATIONAL CENTER
FLOOR REPLACEMENT

Doyle Ave,
Providence, Rhode Island, 02906



CITY OF PROVIDENCE
25 Dorrance St, Providence, RI 02903



400 Massasoit Avenue,
Suite 300, Second Floor
East Providence, Rhode Island
p. (401) 331-9200

2 Hampshire Street,
Suite 106, First Floor
Foxboro, Massachusetts
p. (774) 215-0290
rowse@rowsearchitects.com

OWNERSHIP AND USE OF DOCUMENTS, DRAWINGS AND SPECIFICATIONS AS INSTRUMENTS OF PROFESSIONAL SERVICE, ARE, AND SHALL REMAIN, THE PROPERTY OF THE ARCHITECT. THESE DOCUMENTS ARE NOT TO BE USED, IN WHOLE OR IN PART, FOR ANY OTHER PROJECTS OR PURPOSES, OR BY ANY OTHER PARTIES THAN THOSE PROPERLY AUTHORIZED BY CONTRACT WITHOUT THE EXPRESS AUTHORIZATION OF THE ARCHITECT.

GENERAL NOTES

- EXISTING CONDITIONS WERE OBTAINED FROM DRAWINGS AND DATA PROVIDED BY THE OWNER AND A/E FIELD SURVEY. NO WARRANTY OF ACTUAL CONDITIONS IS INTENDED BY ARCHITECT OR OWNER. CONTRACTOR TO VERIFY AND COORDINATE ALL EXISTING CONDITIONS WITH NEW WORK PRIOR TO BID, START OF CONSTRUCTION OR ANY FABRICATION.
- CONTRACTOR SHALL VISIT SITE, PRIOR TO BID, AND CAREFULLY INVESTIGATE AND EXAMINE THE AREA OF WORK SO AS TO SATISFY HIMSELF AS TO THE NATURE AND LOCATION OF THE WORK. CONTRACTOR TO NOTE THE CHARACTER, QUALITY, QUANTITIES OF MATERIALS REQUIRED AND DIFFICULTIES TO BE ENCOUNTERED. THE KIND AND EXTENT OF EQUIPMENT AND FACILITIES NEEDED FOR PERFORMANCE OF THE WORK AND OTHER ITEMS WHICH MAY, IN ANY WAY, AFFECT THE WORK OR CONTRACTOR'S PERFORMANCE.
- DRAWINGS DO NOT INCLUDE NECESSARY COMPONENTS FOR CONSTRUCTION SAFETY.
- NO EXITS SHALL BE CLOSED WITHOUT THE WRITTEN PERMISSION OF THE OWNER AND LOCAL AUTHORITIES HAVING JURISDICTION.
- THE BUILDINGS WILL BE OCCUPIED DURING ALL OF THE CONSTRUCTION PROCESS. THE CONSTRUCTION SCHEDULE SHALL BE DEVELOPED WITH THE UNDERSTANDING THAT THE BUILDING IS OCCUPIED.



Date: FEBRUARY 21, 2023

Drawn by: BBR Proj. Mgr.: EAR

Revisions	No.	Date	Description

REVISION SKETCH

SKA 1.0

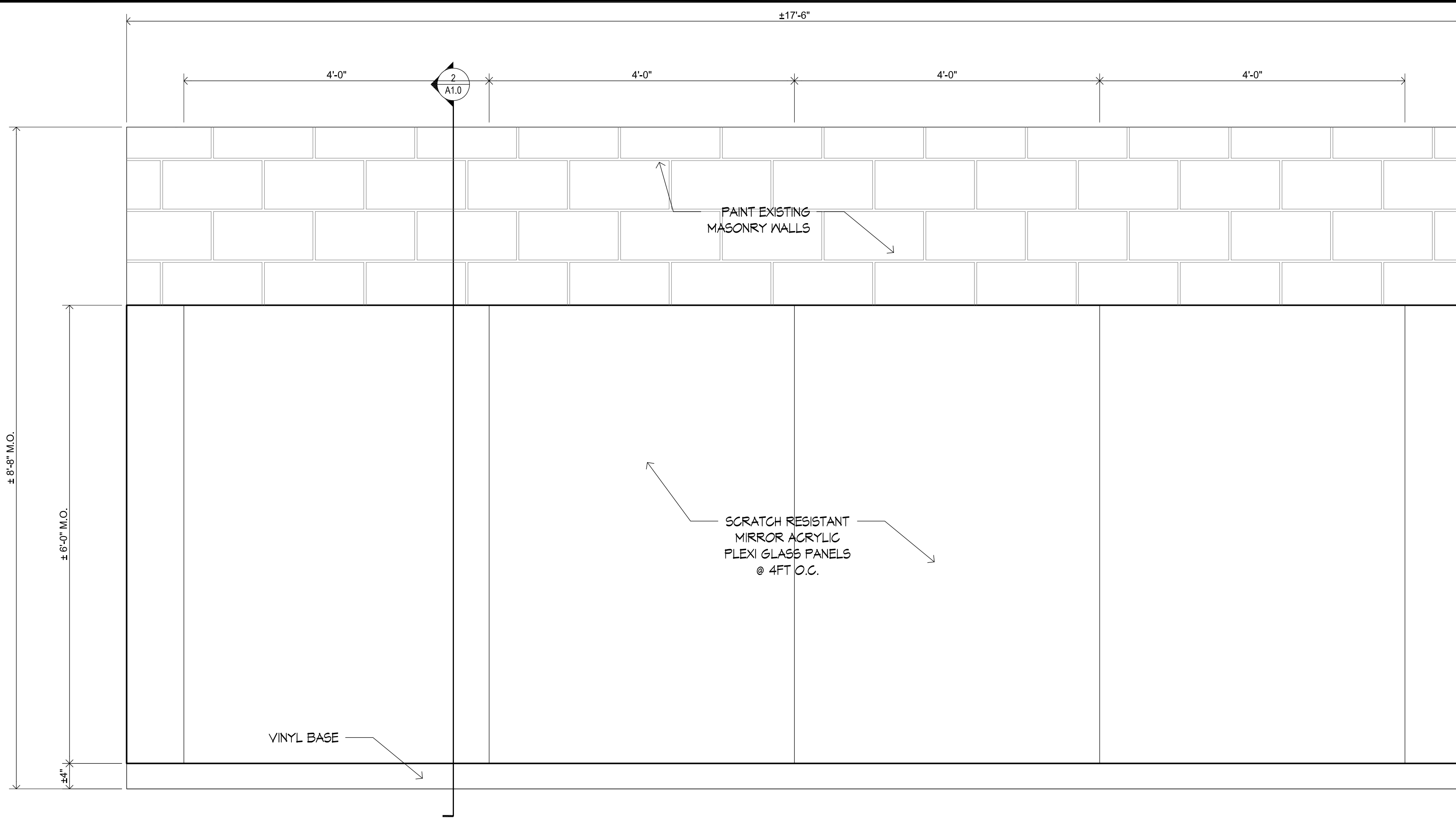

1 PLEXI GLASS PANELS
SKA 1.0 1" = 1' - 0"

2 SECTION DETAIL
SKA 1.0 6" = 1' - 0"

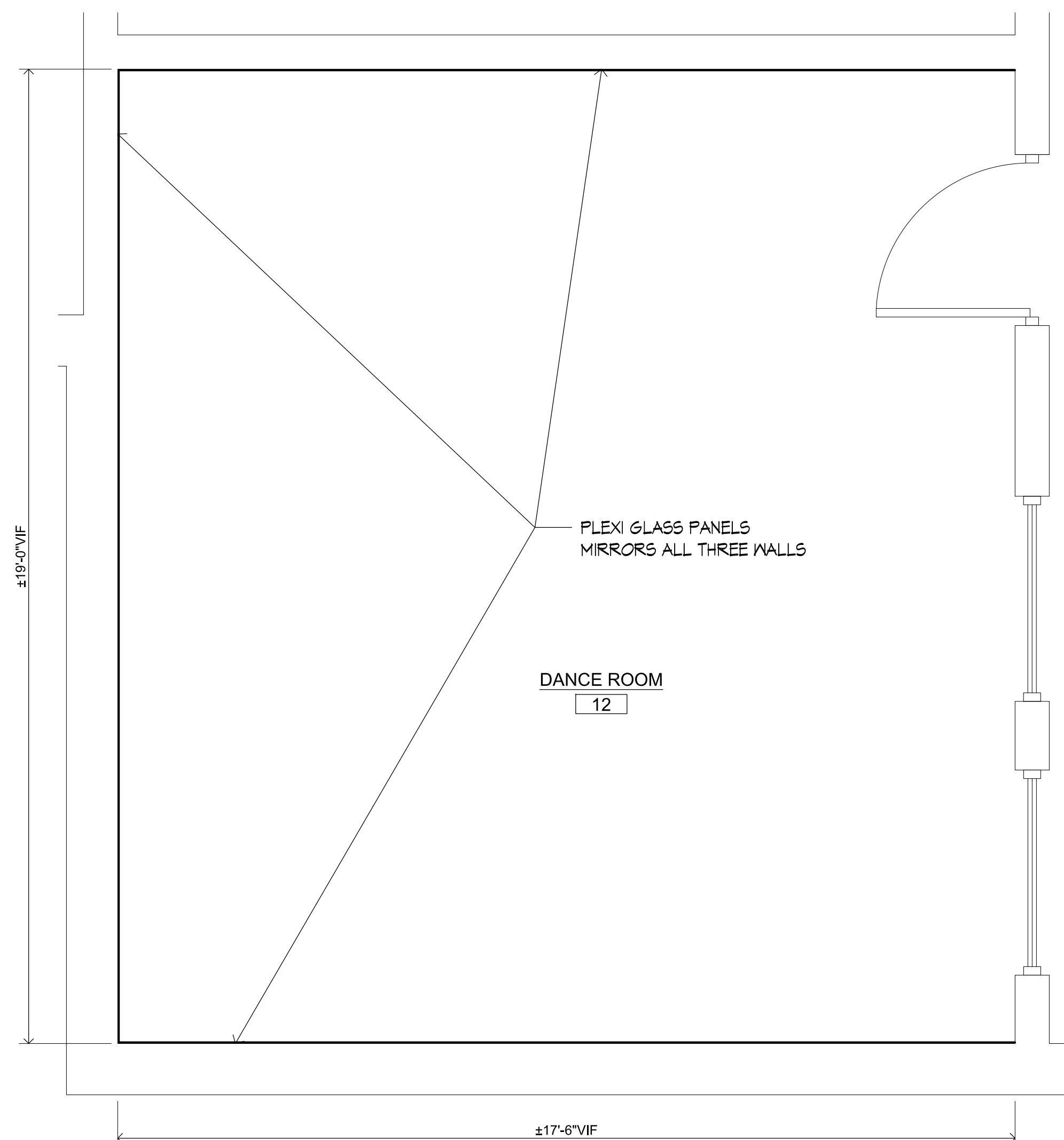

3 ENLARGED PLAN
SKA 1.0 1/2" = 1' - 0"