

# City of Providence

## Riverwalk Resilience



ARUP



# Study Area



# Objectives



**Preserve & rehabilitate what people love**



**Expand placemaking & programming**



**Improve safety & increase use**



**Provide connectivity & accessibility**



**Create ecological benefits & resiliency**

# Scope of Work

- **Continue community engagement**
- **Field investigations & surveys**
- **Permits & approvals**
- **Prepare bid documents for construction**

# Schedule

## 2025

- **Spring:** Updated Plans, Permit Submission + Public Meeting
- **Fall:** 60% Design Plans + Public Meeting

## 2026

- 90% Design Plans & Final Permit Submissions

## 2027

- Final Bid Documents



# Design Status

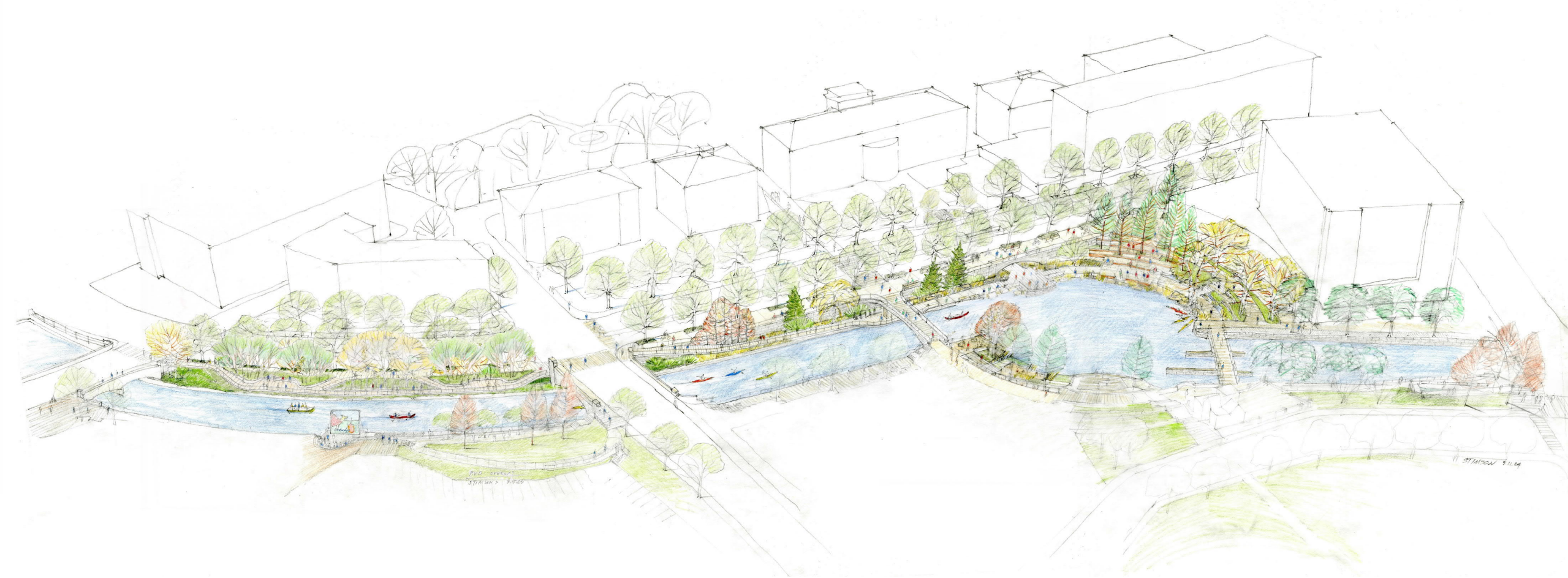

# Resiliency

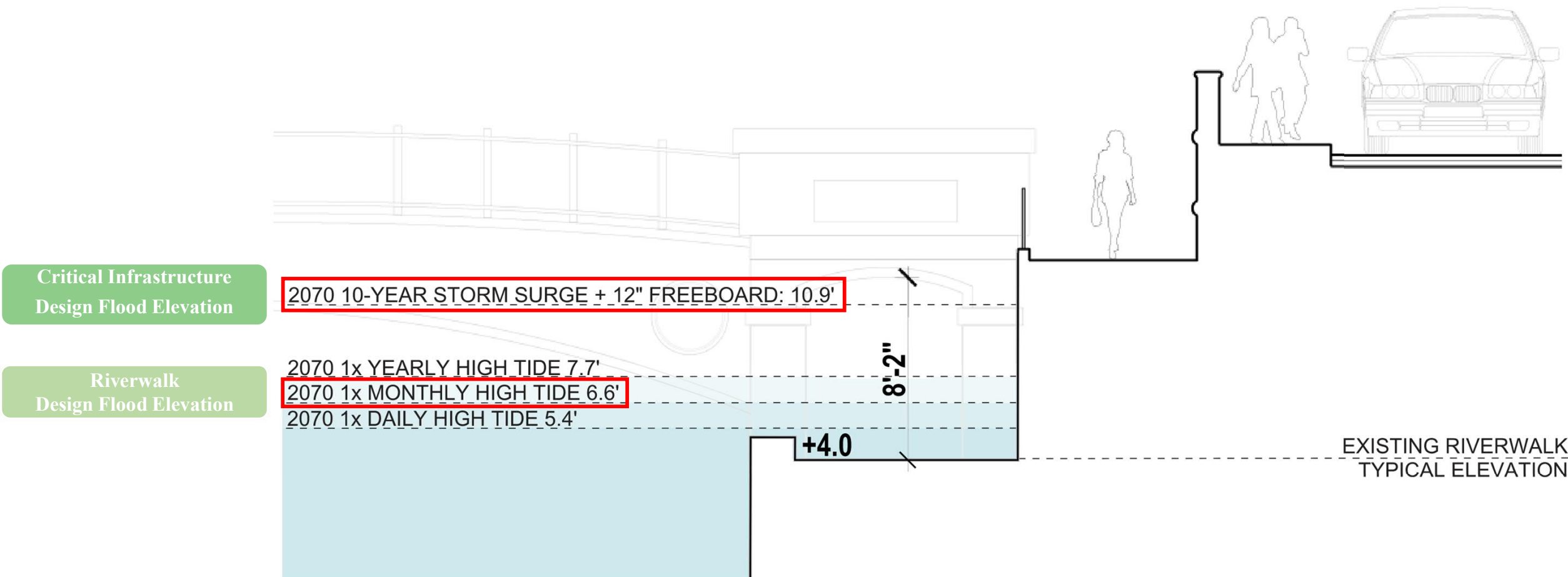

Notes:  
-Sea Level Rise Projections Based on NOAA 2022 High Curve.  
-All Elevations are NAVD88.

# Connectivity

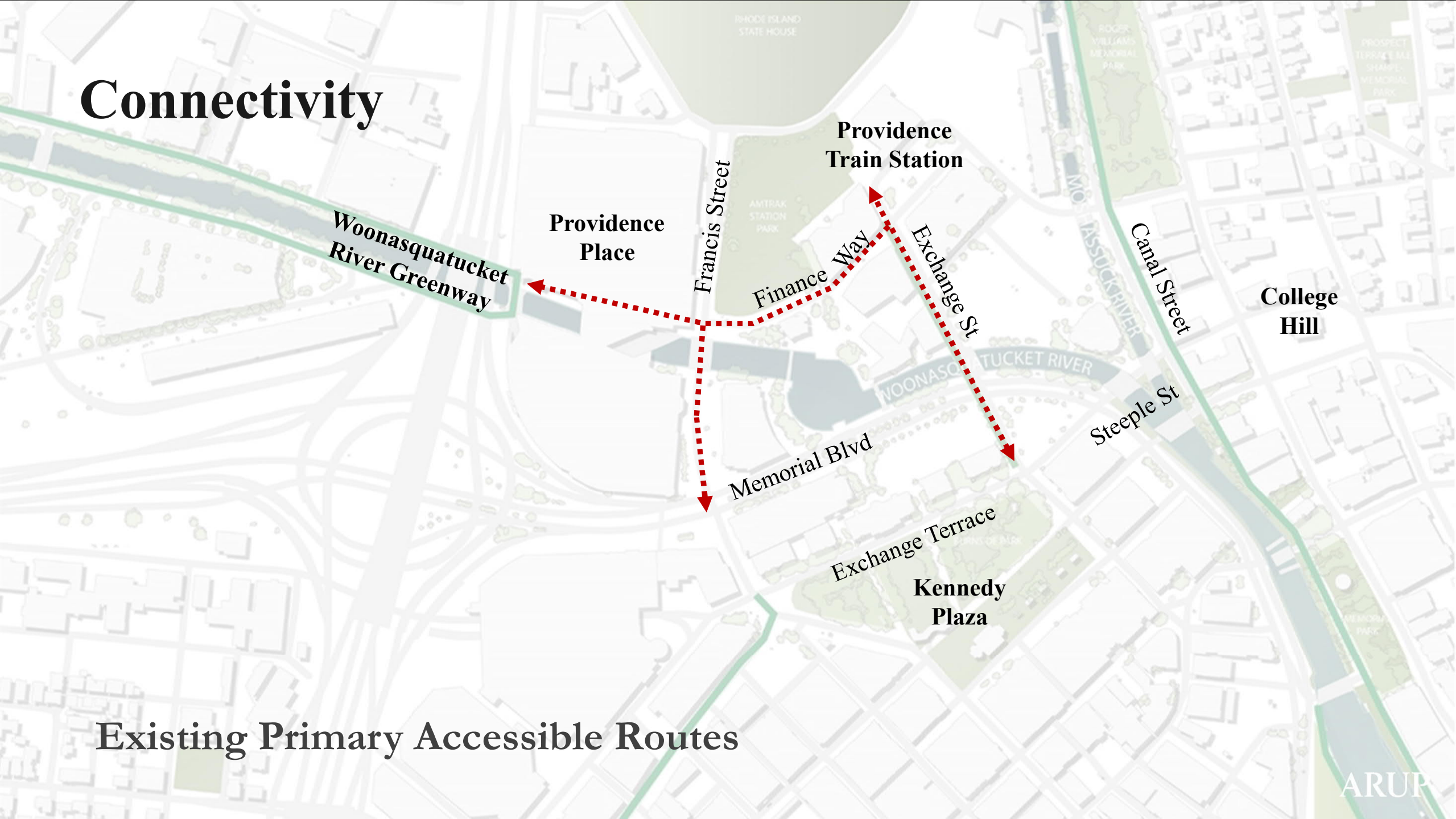

Existing Primary Accessible Routes



# Connectivity

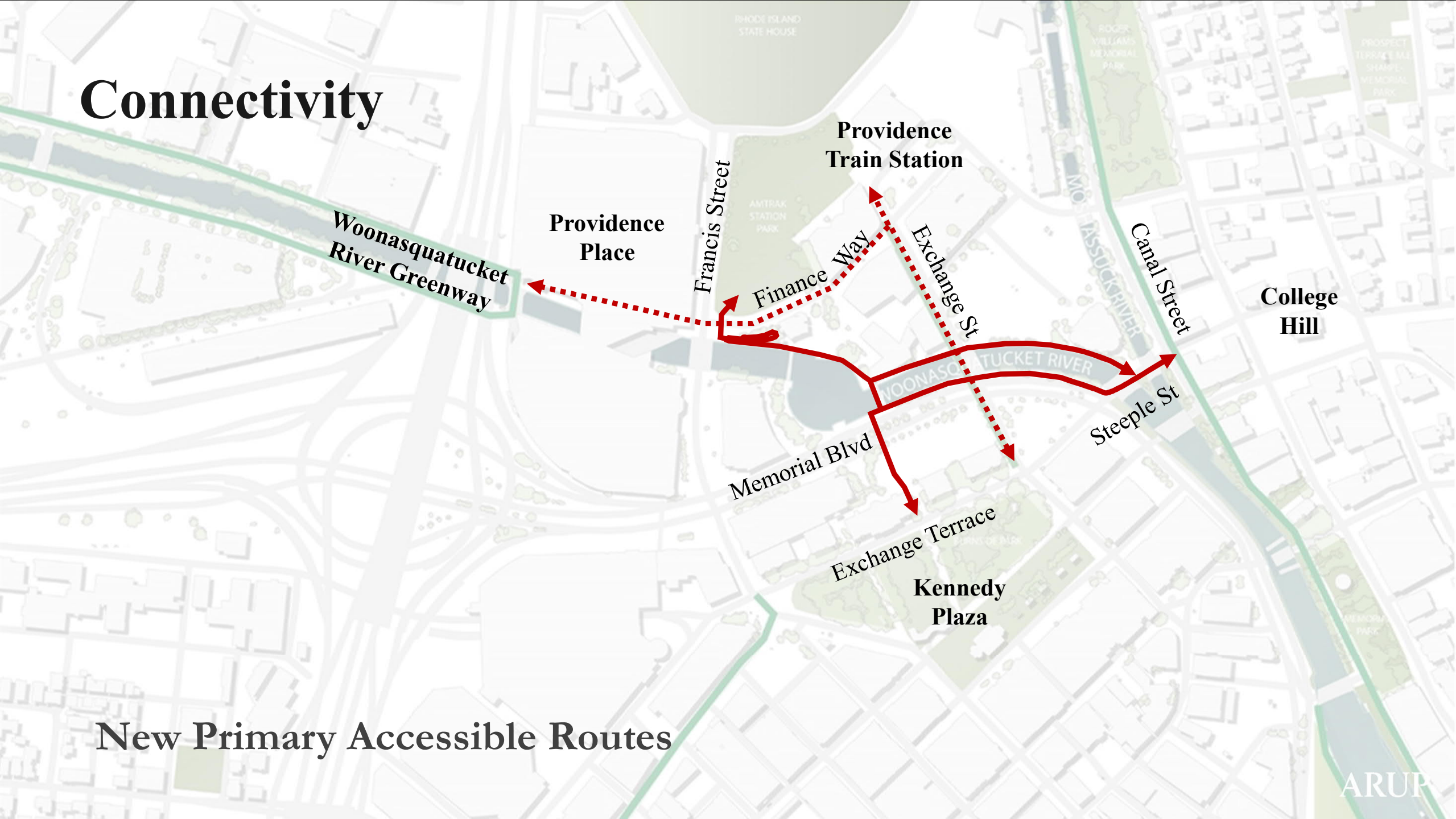

New Primary Accessible Routes

# Connectivity

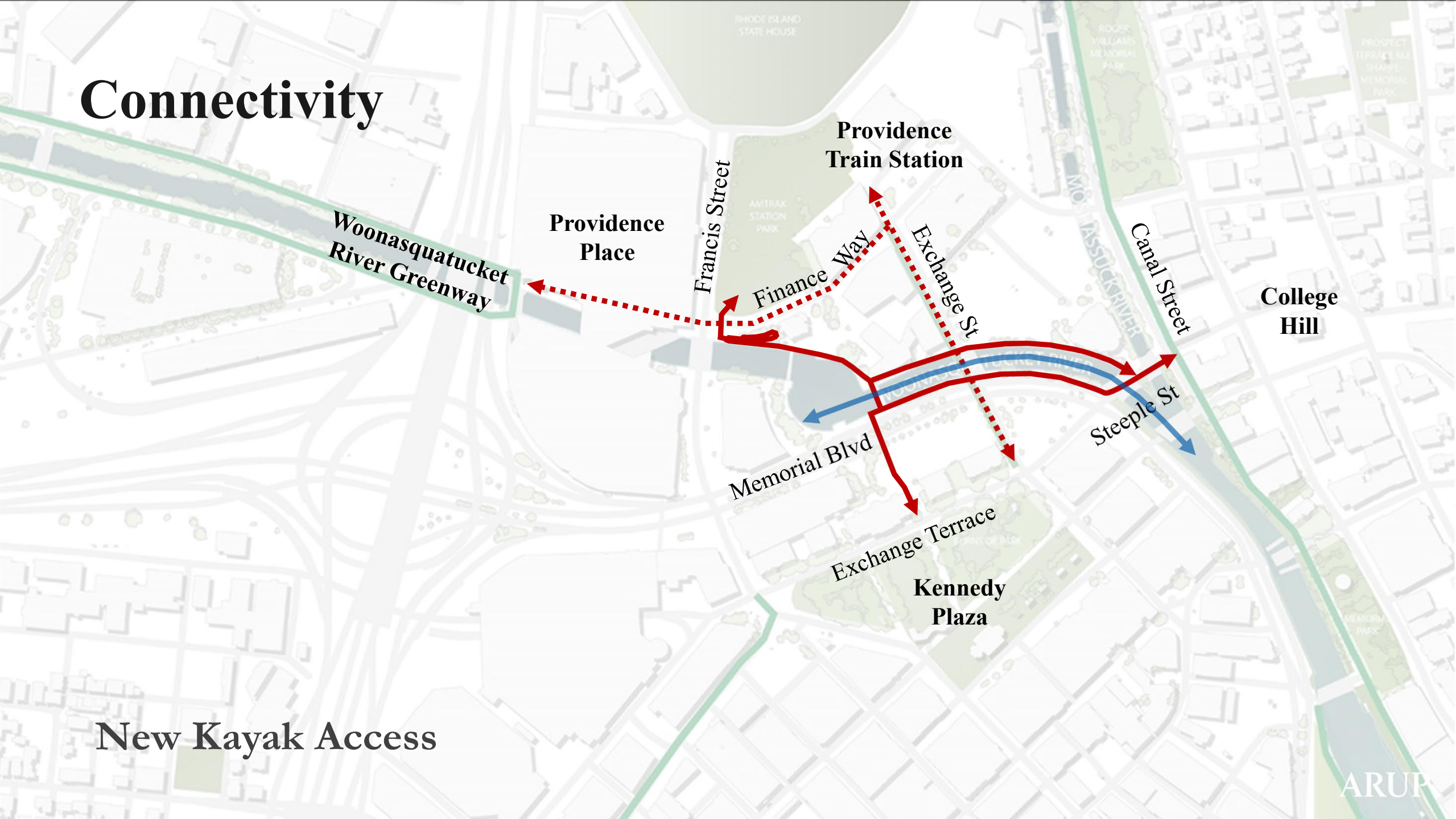

Woonasquatucket  
River Greenway

Providence  
Place

Providence  
Train Station

Francis Street

Finance Way

Exchange St

Canal Street

College  
Hill

Memorial Blvd

Steeple St

Exchange Terrace  
Kennedy  
Plaza

New Kayak Access



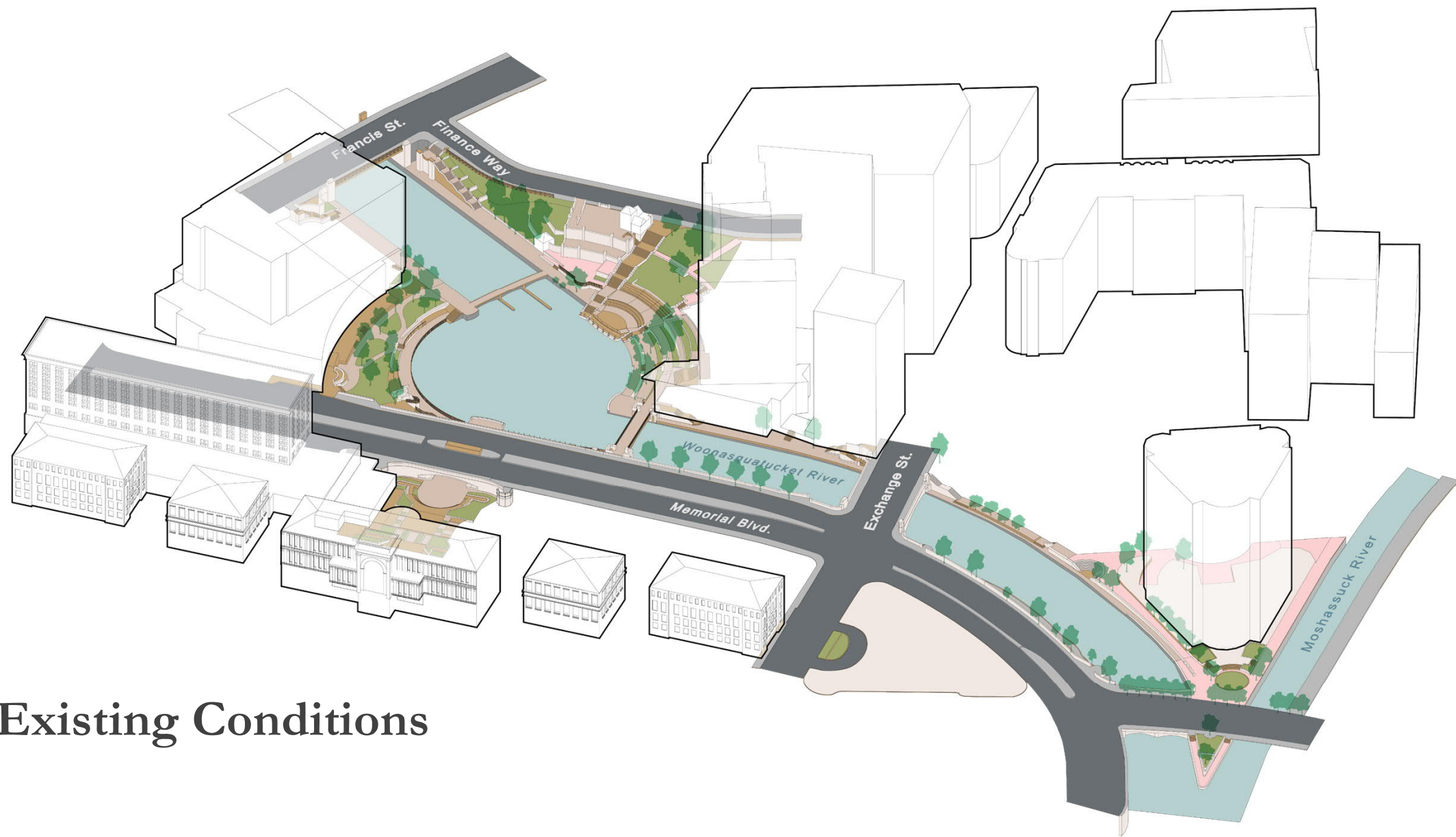

Existing Conditions



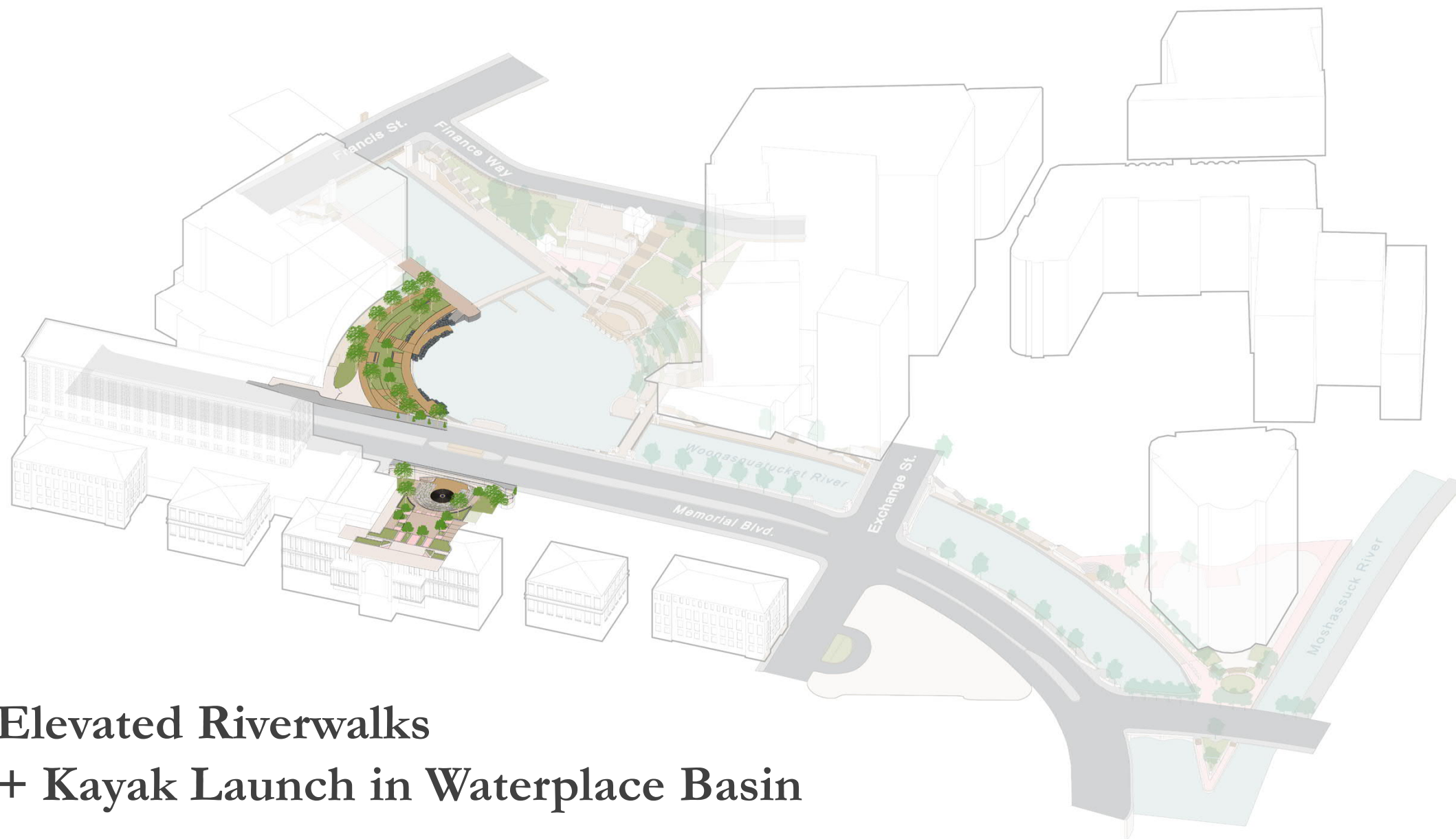

**Elevated Riverwalks  
+ Kayak Launch in Waterplace Basin**



**Accessible Connection to Steeple & Finance**  
**+ New Public Restrooms**  
**+ Improved Event Infrastructure**



**Elevated Riverwalks on Southside of River  
+ Resilient Riverwalks on Northside of River  
+ Wider Sidewalks on Memorial Boulevard**



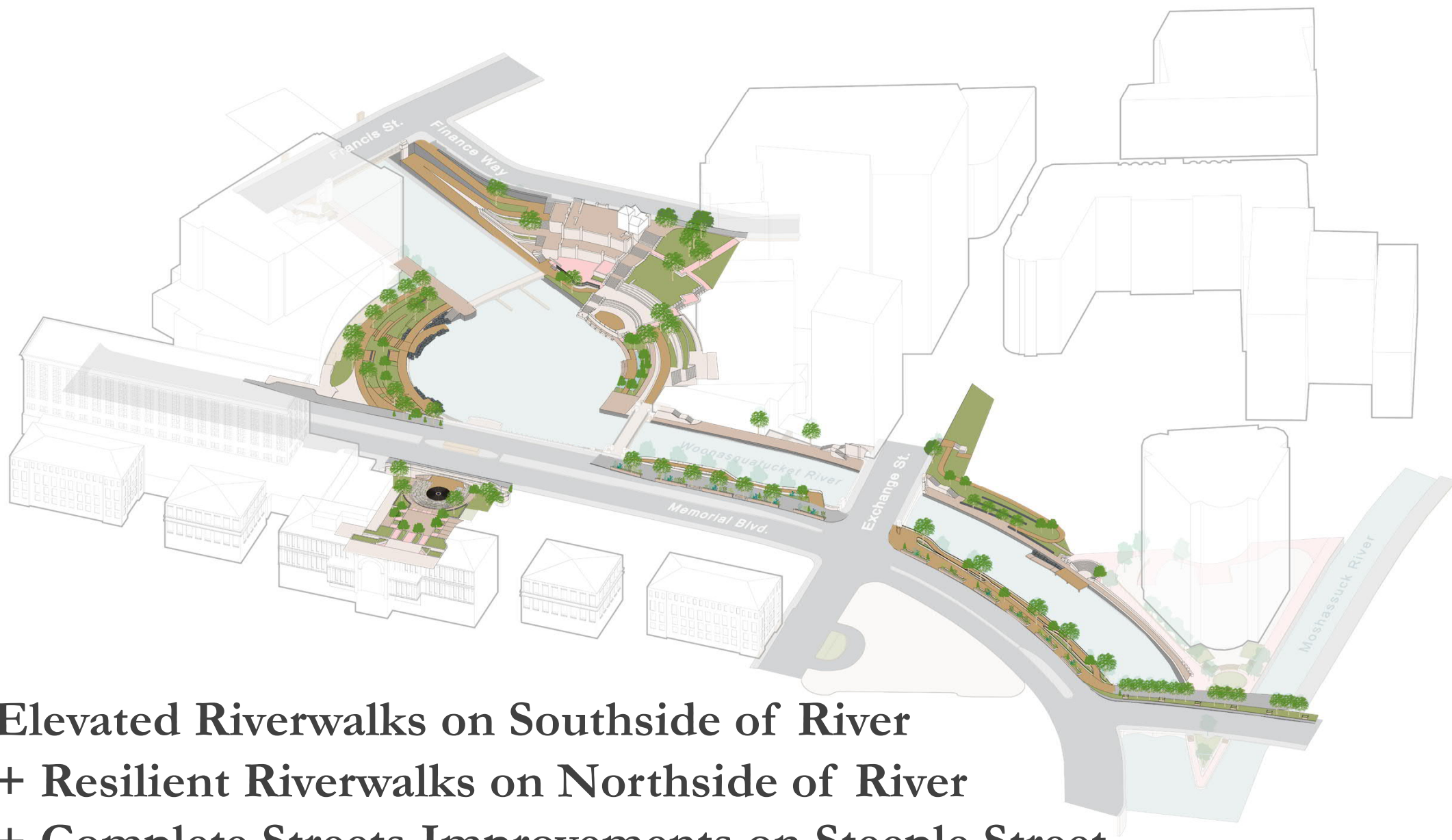

**Elevated Riverwalks on Southside of River**  
**+ Resilient Riverwalks on Northside of River**  
**+ Complete Streets Improvements on Steeple Street**



**Elevated Pedestrian Bridge  
+ Memorial Boulevard Crosswalk**



**Downtown Connector Accessible Walkway**



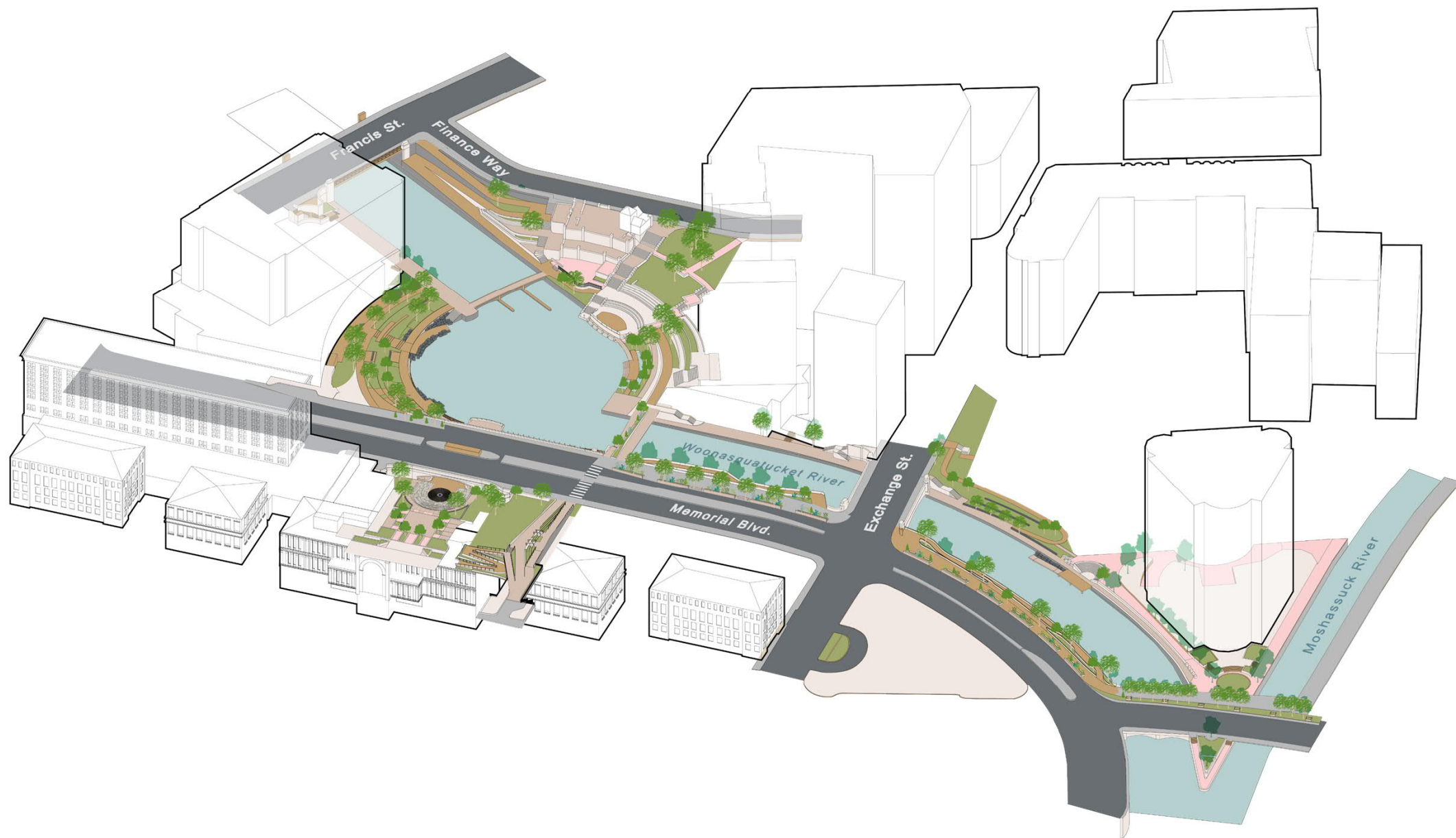

On September 24, 2024, a public meeting was held for the Riverwalk Resilience Project at 444 Westminster Street, with a hybrid format that saw approximately 35 attendees participating online and 20 in person. The engagement process provided community members an opportunity to learn about the Riverwalk Resilience Project, its goals, and potential impacts on the community.



# Project Overview: Scope and Bounds

## PRIORITIES FOR THE RIVERWALK

#1 PRESERVE & REHABILITATE WHAT PEOPLE LOVE

#2 PROVIDE CONNECTIVITY & ACCESSIBILITY

#3 EXPAND PLACEMAKING & PROGRAMMING

#4 CREATE ECOLOGICAL BENEFITS & RESILIENCY

#5 IMPROVE SAFETY AND INCREASE USE

“ I look forward to seeing more  
**resilient, ecological,** and  
**pleasant views** around the  
neighborhood. ”

## KEY THEMES



EDGE  
TREATMENT



ELEVATION +  
FLOODING



CONNECTIVITY  
+ SAFETY



MAINTENANCE  
+ MATERIALITY



ACTIVATION



# City of Providence Riverwalk Resilience



## General Inquiries:

Chris Martin, Principal Planner

[Crmartin@providenceri.gov](mailto:Crmartin@providenceri.gov)



ARUP