



Procurement #: 49489>

CITY OF PROVIDENCE, RHODE ISLAND

Department: Parks

RFP Title: Site Improvements at Ilola French Park

Opening Date: 06/16/2025

Addendum #: 1

Issue Date: 06/09/2025

The purpose of this addendum is:

see attached

Providence City Hall
25 Dorrance Street
Providence, RI 02903



WENDY NILSSON
Superintendent of Parks

BRETT P. SMILEY
Mayor

Addendum # 1
SITE IMPROVEMENTS AT IOLA FRENCH PARK
JUNE 9, 2025

Total Pages Including Cover (78 Pages)

Acknowledge Addenda on Bid Form

**** BID DUE DATE MONDAY, JUNE 16, 2025 AT 2:15PM ****

Attachments:

1. Addendum Cover Sheet (1 Page)
2. Grading/Utility Plan – Softball Field (L-3.1) revision (1 page)
3. Kompan MUGA product sheet (8 pages)
4. Approved Equal lighting vendor: Qualite Sports Lighting – lighting package (68 pages)

Questions/Clarifications:

1. Q: What are the footings for in Add/Alt #3
A: They are for the MUGA enclosure, cut-sheets have been attached for clarification
2. 2 potential options for providing electrical service to the lighting (and irrigation) systems have been suggested, see revisions to L-3.1 for info
3. Qualite Sports Lighting, LLC has been approved as an 'or equal' vendor for the lighting system, their lighting package is attached.

GRADING LEGEND

	EXISTING GRADE
	PROPOSED GRADE
	EXISTING CONTOUR
	PROPOSED CONTOUR
	PROPOSED SLOPE

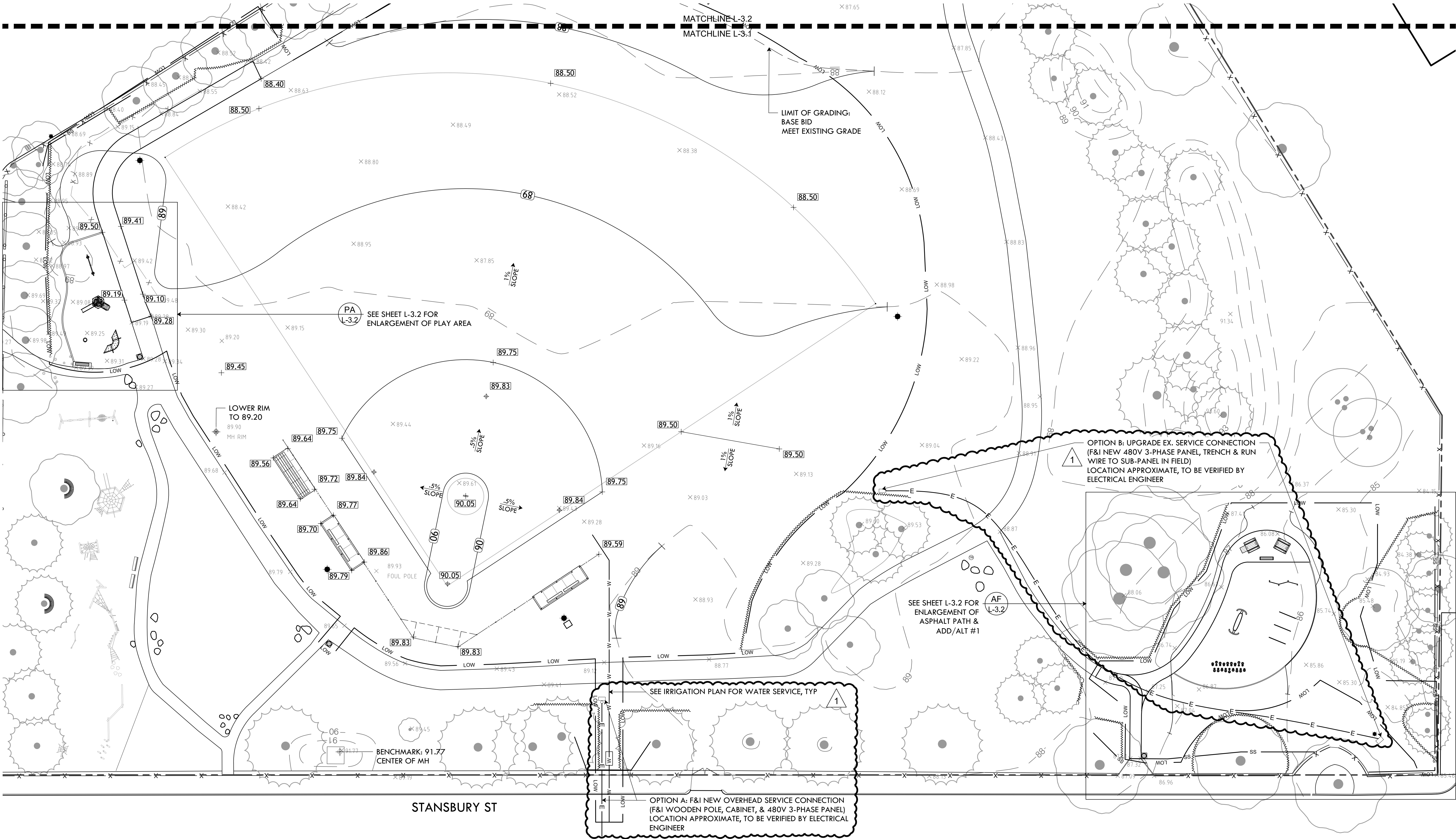

**PROVIDENCE
PARKS DEPARTMENT**
DAIRYMPLE BOATHOUSE
ROGER WILLIAMS PARK
PROVIDENCE, RI 02905



**Providence
Parks**

COPYRIGHT (C) CITY OF
PROVIDENCE PARKS
DEPARTMENT, ALL RIGHTS
RESERVED 2025.

NO PART OF THIS DOCUMENT MAY BE
REPRODUCED, STORED IN A RETRIEVAL
SYSTEM OR TRANSMITTED IN ANY FORM OR
BY ANY MEANS, ELECTRONIC,
MECHANICAL, PHOTOCOPYING,
RECORDING OR OTHERWISE WITHOUT THE
PRIOR WRITTEN PERMISSION OF THE CITY OF
PROVIDENCE PARKS DEPARTMENT. ANY
MODIFICATIONS TO THIS DOCUMENT
WITHOUT THE WRITTEN PERMISSION OF
THE CITY OF PROVIDENCE PARKS
DEPARTMENT SHALL RENDER IT INVALID
AND UNUSABLE.

STAMP

PROJECT:

**Site Improvements at
Iola French Park**

**221 Veazie Street
Providence, RI**

REVISIONS:

No.	Date	Description
1	6.9.25	Addendum 1

NORTH ARROW

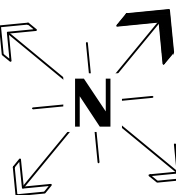

SCALE

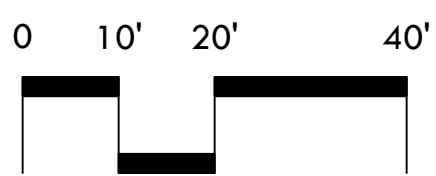

SCALE: 1"=20'

DRAWING INFO

DATE ISSUED: 5/19/25
PROJECT NO: IOLA.24.01
DRAWN BY: SH/SG
CHECKED BY: MG

SHEET TITLE

**Grading/Util. Plan
Softball Field**

L-3.1

3 OF 15

FILE: IOLA.24.01-PLANS.dwg

KOMPAN!
FRE6010

AneHab
2018-09-03

Colorline: Steel
Foundation: 90 Cm
Norm: EN
Units: cm / inch
Post Material: Steel

IN-GROUND

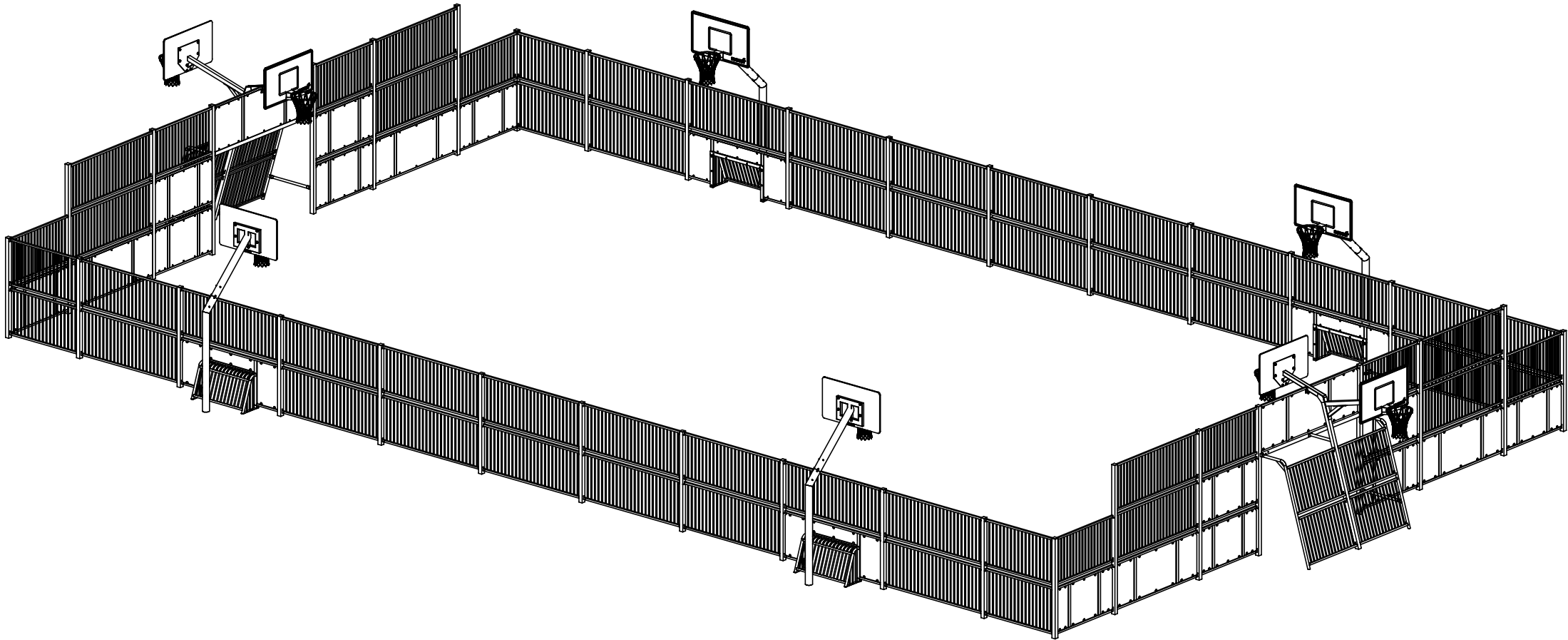

- 40x RE610103
- 8x RE628201
- 4x RE650101
- 2x RE626201
- 8x RE610402
- 16x RE610102
- 4x RE610403
- 4x RE610402
- 4x RE611003
- RE620102
- 2x RE620101
- 2x RE623201
- 4x RE628301
- 4x RE650301
- RE620402

KOMPAN!

FRE6010

AneHab
2018-09-03

SURFACE

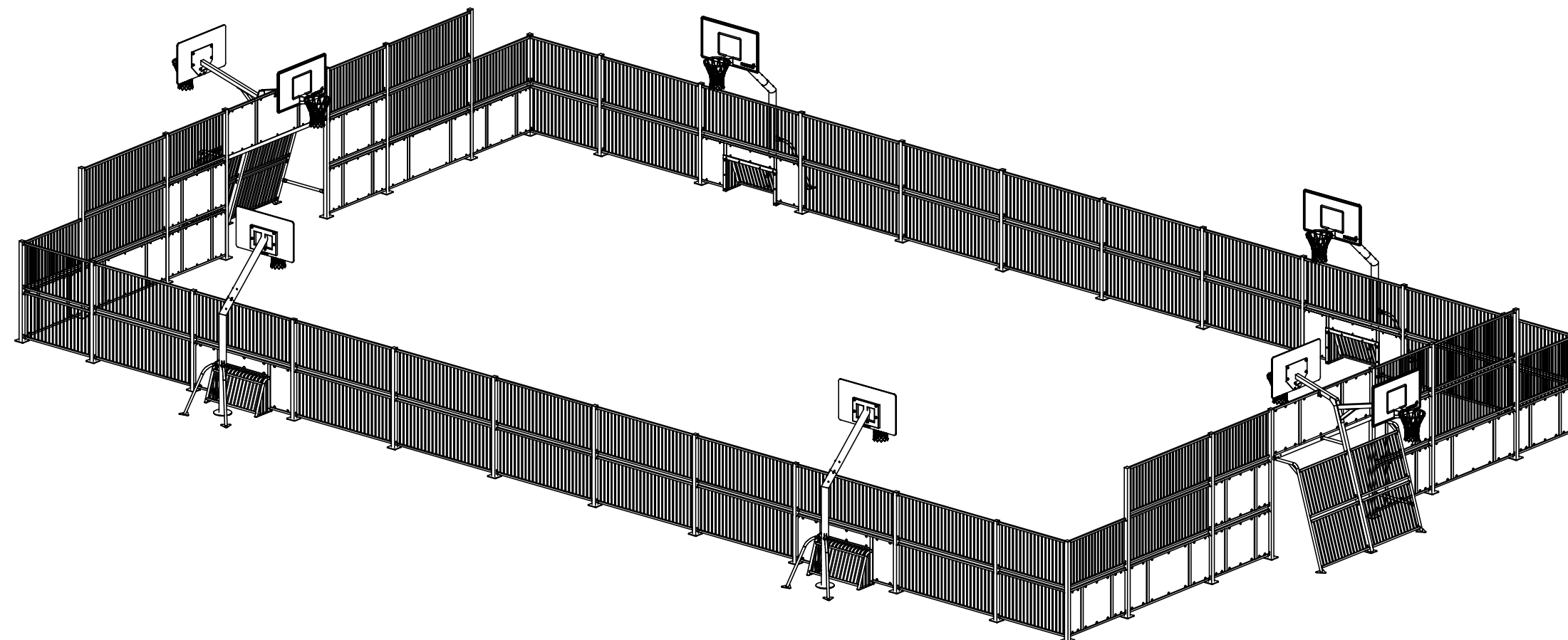

- RE620102
- 2x RE620101
- 2x RE623201
- 4x RE628301
- 4x RE650301
- RE620402

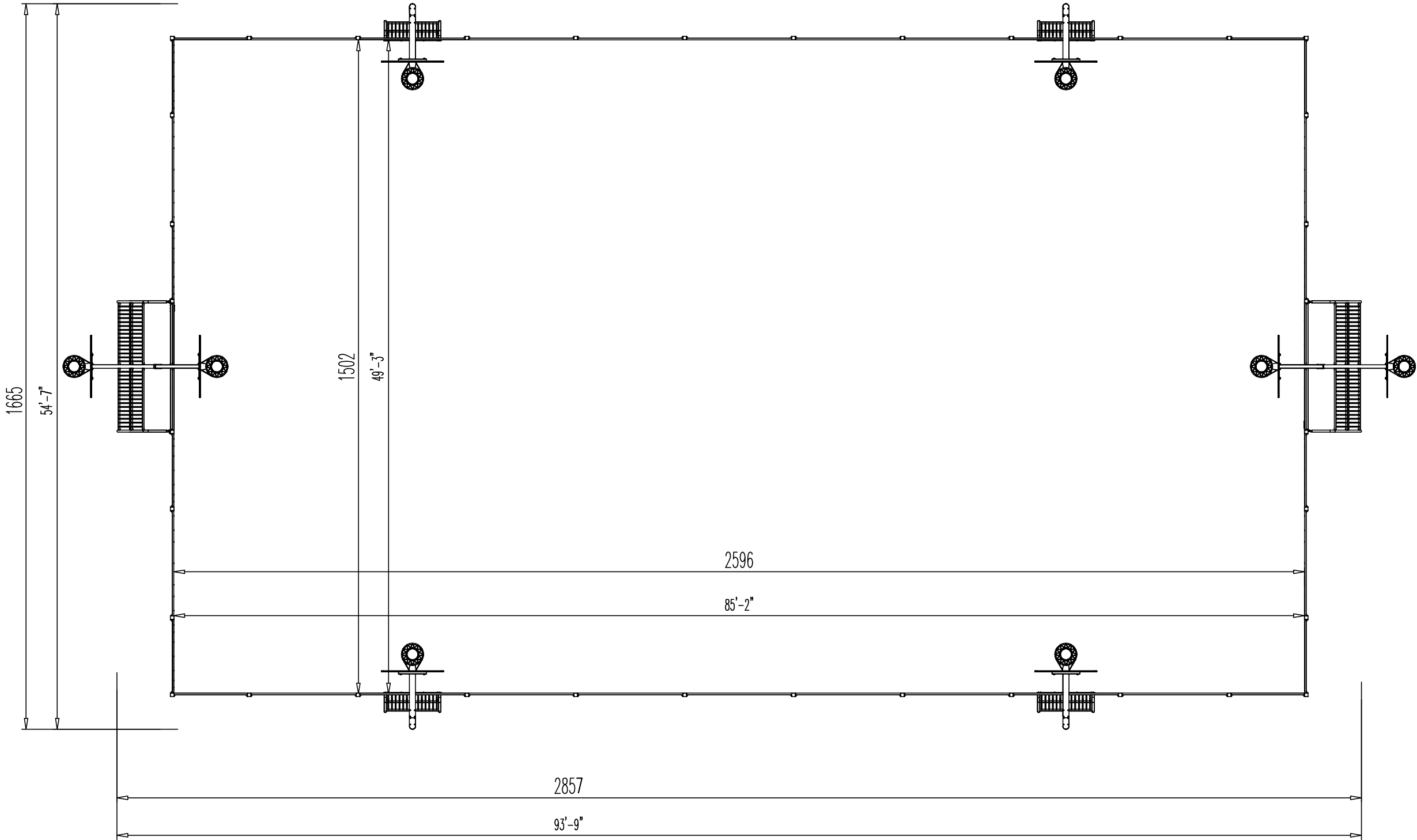
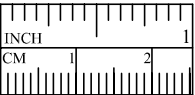

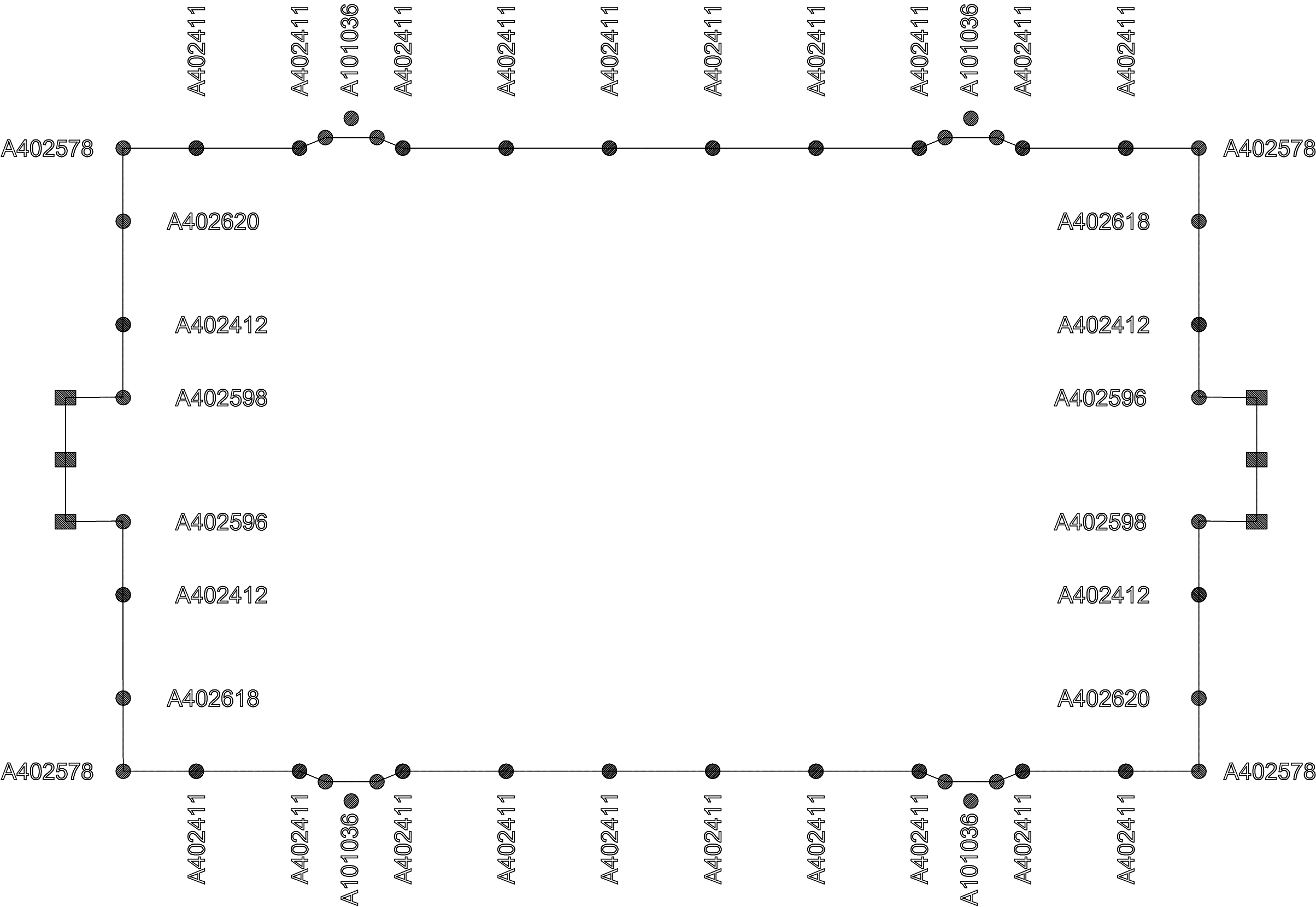

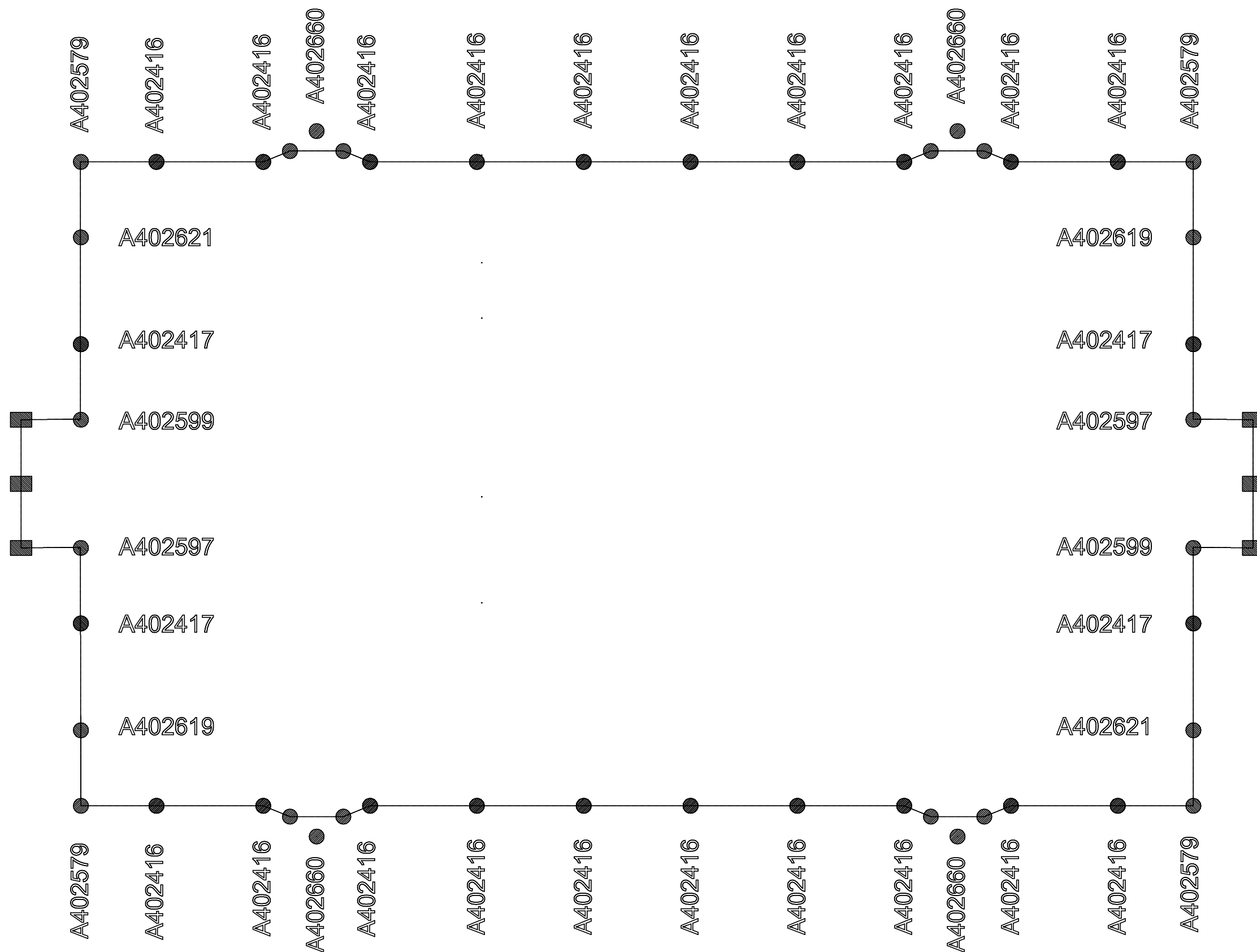

AneHab
2018-09-03

1:100

Beton
Beton
Concrete
Hormigón
Béton
Cemento
Beton
Betong

3.92 m³

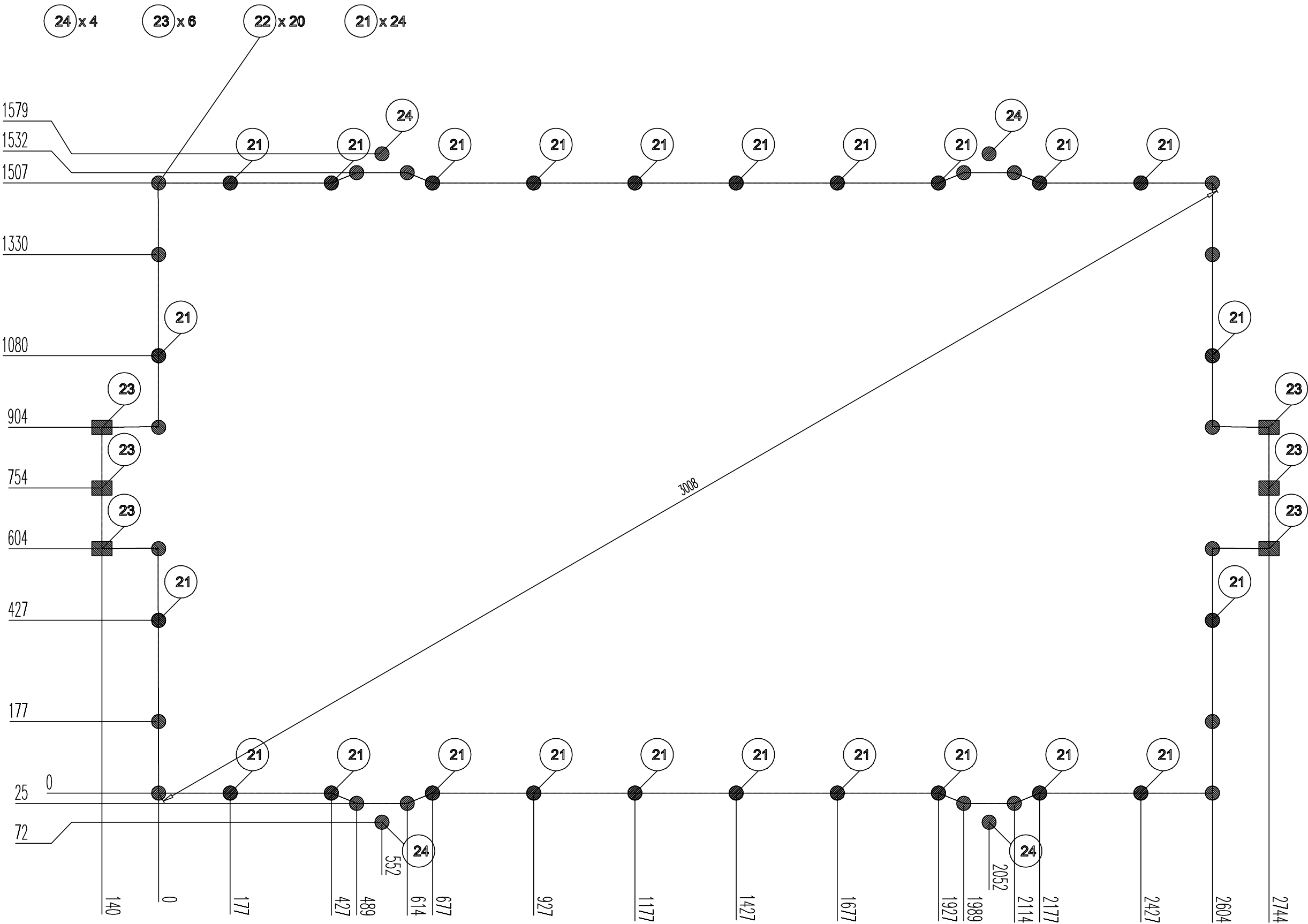

AneHab

2018-09-03

1:1/8"

Beton
Beton
Concrete
Hormigón
Béton
Cemento
Beton
Betong

138.40 cbf

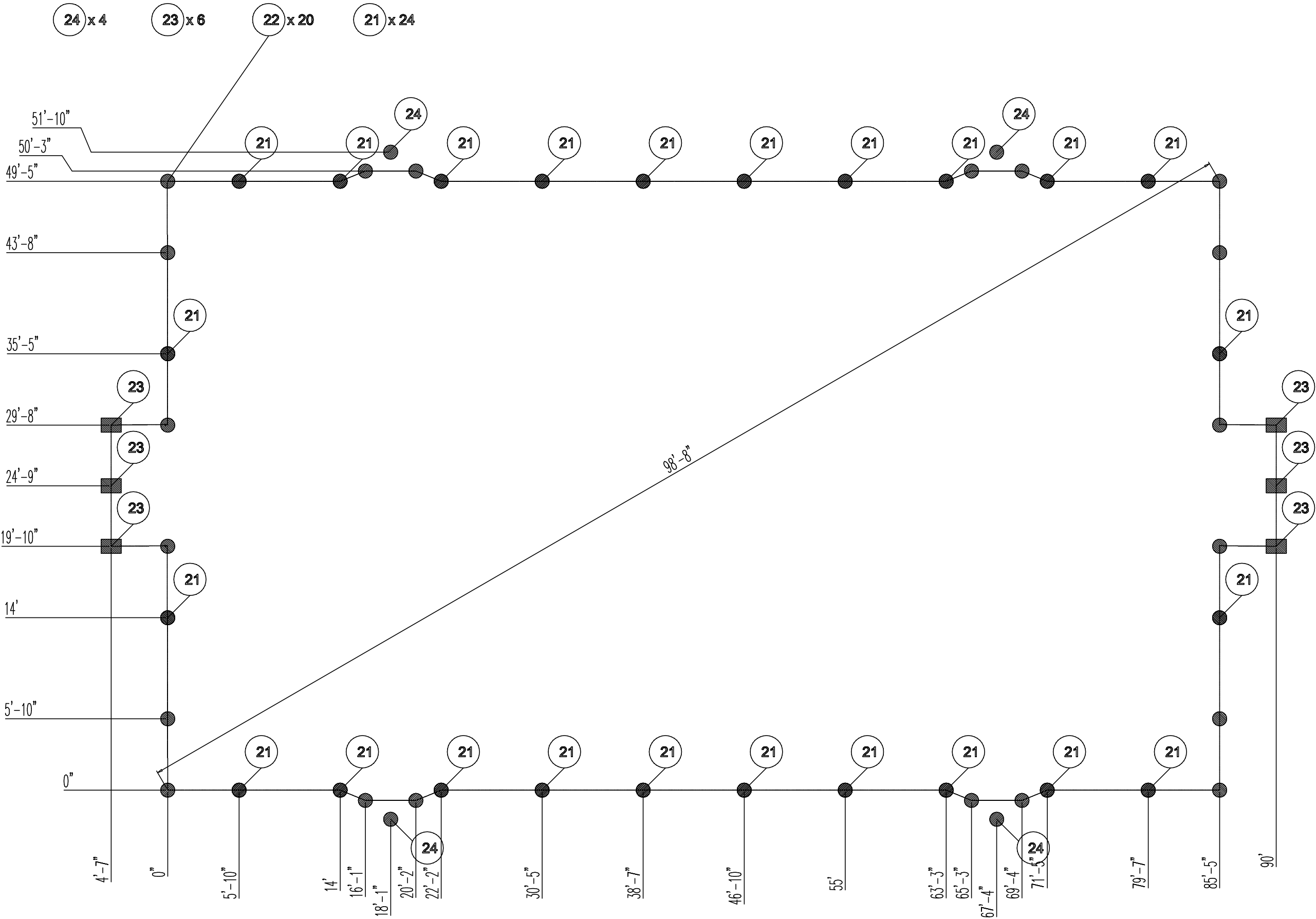

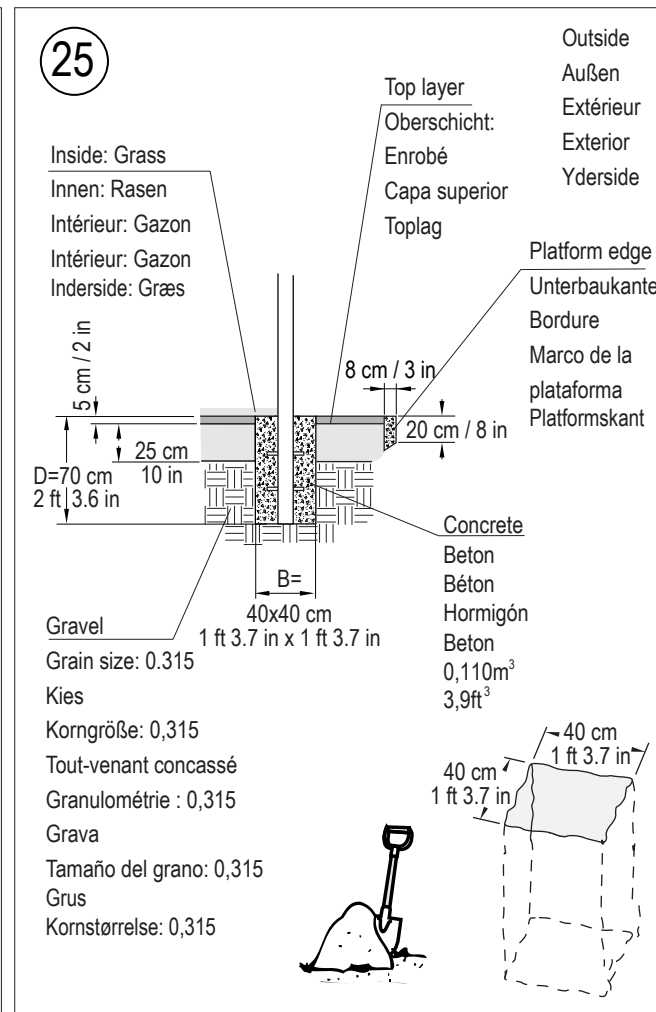
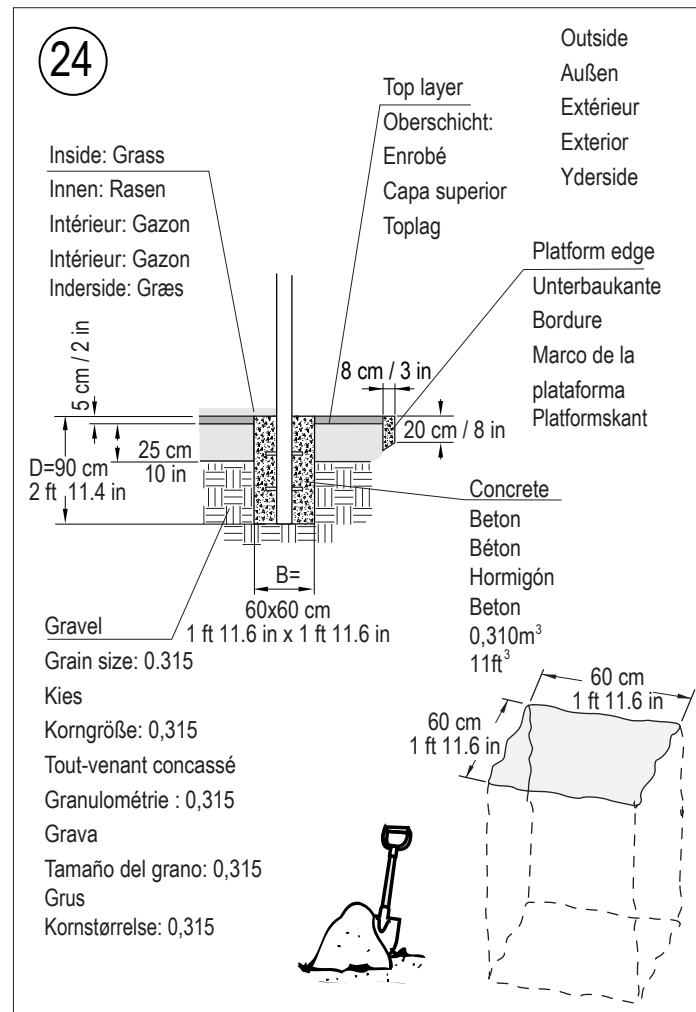
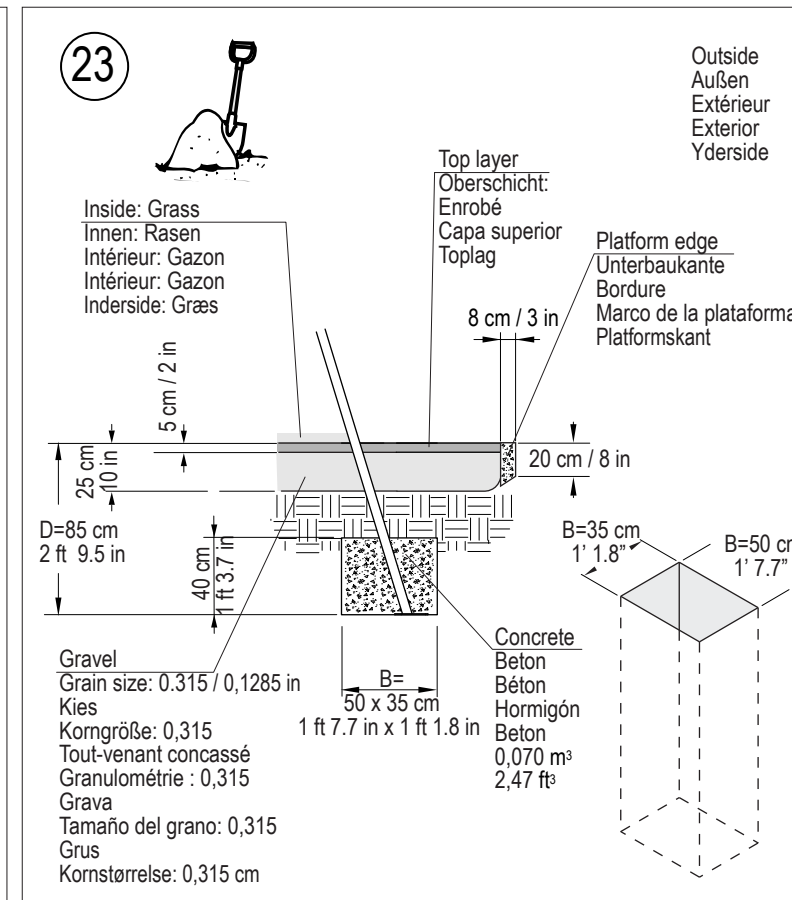
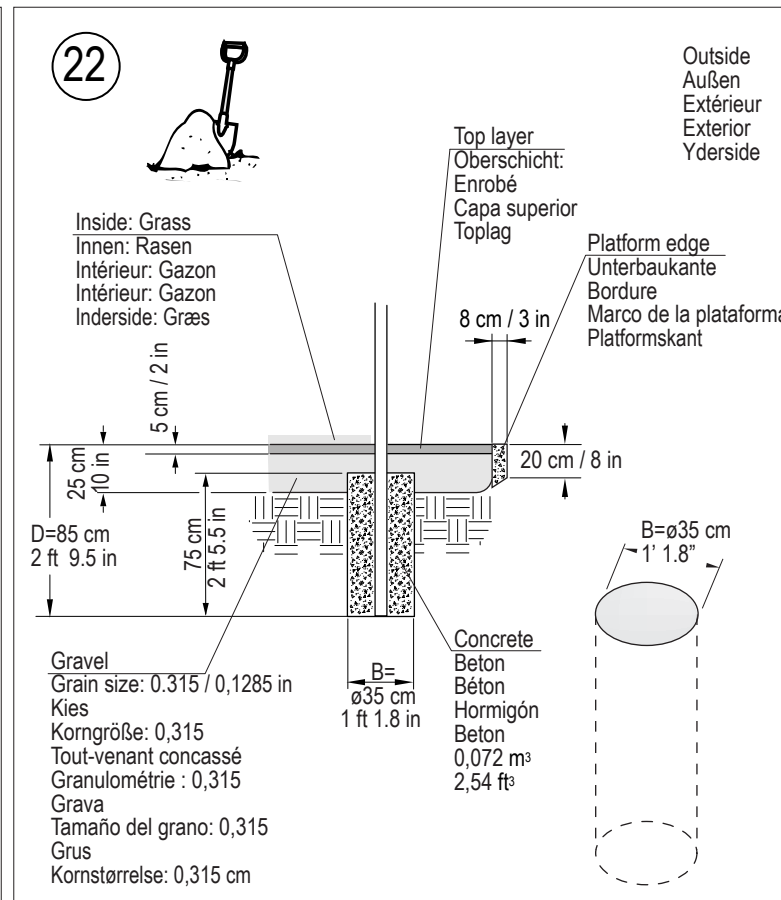
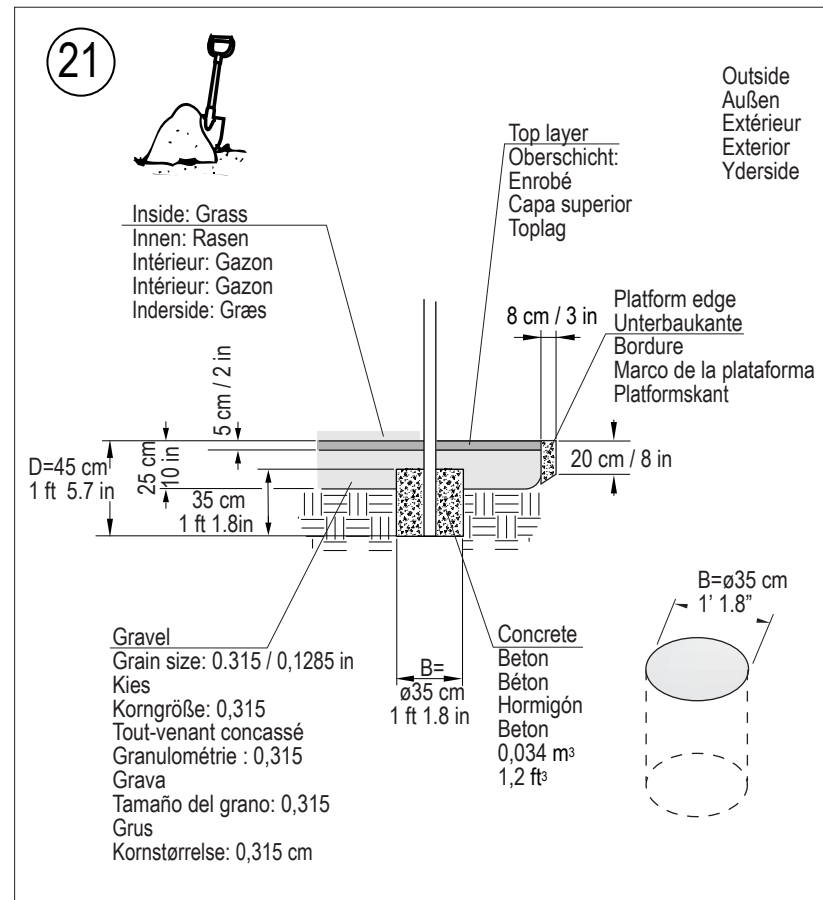

Important! The concrete must be sufficiently hardened before the play item may be used.

Wichtig! Vor der Inbetriebnahme des Spielerräts muß der Beton ausreichend abgebunden haben.

Important! Le béton doit avoir suffisamment durci avant de mettre en service l'équipement de jeux.

Importante! El hormigón debe estar suficientemente endurecido antes de comenzar a utilizar el equipo de juego.

Importante! Prima de utilizzare le attrezzature da gioco, il cemento deve essere sufficientemente solidificato.

Belangrijk! Het beton moet voldoende gehard zijn voordat het speeltoestel in gebruik wordt genomen.

Viktigt! Betongen måste ha hårdat tillräckligt innan lekredskapet börjar användas.

Viktigt! Betonen skal være tilstrækkeligt hærdet, før legeredskabet tages i brug.

Важно! Перед использованием сооружений убедитесь, что бетон затвердел.

HUOM! Betonivalun on oltava tarpeeksi kuiva, ennen kuin leikkivälinettä saa käyttää.

Qualite

SPORTS LIGHTING, LLC

June 5, 2025

PRE-BID SUBMITTAL

Iola French Park Softball Field Lighting Project #244443

Providence, Rhode Island

QL#23389

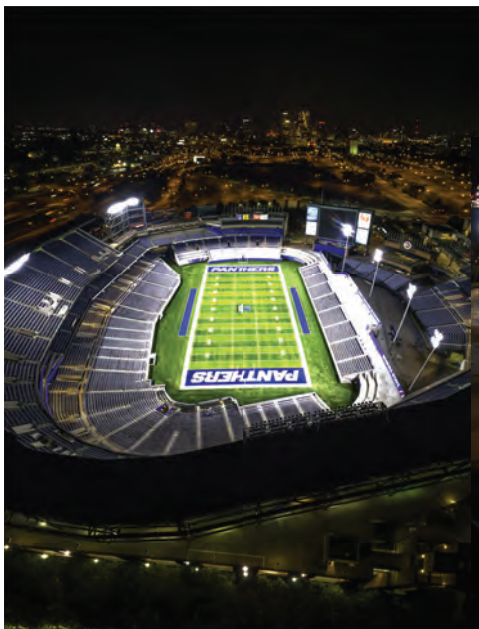



TABLE OF CONTENTS

**Iola French Park Softball
Field Lighting Project #244443
Providence, Rhode Island
QL#23389**

Letter Checklist	<u>A</u>
Equipment Layout On and Off Field Lighting Designs	<u>B</u>
Photometric Files	<u>C</u>
Performance Guarantee	<u>D</u>
Structural Calculations	<u>E</u>
Control & Monitoring	<u>F</u>
Electrical Distribution Plans	<u>G</u>
Warranty	<u>H</u>
Project References	<u>I</u>
Product Information	<u>J</u>
Delivery	<u>K</u>
Cost of Ownership	<u>L</u>
About Qualite	<u>M</u>

A

Letter | Checklist



June 5, 2025

To Whom It May Concern:

We are pleased to offer our information towards being approved as an equal manufacturer for the Iola French Park Softball Field Lighting Project #244443. Qualite Sports Lighting will manufacture and produce the materials for this project per the specification.

- 1.) Our warranty is the best in the business. We are the only company which provides a standard, all-inclusive, 25-year warranty.
- 2.) Qualite is a 40-year-old Sports Lighting company.
- 3.) Your new Qualite GameChanger System will include remote mounted driver cabinet, which includes as standard:
 - a.) Slide in/out drivers
 - b.) Incoming power scrubber
 - c.) Surge protection
 - d.) Fusing
 - e.) Circuit breakers
 - f.) Pole Disconnect
- 4.) Your new control system will be wireless remote. Once the project is installed, we will get your people access to the app which we will provide. We will then set up a training session for its use. It is very easy to work with. You will have the ability to add or subtract users whenever you would like.
- 5.) Your wireless controls will allow you to:
 - a.) Instant on/off
 - b.) Scheduling lights on/off
 - c.) If wanted, control each pole individually
 - d.) Dim lights from 10% to 100%
- 6.) Once a commitment is made with Qualite, we will prepare submittal package and make sure all questions are answered. Once you sign off on the package, we will schedule the install.

Thank you and please do not hesitate to contact us with any questions or comments.

We look forward to being approved as an equal lighting supplier for the Iola French Park Softball Field Lighting Project #244443.

A handwritten signature in black ink that reads "Renny Coe". The signature is written in a cursive, flowing style.

Renny Coe
Northeast Sales Manager
Qualite Sports Lighting, LLC.
517.914.6225 | rcoe@qualite.com

**REQUIRED SUBMITTAL INFORMATION FOR ALL MANUFACTURERS (NOT PRE-APPROVED) 10 DAYS
PRIOR TO BID**

*All items listed below are mandatory, shall comply with the specification and be submitted according to pre-bid submittal requirements. Complete the Yes/No column to indicate compliance (Y) or noncompliance (N) for each item. **Submit checklist below with submittal.***

Yes / No	Tab	Item	Description
yes	A	Letter/ Checklist	Listing of all information being submitted must be included on the table of contents. List the name of the manufacturer's local representative and his/her phone number. Signed submittal checklist to be included.
yes	B	Equipment Layout	Drawing(s) showing field layouts with pole locations
yes	C	On Field Lighting Design	Lighting design drawing(s) showing: <ul style="list-style-type: none"> a. Field Name, date, file number, prepared by b. Outline of field(s) being lighted, as well as pole locations referenced to the center of the field (x & y), Illuminance levels at grid spacing specified c. Pole height, number of fixtures per pole, horizontal and vertical aiming angles, as well as luminaire information including wattage, lumens and optics d. Height of light test meter above field surface. e. Summary table showing the number and spacing of grid points; average, minimum and maximum illuminance levels in foot candles (fc); uniformity including maximum to minimum ratio, coefficient of variance (CV), coefficient of utilization (CU) uniformity gradient; number of luminaires, total kilowatts, average tilt factor; light loss factor.
yes	D	Off Field Lighting Design	Lighting design drawing showing initial spill light levels along the boundary line (defined on bid drawings) in footcandles. Lighting design showing glare along the boundary line in candela. Light levels shall be taken at 30-foot intervals along the boundary line. Readings shall be taken with the meter orientation at both horizontal and aimed towards the most intense bank of lights.
yes	E	Photometric Report	Provide first page of photometric report for all luminaire types being proposed showing candela tabulations as defined by IESNA Publication LM-35-02. Photometric data shall be certified by laboratory with current National Voluntary Laboratory Accreditation Program or an independent testing facility with over 5 years experience.
yes	F	Performance Guarantee	Provide performance guarantee including a written commitment to undertake all corrections required to meet the performance requirements noted in these specifications at no expense to the owner. Light levels must be guaranteed to not fall below target levels for warranty period.
yes	G	Structural Calculations	Pole structural calculations and foundation design showing foundation shape, depth backfill requirements, rebar and anchor bolts (if required). Pole base reaction forces shall be shown on the foundation drawing along with soil bearing pressures. Design must be stamped by a structural engineer in the state of Rhode Island, if required by owner.
yes	H	Control & Monitoring System	Manufacturer of the control and monitoring system shall provide written definition and schematics for automated control system. They will also provide ten (10) references of customers currently using proposed system in the state of Rhode Island.
yes	I	Electrical Distribution Plans	Manufacturer bidding an alternate product must include a revised electrical distribution plan including changes to service entrance, panels and wire sizing, signed by a licensed Electrical Engineer in the state of Rhode Island.
yes	J	Warranty	Provide written warranty information including all terms and conditions. Provide ten (10) references of customers currently under specified warranty in the state of Rhode Island.
yes	K	Project References	Manufacturer to provide a list of ten (10) projects where the technology and specific fixture proposed for this project has been installed in the state of Rhode Island. Reference list will include project name, project city, installation date, and if requested, contact name and contact phone number.
yes	L	Product Information	Complete bill of material and current brochures/cut sheets for all products being provided.
yes	M	Delivery	Manufacturer shall supply an expected delivery timeframe from receipt of approved submittals and complete order information.

no	N	Non-Compliance	Manufacturer shall list all items that do not comply with the specifications. If in full compliance, tab may be omitted.
----	---	----------------	--

The information supplied herein shall be used for the purpose of complying with the specifications for French Park Softball. By signing below, I agree that all requirements of the specifications have been met and that the manufacturer will be responsible for any future costs incurred to bring their equipment into compliance for all items not meeting specifications and not listed in the Non-Compliance section.

Manufacturer: Qualite Sports Lighting LLC

Signature: Renny Coe

Contact Name: Renny Coe

Date: 6 / 5 / 2025

Contractor: _____

Signature: _____

B

Equipment Layout | On and Off Field Lighting Designs



THIS DESIGN WAS DONE IN ACCORDANCE WITH ILLUMINATING SOCIETY OF NORTH AMERICA STANDARDS RP-6-22

THIS INFORMATION IS CONFIDENTIAL AND PROPRIETARY TO QUALITE SPORTS LIGHTING LLC AND IS NOT TO BE REVEALED OR DISTRIBUTED TO OTHERS WITHOUT THE PERMISSION OF QUALITE SPORTS LIGHTING LLC. OR USED IN ANY MANNER DETRIMENTAL TO THE INTEREST OF QUALITE SPORTS LIGHTING LLC.

GUARANTEE IS BASED ON PROPER INSTALLATION, MINIMUM INPUT VOLTAGES, MOUNTING HEIGHT +/- 3 FEET, AND POLES PLACED WITHIN 4 FEET OF SPECIFIED LOCATIONS. POLES TO COMPLY WITH CURRENT AASHTO STANDARDS.

Qualite
SPORTS LIGHTING, LLC
WWW.QUALITE.COM

JOB NAME: **Iola French Park SB Lighting**

LOCATION: **Providence, RI**

REF# QL-23389

REV: D1-A

DESIGNER: PDR

DATE: 6/6/2025

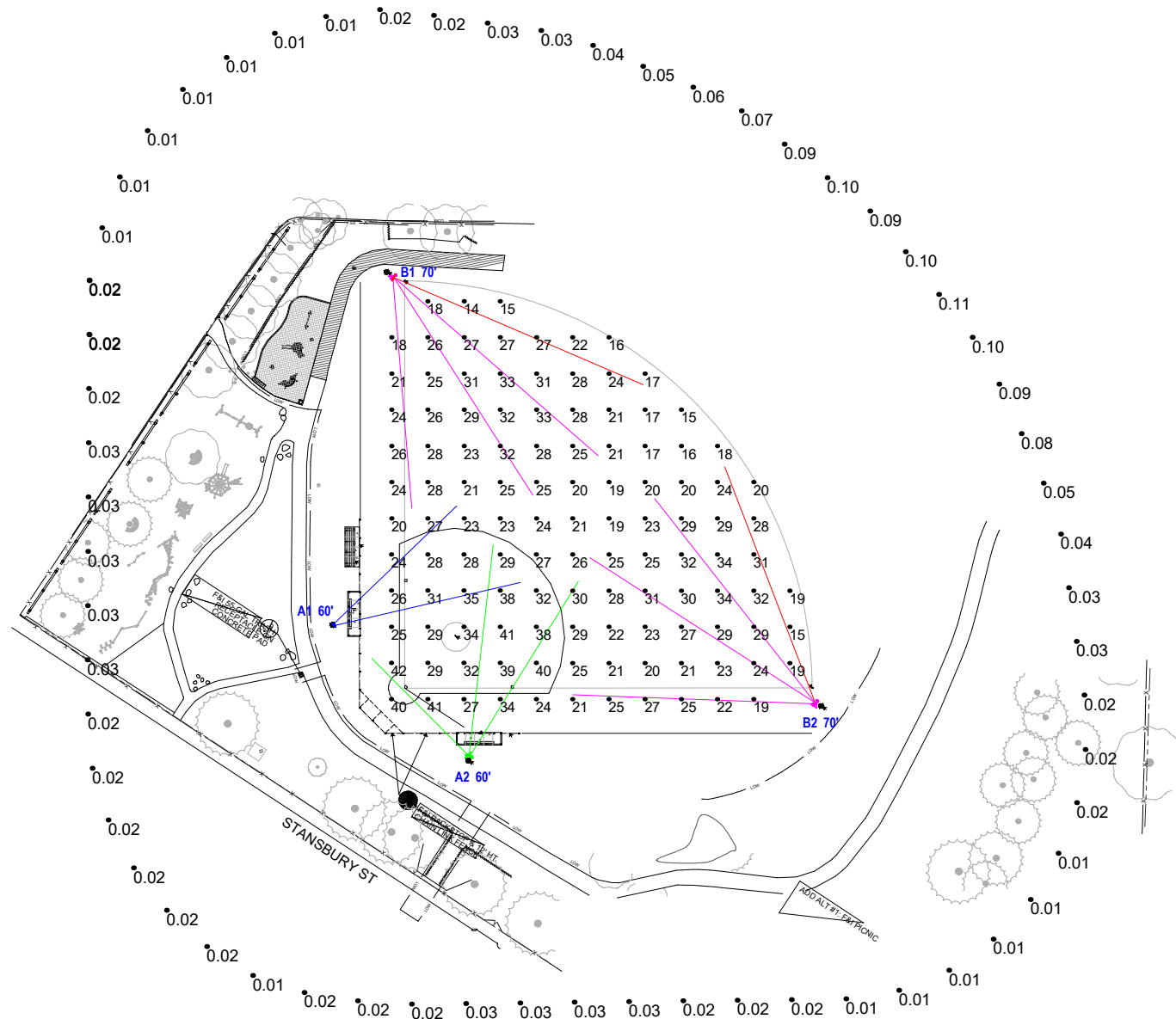

THIS DESIGN WAS DONE IN ACCORDANCE WITH ILLUMINATING SOCIETY OF NORTH AMERICA STANDARDS RP-6-22

THIS INFORMATION IS CONFIDENTIAL AND PROPRIETARY TO QUALITE SPORTS LIGHTING LLC AND IS NOT TO BE REVEALED OR DISTRIBUTED TO OTHERS WITHOUT THE PERMISSION OF QUALITE SPORTS LIGHTING LLC. OR USED IN ANY MANNER DETRIMENTAL TO THE INTEREST OF QUALITE SPORTS LIGHTING LLC.

GUARANTEE IS BASED ON PROPER INSTALLATION, MINIMUM INPUT VOLTAGES, MOUNTING HEIGHT +/- 3 FEET, AND POLES PLACED WITHIN 4 FEET OF SPECIFIED LOCATIONS. POLES TO COMPLY WITH CURRENT AASHTO STANDARDS.

Qualite
SPORTS LIGHTING, LLC
WWW.QUALITE.COM

JOB NAME: **Iola French Park SB Lighting**

LOCATION: **Providence, RI**

REF# QL-23389

REV: D1-A

DESIGNER: PDR

DATE: 6/6/2025

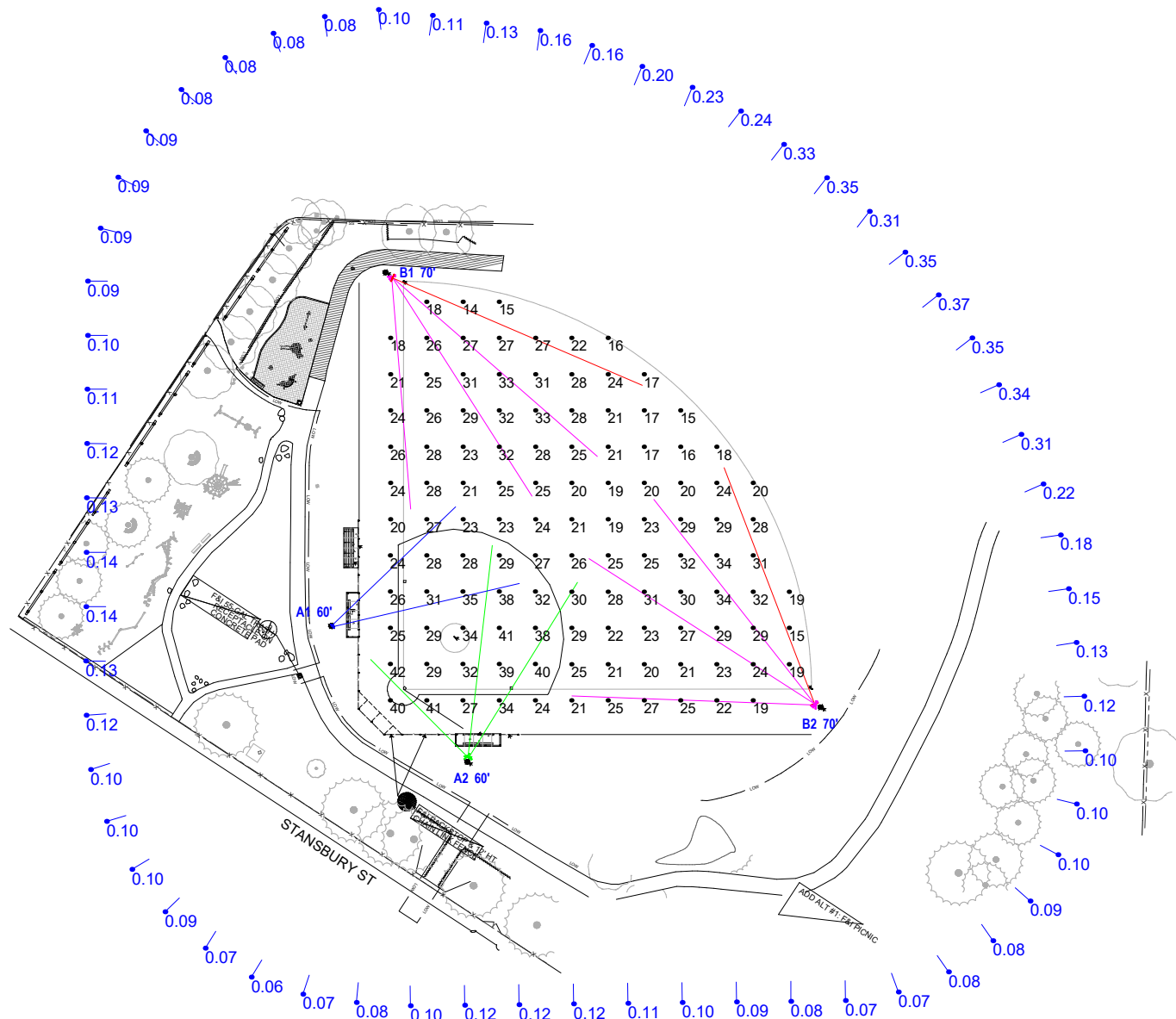

THIS DESIGN WAS DONE IN ACCORDANCE WITH ILLUMINATING SOCIETY OF NORTH AMERICA STANDARDS RP-6-22

THIS INFORMATION IS CONFIDENTIAL AND PROPRIETARY TO QUALITE SPORTS LIGHTING LLC AND IS NOT TO BE REVEALED OR DISTRIBUTED TO OTHERS WITHOUT THE PERMISSION OF QUALITE SPORTS LIGHTING LLC. OR USED IN ANY MANNER DETRIMENTAL TO THE INTEREST OF QUALITE SPORTS LIGHTING LLC.

GUARANTEE IS BASED ON PROPER INSTALLATION, MINIMUM INPUT VOLTAGES, MOUNTING HEIGHT +/- 3 FEET, AND POLES PLACED WITHIN 4 FEET OF SPECIFIED LOCATIONS. POLES TO COMPLY WITH CURRENT AASHTO STANDARDS.

Qualite
SPORTS LIGHTING, LLC
WWW.QUALITE.COM

JOB NAME: **Iola French Park SB Lighting**

LOCATION: **Providence, RI**

REF# QL-23389

REV: D1-A

DESIGNER: PDR

DATE: 6/6/2025

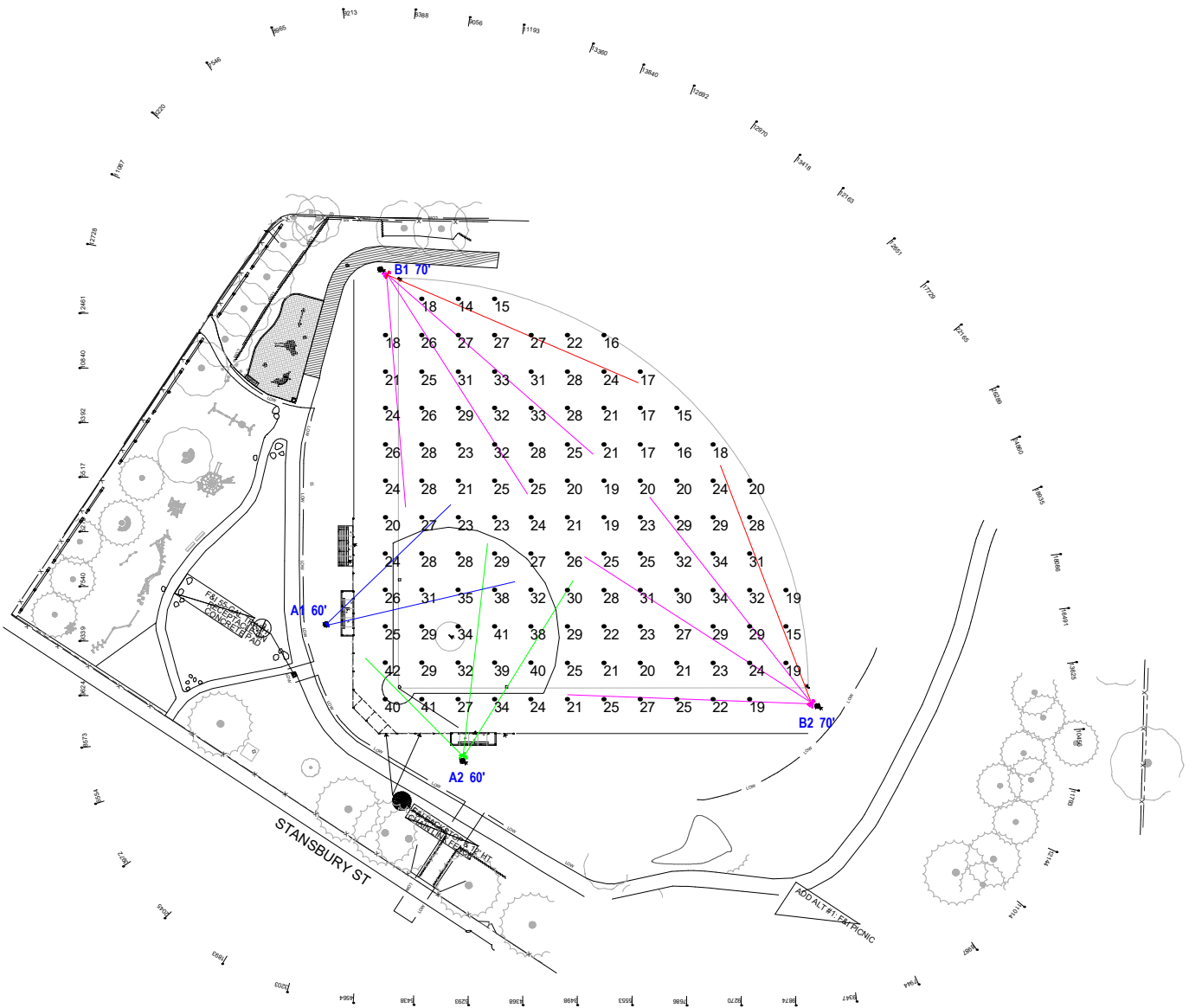

THIS DESIGN WAS DONE IN ACCORDANCE WITH ILLUMINATING SOCIETY OF NORTH AMERICA STANDARDS RP-6-22

THIS INFORMATION IS CONFIDENTIAL AND PROPRIETARY TO QUALITE SPORTS LIGHTING LLC AND IS NOT TO BE REVEALED OR DISTRIBUTED TO OTHERS WITHOUT THE PERMISSION OF QUALITE SPORTS LIGHTING LLC. OR USED IN ANY MANNER DETRIMENTAL TO THE INTEREST OF QUALITE SPORTS LIGHTING LLC.

GUARANTEE IS BASED ON PROPER INSTALLATION, MINIMUM INPUT VOLTAGES, MOUNTING HEIGHT +/- 3 FEET, AND POLES PLACED WITHIN 4 FEET OF SPECIFIED LOCATIONS. POLES TO COMPLY WITH CURRENT AASHTO STANDARDS.



JOB NAME: Iola French Park SB Lighting

LOCATION: Providence, RI

REF# QL-23389

DESIGNER: PDR

REV: D1-A

DATE: 6/6/2025

Calculation Summary

Label	Units	Avg	Max	Min	Max/Min	CV	UG	# Pts	Pt Spacing
INFIELD	Fc	32.5	42	24	1.75	0.18	1.68	25	20 X 20
OUTFIELD	Fc	24.3	34	14	2.43	0.20	1.93	92	20 X 20
HORIZONTAL	Fc	0.030	0.11	0.01	11.0	N.A.	N.A.	63	30 X 30
VERTICAL	Fc	0.140	0.37	0.06	6.17	N.A.	N.A.	61	30 X 30

NEW POLES - POLE LOCATIONS BASED ON BID DOCUMENT**TOTAL PROJECT: Luminaire Schedule**

Symbol	Qty	Description	Tag	Luminaire Watts	Total Watts
	2	GC 1200 N2244V-29	GEN 4 LARGE VISORED	1165	2330
	6	GC 1200 N4WV-29	GEN 4 LARGE VISORED	1160	6960
	3	GC 1200 N5V-33	GEN 4 LARGE VISORED	1160	3480
	2	GC 600 N6V-29	GEN4 SMALL VISORED	580	1160

TOTAL 13**Luminaire Schedule****Project: A1 60' 2 LIGHTS ON 2F STANCHION**

Symbol	Qty	Description	Tag	Luminaire Watts	Total Watts
	2	GC 600 N6V-29	GEN4 SMALL VISORED	580	1160



Luminaire Schedule**Project: A2 60' 3 LIGHTS ON 4F STANCHION**

Symbol	Qty	Description	Tag	Luminaire Watts	Total Watts
	3	GC 1200 N5V-33	GEN 4 LARGE VISORED	1160	3480



KW PER POLE

Label	KW
A1	1.160
A2	3.480
B1	4.645
B2	4.645
TOTAL	13.930

Luminaire Schedule**Project: B1 70' 4 LIGHTS ON 4F STANCHION**

Symbol	Qty	Description	Tag	Luminaire Watts	Total Watts
	1	GC 1200 N2244V-29	GEN 4 LARGE VISORED	1165	1165
	3	GC 1200 N4WV-29	GEN 4 LARGE VISORED	1160	3480

Luminaire Schedule**Project: B2 70' 4 LIGHTS ON 4F STANCHION**

Symbol	Qty	Description	Tag	Luminaire Watts	Total Watts
	1	GC 1200 N2244V-29	GEN 4 LARGE VISORED	1165	1165
	3	GC 1200 N4WV-29	GEN 4 LARGE VISORED	1160	3480

THIS DESIGN WAS DONE IN ACCORDANCE WITH ILLUMINATING SOCIETY OF NORTH AMERICA STANDARDS RP-6-22

THIS INFORMATION IS CONFIDENTIAL AND PROPRIETARY TO QUALITE SPORTS LIGHTING LLC AND IS NOT TO BE REVEALED OR DISTRIBUTED TO OTHERS WITHOUT THE PERMISSION OF QUALITE SPORTS LIGHTING LLC. OR USED IN ANY MANNER DETRIMENTAL TO THE INTEREST OF QUALITE SPORTS LIGHTING LLC.

GUARANTEE IS BASED ON PROPER INSTALLATION, MINIMUM INPUT VOLTAGES, MOUNTING HEIGHT +/- 3 FEET, AND POLES PLACED WITHIN 4 FEET OF SPECIFIED LOCATIONS. POLES TO COMPLY WITH CURRENT AASHTO STANDARDS.

SPORTS LIGHTING, LLC
WWW.QUALITE.COM

JOB NAME: **Iola French Park SB Lighting**LOCATION: **Providence, RI**

REF# QL-23389

REV: D1-A

DESIGNER: PDR

DATE: 6/6/2025

C

Photometric Files

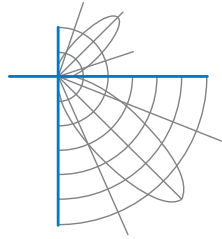

Report of Test

LLIA002129-008

Catalog Number: N5-2.9-V

Aluminum housing and heatsink fins, two molded plastic lens frames.

Formed matte black steel visor with specular hammertone aluminum visor.

198 white LEDs with silicone optics in front of each. Aimed approximately 30 degrees below horizon.

Two Inventronics ESM-680S350MT LED drivers labeled as 2905mA each

479.9Vac, 60.00Hz, 2.519A, 1167.0W, 0.965PF, 6.7%THD(i)

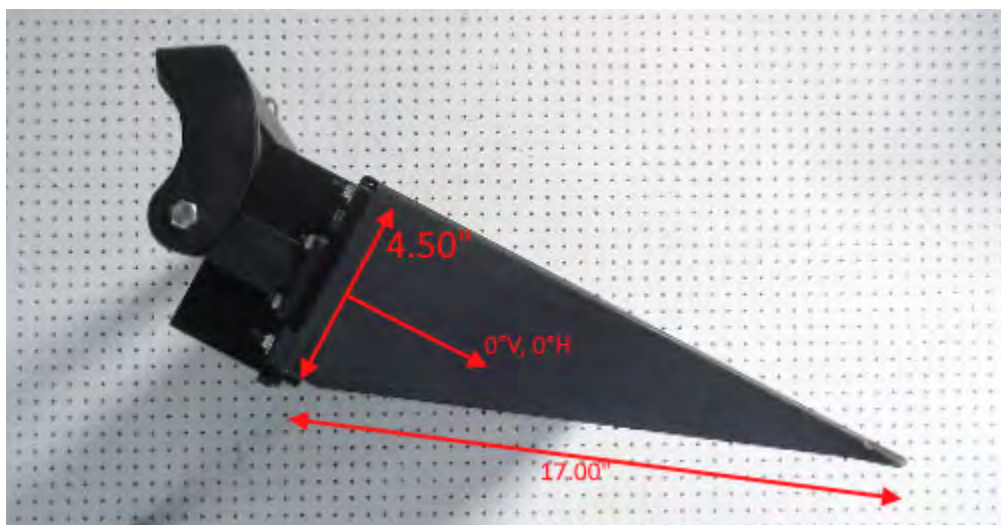

Performance Summary

Total Light Output	121864	lm	Illuminance at 10m	4768.0 lux
Luminaire Power	1167.0	W	Beam Distance	1381.0 Meters (to 0.25 lux)
Luminous Efficacy	104.4	lm/W		
Beam Spread (50%)	22.3° V x 28.9° H		Maximum Intensity	476800.0 cd
Field Spread (10%)	49.2° V x 61.4° H			
NEMA Type	4H x 4V			

PREPARED FOR : Qualite Sports Lighting, 215 West Mechanic St, Hillsdale, MI 49242, USA

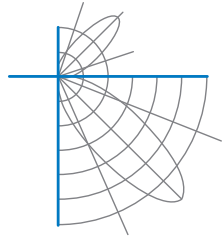

Report of Test

LLIA002129-010

Catalog Number: N4W-2.9-V

Aluminum housing and heatsink fins, two molded plastic lens frames.

Formed matte black steel visor with specular hammertone aluminum visor.

198 white LEDs with silicone optics in front of each. Aimed approximately 30 degrees below horizon.

Two Inventronics ESM-680S350MT LED drivers labeled as 2905mA each

480.0Vac, 60.00Hz, 2.516A, 1164.5W, 0.965PF, 6.9%THD(i)

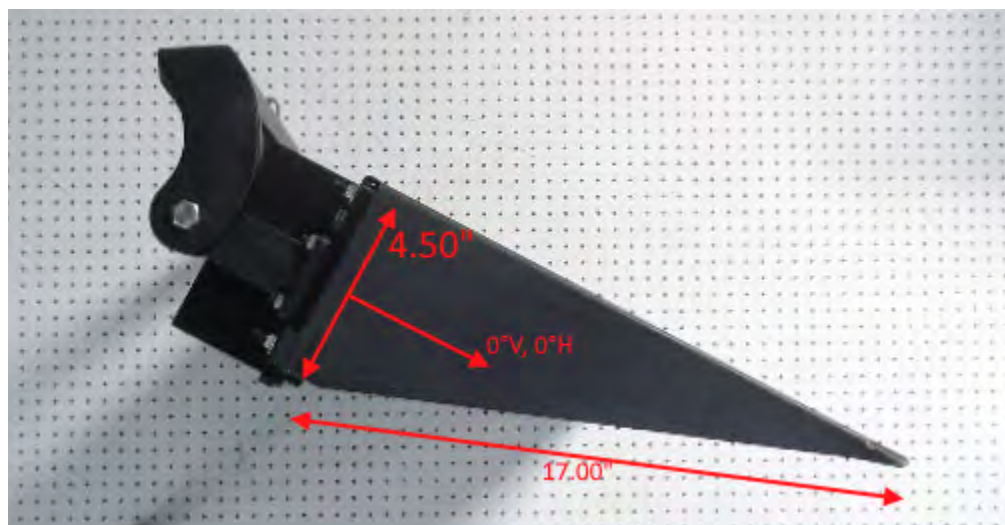

Performance Summary

Total Light Output	123546	lm	Illuminance at 10m	7543.0 lux
Luminaire Power	1164.5	W	Beam Distance	1737.0 Meters (to 0.25 lux)
Luminous Efficacy	106.1	lm/W		
Beam Spread (50%)	16.4° V x 16.9° H		Maximum Intensity	754300.0 cd
Field Spread (10%)	44.9° V x 40.4° H			
NEMA Type	3H x 3V			

PREPARED FOR : Qualite Sports Lighting, 215 West Mechanic St, Hillsdale, MI 49242, USA

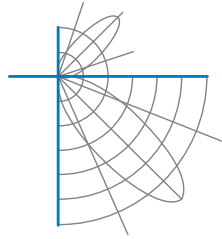

Report of Test

LLIA002129-006

Catalog Number: N2-2.9-V

Aluminum housing and heatsink fins, two molded plastic lens frames.

Formed matte black steel visor with specular hammertone aluminum visor.

198 white LEDs with silicone optics in front of each. Aimed approximately 30 degrees below horizon.

Two Inventronics ESM-680S350MT LED drivers labeled as 2905mA each

479.8Vac, 60.00Hz, 2.512A, 1163.0W, 0.965PF, 6.7%THD(i)

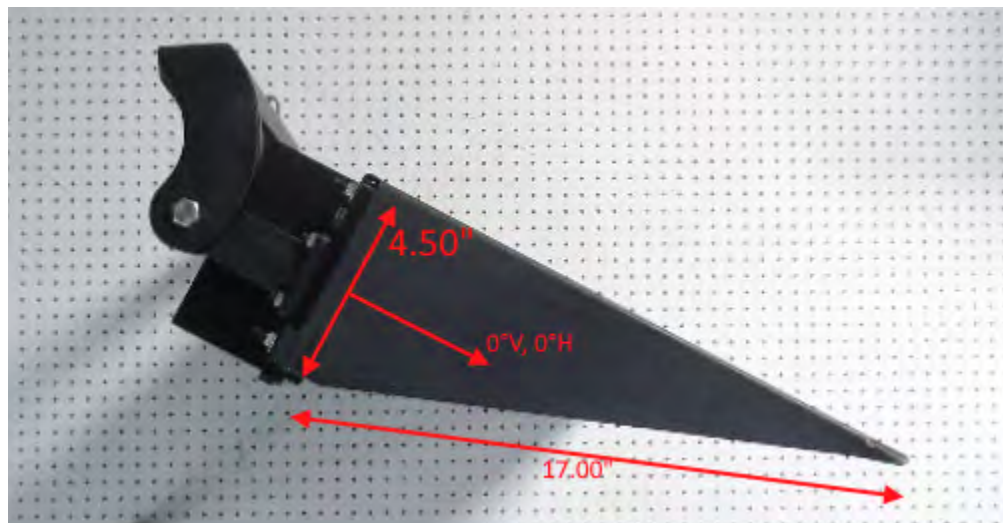

Performance Summary

Total Light Output	129984	lm	Illuminance at 10m	10240.0 lux
Luminaire Power	1163.0	W	Beam Distance	2023.9 Meters (to 0.25 lux)
Luminous Efficacy	111.8	lm/W		
Beam Spread (50%)	15.7° V x 17.3° H		Maximum Intensity	1024000 cd
Field Spread (10%)	34.3° V x 37.3° H			
NEMA Type	3H x 3V			

PREPARED FOR : Qualite Sports Lighting, 215 West Mechanic St, Hillsdale, MI 49242, USA

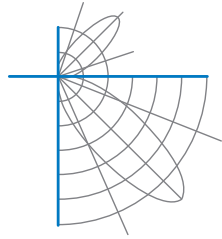

Report of Test

LLIA002129-007

Catalog Number: N4-2.9-V

Aluminum housing and heatsink fins, two molded plastic lens frames.

Formed matte black steel visor with specular hammertone aluminum visor.

198 white LEDs with silicone optics in front of each. Aimed approximately 30 degrees below horizon.

Two Inventronics ESM-680S350MT LED drivers labeled as 2905mA each

480.0Vac, 60.00Hz, 2.511A, 1163.0W, 0.965PF, 6.8%THD(i)

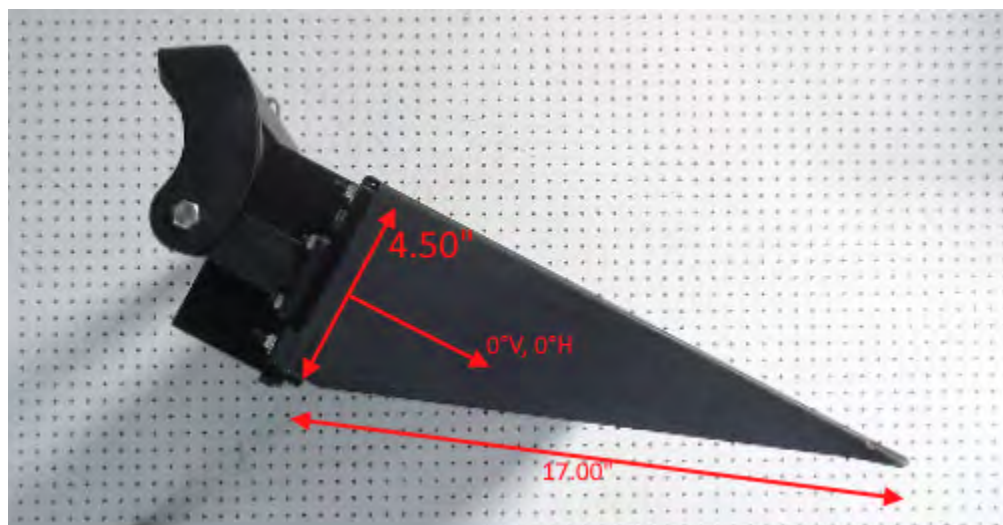

Performance Summary

Total Light Output	122409	lm	Illuminance at 10m	7445.0 lux
Luminaire Power	1162.9	W	Beam Distance	1725.7 Meters (to 0.25 lux)
Luminous Efficacy	105.3	lm/W		
Beam Spread (50%)	16.6° V x 19.3° H		Maximum Intensity	744498.6 cd
Field Spread (10%)	39.0° V x 44.5° H			
NEMA Type	4H x 3V			

PREPARED FOR : Qualite Sports Lighting, 215 West Mechanic St, Hillsdale, MI 49242, USA

D

**Performance
Guarantee**



QUALITE PERFORMANCE GUARANTEE

First of all, we would like to thank you for choosing Qualite Sports Lighting for your lighting project.

We are pleased to offer our Edison Award-winning QLED GameChanger™ Sports Lighting System to light your project. Our new LED system uses state-of-the-art technology, is completely manufactured in the United States, and adheres to the high quality standard that Qualite has built its reputation on.

The enclosed layout(s) indicate the guaranteed maximum Kilowatt consumption.

Qualite also guarantees the light levels and uniformities as specified; or per IESNA recommendations, if a performance specification was not provided.

As a pre-aimed, pre-wired system, our guarantee requires proper input voltage and installation. We understand that sometimes unforeseen conditions can dictate layout changes, during installation and we guarantee to react and assist as quickly as possible to help ensure great results for the end user.

This guarantee must exclude mounting to wooden poles; due to their tendency to twist and change the aiming.

Sincerely,

The Qualite Sports Lighting Team

E

Structural Calculations

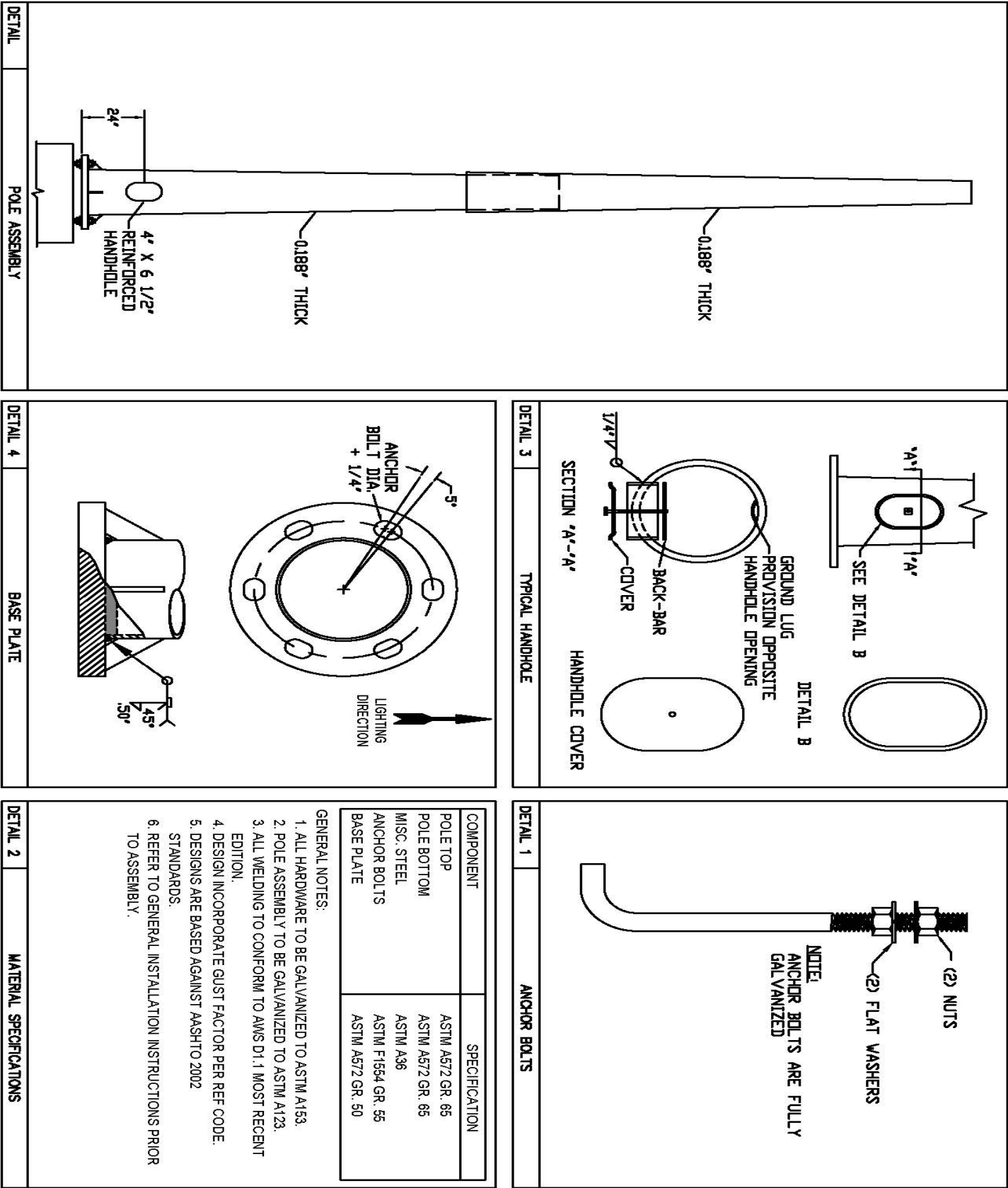

F

Control & Monitoring System



The Controller is the basic building block of the Lightcloud system. Use it for switching and 0-10V dimming. Deploy it for power management. Or simply use it to extend the range of your Lightcloud mesh network.

Color: Black

Weight: 0.4 lbs

RAB | Controls
In partnership with
Qualite
SPORTS LIGHTING, LLC

Technical Specifications

Listings

Compliance

UL Listing:

Suitable for indoor and outdoor use. Suitable for wet and damp locations.

Plenum Rated

IP Rating:

Ingress protection rating of IP66 for dust and water

DLC Listed:

This product is on the Design Lights Consortium (DLC) Qualified Products List and is eligible for rebates from DLC Member Utilities

Electrical

Installation:

All Light cloud components should be installed by a licensed electrician in accordance with local codes.

Input Voltage:

120-277 VAC, 50/60 HZ
<2W (standby- 4W Active)

Frequencies:

50/60 Hz

Current Draw:

30 mA @ 120VAC
20 mA @ 277VAC

Load Switching Capacity:

For Control of Magnetic, Electronic Ballast or LED
277VAC: 20A Magnetic/Resistive
240VAC: 5A Tungsten/Electronic, 20A FLA/60 LRA,
2HP
120VAC: 15A Tungsten/Electronic, 1HP

Operating Temperature Range:

-40°C to 40°C

Storage Temperature Range:

-40°C to 80°C

Construction

Overall Dimensions:

1.55" diameter, 5.75" length
1/2" NPT Mount, Male
16AWG pigtails

Wireless Range

Obstructions:

100 feet

Line of Sight:

1,000 ft

Warranty:

10-year full hardware warranty with 100% repair/replacement coverage for all properly installed devices. [See Lightcloud Warranty Terms.](#)

Dimensions

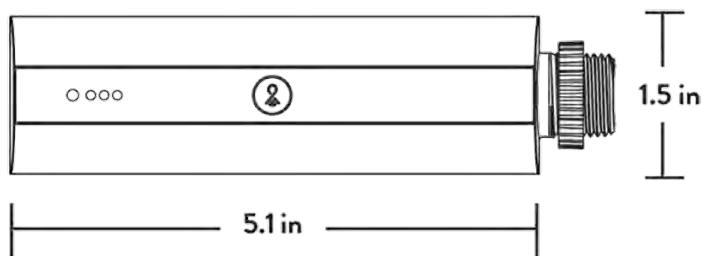

Features

Easy setup - simply power on, confirm device connectivity and call 844-LIGHTCLOUD

Cylindrical design for easy installation at threaded junction boxes

Cloud-based management - no software to install or maintain

Connects to Lightcloud Gateway and other Lightcloud devices

Connects via a secure, encrypted, and self-healing 2.4 GHz wireless mesh network

Repeater Mode to extend range of wireless mesh network

If power to Controller is lost, notification is shown in the Lightcloud application

If communication is lost, Controller can fall back to a customizable emergency state



The Gateway stores all local site information (energy monitoring, schedules, scenes, and more) and communicates with RAB's servers via private 4G cellular connection, so no internet access is required. This Gateway operates on the Verizon cellular network.

Color: Black Weight: 1.3 lbs

RAB | Controls
In partnership with
Qualite
SPORTS LIGHTING, LLC

Technical Specifications

Listings

Compliance

UL Listing:

Indoor use only

DLC Listed:

This product is on the Design Lights Consortium (DLC) Qualified Products List and is eligible for rebates from DLC Member Utilities

Electrical

Input Voltage:

Only use with provided power supply.
5VDC +/- 5%
100-240VAC

Frequencies:

50/60 Hz

Electrical Ratings:

0.5A

Operating Temperature Range:

-30°C to 70°C

Storage Temperature Range:

-40°C to 85°C (-40°F to 185°F)

Other

Maximum Relative Humidity:
95%

Warranty:

10-year full hardware warranty with 100% repair/replacement coverage for all properly installed devices. [See Lightcloud Warranty Terms.](#)

Dimensions

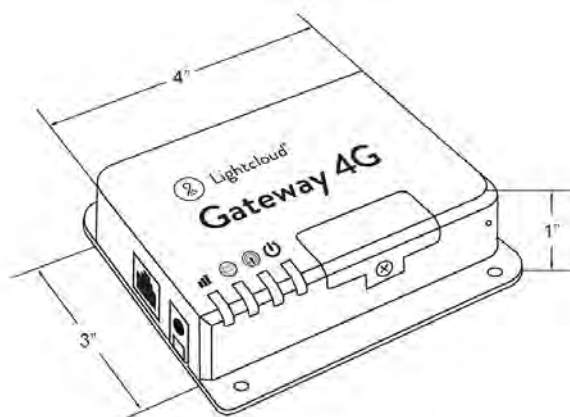

Features

Connects with up to 200 Lightcloud devices

Communicates with Lightcloud devices via 2.4 GHz wireless mesh network

User-serviceable, built-in UPS battery backup (lasts approximately 2 hours)

Cloud-based management - no software to install or maintain

Connects to Lightcloud service using secure cellular 4G connection and no internet access is required

Easy setup - simply power on, confirm a cellular signal and call 844-LIGHTCLOUD

Before final placement of Gateway, call Qualite Sports Lighting at 800.933.9741 to confirm signal strength and placement of Gateway.



The Lightcloud Dimmer is an in-wall device that delivers remote switching, dimming and scene control. Easily trigger one of your scenes, or toggle between multiple scenes.

Color: White

Weight: 0.4 lbs

RAB | Controls
In partnership with
Qualite
SPORTS LIGHTING, LLC

Technical Specifications

Listings

Compliance

UL Listing:

Indoor use only

Electrical

Installation:

All Lightcloud components should be installed by a licensed electrician in accordance with local codes.

Input Voltage:

120V through 277V

Frequencies:

50/60 Hz

Electrical Ratings:

14mA@120VAC

10 mA @ 277VAC

Storage Temperature Range:

-40°C to 85°C (-40°F to 185°F)

Construction

Operating Temperature Range:

0°C to 40°C

Maximum Relative Humidity:

85%

Wire Gauge:

18AWG grounding; terminals supporting up to 12AWG wire

Wireless Range

Line of Sight:

1000 ft

Obstructions:

100 ft

Other

Warranty:

10-year full hardware warranty with 100% repair/replacement coverage for all properly installed devices. [See Lightcloud Warranty Terms.](#)

Dimensions

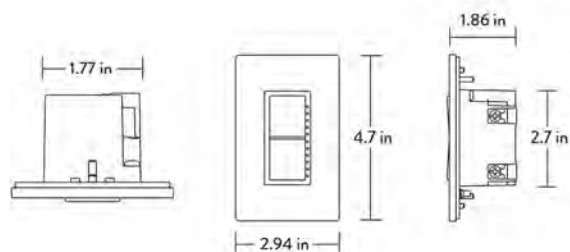

Features

In-wall device for switching, dimming and scene control

Switch and dim individual fixtures or entire zones

Dimming features both fade on/off and rapid full-on

Assign scenes to top and/or bottom buttons

Set the max trim level for a zone or fixture to save energy

Use together with Lightcloud Controller or Sensor devices

Lightcloud Takes Security Seriously

We take our users' security and privacy concerns seriously and strive to be transparent about our security infrastructure and practices. We secure our devices and data at every level of communication, from the site to the cloud, with 5 layers of security.



THE FIRST NETWORKED
LIGHTING CONTROL SYSTEM
LISTED FOR CYBER SECURITY!

5 Layers of Security

Isolation

All Lightcloud data communication is isolated from other networks. Lightcloud isn't affected by compromises to computer networks or dependent on utilizing existing IT infrastructure. Only Lightcloud devices are supported by the Lightcloud network — isolating it from interference and manipulation.

Encryption

Lightcloud uses end-to-end encryption (E2EE) — data transmission is always encrypted. If data were to be accessed, it wouldn't be readable. That encryption remains whether it's between devices, cellular, or accessed via the web. Your data is always secure.

Restriction

Access is restricted by site, passwords, two-factor authentication, and user-level permissions. Every network uses its own keys, so a compromise would be isolated to a single location. Password best practices and two-factor authentication ensure individual users' passwords are secure and used only by the intended user. User-level permissions ensure users only have access to the controls they need.

Prevention

Lightcloud updates go through a rigorous evaluation period in an isolated environment before being released to devices. Evaluations include internal and external audits and penetration tests. This keeps Lightcloud security constantly ahead of any would-be intruders.

Verification

Working with external agencies to evaluate our security validates our efforts to be the most secure lighting controls system available. Our internal security team is constantly improving our system to exceed security guidelines, keeping us several steps ahead.

Call Us Anytime: 1 (844) - LIGHTCLOUD

On-Site Security: Device Communication

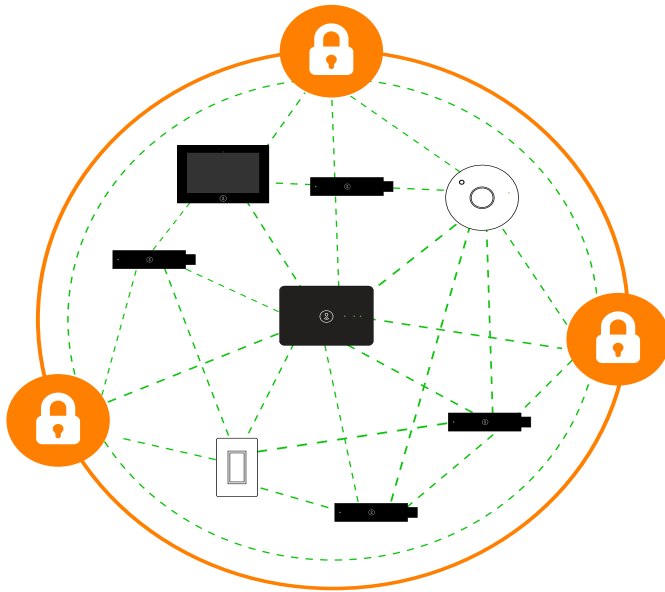

- AES 128-Bit Encrypted
- Data Transmission is ALWAYS Encrypted
- No 3rd Party Products on Network

Lightcloud is a networked lighting control system with Devices communicating over a secure wireless mesh network. At the 802.15.4 wireless level, we provide an encrypted and secure joining process that includes unique network keys for every installation and AES 128-bit encrypted network communications. At no time does any data travel unencrypted. Additionally, only products manufactured by RAB can communicate over the Lightcloud network.

Uplink: Private Cellular to Cloud

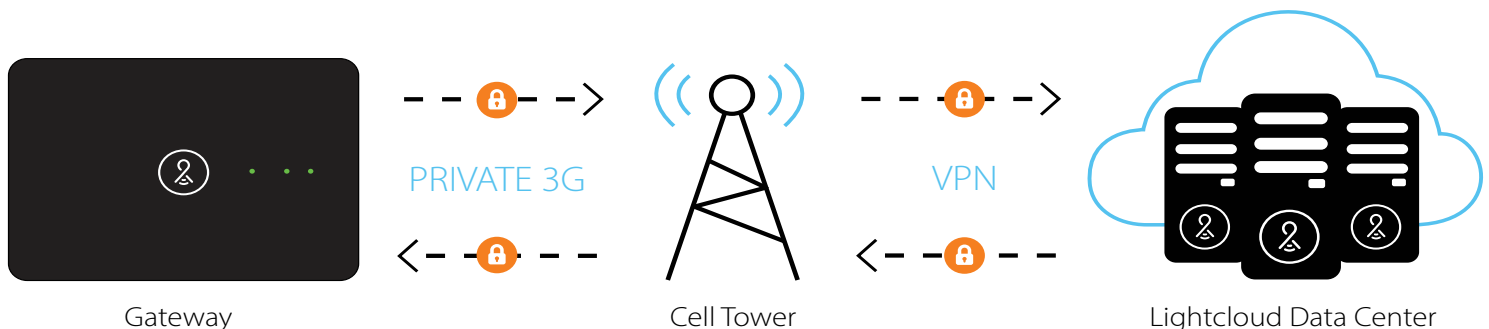

The Gateway communicates to the cloud-based services via dedicated, private 128-bit and 256-bit encrypted 3G cellular connections. Our secure connection operates completely independently from your IT infrastructure. The Gateway provides the communications between the 802.15.4 network and the 3G wireless network. In addition to standard 3G encryption, all data over the cell network travels on a private allocation of cellular addressing over an encrypted VPN (virtual private network) between the Gateways and our private data center.



Cloud Infrastructure: Communication and Storage

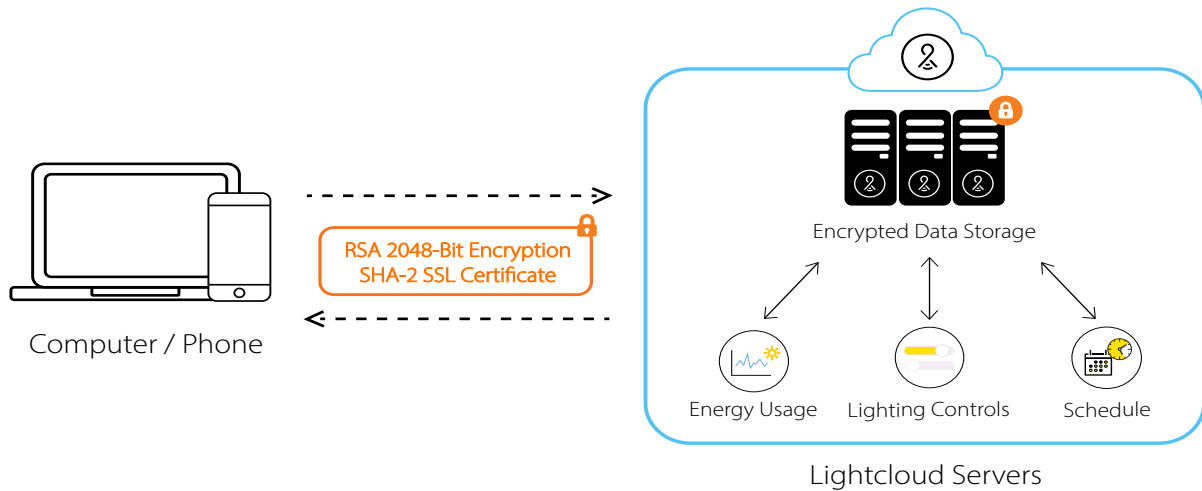

We communicate entirely via SSL TLS — including client communications with servers that interface with our backend servers, which protects communications by using both server authentication and data encryption. Our application endpoints use industry-leading RSA 2048-bit encryption and have DigiCert SHA-2 SSL Certificates. Our servers employ a robust physical security program with multiple certifications. The cloud storage method also guarantees information won't be lost, by creating redundancies on servers around the world.

If a Lightcloud Network were compromised, no sensitive user data would be accessible. User data on Lightcloud is limited to email addresses and lighting controls, so sensitive information is safe.



Access & Control: User-Level Security

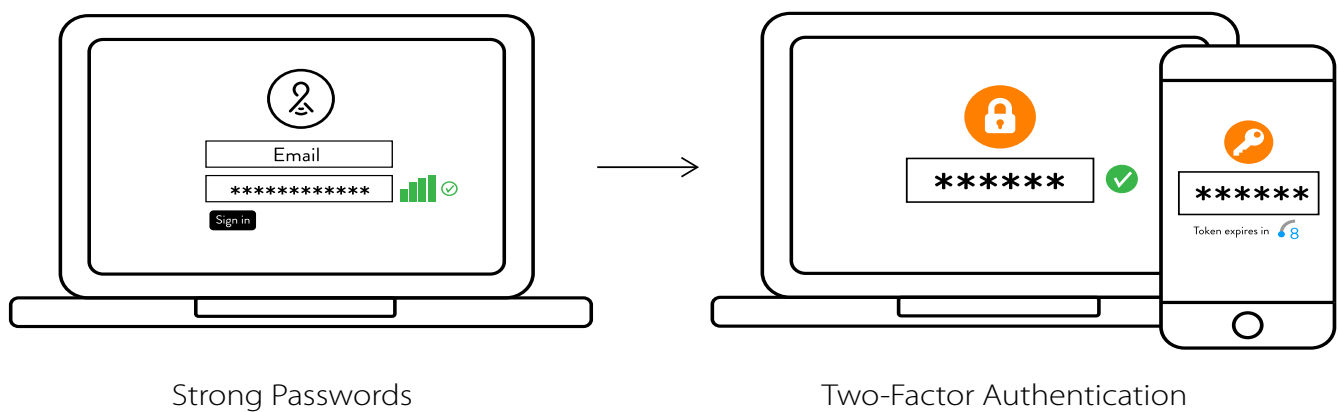

Industry-standard password management protocols are employed, including requirements for length and strength. Strong passwords are important and can be layered with two-factor authentication (2FA) for extra protection. This extra layer of protection can be especially important for administrative users such as systems management and support. Finally, user restrictions ensure access is granted for specific controls for each user. Whenever phones and computers are used to control Lightcloud, each adjustment is logged by user, so if a user's account is ever compromised, that user can immediately be removed or their password changed.

Testing & Vulnerability Management: Monitoring & Development

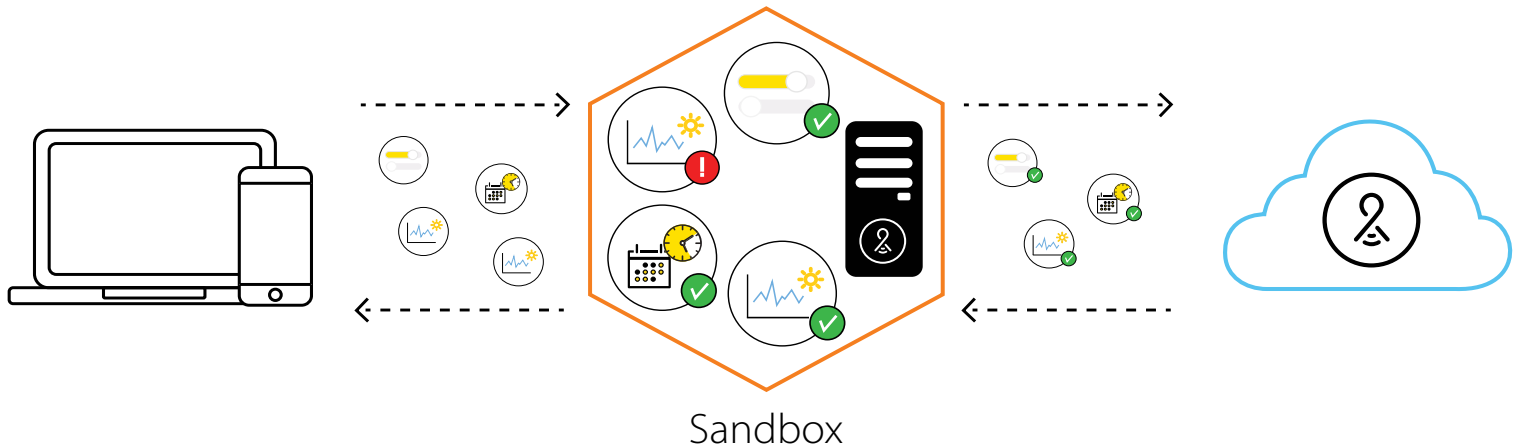

System functionality and design changes are verified in an isolated test “sandbox” environment and subjected to functional and security testing prior to deployment to active production systems. By testing in an isolated environment without live site data, we ensure no data can be compromised while testing. Once security and functionality is verified, changes are rolled out in stages.

Security Audits

Security is an ever-moving target, so we use both internal and 3rd parties to perform quarterly penetration tests and security audits to verify that we are meeting the strict guidelines we have established. Security audits look at the system's hardware/devices, network/server, and the user interfaces/software. Even with physical access to our hardware, none of our security partners have been able to compromise our system at any level. Our security partners are security experts trusted by Fortune 500 Global Companies including GE, Intel, Microsoft, and Samsung.

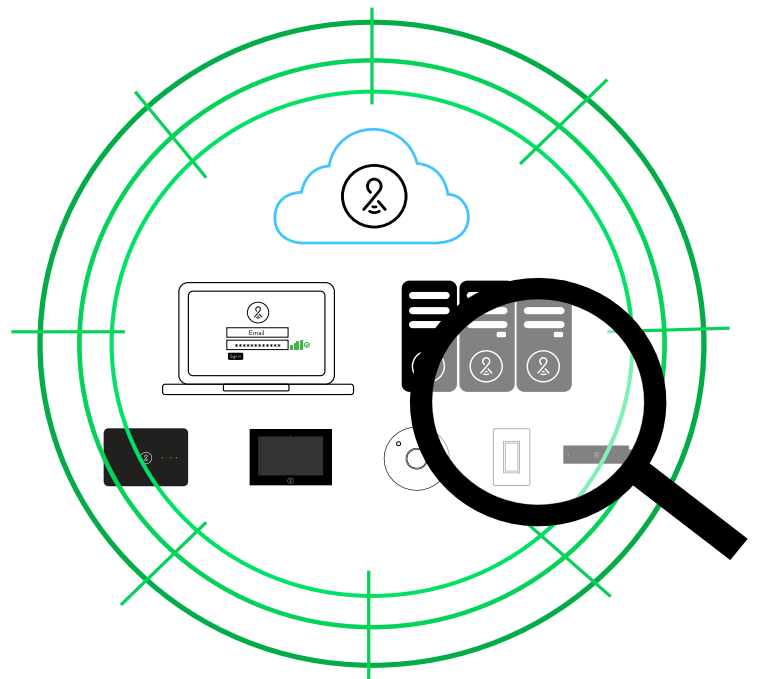



Verification: 3rd-Party Certification

We've designed a very secure ecosystem with layered protection, and two independent agencies — SSL Labs and UL — recognize our security superiority.

THE FIRST  **UL2900-01 LISTED** NETWORKED LIGHTING CONTROL SYSTEM!

UL created the 2900-01 standard of software cybersecurity for network-connectible products and was published as an ANSI (American National Standards Institute) standard. UL evaluated and tested our devices for vulnerabilities, software weaknesses and malware, including risk management and controls in the architecture and design of the product.

UL tests performed:

- Scanned for malware on the binaries
- Scanned for vulnerabilities from the NIST National Vulnerability Database (NVD)
- Scanned for weaknesses in the source code and binaries
- Subjected to malformed traffic data
- Evaluated security protocols for access control and authentication, remote connections, software integrity, cryptography, security logs, and decommissioning
- Ran penetration tests to circumvent controls and security, engage the product in denial of service, access and authentic on the product via unauthorized means, attempt to exploit vulnerabilities acceptable in the risk analysis, elevated privilege on the product, man in the middle attacks

After careful evaluation, UL found our Devices and software exceeded or met all of their requirements, and listed our system as the first UL 2900-01 listed networked lighting control system.

SSL Labs verified and approved our SHA-2 SSL Certificate, inspected our encrypted network communication protocol based on protocol, key exchange, and cipher strength, and determined our security to be of the highest rating. We strive to adopt the latest most secure security protocols and procedures to keep customer data and sites safe.

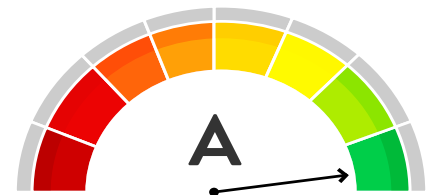

Applications: Trusted Everywhere

Lightcloud is trusted by airports, civic centers, hospitals, hotels, manufacturers, municipal buildings, retailers, sheriff's offices, stadiums, and many other security-sensitive applications. Lightcloud is securely controlling lights all over the country and is ready for your application.

For more information on current Lightcloud customers, see our Select Sites document. For more information on how Lightcloud can fit into your specific application, give us a call at 1 (844) - LIGHTCLOUD



Glossary

AES 128-Bit Encryption

AES is a security standard adopted worldwide and by the US Government. AES is also approved as a cipher for top-secret information at the NSA (National Security Agency). For 128-bit encryption, data is placed in an array, then there are 10 rounds of processing information (substitute, transpose, and mixing of text). 128-Bit encryption has a block and key length of 128 bits.

Virtual Private Network (VPN)

A VPN is a secure, encrypted tunnel that is only accessible by authorized users. VPNs allow information to be safely transmitted over otherwise insecure networks by encrypting the data. If a network is penetrated, the data can't be read and is displayed as meaningless text.

SSL TLS

Secure Sockets Layer and Transport Layer Security are cryptographic protocols for secure, private communication over a network from the server to the browser. The symmetric encryption keys are created for each communication and are unique to each connection. The connection can't be interrupted by an attacker in the middle of the connection or viewed by eavesdroppers. The identities of both the server and the user via the access point is known to the connection. Each message sent has an integrity check to ensure data is transmitted securely and properly.

2-Factor Authentication (2FA)

2FA is an extra layer of security for your Lightcloud login that ensures that you're the only person who can access your account, even if someone knows your password. Each time you log in on a new device, a unique code will be texted to you. This unique code is required along with your password to log in to your user account. 2FA is generally reserved for account administrators or highly security-sensitive locations.

User Restrictions

User restrictions limit access to specific lighting controls and management. System administrators can be given complete control over the system. Other users can be given access to all of the scenes and zones or user-specific controls. By restricting access to only the lights users need to access, it's simpler for the users and more secure.

Sandbox

An isolated testing environment that has no connection to a "live" system is a sandbox. If a sandboxed environment is compromised, it has no effect on the system and no user data can be compromised. By testing in a sandbox, vulnerability and stability can be verified before releasing to customers.

Penetration Audits

Lightcloud Devices, networks, and user interfaces are tested internally and by 3rd-party security experts to look for potential security oversights.

Private 3G

A private allocation of AT&T and Verizon third-generation networks dedicated to Lightcloud. Data is encrypted and transmitted via a VPN to the highly secure Lightcloud Cloud.

COMPLETE control at any time!

- Schedule the lights to come on or off and dim for security and safety!

- Build a complete schedule ahead of time; set it and forget it!

- Manage the schedule from anywhere with your phone, computer, laptop or tablet!

- The first UL2900-01-Listed Networked Lighting Control System!

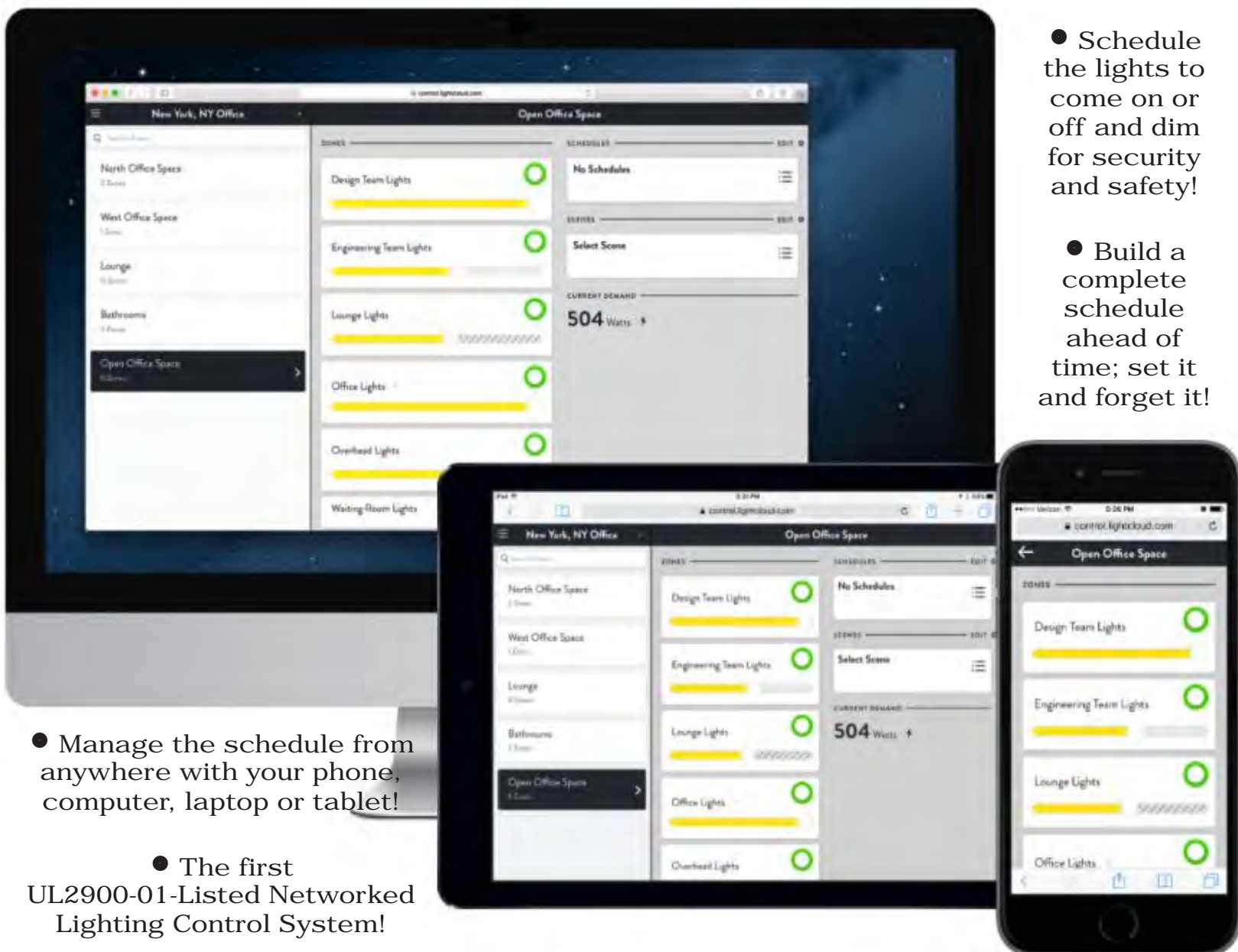

G

Electrical Distribution Plans

This is a sample. Upon PO or LOI, Qualite will provide a project-specific electrical distribution plan.

SERVICE PANEL PROVIDED BY OTHER

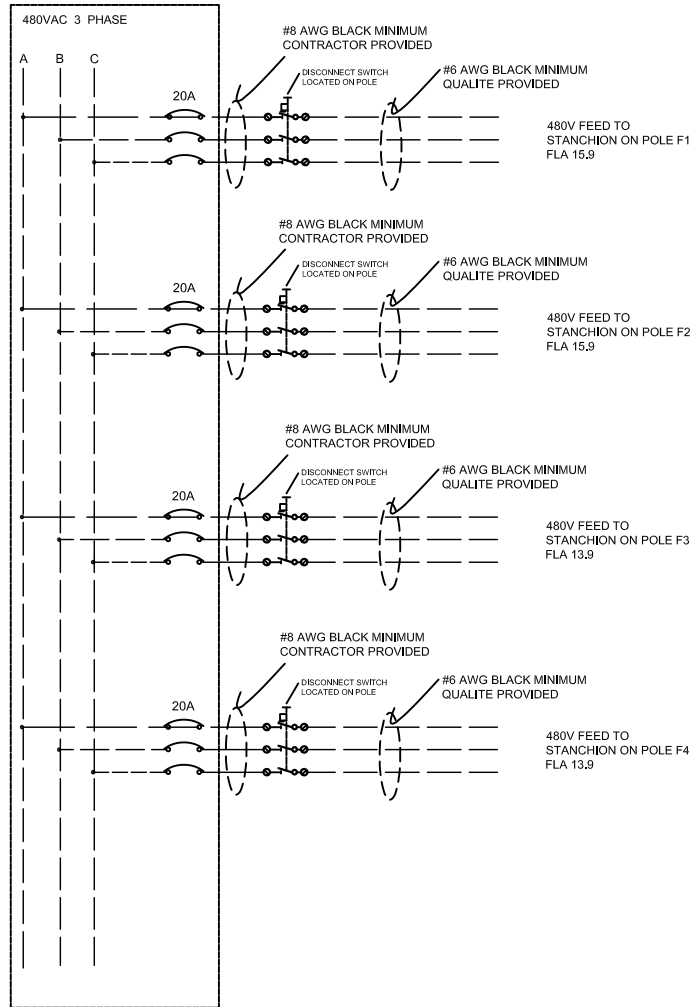

QUALITE SPORTS LIGHTING, INC.				
HILLSDALE, MICHIGAN				
NAME				
DR	SHEET	ENCLOSURE	DATE	OL NO
ASD	1 OF 1	NA	12/27/2024	

PRIMARY MEANS OF DISCONNECT PROVIDED BY INSTALLER	VOLTAGE:	480V 3Ø
	FLA	59.9
	KW	39.9
	CONTROL VOLTAGE	120V 1A

H

Warranty



25-YEAR TOTAL COVERAGE WARRANTY

LED GameChanger™ Lighting System
Sports Lighting Application

Qualite Sports Lighting provides a 25-year “total coverage warranty” to the owner for complete peace of mind at no out-of-pocket cost.

What this warranty covers:

Qualite warrants the GameChanger™ LED Lighting System for 25 years from failure.

All fixtures and or components are covered under this warranty for the full 25 years. All necessary labor, parts, wiring, etc. will be replaced or corrected at Qualite’s expense. The use and cost of equipment (cranes, lifts or other heavy construction equipment) is included in this warranty at Qualite’s expense.

What is covered and included:

- Total system coverage, lights, poles, drivers, etc.
- All labor
- Lifts, crane or other equipment required for repair
- All parts will be supplied by Qualite at no cost to owner
- Light levels are guaranteed for full 25-year period
- Fixture aiming and mounting is guaranteed.

What is not covered:

- Acts of God. (flood, lightning, tornado, etc.)
- Vandalism
- Damage from improper installation
- Non-compliant power conditions

Conditions of Service:

- Adequate, pre-determined egress/ingress is required for heavy service equipment
- Safe working environment for crews

Response Time:

- Normal non-emergency service work will be scheduled within owner’s requirements
- Emergency service response will occur within a 24-hour period

Notes: This warranty is intended for normal usage for the GameChanger™ Lighting System that would be installed on a grade school, high school sports venue, charter schools, park and recreation, college level or other venue with normal use considerations. Please contact Qualite Sports Lighting for high or extreme use facilities.

I

Project References



GameChanger References

Deerfield Electric - New Jersey

Jared Smith
E: jared@deerfieldelectric.net
P: 856.451.5579

Cochran Electric - Michigan

Matt Hill
E: md.hill@hotmail.com
P: 517.784.7106

Hirst Electric - Michigan

Mike Hirst
E: mhirst@hirstelectric.com
P: 517.782.5091

Wellington Electric - Pennsylvania

Bill Gamble
E: wgamble@wellingtonpower.com
P: 724.779.4000

Allegheny City Electric - Pennsylvania

Mike Wiggins
E: mw@alleghenycityelectric.com
P: 412.377.3050

Triad Electric - Virginia

Len Turner
E: lturner@triadgroup-inc.com
P: 757.376.8368

Popson Electric - Pennsylvania

Mike Popson
E: mpopson@yahoo.com
P: 412.309.1920

Frey Electric - Buffalo, New York

Donnie Daigler
E: frey-electric.com
P: 716.868.8445

GameChanger Installations Near You

- * North Allegheny High School Football Field
- * Plum High School Baseball & Softball Fields
- * Washington High School Football Field
- * Chartiers Valley High School Football Field
- * Donaldson Park - 3 - Baseball Fields
- * Selingsgrove High School Football Field
- * Huntingdon Area Schools War Veterans Memorial Field
- * Franklin Regional High School Football Field
- * Penn-Trafford High School Football Field
- * Brookville High School Football Field
- * North Hills School District
- * Martorelli Football Stadium and Baseball Field (pending construction)



&% 'K "A YWUbJWGHfYYhž< J`gXUŸžA=(- &(&.....'k k k 'ei U`jH'Wta







Qualite
SPORTS LIGHTING, LLC

&% 'K "'A YVWUbJWGHfYYhž<J`qXU`Yž'A =(- &(&''''''''k k k "ei U`jHY"Wtā



&% `K "A YWUbTWGhfYYhž<J`qXU`Yž`A =(- &(&.....`k k k "ei U`JhY"WŁa



Topgolf Las Vegas, NV

- ♦ Chesterfield, MO
- ♦ Vineyard, UT
- ♦ Chattanooga, TN
- ♦ Charlotte SW, NC
- ♦ The Colony, TX
- ♦ Jacksonville, FL
- ♦ San Antonio, TX
- ♦ Birmingham, AL
- ♦ Albuquerque, NM
- ♦ Charlotte Univ, NC
- ♦ Cleveland, OH
- ♦ Fort Worth, TX
- ♦ Miami Gardens, FL
- ♦ Nashville, TN
- ♦ Overland Park, KS
- ♦ Ashburn, VA
- ♦ Augusta, GA
- ♦ Lake Mary, FL
- ♦ Doral, FL



- ♦ El Paso, TX
- ♦ Tucson, AZ
- ♦ Pittsburgh, PA
- ♦ Las Vegas, NV
- ♦ Edison, NJ
- ♦ Dallas, TX
- ♦ Austin, TX
- ♦ Huntsville, AL
- ♦ Alpharetta, GA
- ♦ Tampa, FL
- ♦ Spring, TX
- ♦ Rogers, AR
- ♦ Omaha, NE
- ♦ Gilbert, AZ
- ♦ Scottsdale, AZ
- ♦ Roseville, CA
- ♦ San Jose, CA
- ♦ Renton, WA
- ♦ Richmond, VA
- ♦ Fishers, IN
- ♦ Buford, GA
- ♦ Orlando, FL
- ♦ Germantown, MD
- ♦ Thornton, CO
- ♦ Ontario, CA
- ♦ Mt. Laurel, NJ
- ♦ Myrtle Beach, SC
- ♦ Pharr, TX
- ♦ Greenville, SC

- ♦ Auburn Hills, MI
- ♦ Greensboro, NC
- ♦ Oklahoma City, OK
- ♦ Schaumburg, IL
- ♦ Virginia Beach, VA
- ♦ Pompano Beach, FL
- ♦ Philadelphia, PA
- ♦ Canton, MA

- ♦ Naperville, IL
- ♦ Wichita, KS
- ♦ Baltimore, MD
- ♦ National Harbor, MD
- ♦ Colorado Springs, CO
- ♦ Brooklyn Center, MN
- ♦ Boise, ID
- ♦ Louisville, KY

- ♦ Katy, TX
- ♦ Webster, TX
- ♦ Centennial, CO
- ♦ Salt Lake City, UT
- ♦ Glendale, AZ
- ♦ Columbus, OH
- ♦ Baton Rouge, LA
- ♦ El Segundo, CA

- ♦ West Chester, OH
- ♦ Schaumburg, IL
- ♦ Waco, TX
- ♦ Knoxville, TN
- ♦ Atlanta, GA
- ♦ Oklahoma City, OK
- ♦ St. Petersburg, FL
- ♦ Burlingame, CA

INTERNATIONAL VENUES

- ♦ Dubai, UAE
- ♦ Monterrey, Mexico
- ♦ Oberhausen, Germany
- ♦ Bangkok, Thailand
- ♦ Vienna, Austria

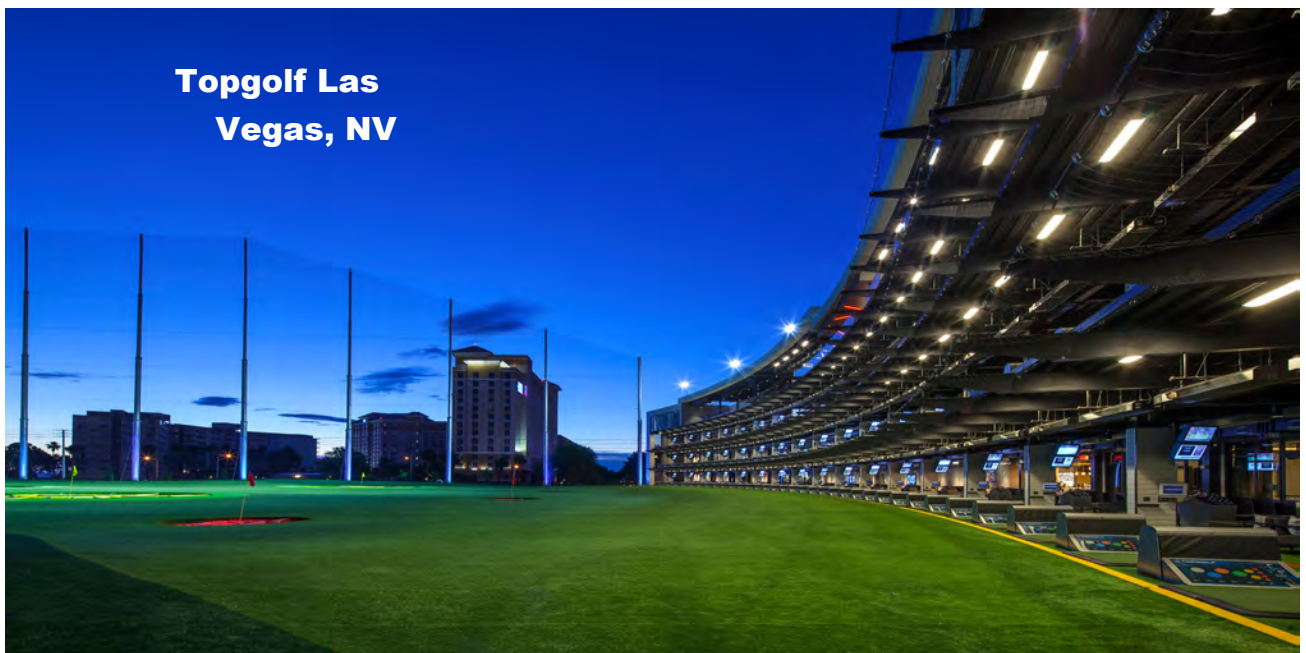

J

Product Information



Keep Your Neighbors in the Dark.

Be a good neighbor with amazing light spill & glare control!

Introducing the **ALL NEW** GameChanger™ Gen 4 Series!

GAMECHANGER™ QLED



Features:

- Meet and exceed spill & glare control requirements to keep your neighbors happy
- Driver cabinets lower on pole - no need for bucket truck to come back to your field for maintenance
- Wireless controls with no operation cost to you
- Entertainment package available; includes pre-set & custom scenes for field lights, dynamic & RGBA lighting
- 25-year warranty on parts & labor



Consider Qualite for a great option that includes everything from inception to completion of your project, including specifications, light designs, engineering, quotations, light level audit, and complete installation.

Main: 800.933.9741 • Fax: 517.437.3146 • info@qualite.com • www.qualite.com

Qualite GameChanger® Gen 4 QLED System offers the most advanced spill and glare control, making it the ideal choice when neighbors are close. It provides top-level field uniformity while reducing energy consumption for your project.

With 38 years of experience in the sports lighting industry, Qualite designs and produces all products in the USA. We have thousands of installations across the country.

We can also assist with the installation of lights and poles in most areas, if needed. Our 25-year full warranty includes parts & labor, ensuring a maintenance-free system for the owner. Our warranty covers both new installations and retrofit projects.

Additionally, we offer remote monitoring and adjustment capabilities for added convenience.

Qualite makes purchasing easy through national cooperative purchasing contracts. We provide project management to ensure a smooth process from start to finish.

If you haven't compared Qualite Sports Lighting with other options, you have nothing to lose, and everything to gain. You'll receive a comprehensive design and quote package from an award-winning national provider, likely at a competitive price with all the features you need.

Make the better choice, with Qualite!



Qualite
SPORTS LIGHTING, LLC

Fixture Technical Specifications

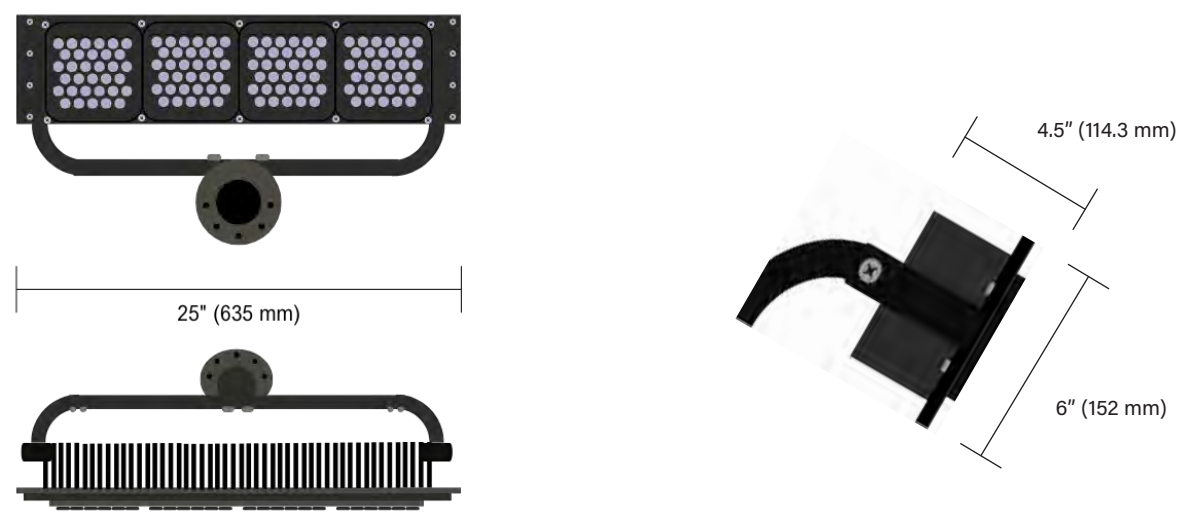

- Applications**

 - Outdoor sports fields at all levels
 - General area lighting
- Controls**

 - LightCloud Gateway 4G
 - Onsite touchscreen or smart switch w/dimmer
- Input Power**

 - 120v - 240v auto sensing
 - 277v - 480v auto sensing
- Ratings**

 - IP66, -40°C to 55°C

GameChanger Electric Detail	GEN4 Series (up to)
Kw Draw	660
*Lumen Output	71,913
CCT	5,700
CRI	>80
Weight	17 lbs.
Current	Amps (up to)
120v -277v	4.76
240v	5.50
208v	6.35
480 1 Ø	2.83
480 3 Ø	1.59 (w/ balanced load)

Please contact us for full technical specifications and all available options.

Basic Assembly Configuration

The GameChanger Lighting System

Pre-aimed, pre-wired and **FULLY ASSEMBLED** light racks for unequaled ease of assembly with guaranteed performance.

Features	System Benefits
High Efficiency LED	<ul style="list-style-type: none">Lower power consumptionVery Low Lumen depreciation5700K / 80CRI Min
Pre-Wired and Pre-Aimed System	<ul style="list-style-type: none">Ease of InstallationGuaranteed light levelsSystem engineered components
Nearly Instant On/Off	<ul style="list-style-type: none">Allows for emergencyNo warm-up/cool-down time
Color-Consistency Dimmable	<ul style="list-style-type: none">Maintains high denition quality lightingPower savings and design flexibility
Environmentally Safe	<ul style="list-style-type: none">ROHS compliant

Pre-wired, pre-aimed, and pre-assembled light stanchion - lights available with full visors as shown



Junction box

Remote driver / Distribution cabinet (see details below)

Qualite provided wire harness (internal to the pole)



Driver Distribution Cabinet



Remote Driver Cabinet
Mounted 10 ft. off the ground for safety and accessibility



Controller Gateway
Can be mounted in concessions, electrical room, outside, etc. Requires 120v outlet.

Surge Protection
100kA Rating
Fail Safe Operation
Built-in Thermal Disconnect

Easy Access Driver
with pullout service slides

Programmable IP67 Rated Drivers
with internal thermal protection power supply

Wireless Controller Disconnect
Pre-wired for single point disconnection

Fused for redundant protection

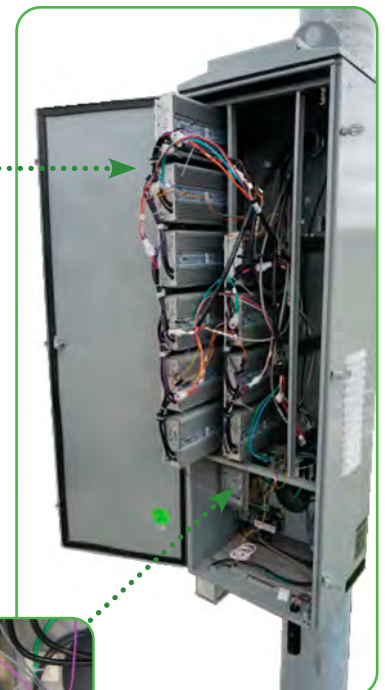

Power Line Filter
Reduce EMI and RFI (both direction)

Control & Switching Options

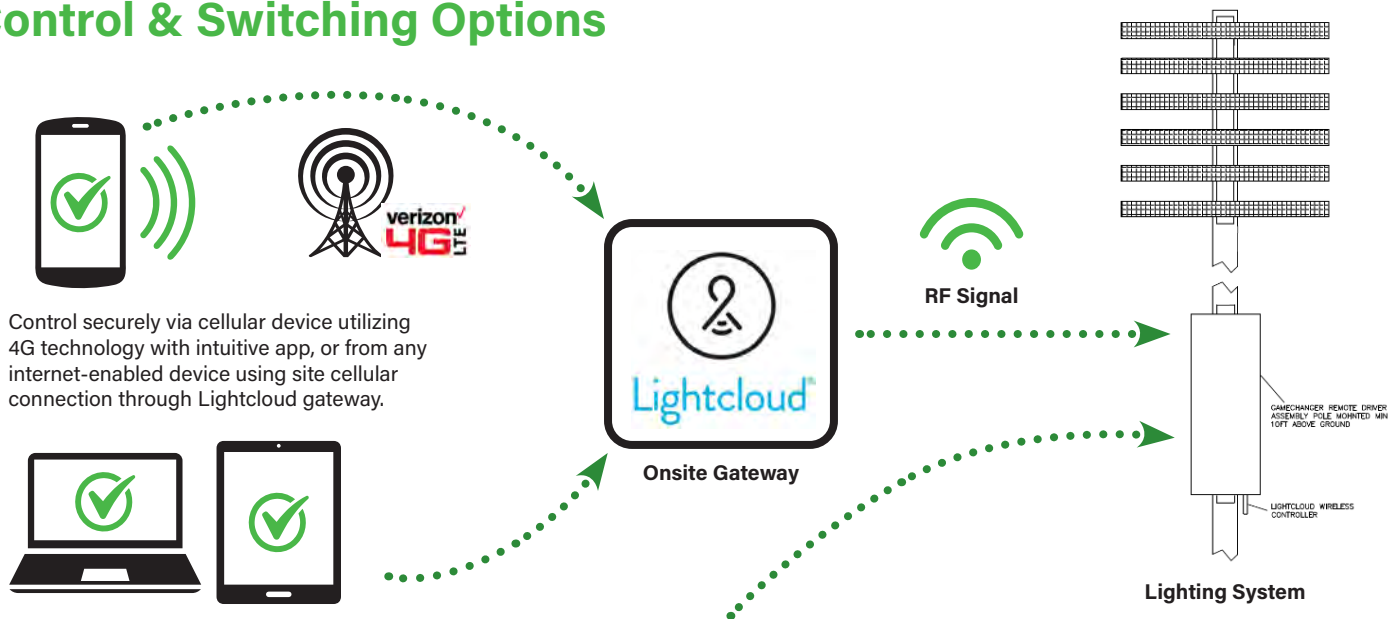

Redundant Onsite Control Option

Touchscreen and Smart Switch talk directly to the pole in the event the gateway should fall offline. Either option can be used as a redundant back-up control option or easy access onsite control without the use of cellular gateway or phone. Either unit communicates directly to pole driver enclosure.



– OR –



About Qualite

If you haven't compared Qualite Sports Lighting to your other options recently, you have nothing to lose and everything to gain. Discover the difference with our comprehensive design and quote package from an award-winning national provider of sports lighting. You'll likely find a competitive price that includes all the features and functions you need.

Qualite has been the sports lighting partner for high schools, colleges, parks and recreation departments, and minor and major league professional sports franchises for over 30 years. Qualite's Q-LED GameChanger™ is the first high performance sports lighting system designed for all sports venues, from youth to professional sports stadiums, with a focus on great connectivity and functionality at affordable pricing.

25-Year Service Warranty

Qualite provides a complete 25-year service and performance warranty. This warranty includes parts, labor and equipment to keep your lighting system running at it's peak performance for a full 25 years. All service work is performed by our factory-trained service technicians. We also utilize our wireless controls for system monitoring and remote service.



Let us know when you are ready to make a better choice!

Main: 800.933.9741 • Fax: 517.437.3146 • info@qualite.com • www.qualite.com

Qualite
SPORTS LIGHTING, LLC

GAMECHANGER™

Q-LED™



Top Golf



Qualite
SPORTS LIGHTING, LLC

(517) 439-1581
www.qualite.com
1-800-933-9741



K

Delivery



June 5, 2025

To Whom It May Concern:

Once an order is placed with Qualite, we would expect two (2) weeks for submittals to be delivered and approved.

Once approved for this project, we can have lighting and pole materials available approximately ten (10) to twelve (12) weeks from signed submittal. We can also have fields shipped as installation dictates.

We see no issue in meeting project time requirements and we think these could be improved on as we continue to coordinate with project managers.

Thank you.

A handwritten signature in black ink that reads "Renny Coe". The signature is written in a cursive, flowing style.

Renny Coe
Northeast Sales Manager
Qualite Sports Lighting, LLC.
517.914.6225 | rcoe@qualite.com

L

Cost of Ownership

PROJECT: Iola French Park
 DESIGN #: 23389D1-A
 DATE: 5/6/2025



Fixture Quantity	kW	kWh rate	Annual Usage	Life (years)	Total
11	1.3	\$ 0.29000	300	25	\$ 31,102.50
2	0.67	\$ 0.29000	100	25	\$ 971.50
Communications Cost for wireless Controls are covered for 25 years					0
All Maintenance Cost are covered for 25 years					0
Total 25-Year Life-Cycle Operating Cost					\$ 32,074.00

M

About Qualite



M. Eric Boorom,
Founder



- Founder of Worth Capital and Worth Investment Group
- Proven track record of over 26 years in operations management, turnarounds, workouts, banking, finance, and mergers & acquisitions
- The Bank of Tokyo-Mitsubishi, the second largest bank in the world; worked as a team member in the Special Assignments Group
- ABN-AMRO/LaSalle National Bank, one of the world's largest banks headquartered in Chicago, Illinois; Worked as a credit analyst, and was also involved in debt recapitalization, operational reengineering, turnaround financing, workout and bankruptcy transactions, real estate financing, enterprise value transactions (cash-flow based financing), mergers, acquisitions, cross-border financing and the issuance/procurement of subordinated debt, bonds and equity.
- Currently President and CEO of Worth Holdings, LLC
- Currently President and CEO of Qualite Sports Lighting, LLC
- Bachelor of Science in finance from Michigan State University



Mikel J. Boorom, P.E.
VP and Director of Product
Development and
Manufacturing



Mikel Boorom started his career working for Commonwealth Engineers, where he designed high-voltage steel and aluminum transmission line structures, including sectional steel pole structures, also designing the reinforced concrete foundations for the structures.

Mr. Boorom was involved with the structural concrete design for a number of nuclear power plants, and has provided engineering expertise in the fields of aerodynamics, aircraft structural analysis and design.

He has been employed by SAFRAN as an expert in the integration of aircraft diesel power plants on general aviation aircraft during which he provided on-site expertise for various projects in France and Central America. He has provided contract services for the Structural Steel Industry and Aircraft Industry. Composite materials integration in current aircraft design optimization of aero dynamic drag reduction.

He has been active in the American Institute of Steel Construction, American Concrete Institute, National Society of Professional Engineers, American Institute of Aeronautics and Astronautics, Society of Automotive Engineers, American Society of Civil Engineers and Structural Engineering Institute.

In addition, he holds an FAA Airframe and Powerplant Mechanics Certificate, Private Pilot's License, with Single Engine and Multi-Engine, Instrument Rating, Seaplane Rating. He has over 10,000 hours of flight time, ranging from ultraflights to Lear jets.

Mr. Boorom earned his bachelor of science degree in Civil/Structural Engineering from Michigan State University and additional studies in soil mechanics, composite structures design, FAA Certification procedures and Forensic Analysis of Structural Failures.



Robert Denning, Sr. VP of West Coast Sales and Construction Services



Bob Denning is the Sr. VP of West Coast Sales and Construction Services, with 40+ years of experience in managing successful organizations.

Mr. Denning joined the Worth Team in 2015, after taking an early retirement from Verizon, where he managed large groups of Construction and Service teams. His organization covered northern California, where he led diverse workgroups of management and union employees. Bob specializes in developing a positive workplace culture, empowering teams, and employees to achieve defined goals. Bob has a degree in Information Technology from PACE University in White Plains, NY, and is a licensed Electrical Contractor in California.

Capabilities and areas of expertise:

- Leadership to coordinate the efforts of multiple teams working across the United States
- Team management to effectively execute project goals
- Issue resolution
- Review construction plans and material needs
- Estimating labor and material costs
- Identify potential contractors
- Oversee daily operations
- Recommend changes to improve
- Licensed Electrical Contractor in several states
- Career of managing large electrical construction teams across the United States, including 34 years at FTE/Verizon and 8 years at Qualite Sports Lighting



Renny Coe

Qualite Sales Manager
North East United States

Renny Coe is the Qualite Sales Manager for the North East United States area.

Renny joined the Qualite Sports Lighting team in 2018, bringing over 32 years of sales expertise.

Highly motivated and accomplished Sales Professional with years of experience in developing strong relationships for successful client/customer outcomes. Skilled in partnering with School Districts and Local Municipalities to address short- and long-term goals for Sports Lighting projects. Has a proven track record of developing and implementing creative Sports Lighting solutions.

Key Skills and Capabilities

- Relationship Building
- Sales Strategy
- Customer Engagement
- Solution-Oriented Approach
- Developing and nurturing long-lasting relationships with school districts and local municipalities.
- Successfully promoting sports lighting options to meet clients' needs and enhance their sports facilities.
- Presentation of proposed Sports Lighting projects to individuals, small or large groups.
- Collaborating with architects, engineers, and decision-makers to plan and execute sports field lighting projects.
- Demonstrated expertise in promoting and presenting energy-efficient options for lighting athletic facilities.



Heather Jeffrey
Sales and Marketing Manager



Heather Jeffrey is the Marketing/Sales Manager for Qualite Sports Lighting.

She joined the team in 2017 and brought with her two decades of marketing, management and sales experience.

Prior to joining our team, she owned and operated her own successful marketing/sales support company. Prior to that, for 18 years, she served as the Executive Editor of two daily newspapers, two total market coverage publications and four weekly newspapers in Michigan.

She studied journalism at Michigan State University and radio/television broadcasting at Kellogg College.

Heather, who started as a customer concierge, specializes in leading our marketing efforts and customer service teams, with a special emphasis on the facilitation/management of our inside and outside sales team.

Capabilities areas of expertise:

- * Sales, customer service and marketing team management;
- * Oversee sales, customer service and marketing team daily duties;
- * Communications;
- * Customer retention;
- * Software administration;
- * Value-engineering options;
- * Bid Packages;
- * Quoting;
- * Marketing presentations; and
- * Email marketing.



Patricia Del Rio
Lighting Design Engineer

Patricia del Rio is an Orlando-based Lighting Design Engineer with over 20 years of experience in manufacturing engineering and the lighting industry.

Patricia joined the Qualite Sports Lighting Team in 2023. Patricia is an expert in lighting design analysis for indoor and outdoor sports projects that comply with IES lighting standards. Patricia's expertise includes indoor, outdoor, roadway, and sports lighting.

As a lighting designer, Patricia has analyzed and developed designs for occupational settings (i.e. offices, schools, warehouses), commercial settings (i.e. restaurants, hotels, parking garages), and life safety egress (i.e. corridors, stairwells). Patricia's latest experience has been with Qualite Sports Lighting, providing lighting designs for sports fields (i.e. football, soccer, baseball, softball, and more) and indoor sports facilities (i.e. basketball arenas).

Patricia is focused on excellence through continuous improvements, creative solutions, and analytical approaches to provide exceptional results. Patricia excels through mentoring, training, and empowering junior designers to excel. Patricia is a proud member of the Illuminating Engineering Society.

Capabilities and areas of expertise:

- Bachelor of Science in Mechanical Engineering from Florida Atlantic University
- Master of Science in Occupational Safety Management from Embry-Riddle Aeronautical University
- Lean manufacturing and design engineering
- Lighting Analysis & Design using AGI32 Lighting Analyst
- Understand & Interpret the NFPA Life Safety Code
- IES/NA Recommendations & Guidelines
- OSHA Compliance & Safety
- AutoCAD / REVIT / Sketchup
- Leadership & Mentoring
- Inside sales/manufacturer's representative
- Indoor, outdoor, parking garages, stairwells, commercial, industrial, sports lighting, egress



Daniel Elias,
Electrical Engineer/
Master Electrician



Daniel Elias serves as Qualite Sports Lighting's electrical engineer.

He was born and raised in Argentina and came to the United States about 20 years ago. He lived in Hollywood, Florida and later moved to San Antonio, Texas, where he lives now with his wife and children.

He has worked in the electrical field for entire life and recently completed his schooling and graduated with an electrical engineer degree. He is a master electrician. He specializes in electrical layout and material planning, as well as provides on-site leadership to execute the quality of installation. He has 12 years experience in the electrical trade.

Samuel C. Spragg:
Production & Facilities Manager



Sam Spragg is the Production and Facilities Manager, with more than 15 years of experience in managing and organizing production and transportation.

Mr. Spragg joined the team in 2023, after a plant closure in the automotive industry, where he managed production employees, transportation and scheduling teams. His organization covered North America, supplying the automotive industries with just in time management. He led diverse work groups of management and union employees. Sam specializes in developing a positive workplace culture and boosting morales, as well as empowering teams and employees to achieve defined goals.

Capabilities and areas of expertise:

- Leadership, team-building, transparency;
- Promoting a safe work environment;
- Quality assurance;
- Coordinating new policies and procedures;
- Team management to effectively execute project goals;
- Review and execute production plans and material needs;
- Problem-solving;
- Identify potential cost savings;
- Oversee daily operations and scheduling of jobs;
- Encourage and enhance self-awareness;
- Promoting adaptability;
- Formulate changes to improve;
- Ability to strategize new concepts;
- Implementing product improvements; and
- 24-year career of managing a strong and efficient work force.

Christopher Parks,
Senior Project Manager



Chris Parks is a senior project manager with Qualite, who oversees a crew for warranty and service. He also handles customer service, Qualite controls trouble-shooting, and has eight (8) years of management experience.

Mr. Parks started with the Qualite team in 2012 on the production floor and worked his way up to warehouse manager, then to purchasing manager, then to production manager and finally, to his current Senior Project Manager position. He has helped develop good production work-flow to help meet production goals and time lines.

Capabilities and areas of expertise:

- Leadership to coordinate the effective completion of production needs to meet customer deadlines
- Team management to effectively execute project goals
- Technical trouble-shooting of LED and Metal Halide systems and controls
- Oversee daily operations
- Issue resolution
- Crew route planning
- Scheduling crews and production
- Purchasing and product sourcing
- Safety procedures



QUALITE HAS OVER 30 YEARS OF EXPERIENCE IN THE STADIUM & FIELD LIGHTING INDUSTRY

WHO WE ARE

Qualite has been the sports lighting partner for high schools, colleges, parks and recreation departments, and minor and major league professional sports franchises for over 30 years. Qualite's Q-LED GameChanger™ is the first high performance sports lighting system designed for all sports venues, from youth to professional sports stadiums, with a focus on great connectivity and functionality at affordable pricing.



LIGHTING SYSTEM DESIGN

Qualite utilizes its experienced design team to develop complete lighting designs that provide code-compliant, yet energy-efficient, lighting systems.

PROJECT MANAGEMENT

Qualite offers complete project management to provide seamless, ontime completion of your project.



WHERE ARE WE LOCATED

Qualite maintains corporate operations in Hillsdale, MI, along with our manufacturing facility, sales and customer service teams.

COMPLETE INSTALLATION SERVICES

Allow Qualite to provide a turnkey solution. From design and manufacturing to installation by our trained factory installation and service team. Each member has extensive knowledge of our products offering code-compliant installation.

25-YEAR SERVICE WARRANTY

Qualite provides a complete 25-year service and performance warranty. This warranty includes parts, labor and equipment to keep your lighting system running at its peak performance for a full 25 years. All service work is performed by our factory-trained service technicians. We also utilize our wireless controls for system monitoring and remote service.



THE AWARD-WINNING QLED GAMECHANGER LIGHTING SYSTEM IS DESIGNED AND MANUFACTURED IN THE USA



THE GAMECHANGER

The art of design is clearly illustrated with the QLED GameChanger™ Lighting System. With proprietary optical lenses that provide precision lighting on and off the field, the GameChanger is designed for performance and energy savings. The GameChanger is factory-aimed and guaranteed to perform as designed for 25 years.

INNOVATIVE HELICAL DESIGN

Old-style, straight crossarms are obsolete. A new, fresh approach utilizes a vertically-mounted stanchion providing lower wind loads on poles and higher performance. Also, by centering loads, lighting poles are subjected to less torsional loads, in turn extending their life. The helical design is very efficient for lighting efficiency, as well, and allows the designer to maintain good aiming angles while limiting spill.



PRECISE LIGHTING CUT-OFF

The GameChanger offers a wide range of cut-off capabilities. With precision optical lenses, lighting cut-off can be achieved in most cases. If extreme cut-off is needed, Qualite engineers add an external visor that extends the cut-off and increases the cut-off capabilities.

Gamechanger Performance Specifications



ELECTRICAL DETAIL	GC600	GC1200
Input Watts	600 W	1200 W
KW Draw	.65	1.3
Lumen Output	>60,000	>120,000
Lumens/Watts	>115	>115
CCT	5,700	5,700
CRI	>80	>80
Weight	25 lbs	39 lbs

CURRENT	AMPS	AMPS
480 V, 1P	1.35	2.70
277 V, 1P	2.35	4.70
240 V, 1P	2.71	5.42
208 V, 1P	3.13	6.26
120 V, 1P	5.42	10.80

- Pre-Wired System
- Pre-Aimed Optics
- Remote Driver Enclosure
- Over Current Protected
- Power Conditioner Included
- Service Disconnect Included
- No Exposed Wiring
- Wiring Harness Included
- Wireless Controls Included
- No WIFI Required
- Dimming Capabilities
- Customer-Designed Scenes
- Advanced Scheduling Capabilities
- Remote Diagnostics Included
- Steel or Concrete Pole Options
- Precision Optics Included
- Built-In Glare Control
- IP66, -40L C TO 55L C
- Lightning Protection
- External Visor (optional)
- 24/7 Tech Support
- 25-Year Warranty
- Performance Guarantee
- Extreme Reliability
- 100,000+ hour life
- HDTV Compatible
- Retrofit Compatible
- Made in the USA
- ROHS Compliant
- Enviromentally-friendly packaging